

41-Abrams mowingplan 10/2005

STATE PROJECT NUMBER
1152-4-71 & 1152-5-73

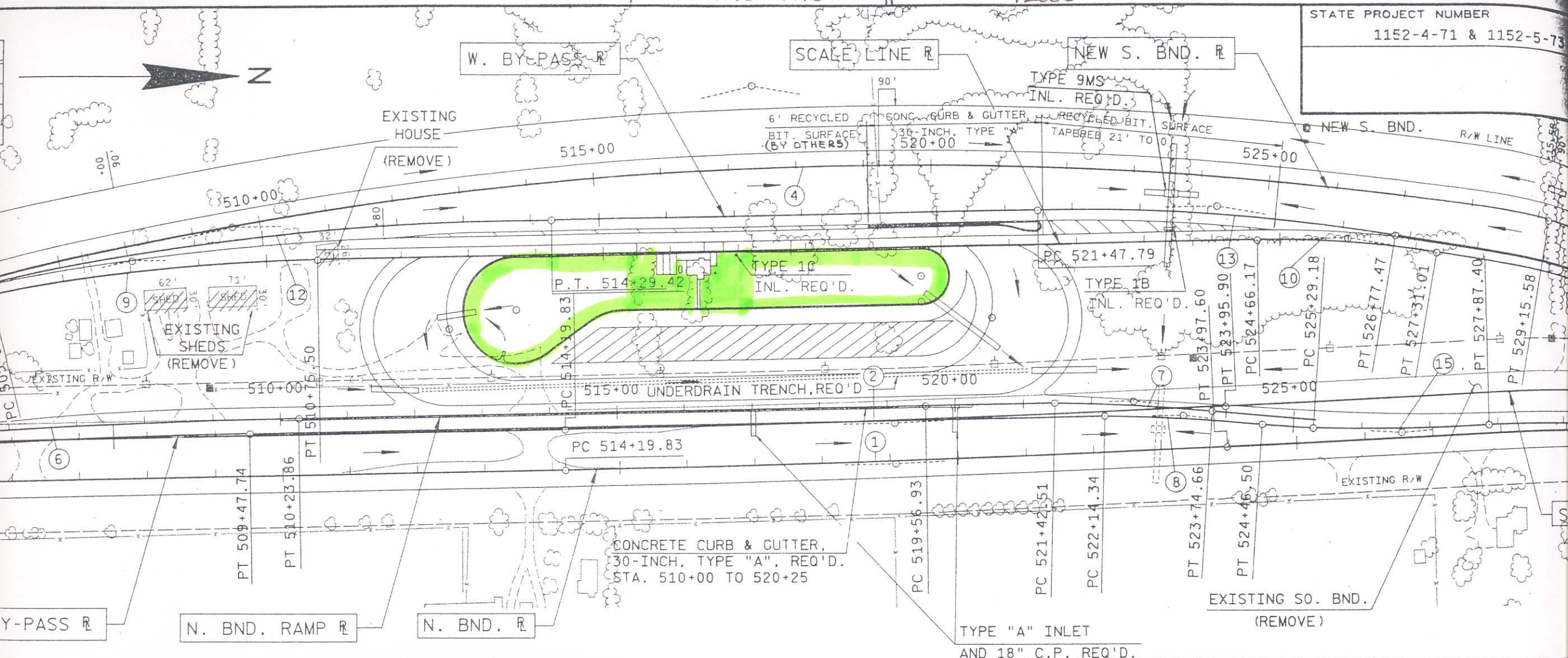

UNCL. EXC.	= 18,666 C.Y.
FILL EXC.	= 56,350 C.Y.
BORROW EXC.	= 49,774 C.Y.

TYPE "A" INLET
AND 18" C.P. REQ'D.