

FRONT ELEVATION

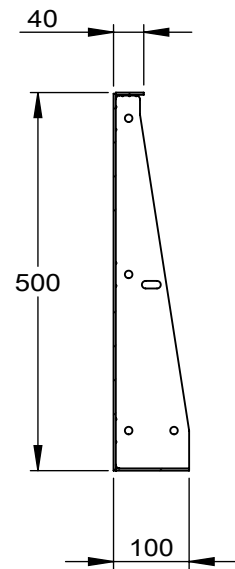

SECTION A-A

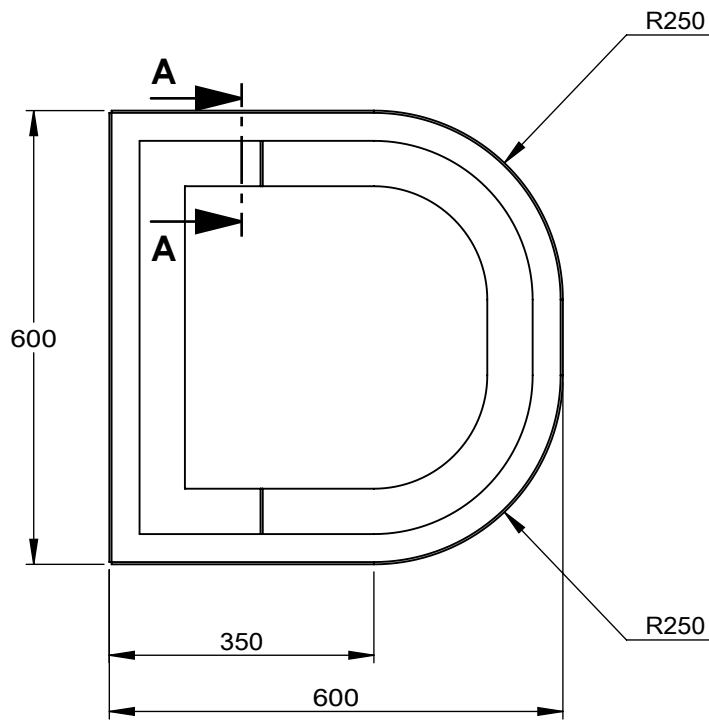

PLAN

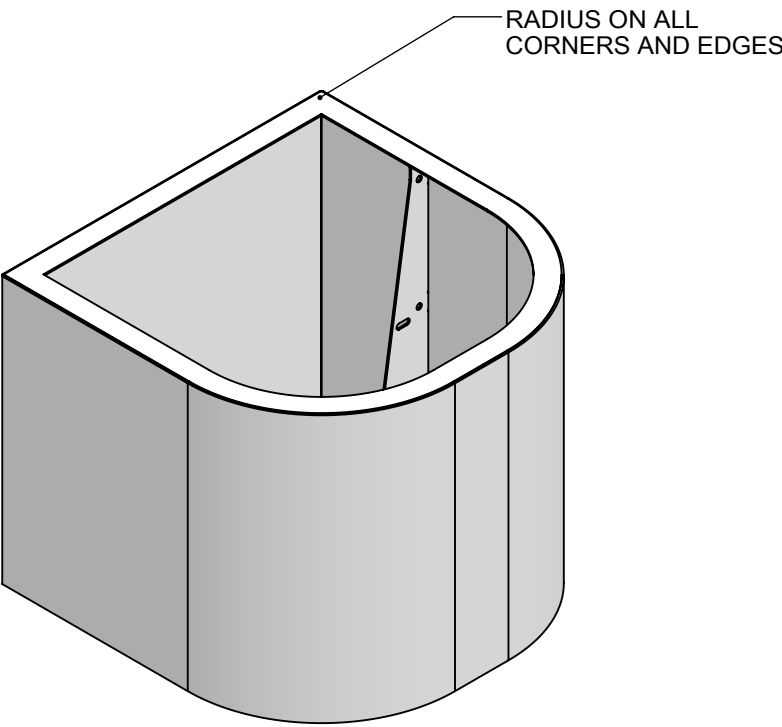

3D VIEW

GENERAL CONRUCTION NOTES	
•	All Folding Tolerances are $\pm 1.2\text{mm}$ with an angle variation of $\pm 1^\circ$
	All Rolling Tolerances $\pm 8\text{mm}$
	All Fabricated and Welded Components are Manufactured to a Tolerance of $\pm 2\text{mm}$
	All Fabricated and Welded Corners are Manufactured to a Tolerance of $\pm 5\text{mm}$ across a Diagonal Measurement
	•
•	Were powder coated components are applicable they are completed to the following specification:
	• Pre Treatment – Shot Blast SA 2.5
	• Primer – Zinc Rich primer with a minimum of 60um
	• Top Coat – Final Top coat to be a minimum of 60um
•	All Timber finishes are supplied as un-treated
	All Cor-ten finishes are supplied as un-treated/un-weathered

VELIN	
• <b>TOTAL WEIGHT = 32.69Kg</b>	REV: <b>A</b>
No.1 Old Street Clarkenwell London EC1V 9HL	<b>Kinley</b> 