

START

END

Nubi NMIC1

USB/XLR Dynamic Microphone

USER MANUAL

Congrats on choosing the Nubi NMIC1 — the microphone that truly lives up to its promise. We're confident that this model - is a flagship. Welcome aboard!

Throughout its development, we focused on delivering outstanding sound, premium materials, and a solid, reliable build.

The manual has clear, step-by-step instructions for assembling, connecting, and setting up your new NMIC1.

If you have any questions, just reach out — we're here to help and will sort things out.

P.S. yes, the packaging is humble cause the mic is where we've put all our effort and money.

Team Nubi ♥

WHY NUBI NMIC1?

We designed NMIC1 for gamers, streamers, content creators, and everyday users who value great sound, premium materials, and a clean, minimalist look. No fluff — just what you need and top quality.

NMIC1 uses a high-end MCU to handle audio processing and encoding. With this premium MCU, you get studio-quality sound at 24-bit/192 kHz.

A built-in noise reduction mode keeps your sound clear in any environment, and you can toggle it with a single touch. To cover all setups, NMIC1 offers both USB-C and XLR connections. The built-in sound card lets you use the mic right away without extra gear, while the XLR connection offers purely unprocessed sound of NMIC1.

Last but not least, premium build and materials ensure long-term reliability. Nubi NMIC1. Designed in Europe. Assembled with love.

PACKAGE CONTENTS

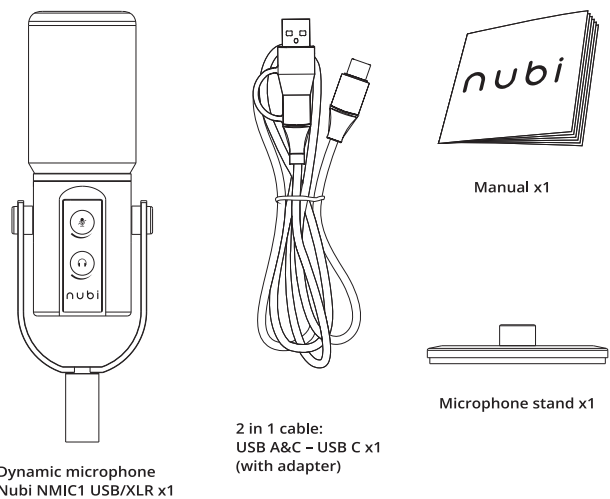

CONTROLS

- Gain (rotate the roller)
- Power on/off (short press)
- Noise reduction (long press)

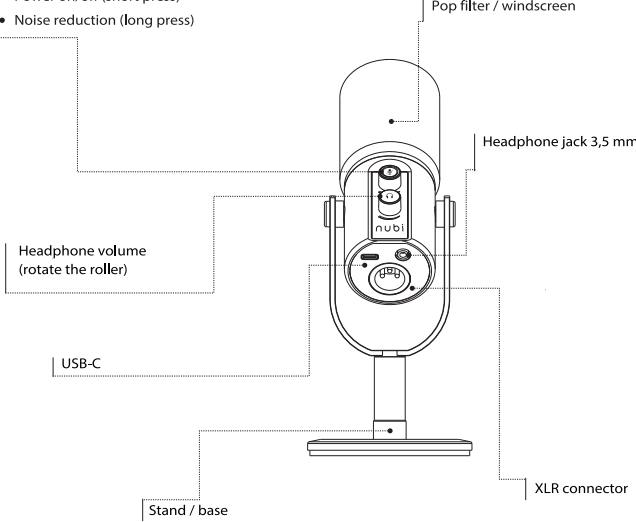

MICROPHONE FEATURES

- Premium 30 mm dynamic capsule with clean sound
- Convenient one-touch mute
- High-quality built-in noise reduction
- Zero-latency monitoring
- On-mic gain control and headphone volume control
- Full compatibility with Windows, Mac, game consoles and smartphones
- Simple plug-and-play without additional drivers
- Cardioid polar pattern
- Reliable wind protection (pop filter)

TECHNICAL SPECIFICATIONS

Microphone type	Dynamic
Polar pattern	Cardioid
Connection	XLR or USB-C
Bit depth and sample rate	24 bit / 192 kHz
Frequency response	50 Hz ~ 16 kHz
Adjustable gain range	0 dB to +36 dB
Sensitivity	-49 dBV/Pa, USB: -9 dBFS/Pa (maximum)
Maximum SPL	110 dB SPL



nubi.gg/drivers

FR Manuel d'utilisation
DE Benutzerhandbuch ESP Manual de usuario
BG Ръководство за потребител FI Käyttöopas
NO Brukerhåndbok TR Kullanım Kılavuzu
SE Användarhandbok DK Brugervejledning
SK Uživatelská příručka PL Instrukcja obsługi
CZ Uživatelská příručka LV Lietotāja rokasgrāmata
UA Посібник користувача RS Корисничко упутstvo
HR Korisnički priručnik RO Manual de utilizare

Get questions or an order issue?
Reach out to our support and we'll help!

HELP@NUBI.GG

With love, team Nubi

FREQUENCY RESPONSE

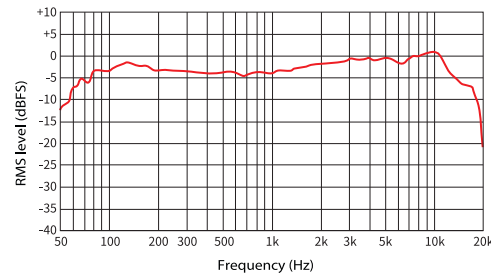

POLAR PATTERN



INSTALLATION AND FIRST CONNECTION

MOUNTING THE MICROPHONE ON THE INCLUDED DESK STAND

- Bring the stand to the microphone mount (threaded)
- Screw the stand onto the stem counterclockwise
- Done. Now connect the microphone to your device

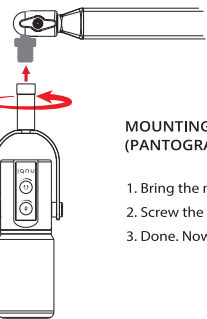

MOUNTING THE MICROPHONE ON A BOOM ARM (PANTOGRAPH / STAND)

- Bring the microphone to the boom arm
- Screw the microphone to the boom arm counterclockwise
- Done. Now connect the microphone to your device

CONNECTING THE MICROPHONE TO A COMPUTER

Connect the microphone to your computer with a USB-C cable. Plug one end into the microphone's USB-C port and the other end into a USB-C or USB-A port on your computer. Make sure the connection is fully seated.

If your computer only has USB-A ports, you can use a USB-C to USB-A adapter.

For real-time monitoring, connect headphones to the 3.5 mm jack on the bottom of the microphone. This provides latency-free monitoring.

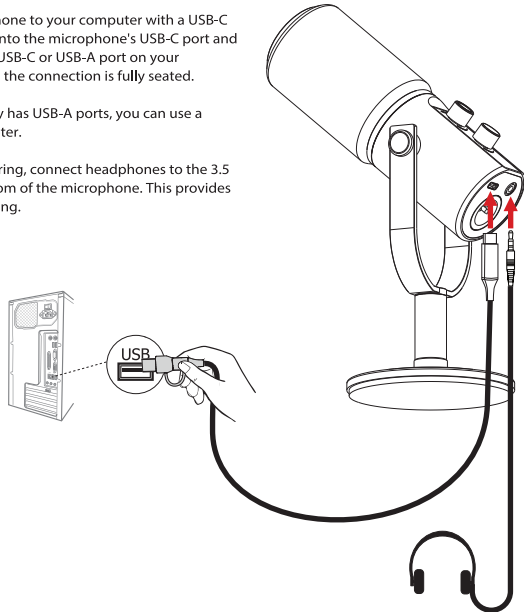

CONNECTING THE MICROPHONE TO AN AUDIO INTERFACE/SOUND CARD

Connect the microphone to an audio interface with an XLR to XLR cable. This cable is not included with the NMIC1. Ensure the cable is securely connected. The NMIC1 is a dynamic microphone which does not require phantom power; make sure your interface provides sufficient gain for the microphone.

For real-time monitoring, use the headphone output on the audio interface. If you plug headphones into the microphone itself, interface monitoring will not be available.

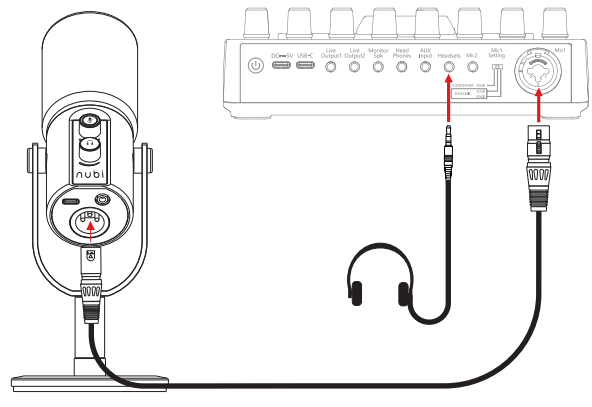

NOISE SUPPRESSION & FUNCTIONING OF ROLLERS

NOISE SUPPRESSION

To turn on noise suppression, long-press the top volume control knob. The LED turns blue. indicate noise suppression is active.

To turn off noise suppression, long-press the top volume control knob again. The LED turns green. indicate noise suppression is off.

GAIN AND MICROPHONE ON/OFF

To increase microphone gain, rotate the top volume control knob clockwise.

To mute the microphone (turn off), tap the the top volume control knob once (short press). The LED will turn red (microphone off).

To unmute (turn the microphone back on), tap the top volume control knob once (short press). The LED will turn green (microphone on).

Note: microphone on/off and noise suppression functions are not available when connected via XLR.

MICROPHONE GAIN AND HEADPHONE VOLUME

- Rotate bottom volume control knob clockwise — increase gain.
- Rotate bottom volume control knob counterclockwise — decrease gain.

CORRECT MICROPHONE POSITIONING

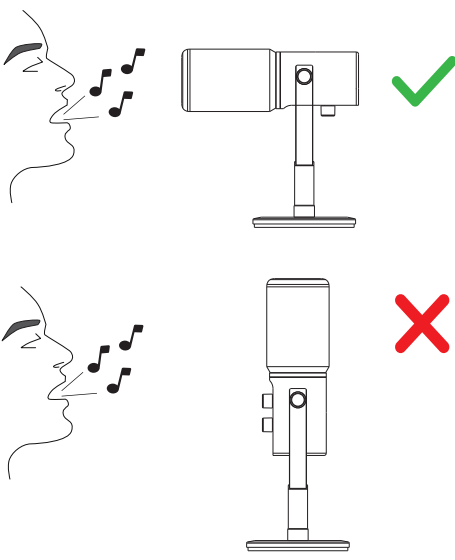

Purpose of product: Computer accessory
Connection: USB-C, XLR
Product material: Metal, ABS
Used for: Sound recording

Manufacturer:
Nubi LTD, Office 3906, 39th, The Center, 99 Queen's Road Central, Central, Hong Kong
EU Importer: FS Holding LTD Profitliilas 4, Germasogeia, Limassol, Cyprus, 4046
E-mail: info@fs-holding.com
Tel: +357 25 26 01 66

UA Імпортер: ТОВ "ФС-Дистрибушн" вул. Чавдар Єлизавети, будинок 13, м/п 394А, 02072, Київ, Україна
E-mail: distribution@fs-d.com.ua
Tel: +38 044 592 4990

The importer is responsible for processing claims from buyers.
Made in China

Date of manufacture: Indicated on the package
Serial number: Indicated on the package

The crossed-out wheellie bin symbol means that you must not dispose of this product with unsorted household waste. Electrical devices can contain harmful substances that may cause environmental damage or harm to your health if not disposed of correctly. Please dispose of these products separately. As the end user, you are required by law to dispose of used electrical equipment at an official recycling point. For information about local recycling points, contact your local authority, civic amenity site, or the business where you purchased this product. By disposing of electrical products at an official recycling point, you are helping ensure that equipment is recycled correctly and professionally, and our environment is protected. Whenever possible, remove any batteries before disposing of the device. Under the law, you risk penalties if you dispose of devices and batteries illegally.

