

CAden
KNOW YOUR PLANS

Demo - Residential Project

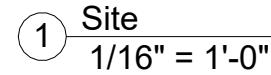



NOTE:
Discrepancies may exist between this plan and the official survey plan. Refer to the survey plan for the current, accurate state of the terrain, including property boundaries, existing structures, and elevations.
For terrain grading immediately surrounding the building, follow the specifications outlined in this plan. However, for overall site grading and drainage, prioritize conformance with the established elevations and contours indicated in the survey plan.

 2503 UNMODIFIED CONTOURS
 2503 DEMOLISHED (PREVIOUS) CONTOURS
 2503 NEW CONTOURS
 SETBACKS
 DOWNSPOUT DROP AND SLOPE ORIENTATION AT GROUND

Stamp

All designs, ideas, arrangements and plans indicated by these drawings and specifications are the property and copyright of the Architect and shall neither be used on any other work nor be used by any other person for any use whatsoever without written permission. Written dimensions shall take precedence over scaled dimension and shall be verified at the job site. Any dimensional discrepancy shall be brought to the attention of the Architect prior to commencement of work.

© 2022

10/13/2025

SITE PLAN

A1.2



Stamp

All designs, ideas, arrangements and plans indicated by these drawings and specifications are the property and copyright of the Architect and shall neither be used on any other work not be used by any other person for any use whatsoever without written permission. Written dimensions shall take precedence over scaled dimension and shall be verified at the job site. Any dimensional discrepancy shall be brought to the attention of the Architect prior to commencement of work.

© 2022

Date 08/19/2025 Issue Concept Design

10/13/2025

Arch. Stamp

MAIN LEVEL

A2

Floor Material Takeoff		
Mark	Name	Area
Main Level (AFF)		
F-01	LVT	2341 SF
F-02	Tile - Default 24x24	165 SF
Upper Level		
F-01	LVT	868 SF

Wall Material Takeoff		
CODE	Material: Name	Material: Area
EWM-01	Board & Batten - SW 6173 Cocoon	3433 SF
EWM-02	Stone - Cream	667 SF

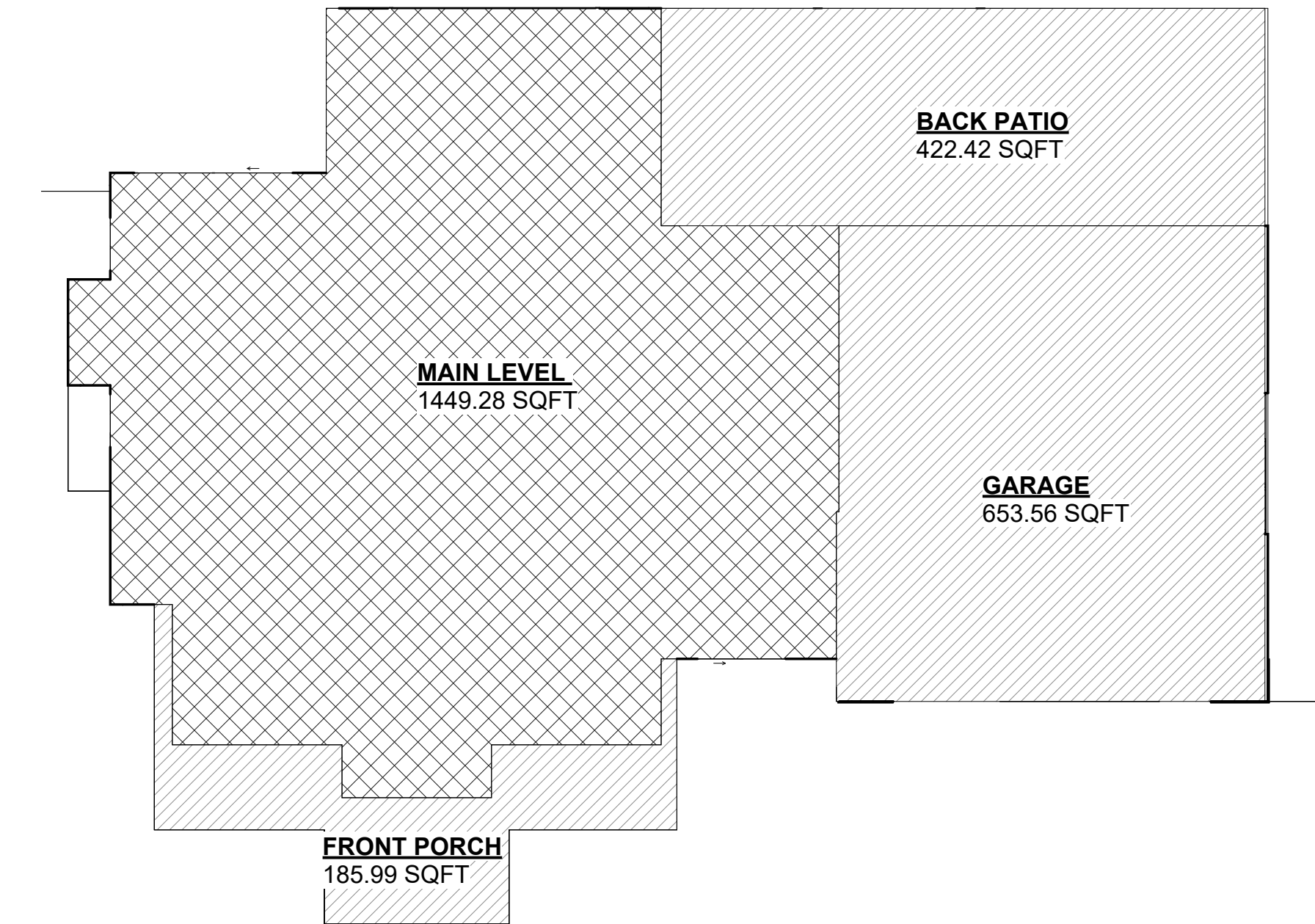
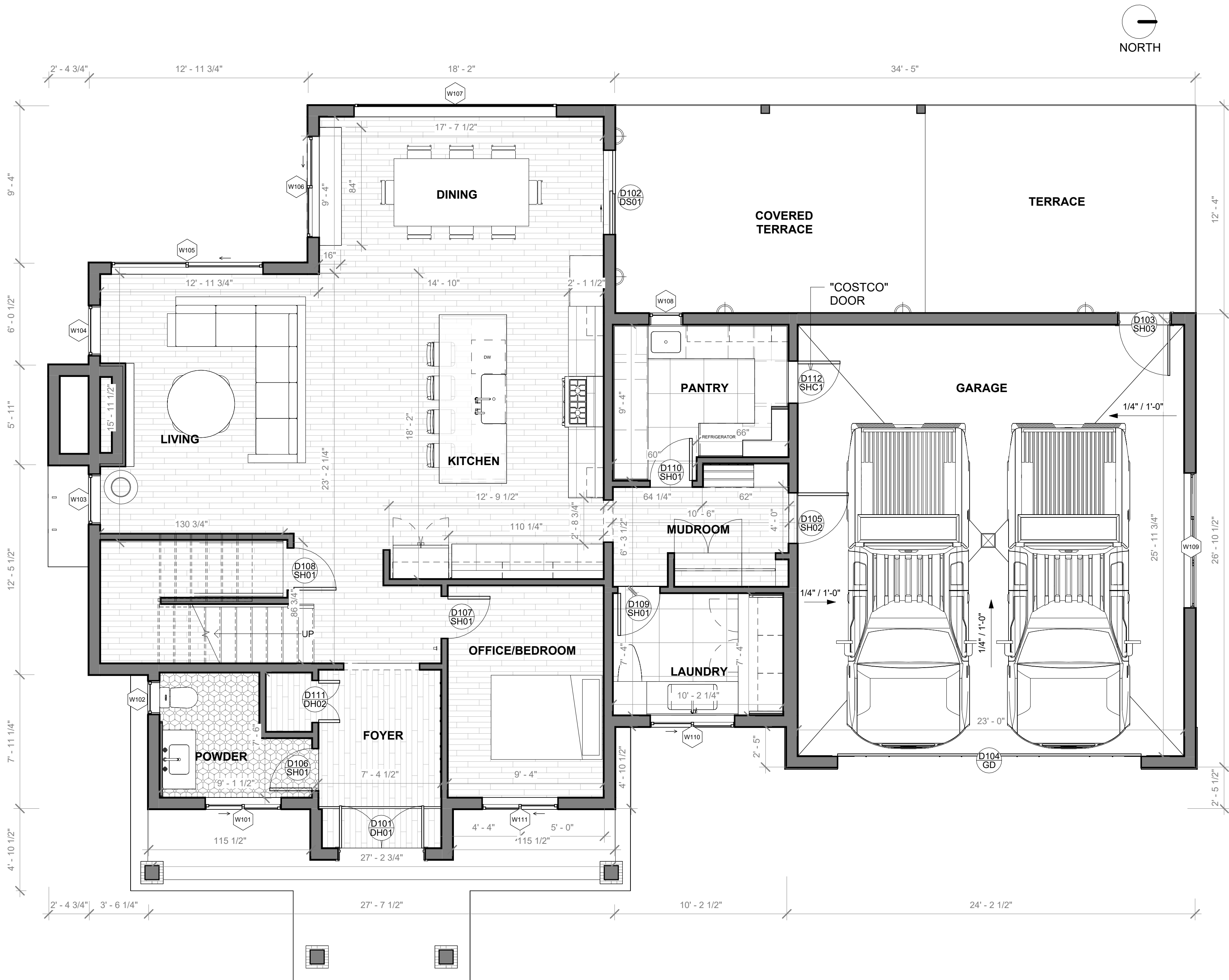

2 AREA CALC
1/8" = 1'-0"

FLOOR MATERIAL LEGEND

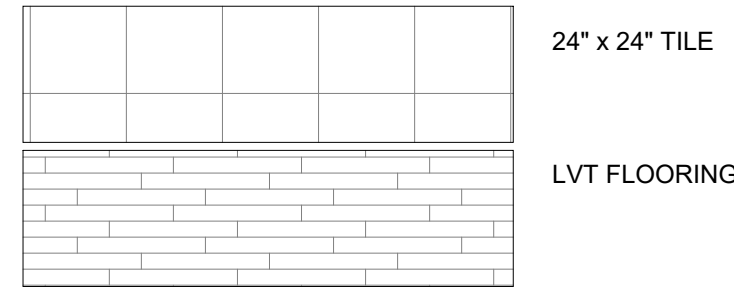

TOTAL AREA CALCULATION

MAIN LEVEL: 1449.28 SF
GARAGE: 653.56 SF
MAIN LEVEL + GARAGE: 2102.84 SF
FRONT PORCH: 185.99 SF
BACK PATIO: 422.42 SF

UPPER LEVEL: 1470.30 SF

TOTAL NO GARAGE 3552.12 SF
TOTAL W/ GARAGE 3573.14 SF

LOT SQFT: 40,667 SF
LOT COVERAGE 5,17%



① Roof
1/4" = 1'-0"

© 2022

10/13/2025

ROOF PLAN

A3

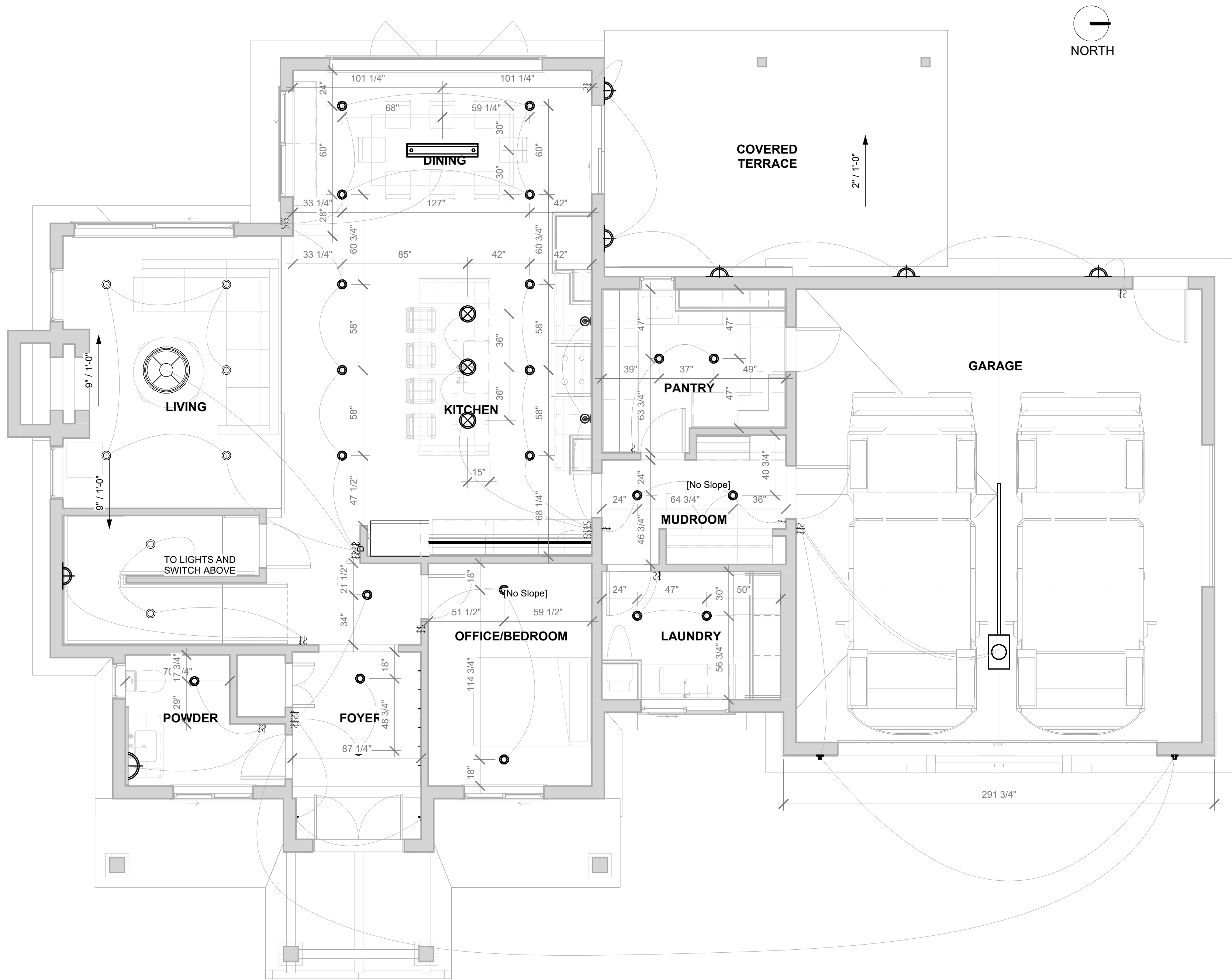

LIGHTING LEGEND	
	Recessed can
	Recessed can (Water resistant)
	Recessed can Directionable (Aimed down)
	Recessed can in soffit (exterior) Directionable - (Aimed down)
	Pendant Light
	Sconce
	Small Counter Recessed can light
	Small Counter Recessed can light
	Living Room - Chandelier
	Dining Room - Chandelier
	Master Bedroom - Chandelier



Stamp

All designs, ideas, arrangements and plans indicated by these drawings and specifications are the property and copyright of the Architect and shall neither be used on any other work nor be used by any other person for any use whatsoever without written permission. Written dimensions shall take precedence over scaled dimension and shall be verified at the job site. Any dimensional discrepancy shall be brought to the attention of the Architect prior to commencement of work.

© 2022

Date	Issue
08/19/2025	Concept Design

10/13/2025

Arch. Stamp

MAIN LEVEL - RCP

A4

LIVING ROOM CHANDELIER REFERENCE



DINING ROOM CHANDELIER REFERENCE





© 2022

10/13/2025

UPPER LEVEL - RCP

A4.1

① Upper Level
1/4" = 1'-0"

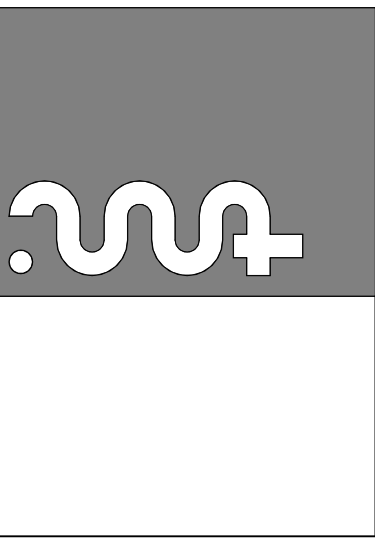

Stamp

© 2022











[illegible]

10/13/2025

Arch. Stamp

**BASEMENT -
RCP**

A4.2

LIGHTING LEGEND	
	Recessed can
	Recessed can (Water resistant)
	Recessed can Directionable (Aimed down)
	Recessed can in soffit (exterior) Directionable - (Aimed down)
	Pendant Light
	Sconce
	Small Counter Recessed can light
	Small Counter Recessed can light
	Living Room - Chandelier
	Dining Room - Chandelier
	Master Bedroom - Chandelier

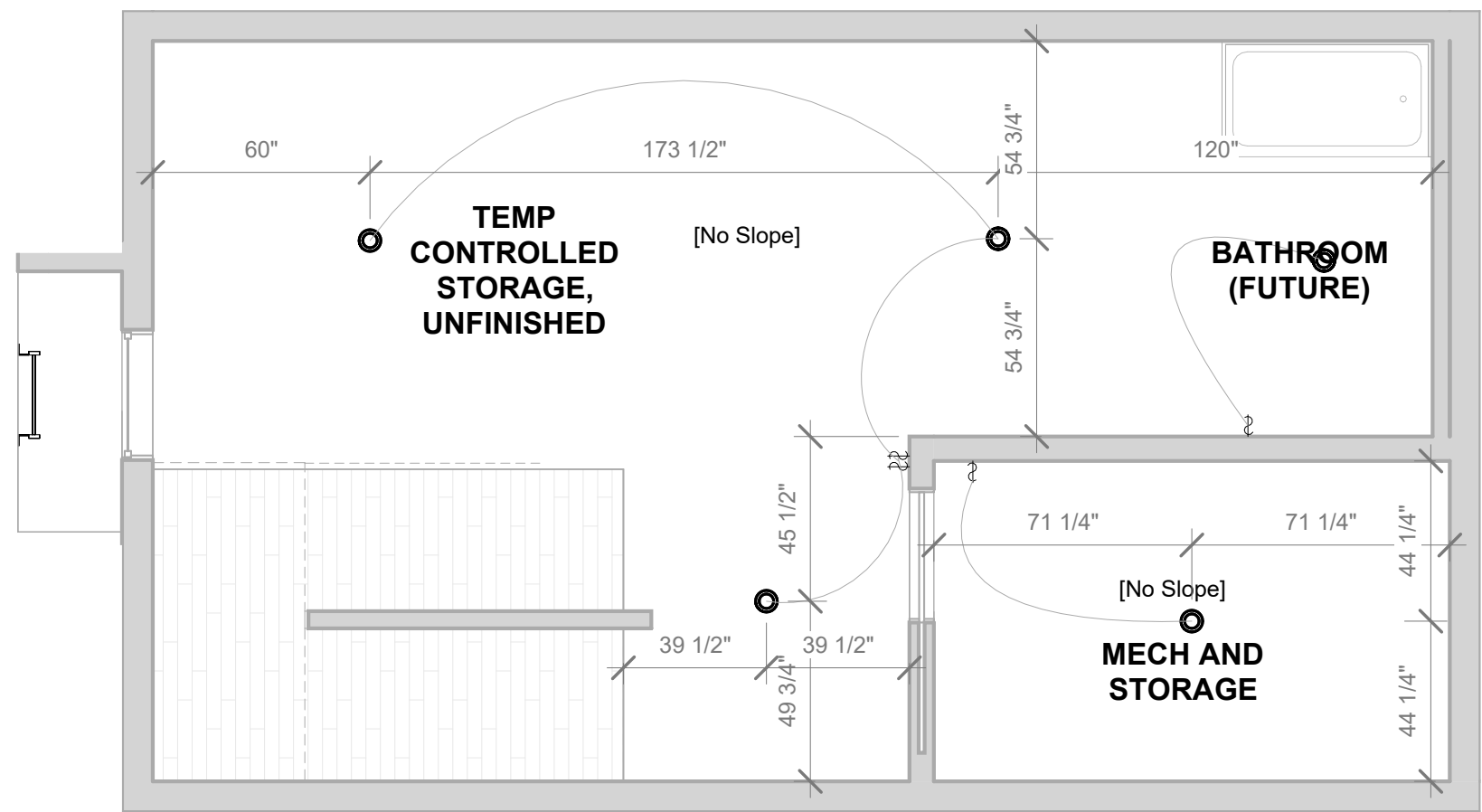

① Basement
1/4" = 1'-0"



② East (Main)
1/4" = 1'-0"



① North
1/4" = 1'-0"

EXTERIOR FACADE MATERIAL LEGEND

	VERTICAL BOARD & BATTEN - 12"
	MASONRY - STONE
	ASPHALT ROOFING - SHINGLE

PAINT AND MATERIAL NOTES:
• FASCIA IN BLACK
• WINDOW FRAMES IN BLACK

Wall Material Takeoff		
CODE	Material: Name	Material: Area
EWM-01	Board & Batten - SW 6173 Cocoon	3433 SF
EWM-02	Stone - Cream	667 SF



Stamp

All designs, ideas, arrangements and plans indicated by these drawings and specifications are the property and copyright of the Architect and shall neither be used on any other work nor be used by any other person for any use whatsoever without written permission. Written dimensions shall take precedence over scaled dimension and shall be verified at the job site. Any dimensional discrepancy shall be brought to the attention of the Architect prior to commencement of work.

© 2022

Date	Issue
08/19/2025	Concept Design

10/13/2025

Arch. Stamp

ELEVATIONS

A5



EXTERIOR FACADE MATERIAL LEGEND

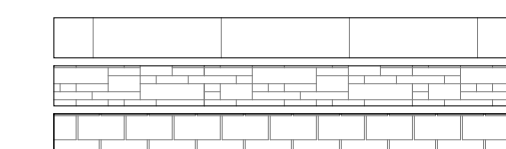

VERTICAL BOARD & BATTEN - 12"
MASONRY - STONE
ASPHALT ROOFING - SHINGLE

PAINT AND MATERIAL NOTES:

- FASCIA IN BLACK
- WINDOW FRAMES IN BLACK

Wall Material Takeoff		
CODE	Material: Name	Material: Area
EWM-01	Board & Batten - SW 6173 Cocoon	3433 SF
EWM-02	Stone - Cream	667 SF

All designs, ideas, arrangements and plans indicated by these drawings and specifications are the property and copyright of the Architect and shall neither be used on any other work nor be used by any other person for any use whatsoever without written permission. Written dimensions shall take precedence over scale dimension and shall be verified at the job site. Any dimensional discrepancy shall be brought to the attention of the Architect prior to commencement of work.

© 2022

[illegible]

10/13/2025

Arch. Stamp

ELEVATIONS

A5.1



② South
 $\frac{1}{4}" = 1'-0"$



Stamp

designs, ideas, arrangements and plans created by these drawings and specifications, the property and copyright of the Architect shall neither be used on any other work nor be used by any other person for any use whatsoever without written permission. Written dimensions shall take precedence over scaled dimension and shall be verified at the job site. Any dimensional discrepancy shall be brought to the attention of the Architect prior to commencement of work.

122

ate	Issue
19/2025	Concept Design

0/13/2025

Arch. Stamp

SECTIONS

A6

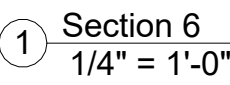
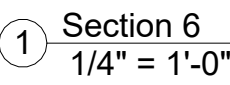

2 Section 1
1/4" = 1'-0"



stamp

designs, ideas, arrangements and plans created by these drawings and specifications. The property and copyright of the Architect shall neither be used on any other work nor be used by any other person for any use whatsoever without written permission. Written dimensions shall take precedence over scaled dimensions and shall be verified at the job site. Any dimensional discrepancy shall be brought to the attention of the Architect prior to commencement of work.

122

[illegible]

0/13/2025

Arch. Stamp

SECTIONS

A6.1

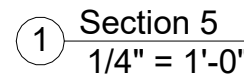

1 Section 5
1/4" = 1'-0"

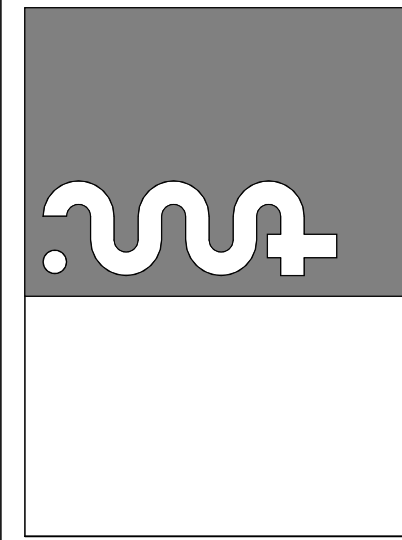

Stamp

All designs, ideas, arrangements and plans indicated by these drawings and specifications are the property and copyright of the Architect and shall neither be used on any other work nor be used by any other person for any use whatsoever without written permission. Written dimensions shall take precedence over scaled dimension and shall be verified at the job site. Any dimensional discrepancy shall be brought to the attention of the Architect prior to commencement of work.

© 2022

[illegible]

10/13/2025
Arch. Stamp

SCHEDULES

A7

Door Schedule									
Mark	Type	Unit Width	Unit Height	Rough Height	Rough Width	Operation	Function	Level	Comments

Basement									
D001	SP01	36"	80"	84 1/2"	73"	RS	Interior	Basement	
Main Level (AFF)									
D101	DH01	60"	96"	96 31/32"	61 31/32"		Exterior	Main Level (AFF)	
D102	DS01	60"	96"			LS	Exterior	Main Level (AFF)	
D103	SH03	36"	80"	81"	38"		Exterior	Main Level (AFF)	
D104	GD	216"	96"	98 1/2"	218"	Single-Panel Tilt-up	Exterior	Main Level (AFF)	
D105	SH02	36"	80"			LH	Interior	Main Level (AFF)	
D106	SH01	30"	80"			LHR	Interior	Main Level (AFF)	
D107	SH01	30"	80"			LHR	Interior	Main Level (AFF)	
D108	SH01	30"	80"			LHR	Interior	Main Level (AFF)	
D109	SH01	30"	80"			LHR	Interior	Main Level (AFF)	
D110	SH01	30"	80"			LHR	Interior	Main Level (AFF)	
D111	DH02	30"	80"				Interior	Main Level (AFF)	
D112	SHC1	30"	36"				Interior	Main Level (AFF)	
Upper Level									
D2C1	SG03	48"	84"	85"	50"		Interior	Upper Level	
D2C2	SG03	48"	84"	85"	50"		Interior	Upper Level	
D2G1	SG01	26 5/8"	105"			SSS	Interior	Upper Level	
D201	SH01	30"	80"			LHR	Interior	Upper Level	
D202	SH01	30"	80"			LHR	Interior	Upper Level	
D203	SH01	30"	80"			LHR	Interior	Upper Level	
D204	SH01	30"	80"			LHR	Interior	Upper Level	
D205	SH01	30"	80"			LHR	Interior	Upper Level	
D206	SH01	30"	80"			LHR	Interior	Upper Level	
D207	1B01	36"	96"			Barn Sliding - Single	Interior	Upper Level	

Window Schedule									
Mark	Operation	Width	Height	Rough Height	Rough Width	Sill Height	Window Material	Level	Comments

W001	Fixed - Single Panel	36"	66"			36"	Clear Panel	Basement	
W101	Sliding - Double Panel	54"	72"	72 1/2"	54 1/2"	24"	Panel + Grid	Main Level (AFF)	
W102	Fixed - Single Panel	24"	48"			40"	Clear Panel	Main Level (AFF)	
W103	Fixed - Single Panel	36"	84"			24"	Clear Panel	Main Level (AFF)	
W104	Fixed - Single Panel	36"	84"			24"	Clear Panel	Main Level (AFF)	
W105	Sliding - Double Panel	108"	84"	84 1/2"	108 1/2"	24"	Panel + Grid	Main Level (AFF)	
W106	Sliding - Double Panel	72"	66"	66 1/2"	72 1/2"	42"	Panel + Grid	Main Level (AFF)	
W107	Fixed - Single Panel	144"	84"	84 1/2"	144 1/2"	24"	Panel + Grid	Main Level (AFF)	
W108	Fixed - Single Panel	24"	66"			42"	Clear Panel	Main Level (AFF)	
W109	Sliding - Triple Panel	96"	48"			48"	Clear Panel	Main Level (AFF)	
W110	Sliding - Double Panel	60"	60"	60 1/2"	60 1/2"	36"	Panel + Grid	Main Level (AFF)	
W111	Sliding - Double Panel	54"	72"	72 1/2"	54 1/2"	24"	Panel + Grid	Main Level (AFF)	
W211	Fixed - Single Panel	24"	24"			156"	Clear Panel	Main Level (AFF)	
W201	Sliding - Double Panel	54"	36"	36 1/2"	54 1/2"	70"	Panel + Grid	Upper Level	
W202	Sliding - Double Panel	54"	48"	48 1/2"	54 1/2"	40"	Panel + Grid	Upper Level	
W203	Fixed - Single Panel	36"	72"			12"	Clear Panel	Upper Level	
W204	Fixed - Single Panel	36"	72"			12"	Clear Panel	Upper Level	
W205	Fixed - Single Panel	108"	72"	72 1/2"	108 1/2"	12"	Panel + Grid	Upper Level	
W206	Sliding - Double Panel	72"	72"	72 1/2"	72 1/2"	12"	Panel + Grid	Upper Level	
W207	Casement (RH) Single Panel	36"	60"	60 1/2"	36 1/2"	24"	Clear Panel	Upper Level	
W208	Fixed - Single Panel	36"	60"			24"	Clear Panel	Upper Level	
W209	Casement (LH) Single Panel	36"	60"	60 1/2"	36 1/2"	24"	Clear Panel	Upper Level	
W210	Sliding - Double Panel	54"	48"	48 1/2"	54 1/2"	36"	Panel + Grid	Upper Level	
W212	Sliding - Double Panel	54"	72"	72 1/2"	54 1/2"	40"	Panel + Grid	Upper Level	
W213	Sliding - Double Panel	54"	48"	48 1/2"	54 1/2"	40"	Panel + Grid	Upper Level	

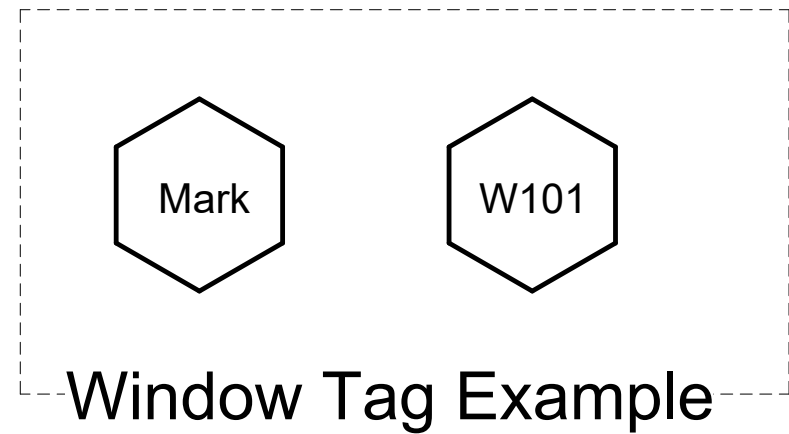
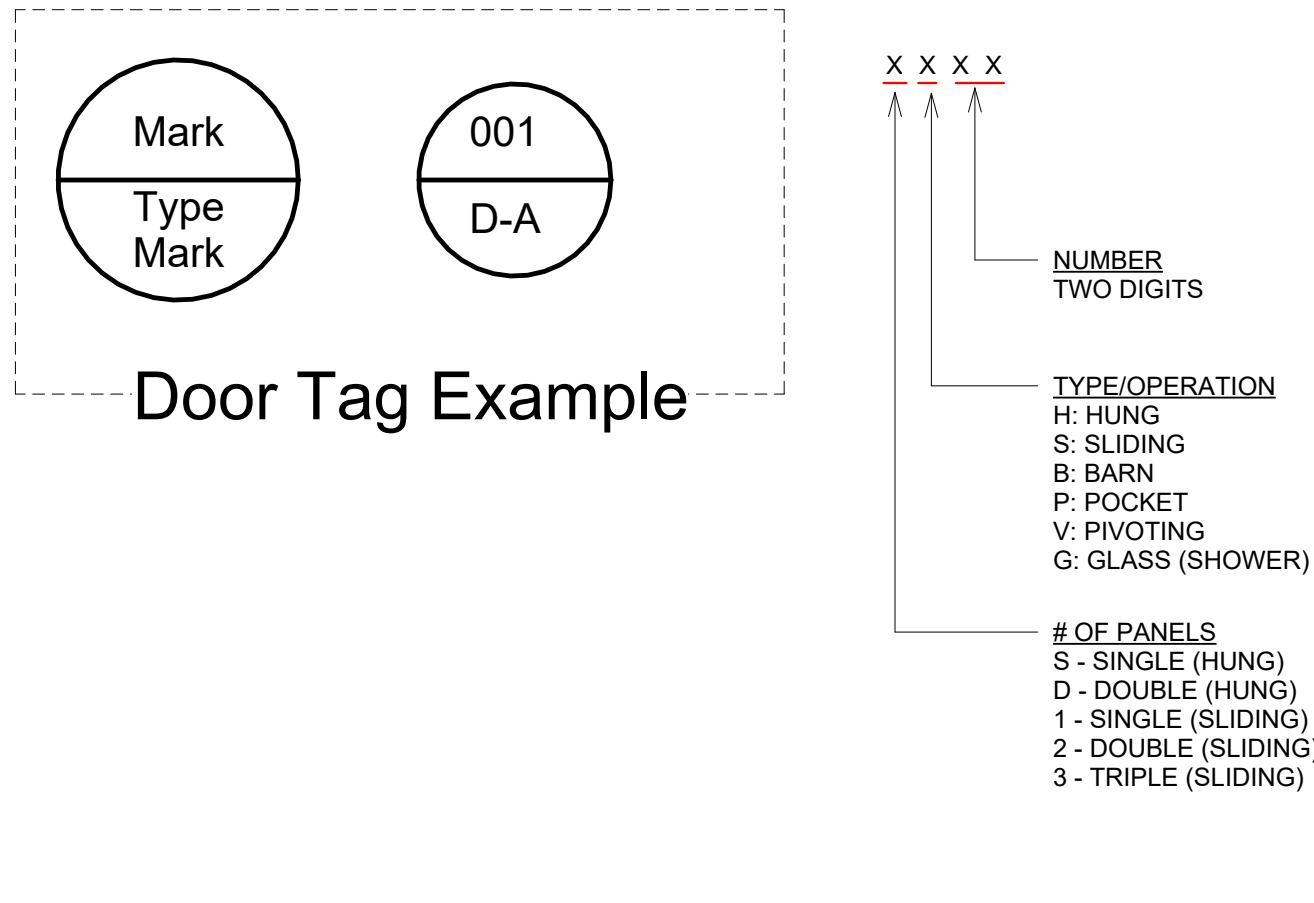

Plumbing Fixture Schedule		
Type Comments	Count	Phase Created
	14	New Construction
	5	New Construction
2 Inch Solvent Weld Outlet with Option -P Trap Primer	1	New Construction
Shower Stall - 40x40	1	New Construction
Showerhead on Hose	2	New Construction
Toilet	4	New Construction

- DOOR & WINDOW SCHEDULE NOTES**
- ROUGH OPENING DIMENSIONS (R.O.): ALL ROUGH WIDTH (R.W.) AND ROUGH HEIGHT (R.H.) VALUES PROVIDED ARE ESTIMATED BASED ON TYPICAL DOOR TYPES.
 - VALUES FOR DOOR AND WINDOW SCHEDULES ARE FINAL. THE ACTUAL ROUGH OPENING DIMENSIONS ARE DEPENDENT ON THE SPECIFIC DOOR MANUFACTURER'S REQUIREMENTS.
 - VERIFICATION REQUIRED: VERIFY ALL ROUGH OPENING DIMENSIONS DIRECTLY WITH THE SELECTED DOOR MANUFACTURER PRIOR TO FRAMING OR ORDERING.
 - ARCHITECT NOTIFICATION: NOTIFY THE ARCHITECT IMMEDIATELY IF ANY DISCREPANCIES OR REQUIRED CHANGES TO THE LISTED DIMENSIONS ARE IDENTIFIED AFTER MANUFACTURER VERIFICATION.

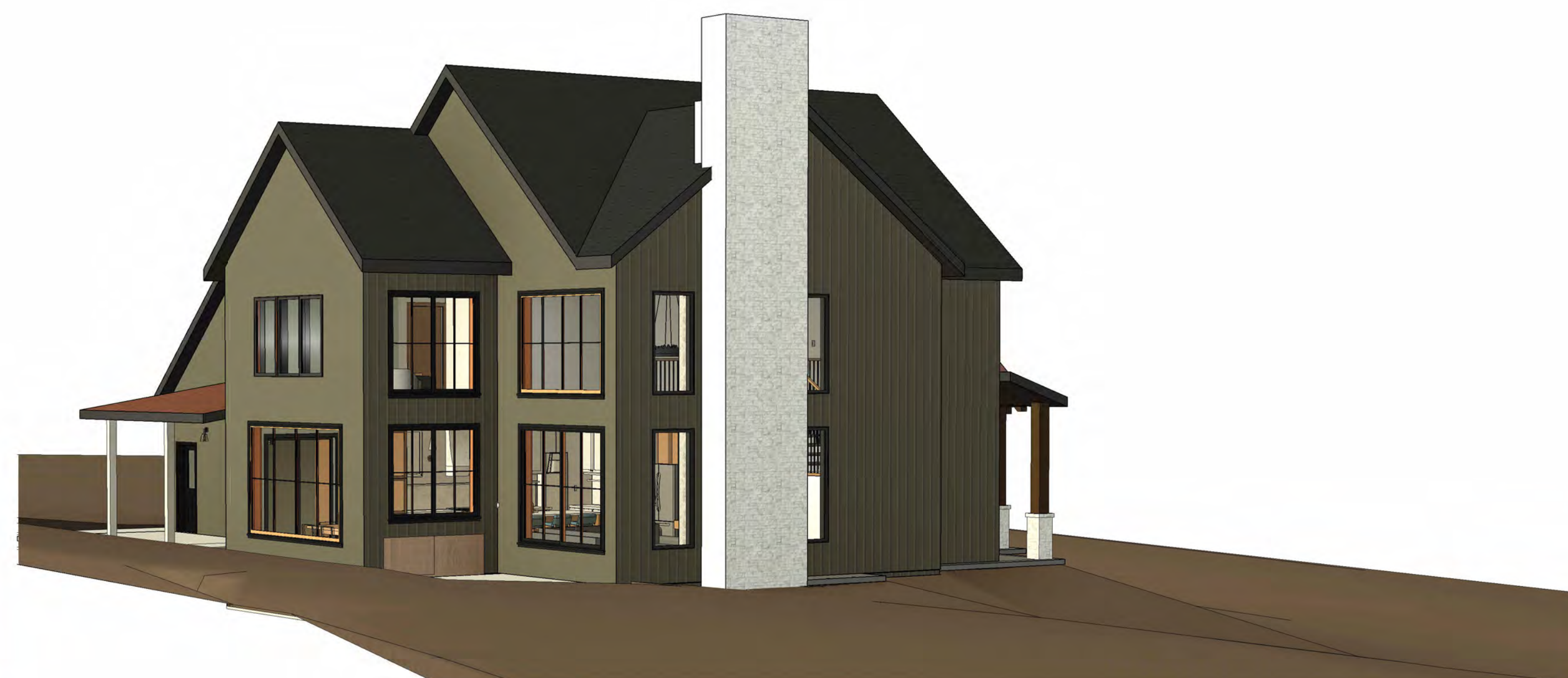
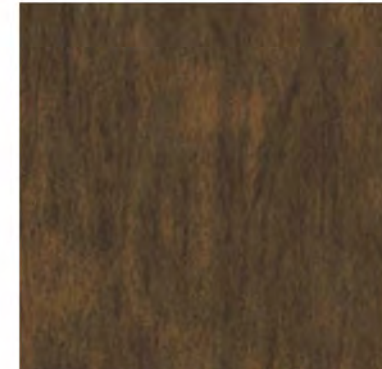
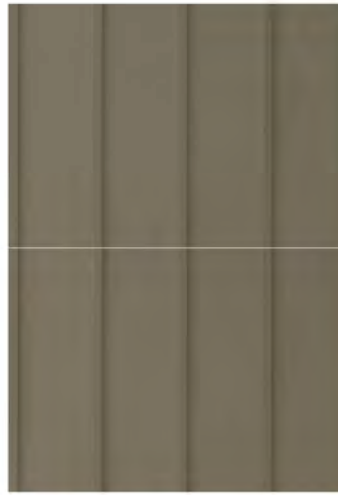

stamp

designs, ideas, arrangements and plans created by these drawings and specifications, the property and copyright of the Architect shall neither be used on any other work nor be used by any other person for any use whatsoever without written permission. Written consents shall take precedence over scaled dimensions and shall be verified at the job site. Any dimensional discrepancy shall be brought to the attention of the Architect prior to commencement of work.

122

[illegible]

0/13/2025

Arch. Stamp

D VIEWS

A9