

# COAXIAL LAND ROGUE

## CR-200-12.7-L REMOTELY OPERATED GUN AND OBSERVATION SYSTEM

Land Rogue is a product line of remotely controlled weapon systems developed for use on Armored Vehicles and Point-Defence installations. Featuring calibres from 7.62mm to 30mm and technology such as optical target tracking, stabilised aiming, range finding, thermal vision and more, built into a low maintenance platform, ready for integration into modern Battle/Combat Management Systems.

**ERA****F**

شركة إيرااف الصناعية المحدودة  
ERA F Industrial Company Ltd.

Specifications are subject to change without notice. Consult manufacturer for latest specifications. All manufacturing rights reserved. This document is for information only and shall not form part of any contract.

# SPECIFICATIONS

## FEATURES

- Coaxial weapon application
- Remote operation
- Optical target tracking
- Fibre optic gyro-stabilised aiming
- Night & day operation, Uncooled IR Sight
- Fire control software
- Low maintenance, ease of operation

## ARMAMENT

- 12.7mm x 99mm Heavy Machine Gun (HMG)
- 7.62mm x 51mm General Purpose Machine Gun
- Fire modes: Single, Rapid Single, Automatic

## GUN CONTROL

- Traverse coverage:  $n \times 360^\circ$
- Elevation:  $-20^\circ$  to  $+50^\circ$
- Programmable no-go & no-fire zones
- Slew rates: up to 1 rad/s ( $\approx 60^\circ/\text{s}$ )
- Low speed:  $< 0.5 \text{ mrad/s}$  ( $\approx 0.028^\circ/\text{s}$ )

## INTERFACE & POWER REQUIREMENTS

- Integration with MMS/BMS/CMS (optional)
- Video recording (optional)
- Multi-function display with software defined keys:
  - Mode selection and display
  - Burst length display
  - Armed or safe display
  - Round count display
  - Error messages
  - Gun position indicator
- Hand Controller keys:
  - System on/off switch and indicator
  - Armed/safe switch and indicator
  - Optical tracking control
  - Trigger
- 24V at 50A (Peak Pulse)
- Manual operation in case of power or system failure

## OBSERVATION / SIGHTING

- Standard: zoom CCD day sensor
- Uncooled Thermal imaging sensor
- Laser range finder (LRF)

## DIMENSIONS

- External mount: 280kg MAX
- Display & hand controller: 15kg

## AMMUNITION

- 12,7mm 200 Rounds
- 7,62mm 300 Rounds

# ILLUSTRATIONS

## SYSTEM LAYOUT

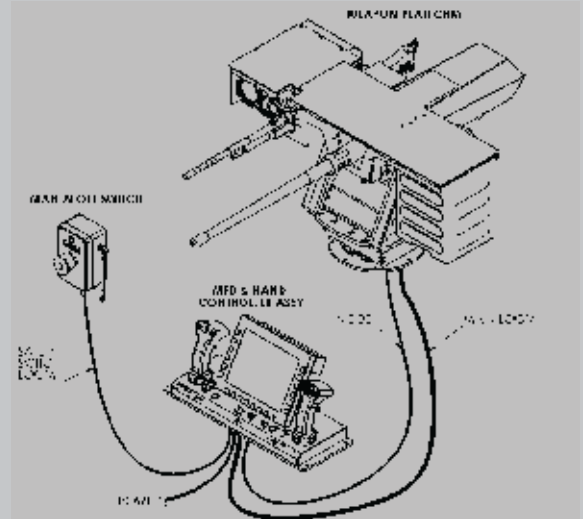

## SYSTEM SIZE

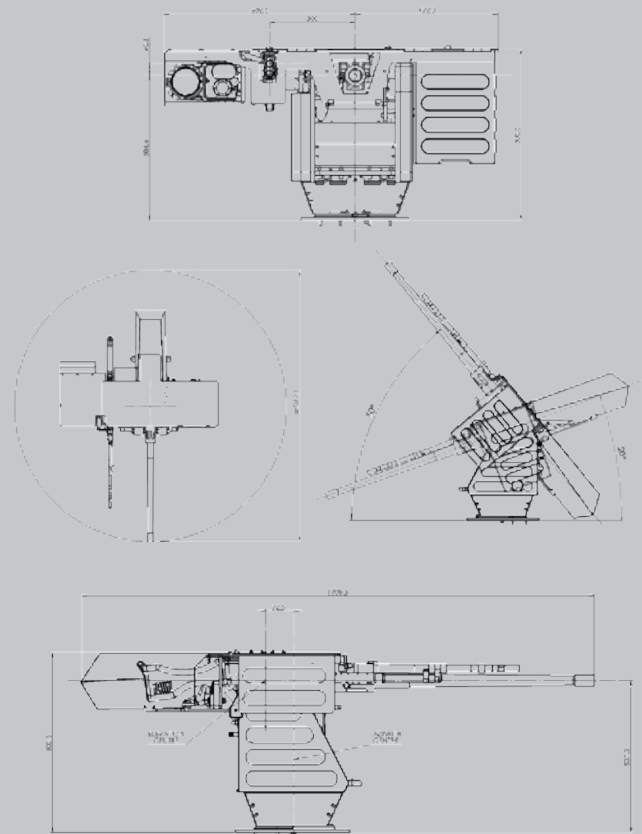

**ERAF**

شركة إراف الصناعية المحدودة  
ERAF Industrial Company Ltd.

المكتب الرئيسي: شارع الإحساء ص.ب. ٢٧. ٢١ - الرياض ١١٤١٧  
ت: ٤٧٦٣١٦٣ ١١ ٩٦٦ + ف: ٤٧٦.٩٨٩ ١١ ٩٦٦ +  
ب: [www.eraf.com](http://www.eraf.com) | [eraf@eraf.com](mailto:eraf@eraf.com)

Specifications are subject to change without notice. Consult manufacturer for latest specifications. All manufacturing rights reserved. This document is for information only and shall not form part of any contract.



# LAND ROGUE LITE

## RL-7.62 LA REMOTELY OPERATED GUN AND OBSERVATION SYSTEM

SeaRogue is a product line of remotely controlled weapon systems developed for use on Naval Vessels ranging from coast guard patrol boats to Corvettes and Cruisers. Featuring calibres from 7,62mm to 30mm and technology such as automated target tracking, stabilised aiming, range finding, thermal vision and more, built into a low maintenance and low cost platform, ready for integration into modern Combat Management Systems.

**ERA****AF**

شركة إيرااف الصناعية المحدودة  
ERA Industrial Company Ltd.

Specifications are subject to change without notice. Consult manufacturer for latest specifications. All manufacturing rights reserved. This document is for information only and shall not form part of any contract.

# SPECIFICATIONS

## FEATURES

- Remote operation from cabin
- Gyro-stabilised aiming
- Night & day operation
- Fire control software
- Low maintenance, ease of operation
- Automated optical target tracking (optional)

## ARMAMENT

- 7.62mm GPMG

## GUN CONTROL

- Traverse coverage: nx360°
- Elevation: -20° to +62°
- Programmable no-go & no-fire zones
- Slew rates: up to 1 rad/s ( $\approx 60^\circ/\text{s}$ )
- Low speed:  $< 0.5 \text{ mrad/s}$  ( $\approx 0.028^\circ/\text{s}$ )

## INTERFACE & POWER REQUIREMENTS

- Multi-function display with software defined keys:
  - Mode selection and display
  - Burst length display
  - Armed or safe display
  - Round count display
  - Error messages
  - Gun position indicator
- Handcontroller keys:
  - System on/off switch and indicator
  - Armed/safe switch and indicator
  - Trigger
- 24V @ 30A Peak
- Integration with CMS (optional)
- Video recording (optional)
- Shot Detector (optional)

## OBSERVATION/SIGHTING

- Day Sight : Zoom CCD Day Sight
- Night sight : Fixed FOV Uncooled Thermal Imaging
- Laser range finder (LRF)

## DIMENSIONS

- External mount: 90kg (including 7.62mm weapon & ammunition)
- Display & hand controller: 10kg
- Sweep Radius  $< 600\text{mm}$
- Height  $< 620\text{mm}$

## AMMUNITION

- 400 Rounds (7.62mm)
- Remote auto cocking

# ILLUSTRATIONS

## SYSTEM DIAGRAM

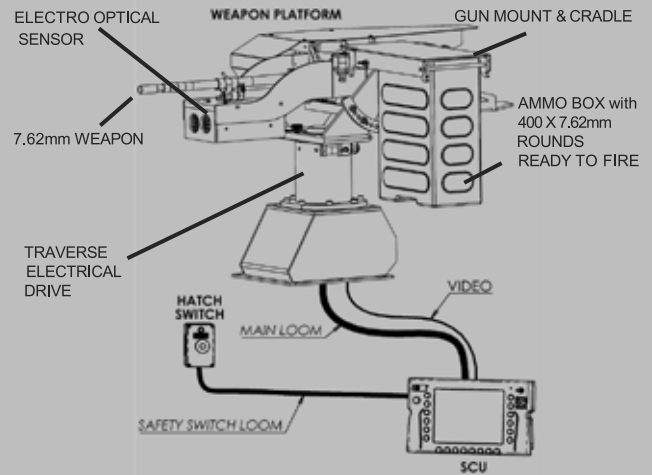

## SYSTEM SIZE

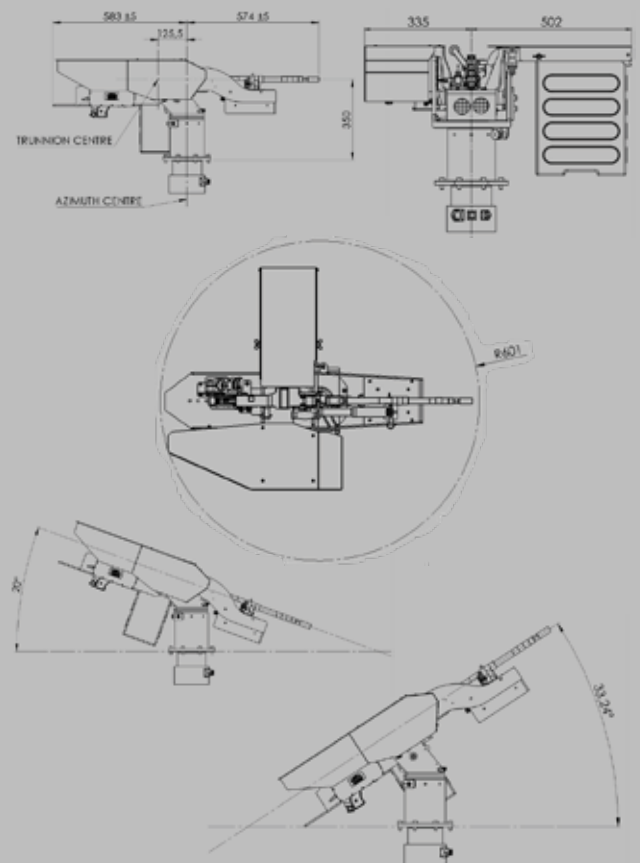



# LAND ROGUE

## R-200-12.7-L REMOTELY OPERATED GUN AND OBSERVATION SYSTEM

The Land Rogue is product line of remotely controlled weapon systems developed for use on Armoured Vehicles and Point-Defence Installations. Featuring calibres from 7,62mm to 30mm and technology such as automated target tracking, stabilised aiming, range finding, thermal vision and more, built into a low maintenance and low cost platform, ready for integration into modern Combat Management Systems.

**ERAF**  
شركة إيرااف الصناعية المحدودة  
ERAF Industrial Company Ltd.

Specifications are subject to change without notice. Consult manufacturer for latest specifications. All manufacturing rights reserved. This document is for information only and shall not form part of any contract.

# SPECIFICATIONS

## FEATURES

- Remote operation from cabin
- Automated optical target tracking
- Fibre optic gyro-stabilised aiming
- Night & day operation, Uncooled IR Sight
- Fire control software
- Low maintenance, ease of operation

## ARMAMENT

- 12.7mm HMG cannon
- 7.62mm GPMG (optional)
- 76mm Smoke launcher Kit (optional)

## GUN CONTROL

- Traverse coverage: nx360°
- Elevation: -40° to +60°
- Programmable no-go & no-fire zones
- Slew rates: up to 1 rad/s ( $\approx 60^\circ/\text{s}$ )
- Low speed:  $< 0.5 \text{ mrad/s}$  ( $\approx 0.028^\circ/\text{s}$ )
- Manually operable

## INTERFACE & POWER REQUIREMENTS

- Integration with CMS (optional)
- Video recording (optional)
- Multi-function display with software defined keys:
  - Mode selection and display
  - Burst length display
  - Armed or safe display
  - Round count display
  - Error messages
  - Gun position indicator
- Handcontroller keys:
  - System on/off switch and indicator
  - Armed/safe switch and indicator
  - Trigger
- 24V @ 50A Peak Pulse

## OBSERVATION/SIGHTING

- Day Sight : CCD Day Sight
- Night sight : Cooled/Uncooled Thermal Imaging
- Laser range finder (LRF)

## DIMENSIONS

- External mount: 220kg (including 12.7mm weapon & ammunition)
- Display & hand controller: 15kg
- Length : 1654mm @ horizontal elevation
- Height : 639mm @ horizontal elevation

## AMMUNITION

- 200 Rounds (12.7mm)
- 400 Rounds (7.62mm) (optional)
- 4 Smoke Launchers (optional)

# ILLUSTRATIONS

## SYSTEM DIAGRAM

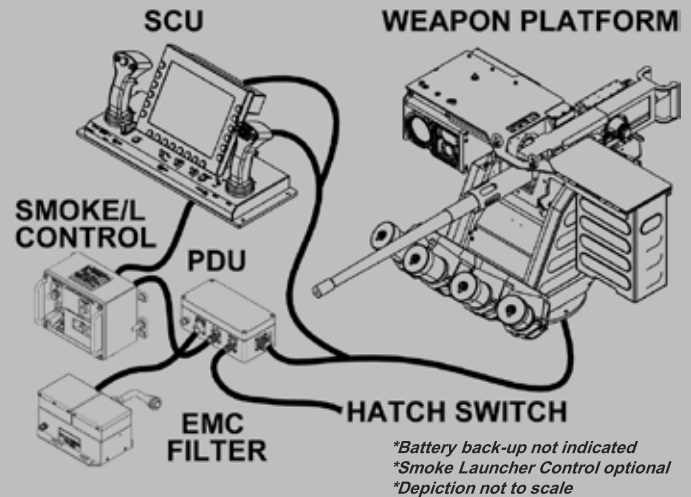

## SYSTEM SIZE

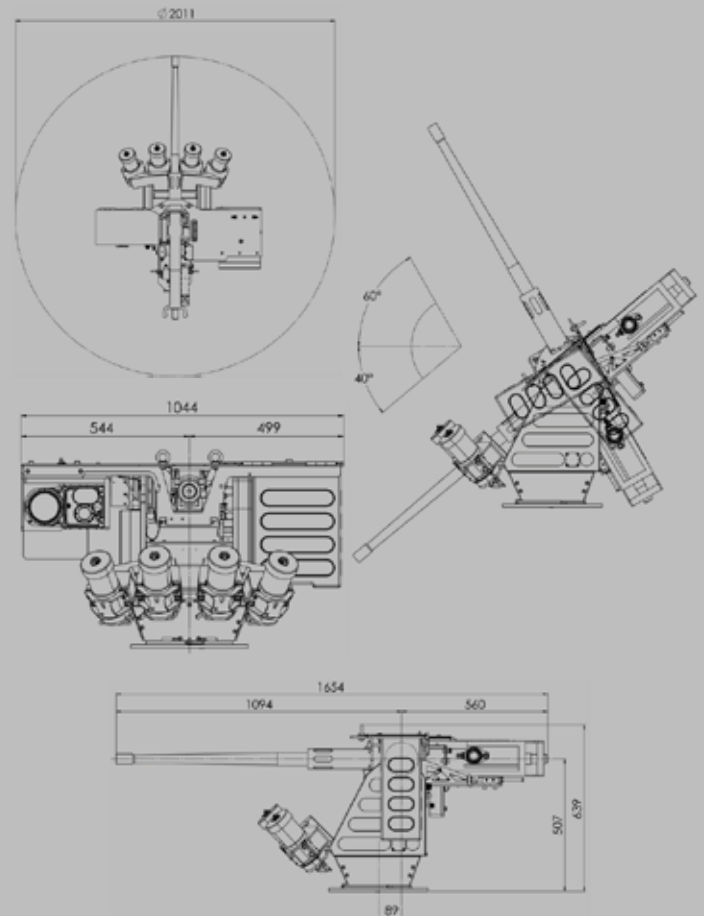





# LAND ROGUE - DL

## DEFA 30mm REMOTELY OPERATED GUN AND OBSERVATION SYSTEM

The Land Rogue is product line of remotely controlled weapon systems developed for use on Armoured Vehicles and Point-Defence Installations. Featuring calibres from 7,62mm to 30mm and technology such as automated target tracking, stabilised aiming, range finding, thermal vision and more, built into a low maintenance and low cost platform, ready for integration into modern Combat Management Systems.

**ERAFA**  
شركة إيرااف الصناعية المحدودة  
ERAFA Industrial Company Ltd.

Specifications are subject to change without notice. Consult manufacturer for latest specifications. All manufacturing rights reserved. This document is for information only and shall not form part of any contract.

# SPECIFICATIONS

## FEATURES

- Remote operation by bridge personnel
- Automated optical target tracking
- Fibre optic gyro-stabilised aiming
- Night & day operation
- Fire control software
- Low maintenance, ease of operation

## ARMAMENT

- DEFA 30mm x 113mm cannon
- Muzzle velocity: 815m/s
- Rate of fire: 1200+ RPM

## GUNCONTROL

- Traverse coverage:  $n \times 360^\circ$
- Elevation:  $-20^\circ$  to  $+35^\circ$
- Programmable no-go & no-fire zones
- Slew rates: up to 1 rad/s ( $\approx 60^\circ/\text{s}$ )
- Low speed:  $< 0.5 \text{ mrad/s}$  ( $\approx 0.028^\circ/\text{s}$ )

## INTERFACE & POWER REQUIREMENTS

- Integration with CMS (optional)
- Video recording (optional)
- Multi-function display with software defined keys:
  - Mode selection and display
  - Burst length display
  - Armed or safe display
  - Round count display
  - Error messages
  - Gun position indicator
- Hand controller keys:
  - System on/off switch and indicator
  - Armed/safe switch and indicator
  - Optical tracking control
  - Trigger

## OBSERVATION/SIGHTING

- Standard: zoom CCD day sight
- 2x FOV thermal imaging night sight
- Laser range finder (LRF)
- Interface to separate stabilised sight (optional)

## DIMENSIONS

- External mount: 600kg MAX
- Display & hand controller: 15kg
- Electronic controller: 50kg
- Trunnion centre: 1300mm
- Total height: 1000mm

## AMMUNITION

- 100 Rounds (30mm x 113mm)
- Wide range of ammunition types available

# ILLUSTRATIONS

## DISPLAY & CONTROLLER



## SYSTEM SIZE



## SYSTEM DIAGRAM

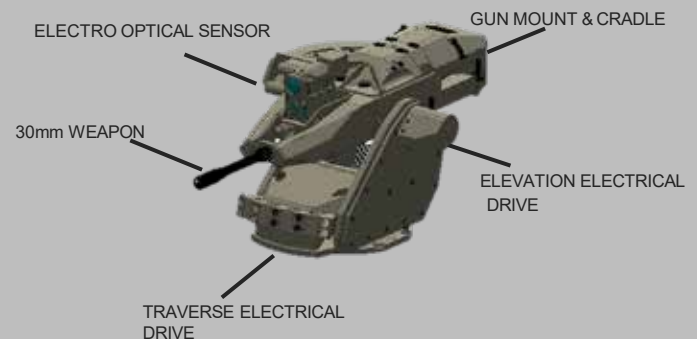





# SUPER ROGUE

## SR-500-20-L REMOTELY OPERATED GUN AND OBSERVATION SYSTEM

The Land Rogue is product line of remotely controlled weapon systems developed for use on Armoured Vehicles and Point-Defence Installations. Featuring calibres from 7,62mm to 30mm and technology such as automated target tracking, stabilised aiming, range finding, thermal vision and more, built into a low maintenance and low cost platform, ready for integration into modern Combat Management Systems.

**ERAF**  
شركة إيرااف الصناعية المحدودة  
ERAF Industrial Company Ltd.

Specifications are subject to change without notice. Consult manufacturer for latest specifications. All manufacturing rights reserved. This document is for information only and shall not form part of any contract.

# SPECIFICATIONS

## FEATURES

- Remote operation from cabin
- Automated optical target tracking
- Fibre optic gyro-stabilised aiming
- Night & day operation
- Fire control software
- Low maintenance, ease of operation

## ARMAMENT

- Rheinmetall KAE 20mm x 128mm
- Muzzle Velocity: 1050m/s
- Rate of Fire: ARS

## GUN CONTROL

- Traverse coverage: nx360°
- Elevation: -15° to +32°
- Programmable no-go & no-fire zones
- Slew rates: up to 1 rad/s ( $\approx 60^\circ/\text{s}$ )
- Low speed:  $< 0.5 \text{ mrad/s}$  ( $\approx 0.028^\circ/\text{s}$ )
- Manually operable

## INTERFACE & POWER REQUIREMENTS

- Integration with CMS (optional)
- Video recording (optional)
- Multi-function display with software defined keys:
  - Mode selection and display
  - Burst length display
  - Armed or safe display
  - Round count display
  - Error messages
  - Gun position indicator
- Handcontroller keys:
  - System on/off switch and indicator
  - Armed/safe switch and indicator
  - Trigger
- 228V @ 1200W Peak, 350W Average

## OBSERVATION/SIGHTING

- Day Sight : Zoom CCD
- Night sight : 2x FOV thermal – cooled/uncooled
- Laser range finder (LRF)

## DIMENSIONS

- External mount: 550kg (Excluding Weapon and Ammunition)
- Controller: 45kg
- Control Console: 15kg
- Length : 2680mm @ horizontal elevation
- Height : 800mm @ horizontal elevation

## AMMUNITION

- 200 Rounds (20mm x 128mm)
- Remote auto cocking

# ILLUSTRATIONS

## SYSTEM DIAGRAM

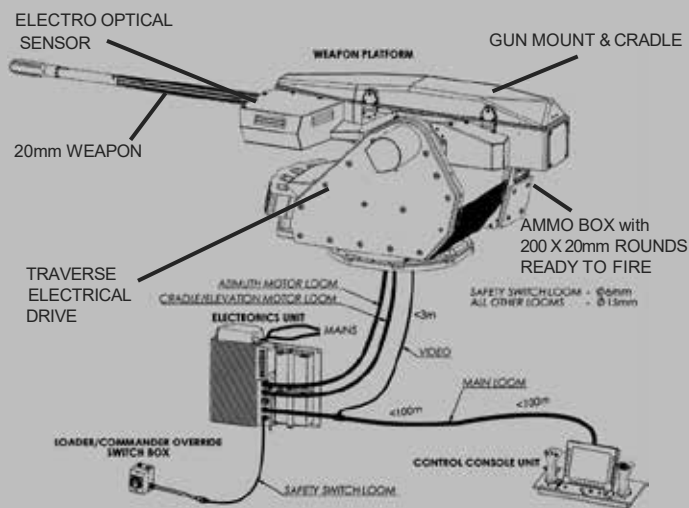

## SYSTEM SIZE

