



KU 09 L

Coupler

Ø 4 mm

30 V_{AC} / 60 V_{DC}

32 A

- with solder terminal for cables up to 2.5 mm²
- with sleeve, unassembled

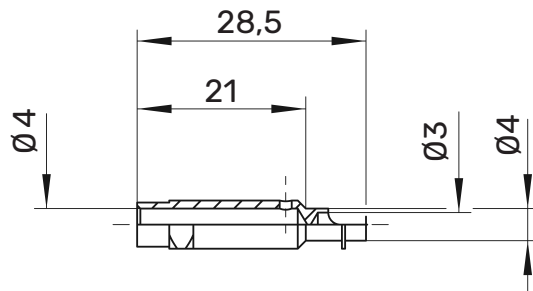
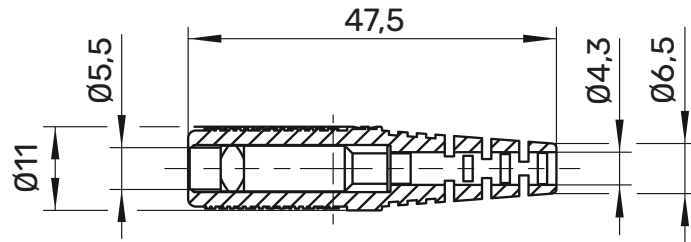

General information

Order No¹⁾ **KU 09 L Ni | Au / ..(colour)**

colours black, red, blue, yellow, green, grey, brown,

contact parts nickel-plated | **gold-plated**

sleeves TPE (Evoprene)

Technical data

terminal solder up to 2.5 mm²

for wire cross-section up to 2,5 mm²

for cable diameter up to 4 mm

sleeve for cable Ø 4 mm

transition resistance 3 mΩ (Ni) | 2 mΩ (Au)

rated voltage²⁾ 30 V_{AC} / 60 V_{DC}

rated current²⁾ 32 A

operating temperature from -30 °C to +110 °C

¹⁾ other contact platings, colours, designs and sleeves for other cable diameter on request
²⁾ at normal ambient temperatures

KU 09 L

Ni

Au

●	SW	Schwarz	Black	99002191	99002200
●	RT	Rot	Red	99002190	99002199
●	BL	Blau	Blue	99002185	99002194
●	GE	Gelb	Yellow	99002187	99002196
●	GN	Grün	Green	99002188	99002197
●	GR	Grau	Grey	99002189	99002198
●	BR	Braun	Brown	99002186	99002195