



KU 92 L

Coupler

Ø 4 mm

30 V_{AC} / 60 V_{DC}

10 A

- with solder terminal for cables up to 0.5 mm²
- with sleeve, unassembled

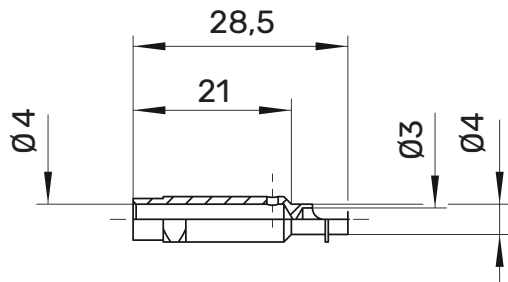
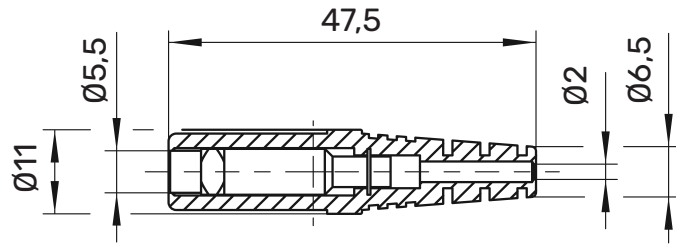

General information

Order No. ¹⁾ **KU 92 L Ni | Au / ..(colour)**

colours black, red, blue, yellow, green, grey, brown, white, purple

contact parts nickel-plated | **gold-plated**

sleeves TPE (Evoprene)

Technical data

terminal solder up to 2.5 mm²

for wire cross-section up to 0,5 mm²

for cable diameter up to 2 mm

sleeve for cable Ø 2 mm

transition resistance 3 mΩ (Ni) | 2 mΩ (Au)

rated voltage ²⁾ 30 V_{AC} / 60 V_{DC}

rated current ²⁾ 10 A

operating temperature from -30 °C to +110 °C

¹⁾ other contact platings, colours and sleeves for other cable diameter on request
²⁾ at normal ambient temperatures

KU 92 L				Ni	Au
●	SW	Schwarz	Black	99002259	99002268
●	RT	Rot	Red	99002258	99002267
●	BL	Blau	Blue	99002253	99002262
●	GE	Gelb	Yellow	99002255	99002264
●	GN	Grün	Green	99002256	99002265
●	GR	Grau	Grey	99002257	99002266
●	BR	Braun	Brown	99002254	99002263
○	WS	Weiß	White	99002261	99002270
●	PVI	Violett	Purple	99022000	