

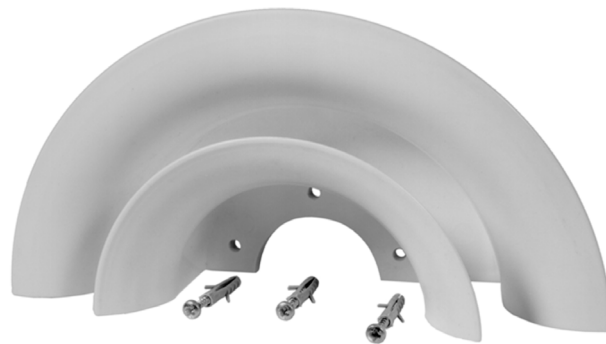

KT 9021 Cable bearer

- made of white shock-resistant polystyrene (PS) for hanging up sensitive to bending leads, cable coils, extension leads, etc.
- with 2 sections. Each section can be fixed on the wall separately
- with fixing material



General information

Order No. **KT 9021**

colours white

Technical data

diameter 220 mm

hight 110 mm

depth 62 mm

number of levels 2

cabel bearer material PS



SCHÜTZINGER

KT 9021

● **WS** **Weiß** **White** 99002160