



## SDK 503

### Schnelldruckklemme

Ø 4mm

30 V<sub>AC</sub> / 60 V<sub>DC</sub>

16 A

- vollisolierter Einbau für metallische Frontplatten

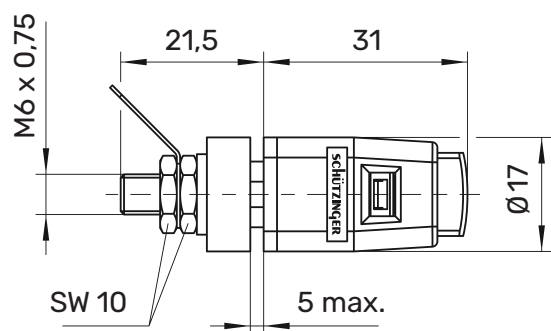

#### Montagebohrung

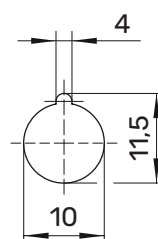

#### Allgemeine Angaben

Best.-Nr. <sup>1)</sup>	SDK 503 Ni / ...(Farbe)
Farben	schwarz, rot, blau, gelb, grün, grau, braun, weiß, orange, violett
Kontaktteil	vernickelt
Isolierteil	PA 6.6 (Polyamid)

#### Technische Daten











Anschluss	Lötöse oder Kabelschuh
Durchgangswiderstand	5 mΩ
Bemessungsspannung <sup>2)</sup>	30 V <sub>AC</sub> / 60 V <sub>DC</sub>
Bemessungsstrom <sup>2)</sup>	16 A
Betriebstemperatur	von -25 °C bis +90 °C
Frontplattenstärke	0,8 mm-5 mm
vorderes Einsteckfenster	6,5 mm x 4 mm
hinteres Einsteckfenster	8 mm x 4 mm
Anzugsdrehmoment der Befestigungsmutter	120 Ncm

<sup>1)</sup> andere Farben, Anschlüsse und Federn (ca. 15 N oder 33 N) auf Anfrage

<sup>2)</sup> bei normalen Umgebungstemperaturen

**SDK 503**

Ni

	<b>SW</b>	<b>Schwarz</b>	<b>Black</b>	99004181
	<b>RT</b>	<b>Rot</b>	<b>Red</b>	99004179
	<b>BL</b>	<b>Blau</b>	<b>Blue</b>	99004169
	<b>GE</b>	<b>Gelb</b>	<b>Yellow</b>	99004173
	<b>GN</b>	<b>Grün</b>	<b>Green</b>	99004175
	<b>GR</b>	<b>Grau</b>	<b>Grey</b>	99014900
	<b>BR</b>	<b>Braun</b>	<b>Brown</b>	99004172
	<b>WS</b>	<b>Weiß</b>	<b>White</b>	99004184
	<b>VI</b>	<b>Violett</b>	<b>Purple</b>	99014901
	<b>OR</b>	<b>Orange</b>	<b>Orange</b>	99015094
	<b>GNGE</b>	<b>Grüngelb</b>	<b>Green-yellow</b>	99004177