



## SDK 503

### Quick-release terminal

Ø 4mm

30 V<sub>AC</sub> / 60 V<sub>DC</sub>

16 A

- fully insulated for metal panels

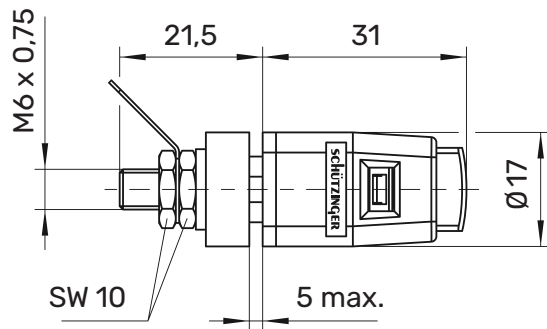

#### Montagebohrung/ hole

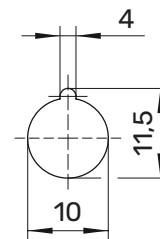

#### General information

Order No. <sup>1)</sup>	<b>SDK 503 Ni / ...(colour)</b>
colours	black, red, blue, yellow, green, grey, brown, white, orange, purple
contact parts	nickel-plated
insulation	PA 6.6 (Polyamid)











#### Technical data

terminal	solder or cable lug
transition resistance	5 mΩ
rated voltage <sup>2)</sup>	30 V <sub>AC</sub> / 60 V <sub>DC</sub>
rated current <sup>2)</sup>	16 A
operating temperature	von -25 °C bis +90 °C
panel thickness	0,8 mm-5 mm
front insertion window	6,5 mm x 4 mm
rear insertion window	8 mm x 4 mm
max. torque	120 Ncm
fastening nut	

<sup>1)</sup> other colours, terminals and springs (approx. 15 N or 33 N) on request  
<sup>2)</sup> at normal ambient temperatures

**SDK 503**

Ni

	<b>SW</b>	<b>Schwarz</b>	<b>Black</b>	99004181
	<b>RT</b>	<b>Rot</b>	<b>Red</b>	99004179
	<b>BL</b>	<b>Blau</b>	<b>Blue</b>	99004169
	<b>GE</b>	<b>Gelb</b>	<b>Yellow</b>	99004173
	<b>GN</b>	<b>Grün</b>	<b>Green</b>	99004175
	<b>GR</b>	<b>Grau</b>	<b>Grey</b>	99014900
	<b>BR</b>	<b>Braun</b>	<b>Brown</b>	99004172
	<b>WS</b>	<b>Weiß</b>	<b>White</b>	99004184
	<b>VI</b>	<b>Violett</b>	<b>Purple</b>	99014901
	<b>OR</b>	<b>Orange</b>	<b>Orange</b>	99015094
	<b>GNGE</b>	<b>Grünelb</b>	<b>Green-yellow</b>	99004177