



## SDK 800

### Safety quick-release terminal

Ø 4mm Sicherheit

300 V CAT II

16 A

- fully insulated for metal panels

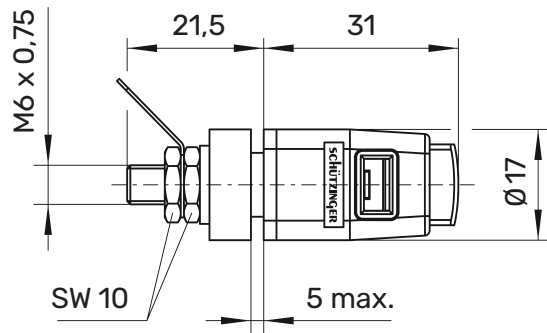

Montagebohrung/hole:

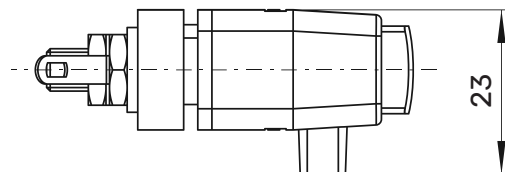
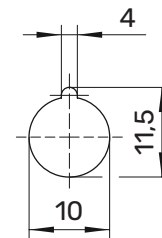

### General information

Order No. <sup>1)</sup>	<b>SDK 800 Ni / ...(colour)</b>
colours	black, red, blue, yellow, green, grey, brown, white, orange, purple, green-yellow
contact parts	nickel-plated
insulation	PA 6.6 (Polyamid)

### Technical data











terminal	solder or cable lug
transition resistance	5 mΩ
rated voltage <sup>2)</sup>	300 V CAT II
rated current <sup>2)</sup>	16 A
operating temperature	von -25 °C bis +90 °C
panel thickness	0,8 mm-5 mm
insertion window	8 mm x 4 mm
spring force	20 N
max. torque	120 Ncm
fastening nut	

<sup>1)</sup> other colours, terminals and springs (approx. 15 N or 33 N) on request

<sup>2)</sup> at normal ambient temperatures

**SDK 800**

Ni

	<b>SW</b>	<b>Schwarz</b>	<b>Black</b>	99004223
	<b>RT</b>	<b>Rot</b>	<b>Red</b>	99004221
	<b>BL</b>	<b>Blau</b>	<b>Blue</b>	99004214
	<b>GE</b>	<b>Gelb</b>	<b>Yellow</b>	99004216
	<b>GN</b>	<b>Grün</b>	<b>Green</b>	99004218
	<b>GR</b>	<b>Grau</b>	<b>Grey</b>	99016225
	<b>BR</b>	<b>Braun</b>	<b>Brown</b>	99009301
	<b>WS</b>	<b>Weiß</b>	<b>White</b>	99011088
	<b>VI</b>	<b>Violett</b>	<b>Purple</b>	99016227
	<b>OR</b>	<b>Orange</b>	<b>Orange</b>	99016226
	<b>GNGE</b>	<b>Grünelb</b>	<b>Green-yellow</b>	99004219