



FK 9900 L lamella-basket plug

Ø 4mm

30 V_{AC} / 60V_{DC}

32 A

- straight, with solder terminal for cables up to 2.5 mm²
- with sleeve, unassembled

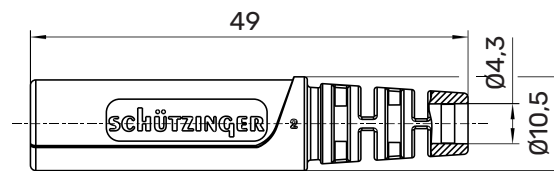
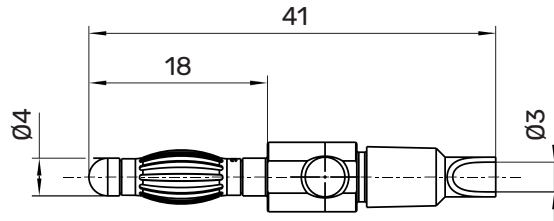

General information

Order No. ¹⁾	FK 9900 L Ni Au / ..(colour)
colours	black, red, blue, yellow, green, grey, brown, white, purple
contact parts	nickel-plated gold-plated
sleeve	PA 6.6 (Polyamid) UL94 - V2

Technical data

terminal	solder up to 2.5 mm ²
sleeve for cable	up to Ø 4 mm
transition resistance ⁴⁾	3 mΩ (Ni) 2 mΩ (Au)
rated voltage ²⁾	30 V _{AC} / 60 V _{DC}
rated current ²⁾	32 A
operating temperature	from -25 °C to +80 °C

¹⁾ other contact platings and colours on request
²⁾ at normal ambient temperatures
⁴⁾ depending on contact plating

FK 9900 L				Ni	Au
●	SW	Schwarz	Black	99025553	99025558
●	RT	Rot	Red	99025554	99025559
●	BL	Blau	Blue	99025555	99025560
●	GE	Gelb	Yellow	99025556	99025561
●	GN	Grün	Green	99025557	99025562
●	GR	Grau	Grey		
●	BR	Braun	Brown		
○	WS	Weiß	White		
●	VI	Violett	Purple		