

Next 



»» ISAIAH 54:2

Enlarge the site of your tent, and let your tent curtains be stretched out; ***do not hold back***; lengthen your ropes and ***drive*** your stakes deep.

When Isaiah first spoke these words, the nation of Israel stood on the edge of restoration. After a long season of loss and exile, God was calling His people to prepare for renewal. They had endured years of uncertainty, yet through the prophet Isaiah, God offered a promise of hope. A new day was coming. His blessing would return, His presence would dwell among them again, and their future would be larger than their past.

The image Isaiah used, a tent being stretched and expanded, spoke directly to Israel's heart. In those days, a tent represented the center of family life, the place of gathering and covering. To enlarge the tent was to prepare for growth, to make room for what had not yet arrived. It was an act of faith to build before seeing, to stretch before knowing, and to strengthen before feeling ready.

In this same spirit, God is calling us as a church to prepare our hearts and our house for what He will do next. Just as Israel was invited to expand their boundaries, we are invited to enlarge our capacity for ministry, mission, and faith. "Do not hold back," He says. That means trusting Him enough to step forward, even when the horizon ahead feels uncertain.

Every project within Next, from refreshing our Worship Center to launching a new campus and reaching the world, reflects this same calling. We are lengthening the ropes and driving the stakes deep, not only in our facilities but in our faith.

We are building for people we have not yet met and preparing for lives that will one day be changed by the gospel.

Isaiah's message still echoes today. The people of God were never meant to stay comfortable or contained. We are meant to stretch. We are meant to grow.



»» From Pastor Jarrett

As I look across the life of Champion Forest, I am filled with gratitude for how God has moved among us. For more than fifty years, this church has stood as a light in Northwest Houston, a place where people from every walk of life have found hope, purpose, and belonging in Jesus Christ. We have seen lives changed, families restored, and generations raised up to follow Him. I believe with all my heart that what we have experienced so far is only the beginning of what God desires to do.

The Next Initiative is a three-year journey of faith that helps us prepare for what God is about to do next. Through it, we are saying to the Lord, “We are ready.” Ready to enlarge our capacity. Ready to stretch our faith. Ready to make room for more people to know and follow Jesus. This season is not only about building projects. It is about building people. Every square foot, every plan, and every act of courageous generosity points to lives that will be forever changed by the gospel.

In the weeks ahead, you will hear stories of what God is already doing through Champion Forest and see where He is calling us to go. Together we will refresh our Worship Center at the Champions Campus, build new space for kids and adult discipleship at the North Klein Campus, launch a new campus in Magnolia, expand our digital reach, and strengthen our mission partnerships around the world. Each step reflects our commitment to advance *the gospel from Northwest Houston to the world.*

More than anything, my prayer is that this season strengthens our trust in the Lord. When we step out in faith, we rediscover that He is faithful.

I am inviting you and your family to join us in this journey, to pray, to participate, and to help propel this mission forward. God is doing something here at Champion Forest, and we are trusting God for all that’s next.

Pastor Jarrett Stephens

Pastor Jarrett

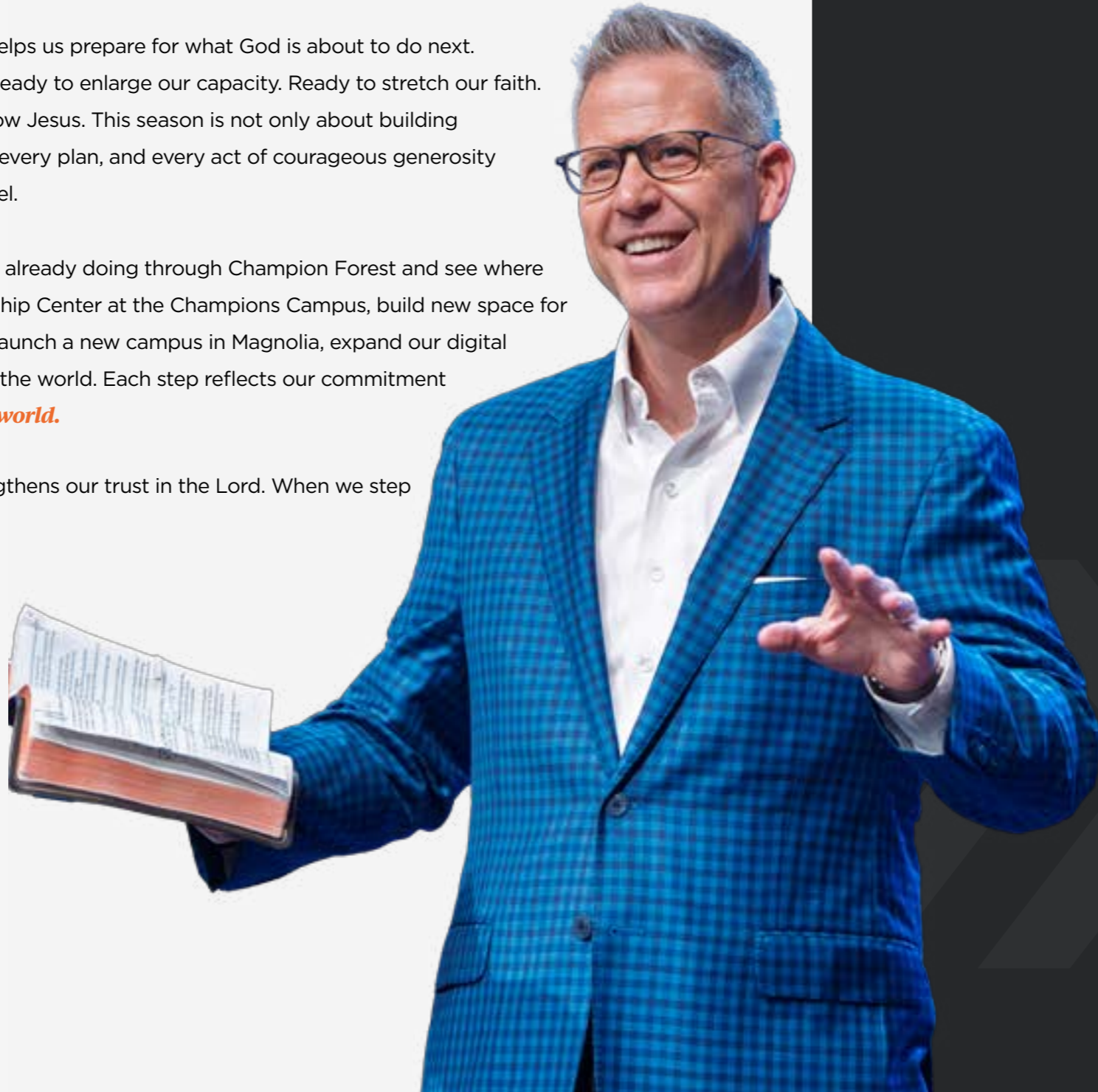

TABLE OF CONTENTS

6	Our History
8	What is Next?
	<i>Projects</i>
10	Worship Center
12	Digital Broadcast
14	North Klein
16	International Missions
17	Magnolia Campus
18	Testimonials
23	My Giving Worksheet
24	FAQ

»» OUR HISTORY

Founding and Early Years



1970

On September 20th, Rev. Robin Guess holds the first worship service with six people in attendance.

1972

On October 1, the fellowship formally organizes as Champion Forest Baptist Church with 230 charter members.

1973

On February 25, the church breaks ground on its first worship center and Sunday School building at 12501 Champion Forest Drive.

1976

Members pledge \$400,000 through the “Together We Build” program to fund a new Family Life Center. Construction begins, the first parking lot expansion is completed, and the church Library opens.

1978

Senior Pastor Damon Shook becomes the second Senior Pastor, additional portable space is added, two services begin, and the church is recognized among the top 1 percent in SBC growth.

1979–1982

Facilities are expanded through major remodels and new construction, including updates to the Worship Center, a new 20,000 sq. ft. Education Building, added balcony seating and parking, planning for a new Worship Center and Children’s Building, launch of the “Building Together By Faith” initiative with a groundbreaking in 1981, and additional portable space leased to support growing Sunday School needs.

A Move Toward Greater Impact

1990–1991

A Land Acquisition Committee is formed, resulting in the church purchasing 54 acres at Stuebner Airline and Strack for \$2.27 million, now known as the Champions Campus.

1997–1999

Services begin at the new site while construction continues, Phase II is completed, the church fully relocates to Stuebner Airline, and the former Champion Forest Drive property is sold.

2000–2002

The Champions Campus launches construction of a 4,500-seat Worship Center, Chapel, Library, and expanded infrastructure, culminating in the dedication of the new Worship Center on August 18, 2002.



Reaching for More

2005–2007

Following Pastor Shook’s retirement and the election of a new Pastor Search Committee, Dr. David Fleming is overwhelmingly affirmed as the church’s third Senior Pastor and begins his ministry in January 2007.



2008–2010

The church launches an ambitious expansion plan adding major education facilities and refurbishing existing spaces. Despite economic challenges, the congregation completes the IMPACT initiative and dedicates the new buildings in 2010.

2010

CF embraces multilingual and multicultural ministry, becoming one church in two languages with the launch of the Spanish ministry.



2013

CF becomes a multi-site church with the launch of the North Klein Campus, as 300 church members begin meeting weekly in the Klein Multipurpose Center.

2019

The church celebrates the Easter grand opening of the North Klein Campus on Spring Stuebner Road.



Advancing the Kingdom

2020

Dr. Jarrett Stephens becomes the fourth Senior Pastor, ushering in a renewed focus on evangelism, discipleship, and mission.



2021

The CF Residency is created, expanding as a pipeline for developing future ministry leaders and pastors.

2022

CF Connect is established as a major training and equipping ministry, strengthening the capital “C” Church and leaders across the region, US, and around the world.

2024

New Student Building opened at North Klein Campus.

2021–2025

The church celebrates a historic milestone with 5 consecutive record-setting baptism years, and for the first time sees over 1,000 people baptized in one year.



WHY NOW?

Ministry momentum is building and capacity must grow with it.

- » Facilities are aging and at limits (Champions Campus WC has original carpet, paint, lights & chairs (2002); the last tech upgrade was 2012)
- » North Klein is rapidly expanding, and families and kids need ministry space.
- » Magnolia’s population is exploding, and the opportunity to plant and reach is now.
- » Digital reach is essential for gospel multiplication (Houston, prisons, nations).

WHY US?

- » God has entrusted this generation at Champion Forest with the resources and calling to act now.
- » For over 50 years, this church has stepped forward in faith, and today we stand on the foundation others built.
- » Because Champion Forest has always prioritized people, making an impact, and leaving a legacy of faith.



What is *Next*?

As Pastor Jarrett shared in his opening words, Champion Forest has enjoyed a rich heritage of God’s faithfulness. For more than 50 years, this church has been a light in Northwest Houston, a home where people have found hope, purpose, and belonging in Jesus Christ.

The Next Initiative flows directly out of that legacy. It is our unified “we are ready” to the Lord. Ready to enlarge our capacity. Ready to stretch our faith. Ready to make room for more people to know and follow Jesus.

These projects are not about buildings for their own sake. They are expressions of a deeper desire to build people, shape lives, and prepare the way for what God desires to do in and through our church.

It should come as no surprise that each of our efforts in Next blend seamlessly with our focus priorities as a church. Each part is designed to help us ***advance the Kingdom by making disciples, loving our community, and strengthening the Church.***

The Worship Center renovation at the Champions Campus will support vibrant worship and disciple-making for years to come. The expansion of our digital ministry and broadcast reach will carry the gospel farther into our community and around the world. The new Kids and Adult Discipleship Building at the North Klein Campus will create space for more families to grow in their faith. Our international church planting efforts will extend the mission of Jesus to new cities and nations. And a third campus in the Magnolia area will position us to love and reach one of the fastest-growing regions in our community.

\$13M Worship Center Renovation— Champions Campus

\$9M North Klein Expansion — Kids & Adult Discipleship Space and Parking Lot

\$4M Digital Ministry & Broadcast Expansion

\$2M International Church Planting Projects

\$10M Land for a Third Campus in the Magnolia Region



next.championforest.org

»» WORSHIP CENTER

Worship Center Renovations

The Worship Center that has shaped so many lives now needs renewal of its own. This project will refresh the space with updated technology, lighting, and design to create an environment ready to shape the next generation of worshipers.

\$13m

RENOVATIONS

- All new digital immersive audio system with room acoustic treatments
- All new digital video system with new cameras, screens, and infrastructure
- All new theater seats, paint, and carpet
- Complete stage rebuild for broadcast and optimal in-room worship
- Complete house lighting replacement
- Complete Worship Center roof resurfacing



Digital Ministry & Broadcast Expansion

To take the gospel from Northwest Houston to the world, Champion Forest will expand its digital footprint by upgrading broadcast capabilities, embracing new media, and launching global outreach through platforms that can reach homes, prisons, and hearts around the world.

\$4m



“The updates to our Worship Center and the expansion of our digital reach are going to open new doors like never before. These projects will create spaces, both in the room and online, where people can encounter God in powerful ways. I believe what’s coming will inspire and equip us to share the hope of Jesus farther than we’ve ever dreamed.”

Michael Neale

Pastor of Multisite Experience & CF Creative

One example of how our digital presence will reach places few can go is through the Pando app. Pando was originally created for people who are incarcerated and is the first app of its kind available within correctional facilities. Through secure tablets, inmates across the country can experience the love of Christ through life-changing content, available 24/7, at no cost.



North Klein Campus Expansion — Kids & Adult Discipleship Space and Parking Lot

With North Klein Campus bursting at the seams, this project will nearly double ministry space, adding 15,000 square feet for children and adults. It's a vital investment in disciple-making and the growing families that call North Klein Campus home.

\$9m



“ I couldn't be more excited about what's ahead for North Klein Campus. The new spaces for kids and adults will not only help us keep up with the incredible growth we're seeing, but also create more room for life-changing ministry every week. This expansion is all about making sure every person who walks through our doors has a place to belong and grow in their faith. I'm so thankful for our church family and excited about the future!”

Steven Morris
North Klein Campus Pastor

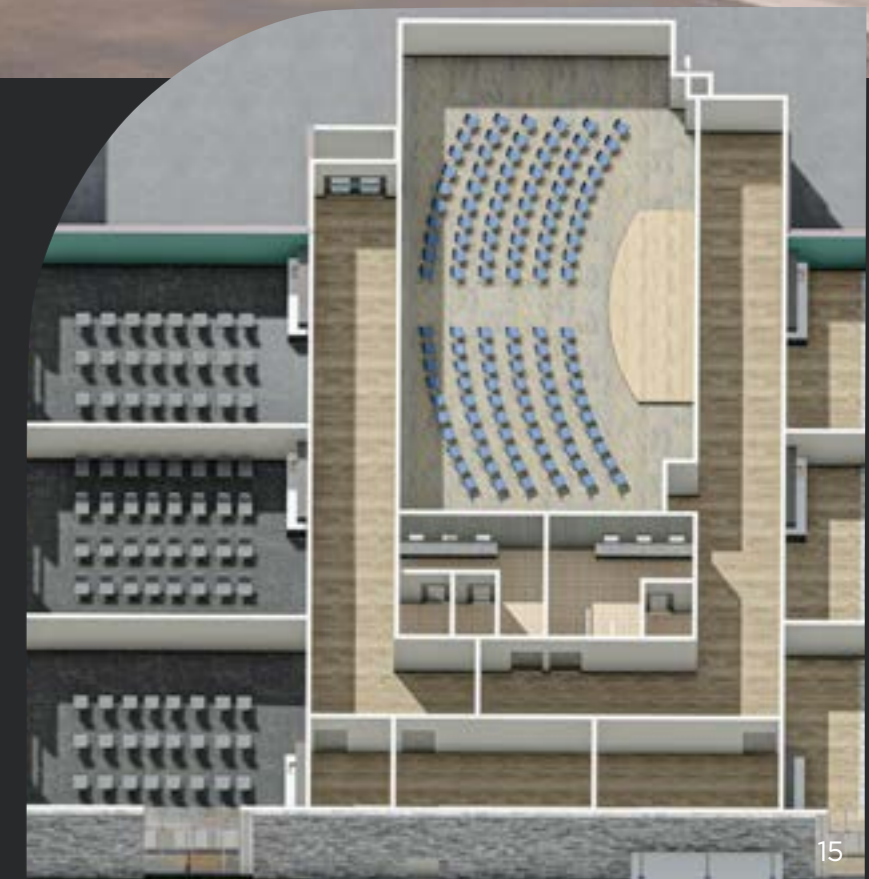

»» INTERNATIONAL MISSIONS

International Church Planting Projects

Through partnerships with FAMB, Greater Europe Mission, and the International Mission Board, Champion Forest will launch new church plants in Nepal, five European cities, and Madrid—sending people and resources to strengthen the global Church.

\$2m



GEM: Rome, Birmingham, Frankfurt, Pristina (Kosovo)

IMB: Madrid

FAMB: 7 Provinces in Nepal

“In the DNA of Champion Forest, there has always been a heartbeat for those who do not yet know Christ. We have always “existed for people not yet here.” As we consider what the Next chapter is missionally for us, we are focusing on planting more churches in Nepal, England, Italy, and Spain. New churches reach new people! We want to help FAMB (For All Mankind Movement) reach Nepal. We want to partner with the International Mission Board to establish a Church Planting Residency in Valencia, Spain—replicating what we currently do with Spanish church planting pastors at CF. And we want to plant new churches across parts of Europe with Greater Europe Mission to take the Light back into dark places that once burned bright with the gospel. Next will help us do this together.”

John Wills

Missions Pastor & Residency Program Director



»» MAGNOLIA CAMPUS

Third Campus in the Magnolia Region

Building on the success of the North Klein Campus, Champion Forest will establish a third campus along the growing HWY 249 corridor, reaching new communities with the gospel and extending the church’s mission further than ever before. The funds raised during Next will allow us to secure land for this new work.

\$10m





Read more of Taylor's story

“I just want to show the same love God showed me, so that one more person can feel welcomed, accepted, and loved.”

Taylor Perrella

Taylor grew up in church, but her faith always felt shallow and distant. Chasing love and worth through partying, relationships, and an abusive marriage, she found herself empty, ashamed, and convinced there was no way out. A move to Spring, a sick cat, and a simple Tuesday night gathering at Champion Forest became the turning point where God met her through unexpected people, honest confession, and a message of redemption that changed everything. Today she is serving, leading, and sharing the love she once believed was out of reach.

Jerome and Dora Stovall know what it means to walk through unthinkable loss. Just hours after moving into their new home, their young son Zy'Air drowned in the backyard pool, sending their already fragile blended family into deep grief, anger, and distance from God. Wrestling with hard questions, church hurt, and a marriage hanging by a thread, they eventually found themselves at Champion Forest's North Klein Campus, where the ReEngage marriage ministry and a loving church family became a lifeline. Today, instead of barely holding on, the Stovalls are serving together in Kids Ministry, helping other hurting families discover the hope and healing they found in Christ.

“When you get out of the way, God steps in and puts you in places you never thought you would be..”

Jerome & Dora Stovall



Read more of the Stovalls' story





Ron & Susie Roberson



“We knew tithing when there was a paycheck coming every month. The real test came when we celebrated our first anniversary and neither of us had a job.”

Ron and Susie have called Champion Forest home for more than three decades, but their story of generosity started long before they ever walked onto campus. As newlyweds in the mid-80s, they lost both of their jobs and watched the numbers on paper simply not work. Choosing to tithe anyway, they saw God provide in surprising ways and learned that “you really cannot afford not to tithe.”

Now, with children and grandchildren growing up at Champion Forest, Ron and Susie see themselves standing on the shoulders of a faithful generation and joyfully stepping up to become that foundation for the next one. Their story is a quiet, steady reminder that when God is moving, the greatest privilege is to join him.



Read more of the Robersons' story

“When Champion Forest gives to Next, you are sending the gospel to people who will never have a chance to hear unless someone is sent to them.”

Brian Jones



Brian stands in a unique place. He is both a longtime member of Champion Forest and a leader with the For All Mankind Movement, a missions organization planting churches in some of the least reached regions of South Asia. In villages across Nepal, he has watched men and women living in deep spiritual darkness hear the name of Jesus for the very first time and respond with surprising boldness, sparking new house churches that are multiplying faster than anyone imagined.

Now, through the Next Initiative, Champion Forest and FAMM are locking arms to fully resource indigenous workers who are ready to risk everything to share Christ with their own people. Every gift fuels training and teams on the ground, so that more and more unreached families can hear the gospel and see churches planted in their villages.



Read more of Brian's story & the vision for Nepal

WHAT WILL IT TAKE?

THE COST

The estimated cost of Next is \$38,000,000. This amount of cash and pledges, together with prudent borrowing and cash already on hand, will allow us to move forward.

THE COMPONENTS

Next has two components that work together: “First and Best Offering” and “3-Year Pledge Commitments.” All of our giving is above and beyond regular tithes and offerings.

- A “First and Best Offering” is a special gift we need everyone to give on Commitment Sunday, March 1.
- A 3-year pledge is a commitment to give a certain amount over the next 3 years.

OUR GOALS

Goal #1 — First and Best Offering

On March 1, 2026
\$6 MILLION GIVEN
+

Goal #2 — 3-Year Pledge Commitments

2026-2028
\$22 MILLION PLEDGED
=
TOTAL GIVEN
\$28 MILLION

HOW SHOULD I RESPOND?

PRAY

Everything begins with prayer. Ask God to open your heart to what He is doing through Next and how He wants to use you in it. Pray for our church to walk together in faith, unity, and joy. Pray for every life that will be touched through these efforts, from Northwest Houston to the world. As you pray, listen for His voice and trust that He will lead you to take your next step of faith.

- We are praying for a 6 MILLION First and Best Offering on March 1, 2026.
- We are praying for a 3-Year Pledge.

PREPARE

This is a season to prepare our hearts, our households, and our hands for what God is about to do. Take time to reflect on how He has blessed you and how you can join Him in blessing others. Preparation is not about pressure; it’s about posture. When we prepare with open hearts, we make room for God to do something new in and through us.

- Talk and pray together as a family about what courageous generosity looks like in your home.
- Join our NEXT PRAYER JOURNEY by visiting Next.ChampionForest.org.

PROPEL

Faith always moves forward. As we each take our step of obedience, we help propel the mission of Champion Forest forward from Northwest Houston to the world. Every gift becomes part of God’s unfolding story. Together we are building something that will outlast us, creating space for future generations to know and follow Jesus.

- Determine your giving amount and bring it March 1st.

MARCH 1, 2026
COMMITMENT SUNDAY

GOAL #1 — FIRST AND BEST OFFERING

6 Million Given

GOAL #2 — 3-YEAR PLEDGE
(APRIL '26 - MARCH '29)

22 Million Pledged

TOTAL AMOUNT IN CASH AND PLEDGES

28 Million

POTENTIAL GIVING CHART

Donors Needed	Amount	Total
350	\$1,000	\$350,000
1160	\$5,000	\$5,800,000
440	\$10,000	\$4,400,000
250	\$20,000	\$5,000,000
50	\$30,000	\$1,500,000
35	\$40,000	\$1,400,000
10	\$50,000	\$500,000
10	\$75,000	\$750,000
8	\$100,000	\$800,000
8	\$250,000	\$2,000,000
5	\$500,000	\$2,500,000
3	\$1,000,000	\$3,000,000
		\$28,000,000

*Based on this scenario, debt will be required. While the amount of debt is to be determined, it will be based on our cash on hand (\$1.7 million), the amount given on Commitment Sunday and the amount pledged over the three-year period. Any debt obligations will be presented to the Church for approval prior to origination.

Next
MY GIVING WORKSHEET

My First and Best Offering:

1

\$

☐ ONLINE ☐ CASH ☐ CHECK

My 3-Year Pledge:

2

I PLAN TO GIVE \$

☐ WEEKLY ☐ MONTHLY ☐ YEARLY ☐ ONE TIME

OVER THE NEXT THREE YEARS RESULTING IN A TOTAL PLEDGE OF:

\$

Gifts from Assets
(Securities, Real Estate, etc.)

3

\$

MY TOTAL Next GIVING
ADD BOX 1+2+3 AND ENTER THE AMOUNT BELOW

\$



SCAN FOR ONLINE COMMITMENT CARD

1. What is the purpose of the Next Initiative?

Next is a churchwide journey of generosity that prepares us for what God is calling Champion Forest to do in the coming years. It strengthens every campus, expands ministry capacity, and positions our church to reach more people with the gospel—locally and globally.

2. How long does Next last?

Next is a three-year initiative beginning on Vision Sunday, January 25, 2026. Gifts may be given at any time during this three-year period.

3. What projects are included in Next?

Next includes:

1. Complete Renovation of the Champions Campus Worship Center
 - New immersive digital audio system with full acoustic treatment
 - New digital video system with upgraded cameras, screens, and infrastructure
 - New theater seating, paint, and carpet
 - Fully redesigned stage optimized for worship and broadcast
 - Complete house-lighting replacement
2. New Adult & Kids Building Expansion at the North Klein Campus

Including a supporting parking lot to accommodate growth and accessibility.
3. A New Campus in the Magnolia Region

Land acquisition.
4. Broadcast Ministry Expansion

Expanding the pulpit ministry of Champion Forest nationally and internationally through global streaming, TV, apps, and digital platforms.
5. International Missions & Church Plants

In partnership with GEM, IMB, and FAMM.

4. Is this replacing my regular giving to the church?

No. Giving to Next is above and beyond regular tithes and offerings, which support the ongoing ministry of Champion Forest.

5. What is Commitment Sunday?

March 1, 2026, is Commitment Sunday! On this day, we are asking our church family to:

1. Bring our FIRST and BEST OFFERING toward Next, with a goal of \$6 million.
2. Bring our 3-year pledge commitment with a goal of \$22 Million.

6. How do three-year commitments work?

Each household prayerfully asks God what they should give over the next three years. Commitments can be fulfilled weekly, monthly, annually, or in any rhythm that fits your financial plan.

7. Can I change or adjust my commitment?

Yes. A commitment reflects faith and intention, not a contract. You may adjust your commitment at any time.

8. Can I give non-cash or asset-based gifts?

Yes. You may give stocks, real estate, retirement distributions, or other assets.

9. What if I cannot attend Commitment Sunday?

You can participate anytime by submitting your commitment online, by mail, or at any campus during the following week.

10. Is any gift amount too small?

No! Every gift matters. Next is about full participation, not equal amounts. We ask each family to prayerfully give in faith.

11. When will the projects begin?

Timelines will align with the strength of our FIRST and BEST Offering and the total amount pledged. Our plan is to begin the Champions Campus Worship Center renovation right after Easter 2026 and the North Klein Campus Building Expansion in August of 2026.

12. How does borrowing fit into the overall plan?

Next includes a strategic borrowing component that allows essential projects to begin rapidly and be completed wisely. Generous giving reduces long-term borrowing.

13. Will Next increase the church’s operating budget?

No. Next funds are separate from regular tithes and offerings. They are designated solely for expansion and improvement projects.

14. Can I participate if I’m new to Champion Forest?

Absolutely. Next is a unifying journey for everyone who calls Champion Forest home.

15. How will I receive updates throughout the three years?

Regular updates will be shared on project progress, financial milestones, and ministry impact. You can also visit next.championforest.org for updates.

16. Can I participate digitally?

Yes. Go to www.next.championforest.org or scan the QR code. You will be directed to select “GIVE NOW,” enter your gift amount, select “Next,” sign in or sign up, follow the prompts to enter your payment information, and submit your payment.

17. Is the 3-year pledge binding?

No. It is a statement of intent made in good faith, but it is not binding.

18. Who will see my gift and pledge?

Only those in our Business Office who need to process the giving information will see your gift and pledge.

19. How do I lead my family well during this opportunity?

This is a unique season of life that may never come our way again, as we invest in the spiritual lives of this generation, future generations, and our region. Be sure to have intentional family discussions and prayer times each week to take full advantage of this moment. Make your First and Best Offering and 3-Year Pledge a family experience.

20. How do I designate my gift to the campaign in the future?

On your check memo line, or on the envelope of a cash gift, writing one of the following phrases: “Next”, “Capital Campaign”, “Pledge”, or any similar designation will let the church know to direct the gift to this campaign.

FAQ

Learn More





» PRAYER

"Lord, You are calling us to expand and enlarge our *hearts and lives*. Teach us to stretch without fear, to loosen our grip, and to set our *hope* deep in You. Form us into a *people who love* our region faithfully and carry Your light to the nations, trusting You as You lead us forward. In Jesus' name, *Amen*."

Special thanks to our members who served on the Next Vision Team, generously offering their prayer, time, and investment in our future.

Steve Allen, Ken Barrett, Carly Beckham, Randall Bell, Lloyd Bratton, Dianne Davenport, Raye Anne Edmonds, Heather Garza, Bill Goudeket, Carla Knight, Levi McCaskill, Ray Morris, Rebecca Patterson, Trevor Payne, Amarilis Rivera, Rafael Tovar, Ron Walker, Jonathan Ward, Eric Weiss.

»»» ISAIAH 54:2

Enlarge the site of your tent, and let
your tent curtains be stretched out;
do not hold back; lengthen your
ropes and *drive* your stakes deep.



NEXT.CHAMPIONFOREST.ORG