

BIMx Development

— it works —

📍 @ bimxdv 📍

BIMX Pro Sliding Door

BIMX Development



Bali
2025





BIMX PRO SLIDING DOOR

Performance:

- ▶ **Air Tightness:** Level 4
- ▶ **Water Tightness:** Level 5
- ▶ **Wind Load Resistance:** Level 8
- ▶ **Thermal Insulation:** $K \leq 2.4 \text{ W/m}^2 \cdot \text{K}$
 - ▷ (Low-E hollow glass with insulation cotton filling)
- ▶ **Sound Insulation:** $\geq 35 \text{ dB}$
 - ▷ (Laminated + hollow tempered glass)

BIMX PRO SLIDING DOOR

Product Configuration:

- ▶ **Structure:** Medium narrow frame, four-seal strip design, hidden drainage
- ▶ **Opening Method:** Horizontal sliding
- ▶ **Profile Thickness:** 2.0 mm
- ▶ **Frame Width:**
 - ▷ Two-rail: 108 mm
 - ▷ Three-rail: 162 mm
- ▶ **Sash Width:** 58 mm
- ▶ **Glass:** 5G + 20A + 5G
- ▶ **Heat Insulation Strip:** 25.3 mm
 - ▷ Option: Insulation cotton
- ▶ **Hardware:** German brand Wehag handle, Gedi pulley / anti-swing wheel





BIMX PRO SLIDING DOOR

Key advantages:

► **Flexible Track Options** – Available in two-track and three-track designs. The outer frame is assembled with 90° screws. The side seals match the top and bottom, closed with a cover plate for a flat, elegant appearance.

► **Smooth & Stable Operation** – Equipped with a top-frame guide pulley to prevent the glass sash from swinging.

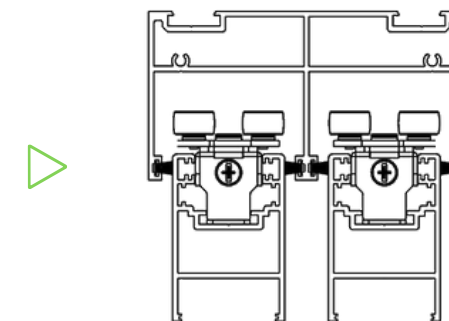

► **Durable Bottom Rail** – Stainless steel guide rails ensure long-lasting strength, smooth sliding, and resistance to fading.



Enhanced Sealing & Soundproofing

– Multi-channel rubber strips between the frame and sashes, combined with wool strips, provide excellent sealing, noise reduction, and insulation.

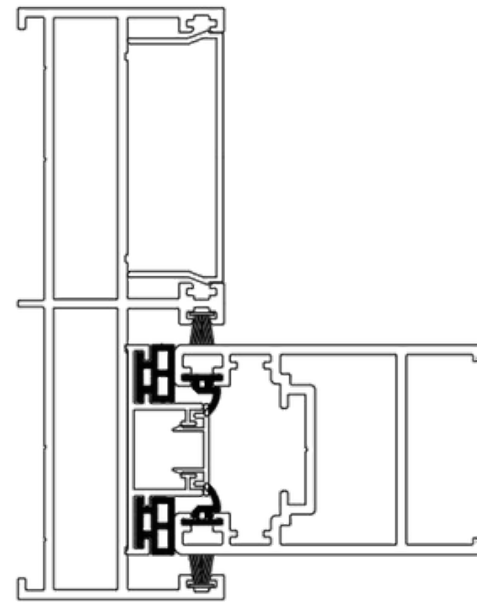

Integrated Flyscreen Option –
Three-track design available with a built-in flyscreen for added comfort and convenience.

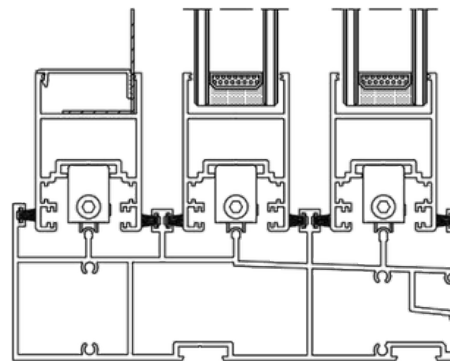



▼

Concealed Drainage System –
Vertical drainage design prevents
rainwater backflow and ensures
smooth water discharge.

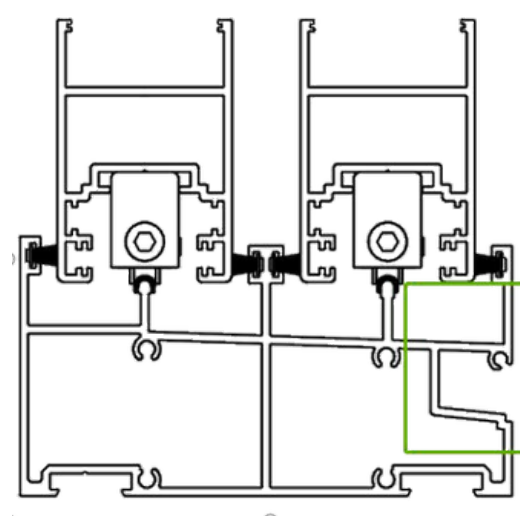

▼

Slim Frame Design –
Minimalist, stylish look that
enhances modern interiors.

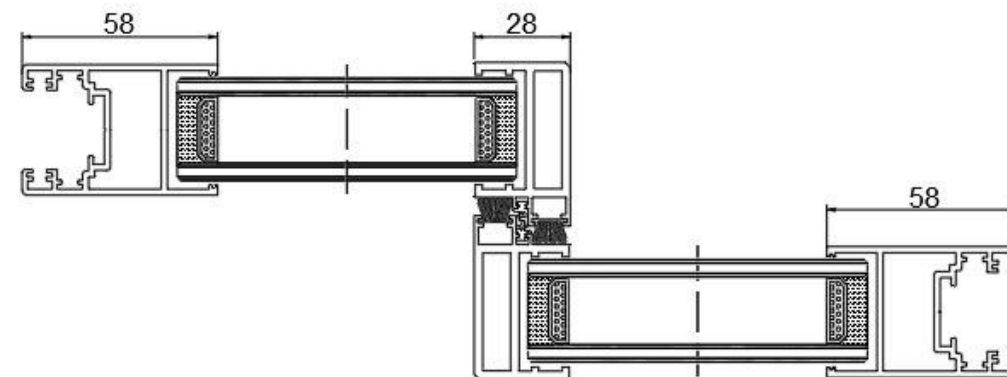



Reinforced Structure –
Strengthened components allow
glass sashes to reach heights
over 2600 mm while maintaining
stability and performance.

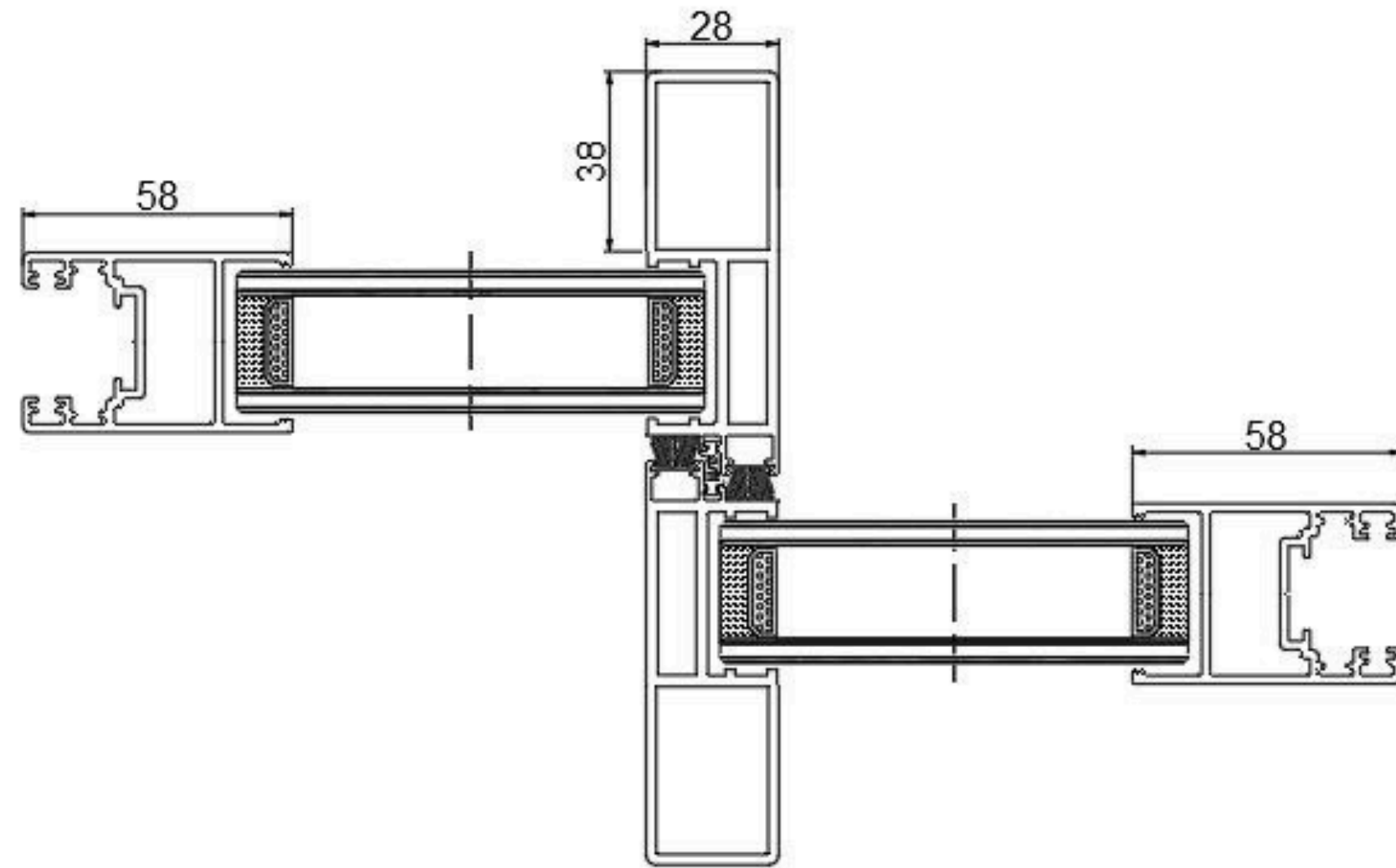

▼

Reinforced Components for Three-Track Sliding Door –

Specially designed strengthening parts enhance stability and durability, ensuring smooth operation even with larger glass panels.

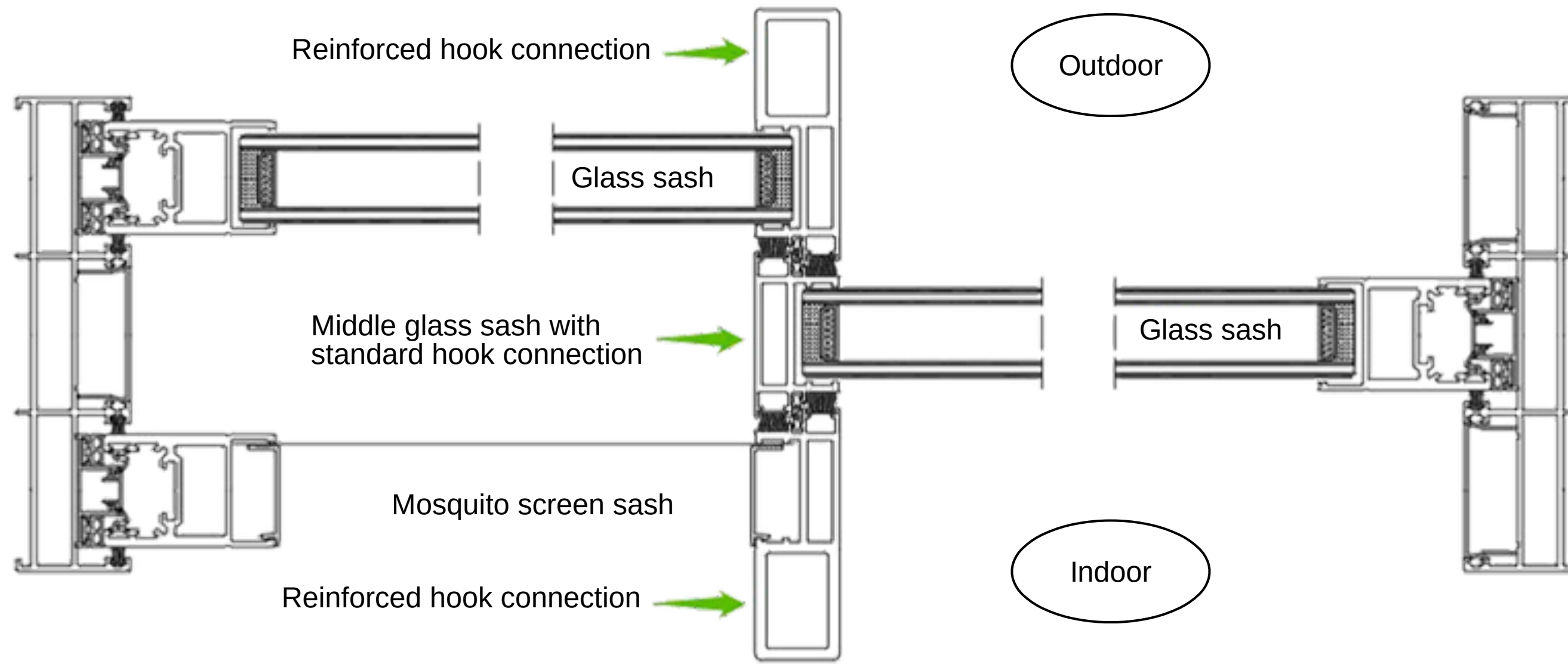

Assembly Mode

45-degree corner bracket joint

90-degree connector assembly



90-degree connector assembly

45-degree corner bracket joint

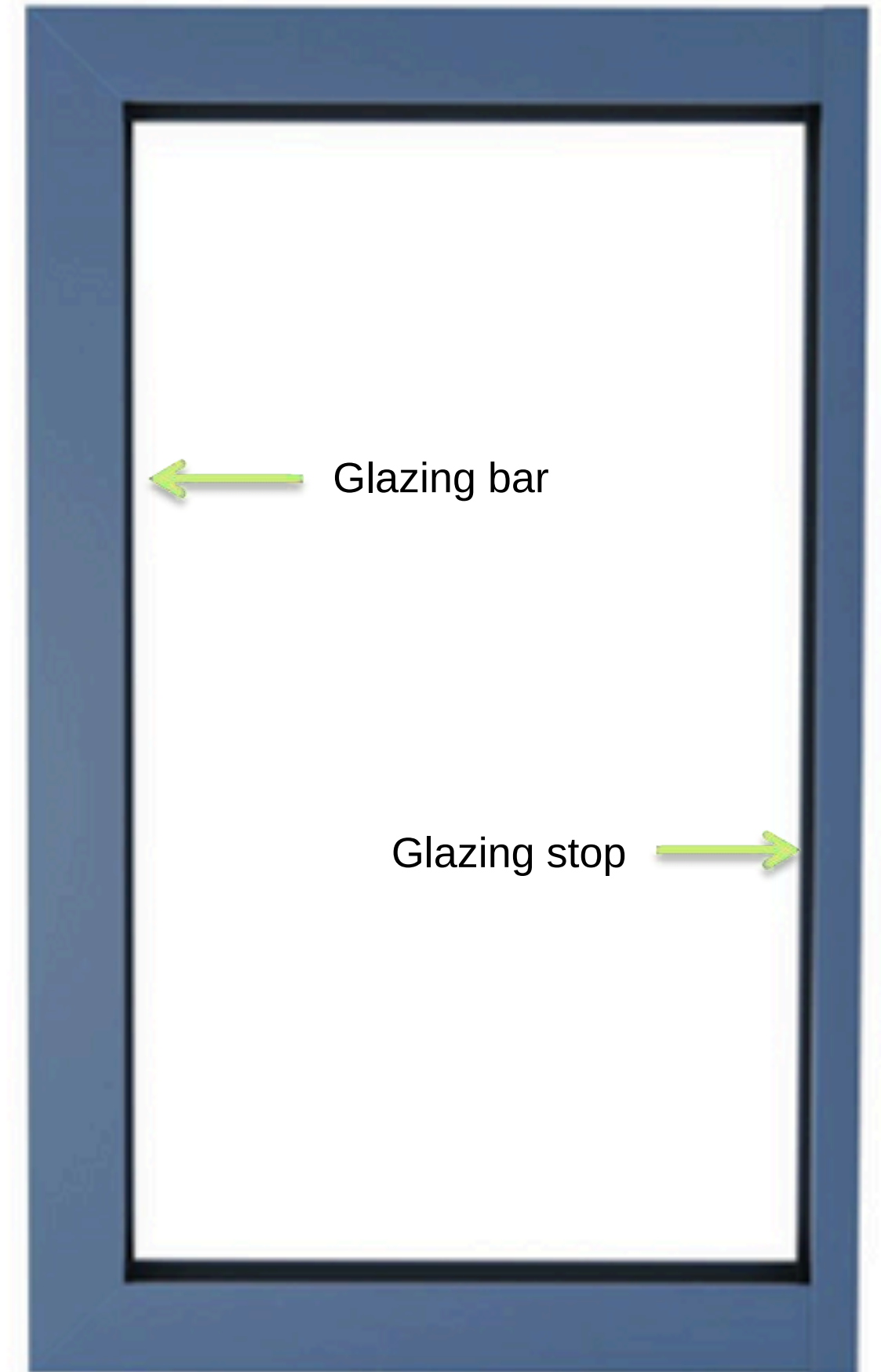



Glass Slot Design

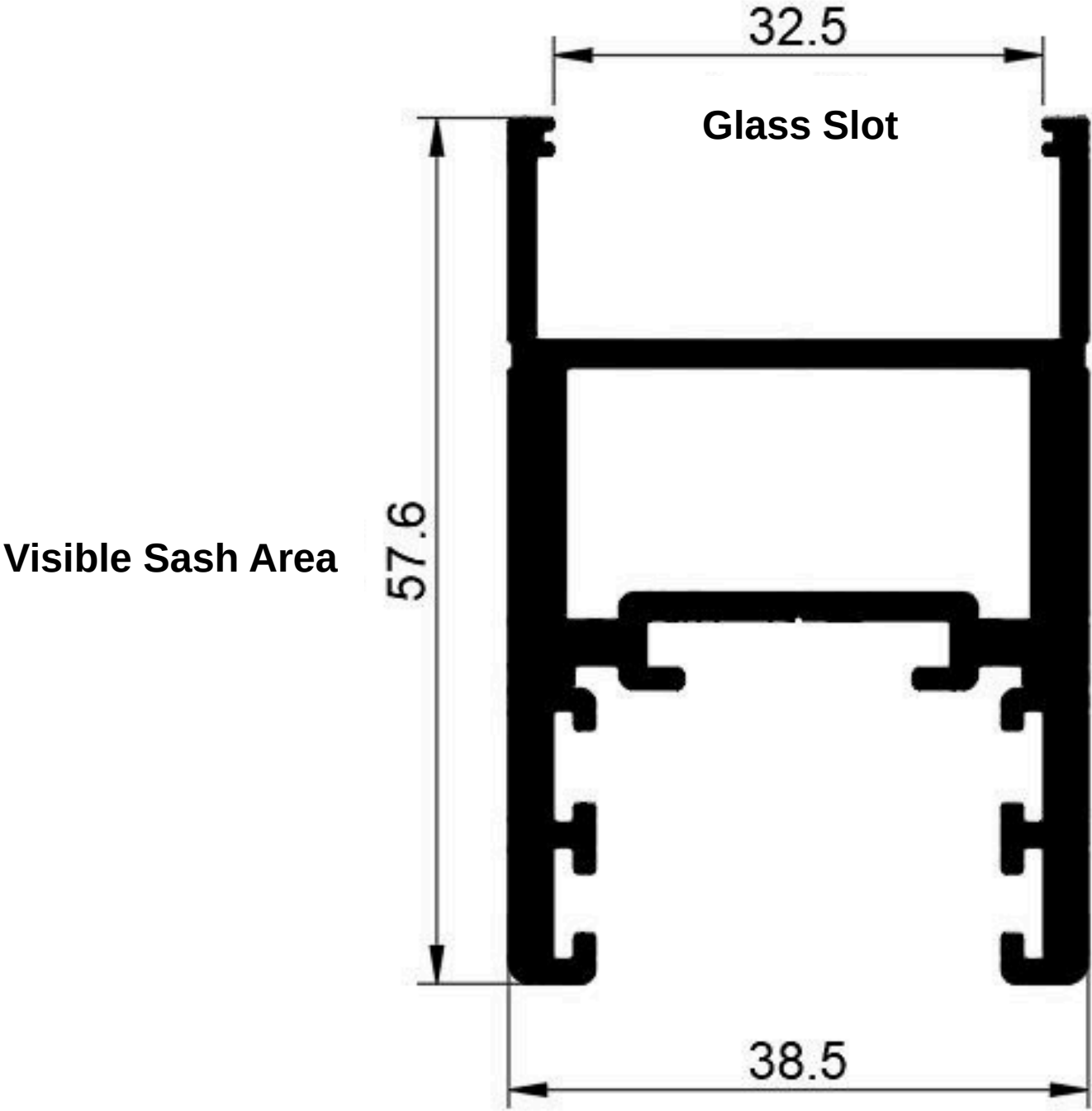

▼

Design Options

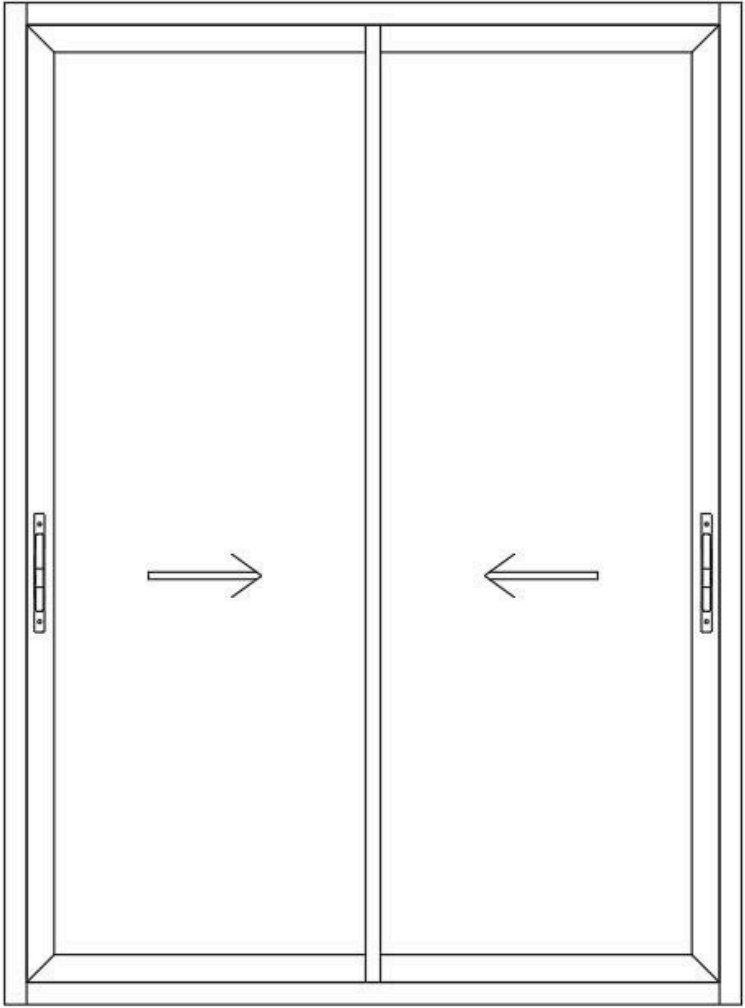

Double Track Two Panels

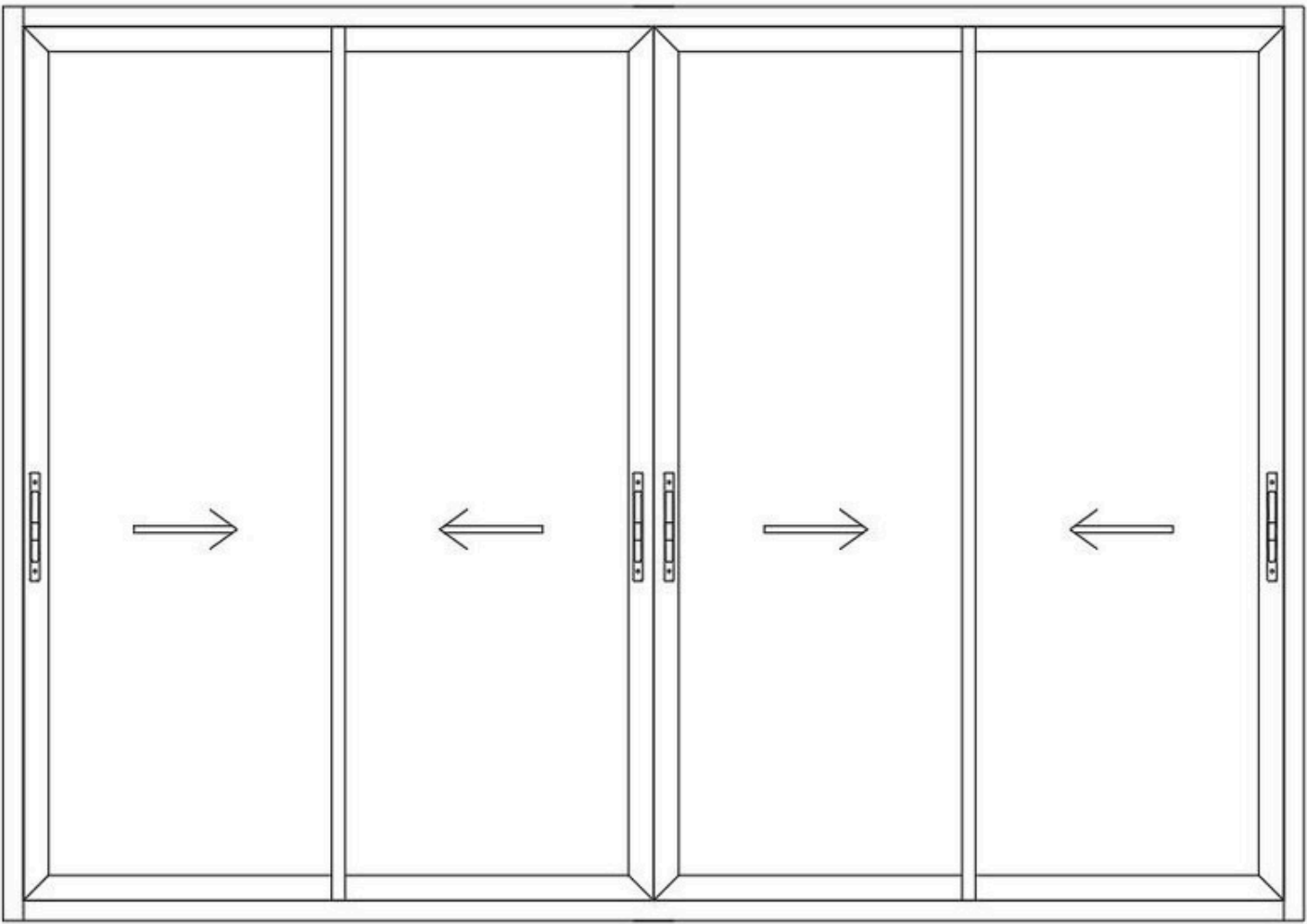

Two-Track or Three-Track Four Panels

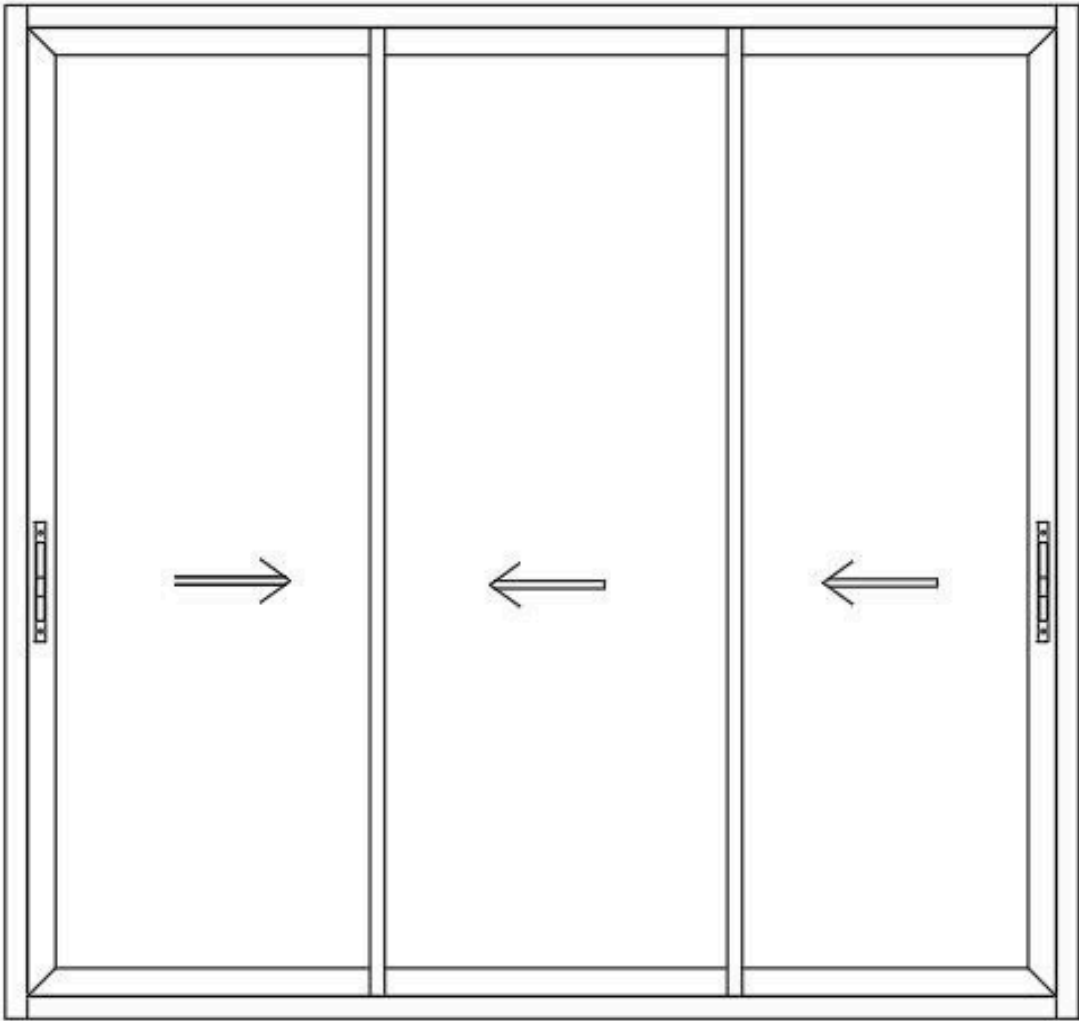

Three-Track Three Panels

Design Options

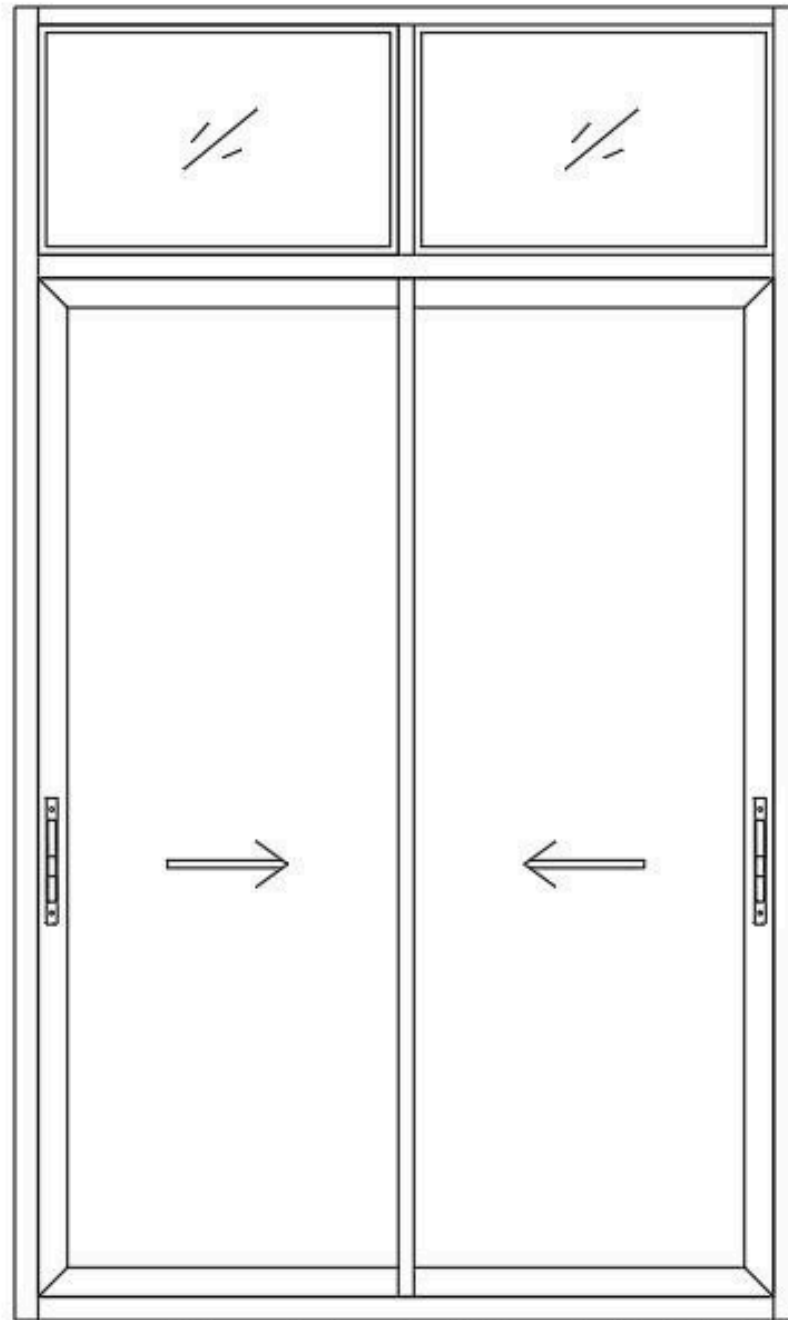

Two-track two-panel / Two-track two-panel with screen
With fixed header

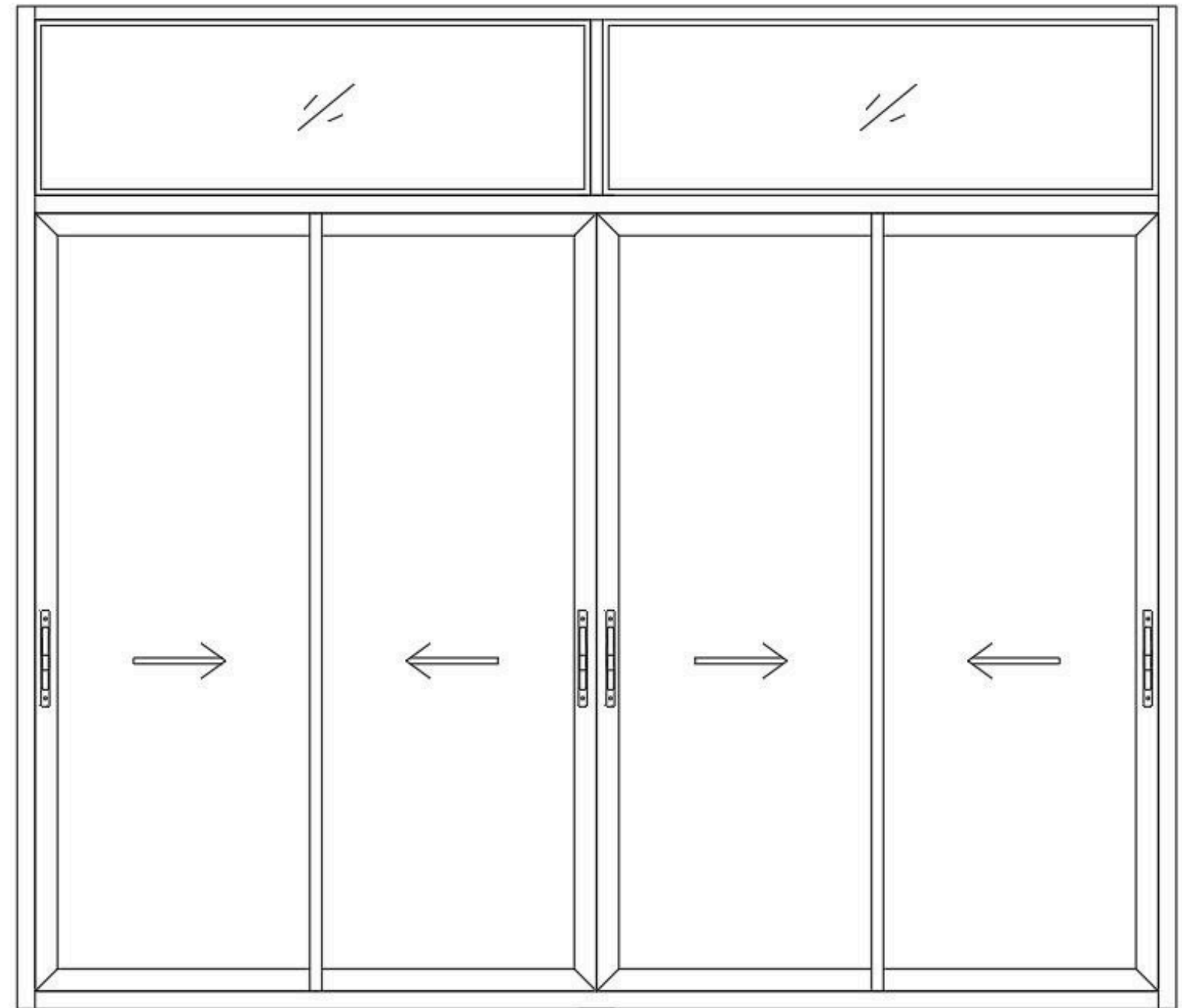

Two-track four-panel / Three-track four-panel with screen
With fixed header



BIMX Pro Size Limits

SAINA Pro Sliding Door Maximum Size Chart (Without Screen)

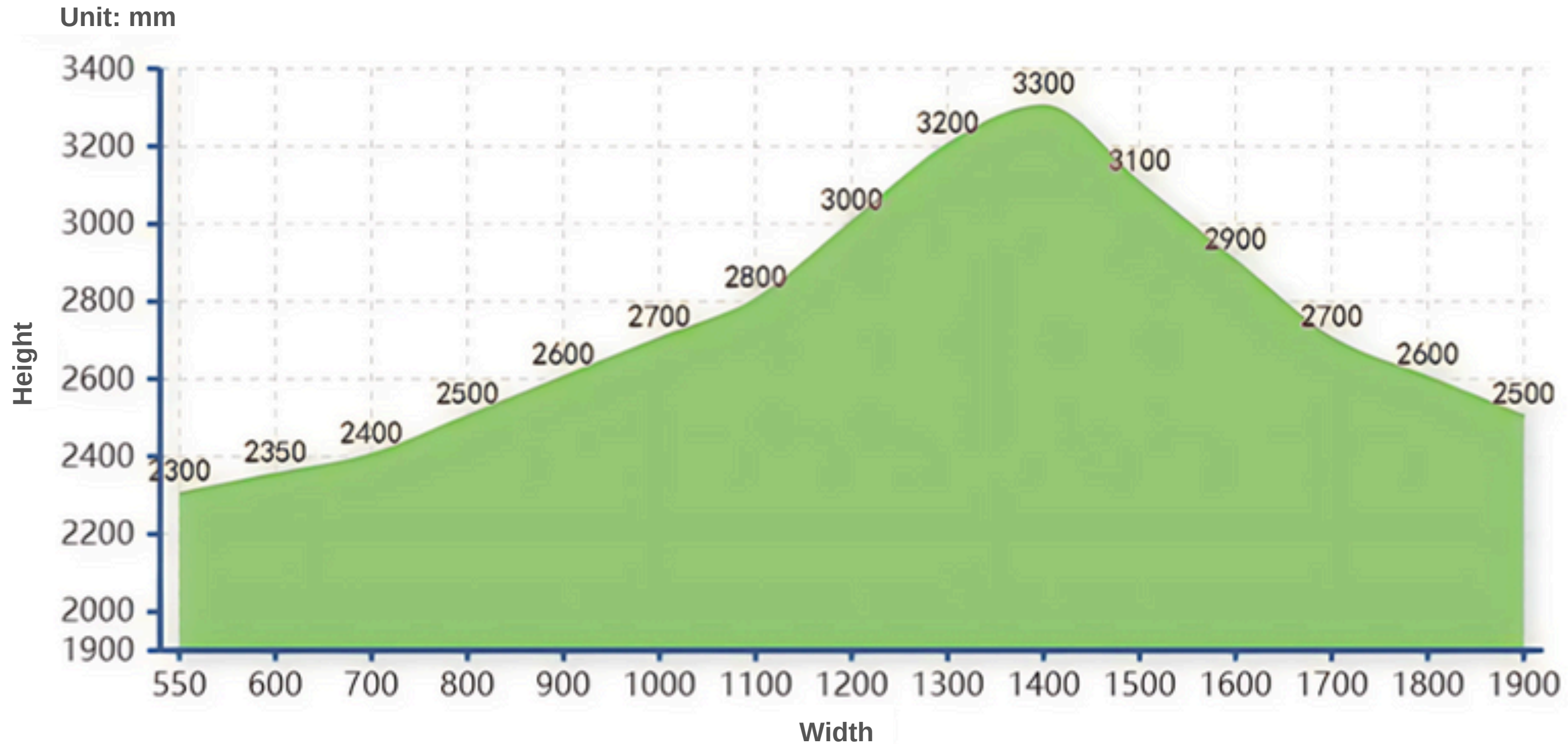

Size Limitations (Without Screen)

- ▶ Heights exceeding 2600mm require reinforcement components
- ▶ Sash widths exceeding 1200mm require 8 wheels

Seal all connection gaps with appropriate sealant for improved water resistance.





In-ground installation:

Maximum depth 15mm. Do not block drainage systems.

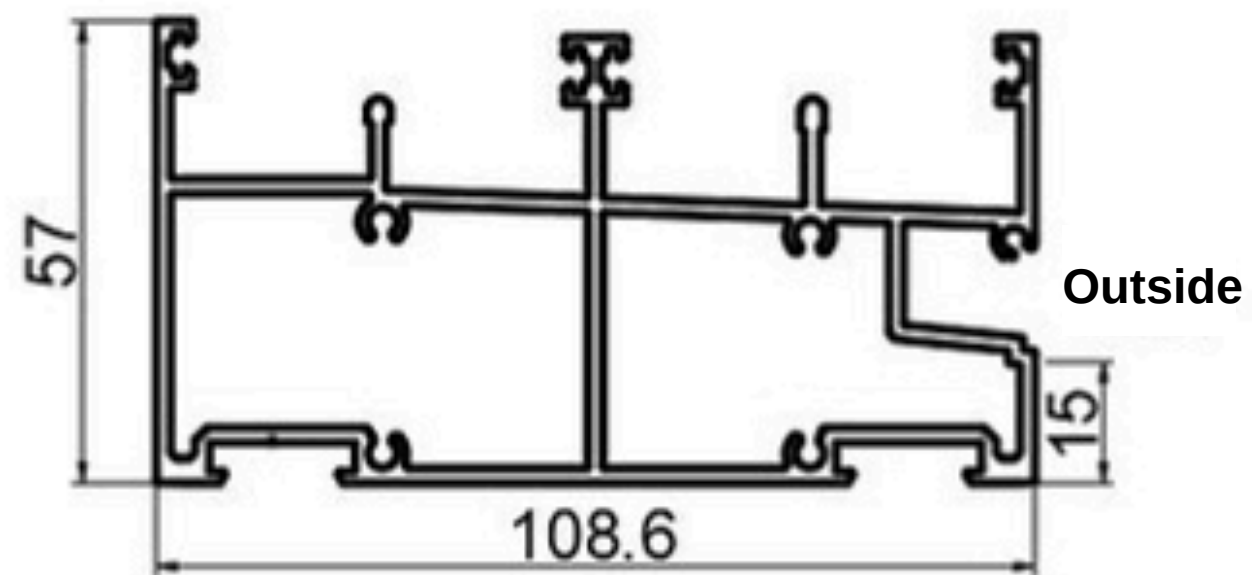

Two-track

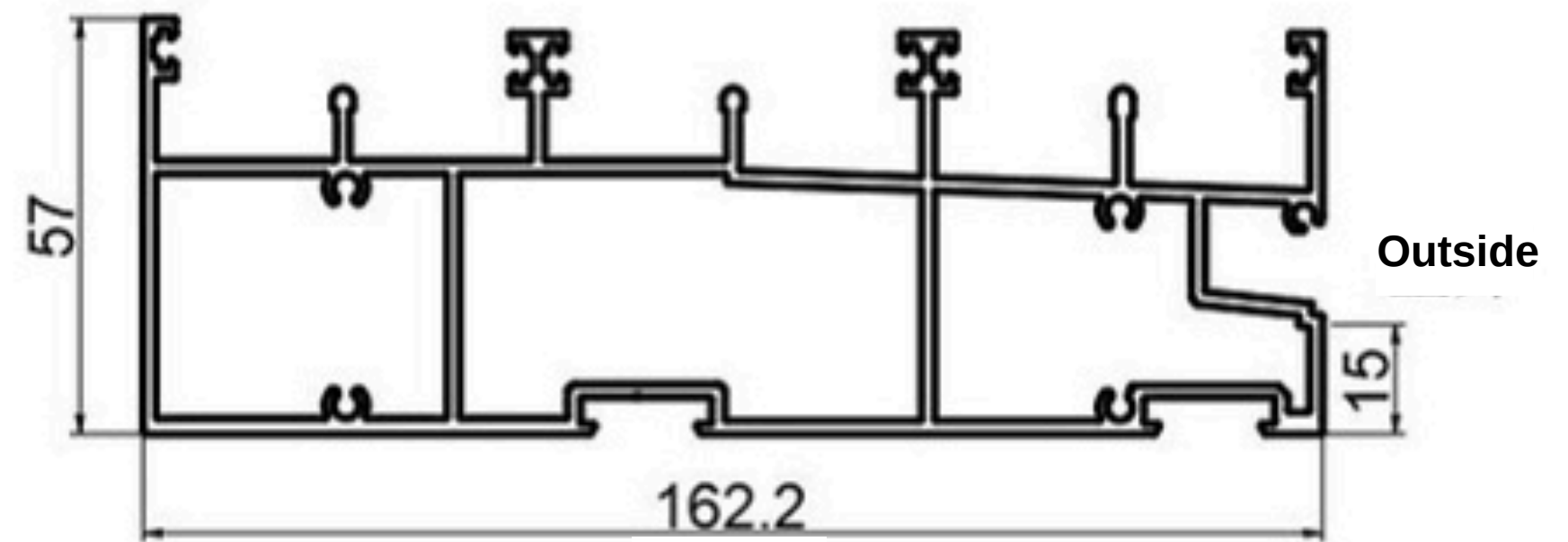

Three-track

▼

When selecting panels with reinforced glazing beads, note that the reinforced profile extends outward from the frame. Ensure sufficient clearance space is provided during installation to accommodate the extended profile and allow proper panel operation.

Reinforcement glazing bead extends 31mm beyond outer frame

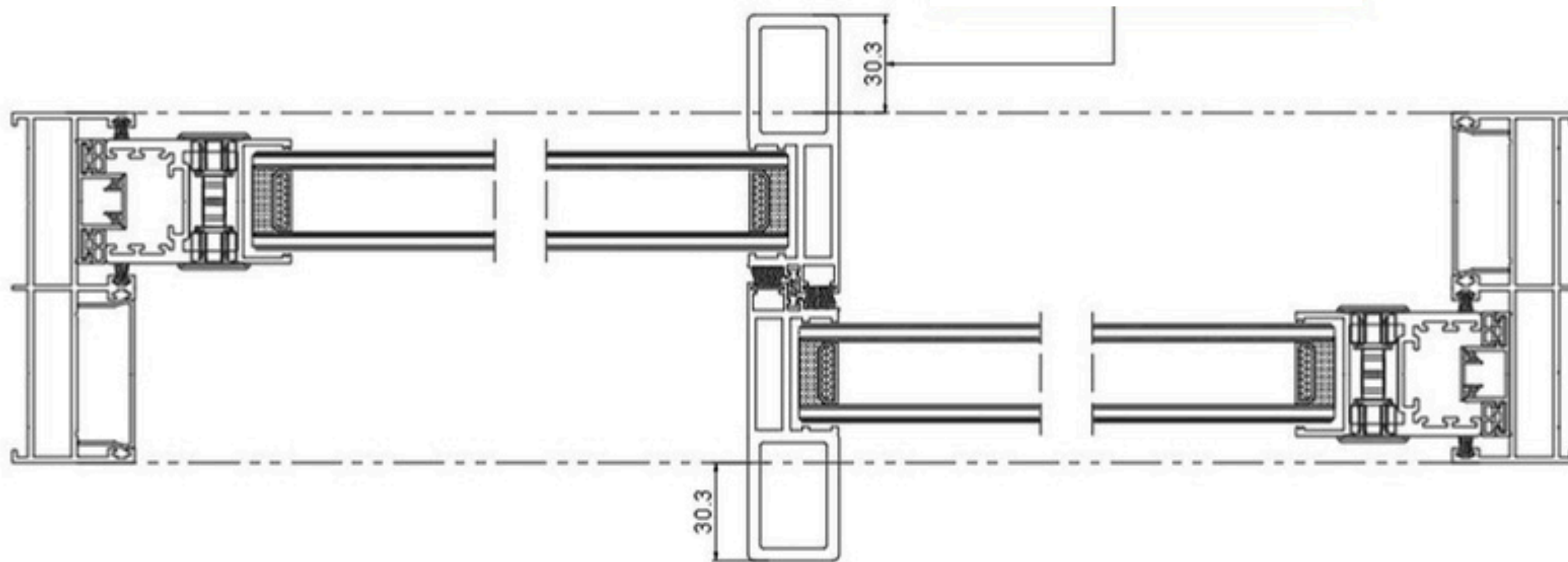



BIMX Pro Sliding Door Options for Edge cover

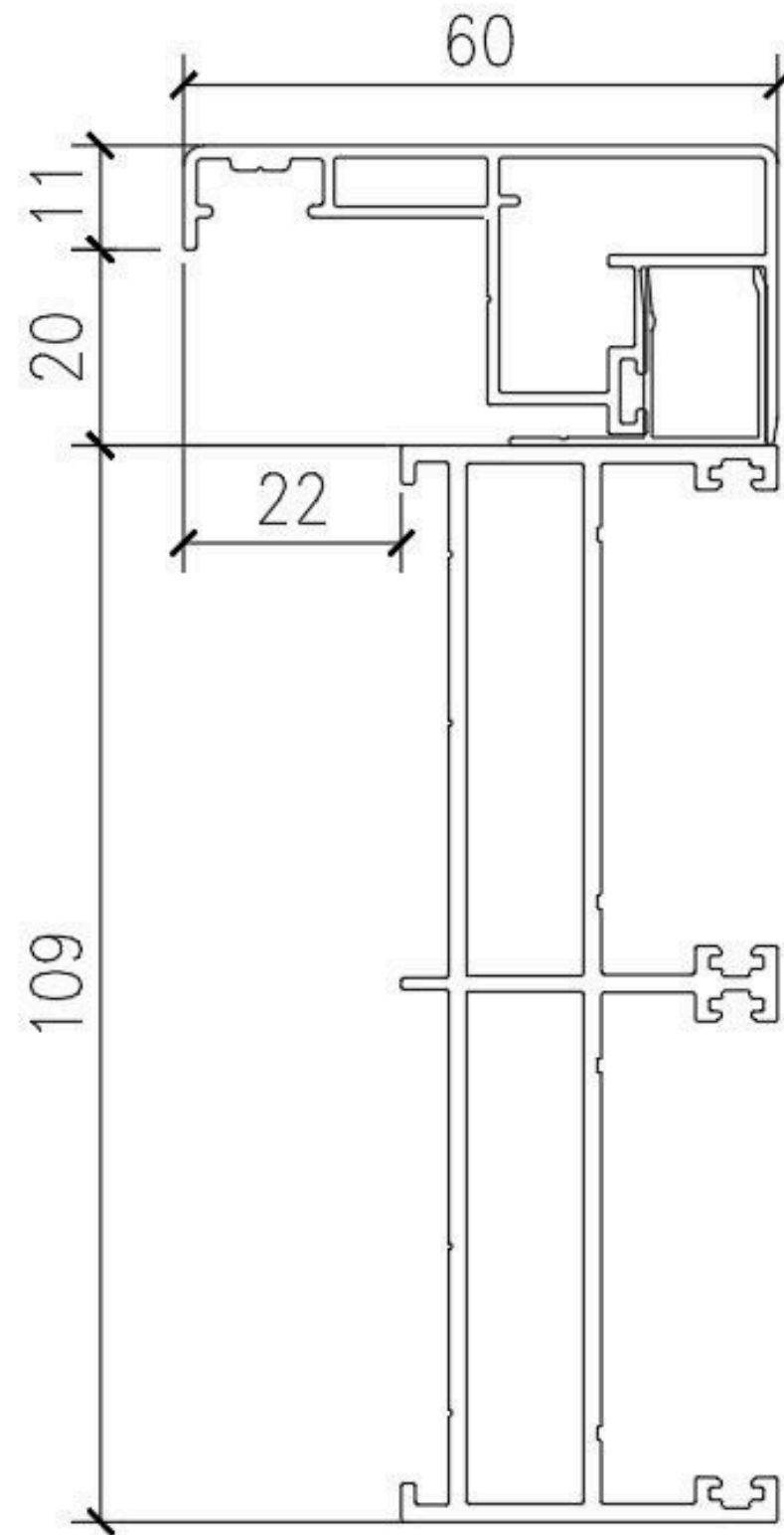

Minimalist 60mm Edge Cover

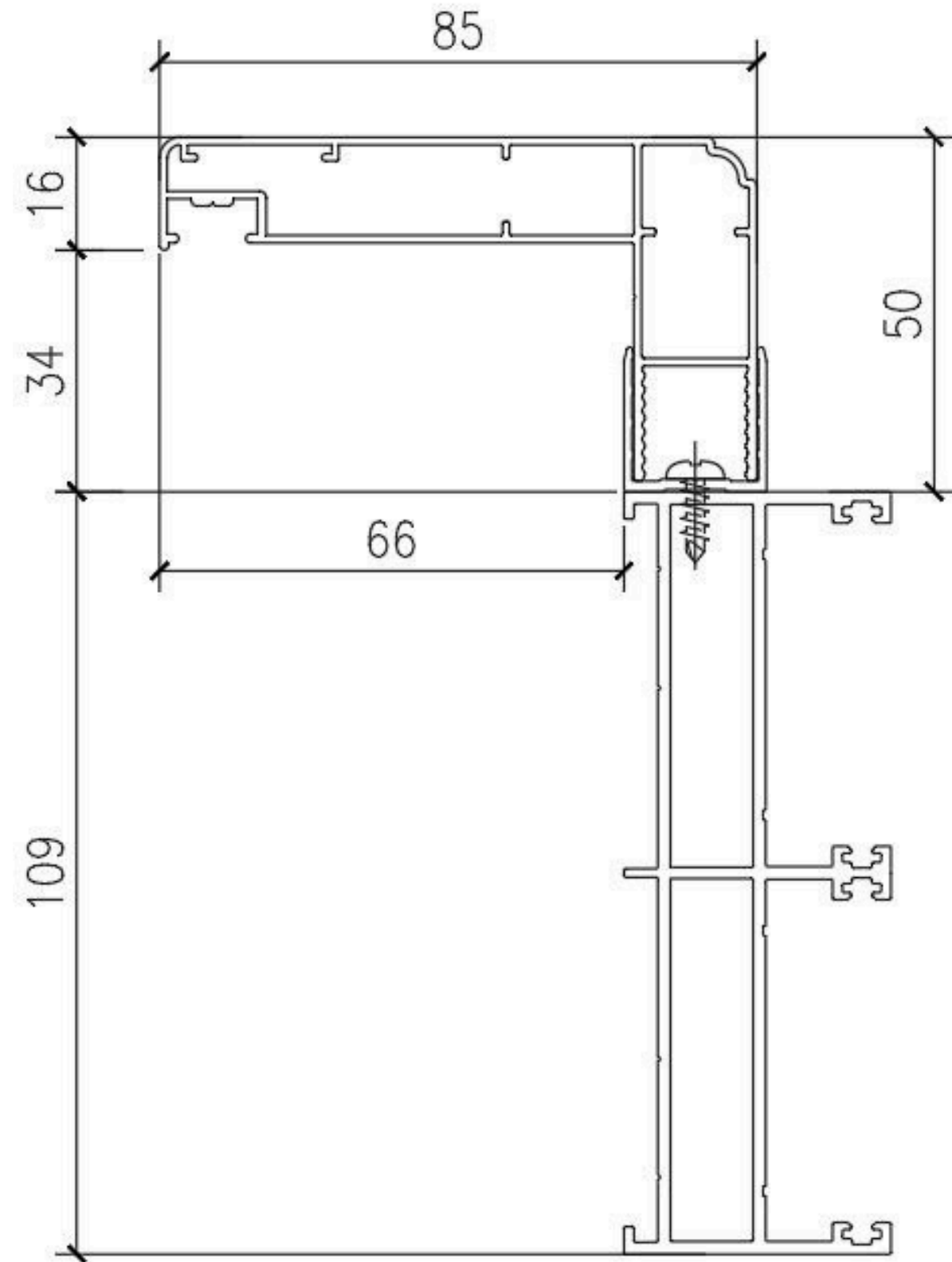

Flat Panel 85cm Edge Cover

▼

BIMX Pro Sliding Door Options for Edge cover

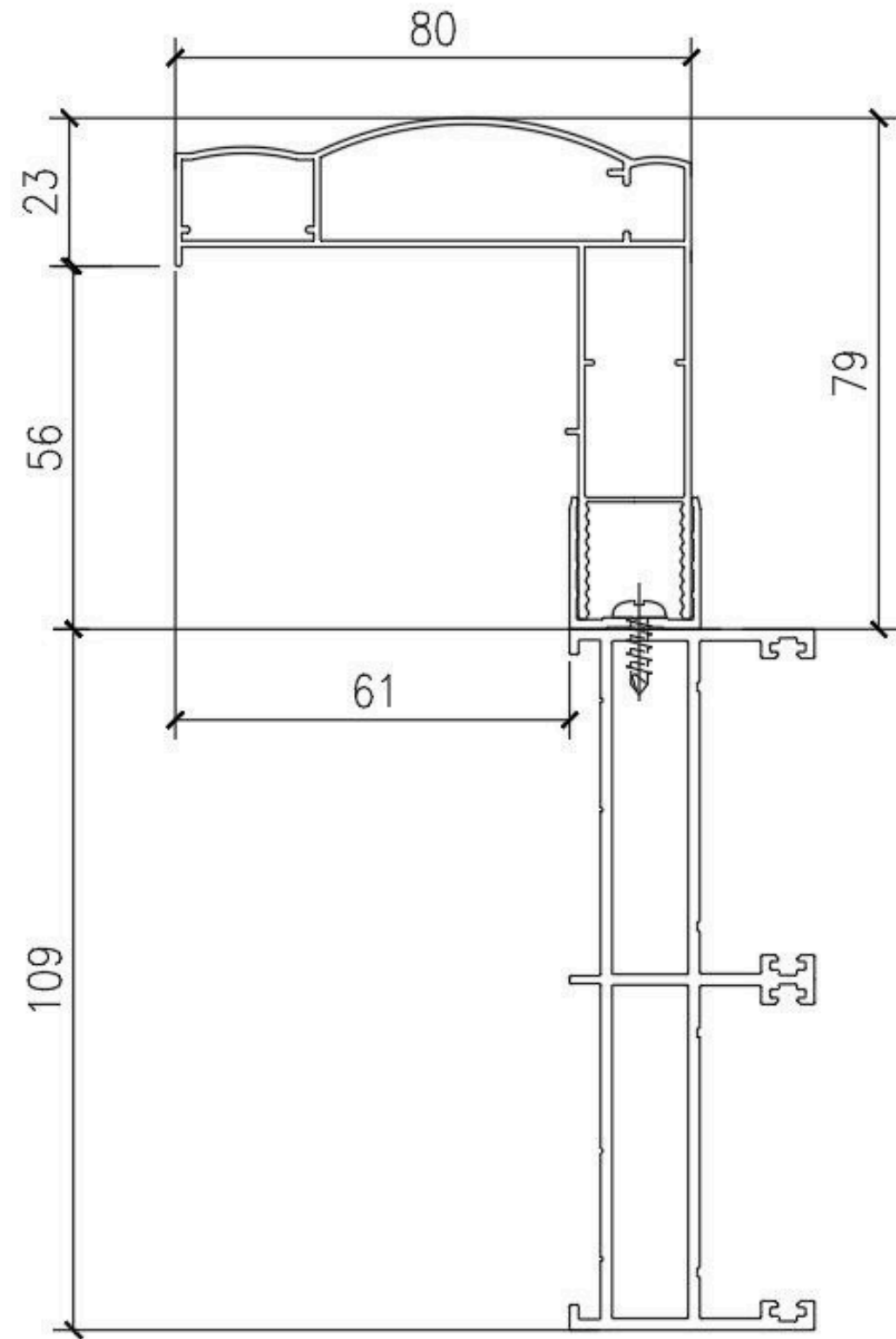

8cm Edge Trim Profile

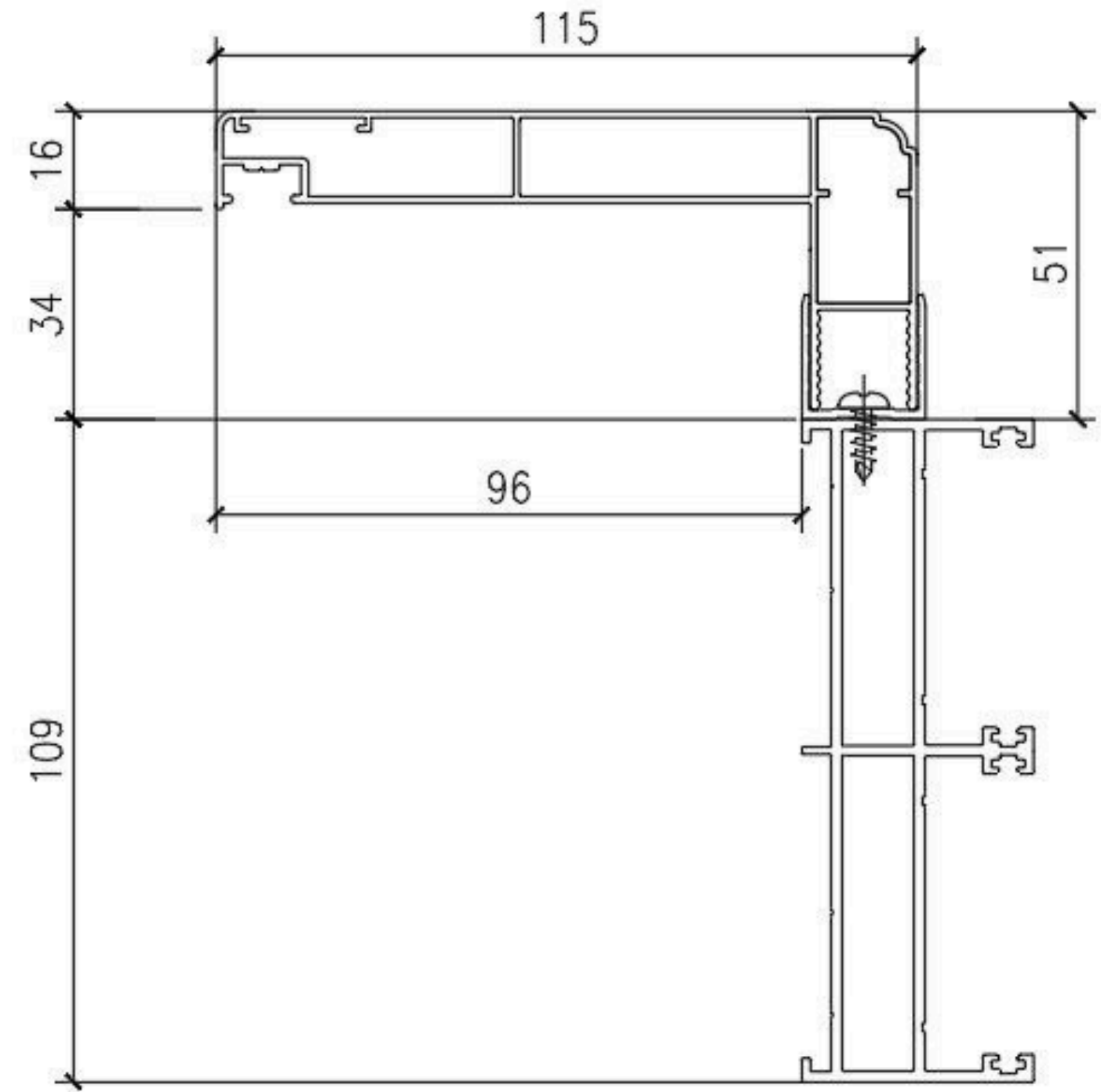

Flat Panel Edge Cover 11.5cm



BIMX Pro Sliding Door Hardware Components

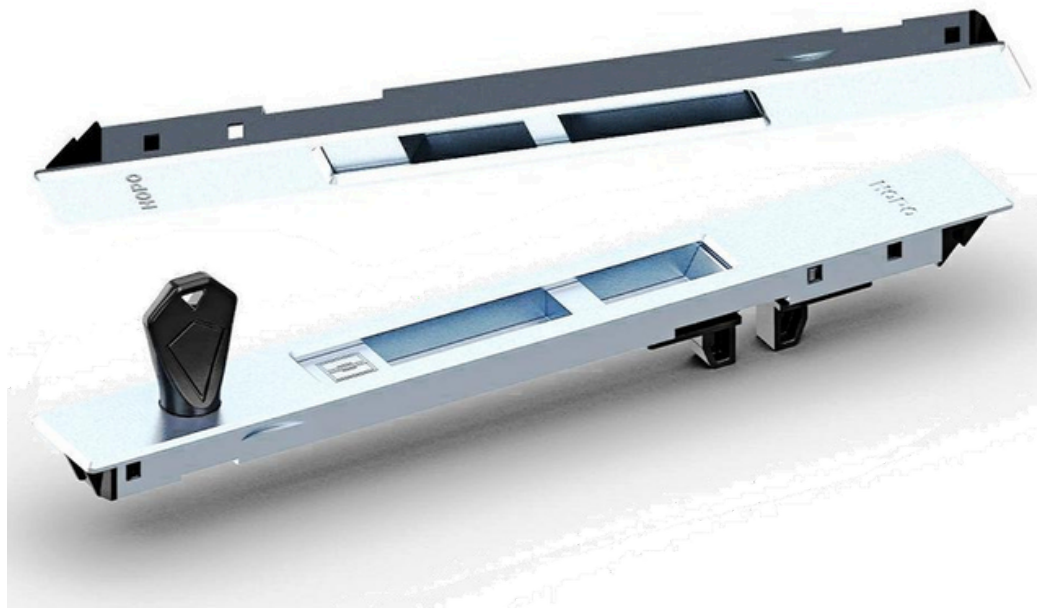

Germany Hoppe slim lock



Bottom wheel 4 pcs

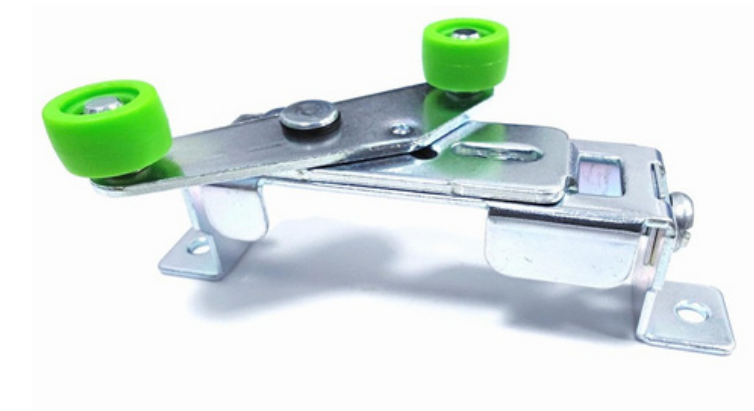

Balance wheel



BIMX Pro Sliding Door Lock and Handle Options

Image Configuration: Moyee
Double Hook Lock + Double-
sided Baogao Mini Handle



MOYEE
摩耶·平开门窗五金

HOOK SHAPE⁺
Locking system

勾状 锁闭系统



BIMX Pro Sliding Door Lock and Handle Options

Image Configuration: Moyee
Six-Hook Lock + Baogao Mini
Handle



BIMX Pro Sliding Door Handle Options



The Bogo Handle is available in two sizes to accommodate different door dimensions and design preferences:

- ▶ **280mm Small Size** - Compact option suitable for smaller door panels or minimalist designs
- ▶ **420mm Big Size** - Larger option providing better grip and visual presence on larger door panels

*Both sizes are compatible with large/small concealed locks**

*Available in black or silver colors**



BIMX Pro Sliding Door Handle Options

All handles shown are compatible with Hobo edge concealed locks.



**New Zealand Handle
(Gold/Silver)**



**Hobo Large Handle/Small Handle
(Antique Bronze/Silver)**



**Ouya Large Handle
(Silver)**



**Ouya Small Handle
(Silver)**



**Ximike Handle
(Silver)**