

Audit and Design: Proposed Basement Plan

Licensed Under Creative Commons Attribution-NonCommercial 4.0 International

This template is licensed under a Creative Commons Attribution-NonCommercial 4.0 International License (CC BY-NC 4.0).

You are free to:

- **Share** — copy and redistribute the material in any medium or format.
- **Adapt** — remix, transform, and build upon the material.

Under the following terms:

- **Attribution (BY):** Credit must be given to Roosevelt Miranda
- **NonCommercial (NC):** Only noncommercial use of this material is permitted. Noncommercial means not primarily intended for or directed toward commercial advantage or monetary compensation.

Learn more: <https://creativecommons.org/licenses/by-nc/4.0/>

BY: Credit must be given to Roosevelt Miranda

NC: Only noncommercial use of your work is permitted.

About: This document provides a proposed basement layout for a future clean energy community resilience hub. Created by Roosevelt Miranda, the plan outlines a simplified, unfinished basement configuration featuring dedicated HVAC areas and ample open space. The drawing is part of a preliminary design intended for adaptation and permitting, serving as an early-stage exploration of how basement areas can be used to support core infrastructure needs of a CCRH.

Usage Description: This example is useful for early-stage design teams and planners considering how to integrate mechanical systems, storage, or resilience features (like emergency supplies or battery storage) below grade. It applies most directly to the infrastructure and design planning phase, and can support:

- Discussions with engineers about HVAC and backup systems
- Estimating available square footage for climate-controlled storage
- Exploring storm resilience strategies (e.g., water-proofing, drainage)

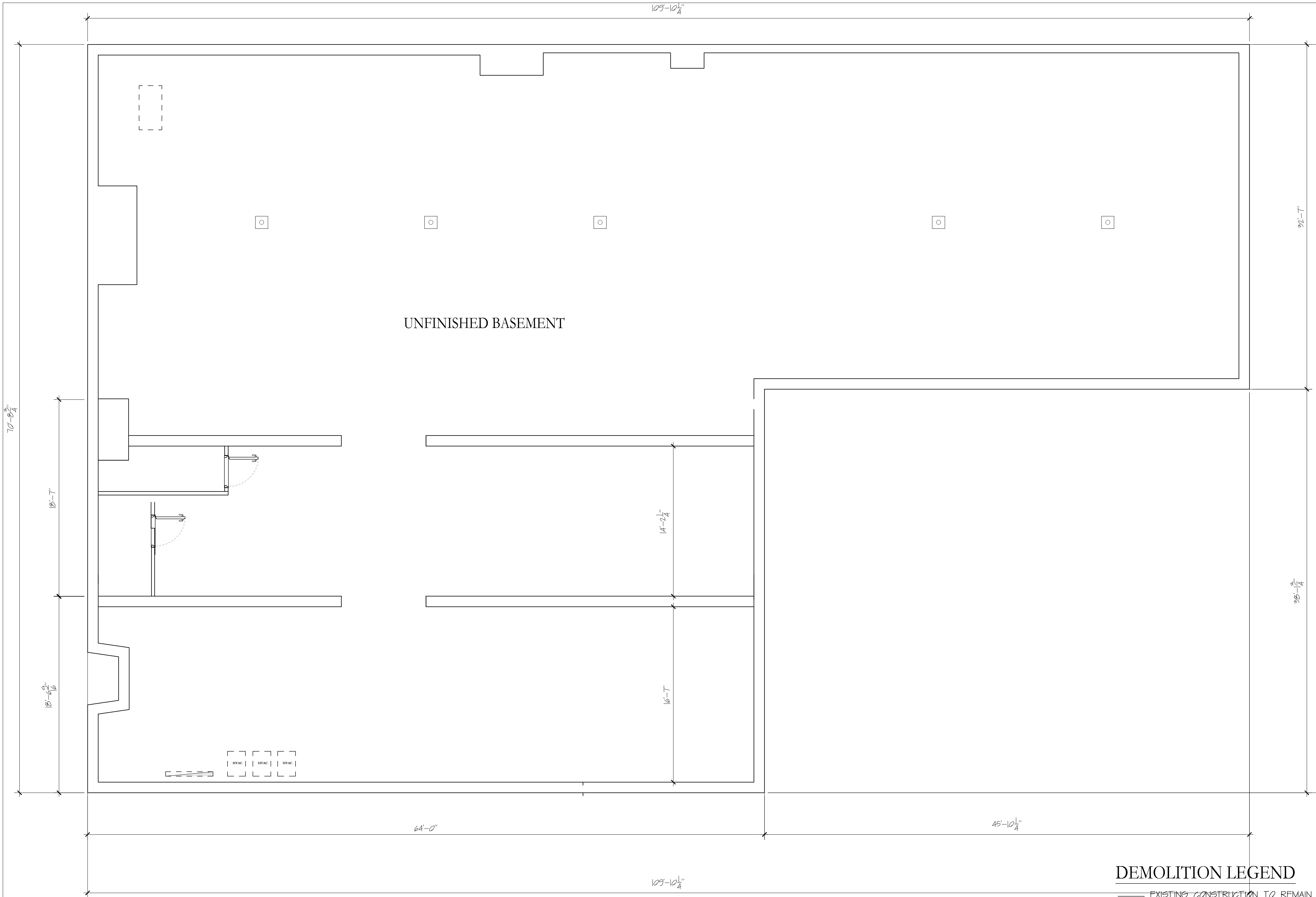

UNFINISHED BASEMENT

CONTACT

DESIGNER : ROOSEVELT MIRANDA
 EMAIL : MIRANDART95@GMAIL.COM
 PHONE : 774-368-1858
 EOR : MIKE GALLERY

STAMP PLANS WILL BE PROVIDE IN THE PERMIT SET

JOB ADDRESS

**321 - BAY ST
 TAUNTON, MA**

ISSUE	DATE	DESCRIPTION OF ISSUE	BY
A	06/11/2025		-

DO NOT SCALE DRAWINGS ALL DRAWINGS ARE PREPARED FOR DESIGN PURPOSE ALL DIMENSION SHOULD BE VERIFIED BY CONTRACTOR ALL IN CASE OF ANY DISCREPANCIES THE OWNER OR CONTRACTOR SHALL CONTACT THE DESIGNER BEFORE DOING ANY WORK.

DEMOLITION LEGEND

- EXISTING CONSTRUCTION TO REMAIN
- - - EXISTING CONSTRUCTION TO BE DEMOLISHED
- ▬ EXISTING CONSTRUCTION TO BE ADD

1 Proposed Basement Plan 1/4"=1'-0"

A10