





# D&N Bending Corporate presentation

2026

# D&N Bending

*Shaping the Future Since 1962:*

*Precision, Innovation, Partnership.*

## Divisions

Roll Forming

Bending

Aluminum Extrusion Fabrication

Prototype

Stamping

Thermoplastic Extrusions

Automation

Tooling & Specialty Machinery



# D&N Bending Overview

- Headquartered in Romeo, MI.
- Family Owned and Operated since 1962
- Prototype (Development), Service, and Production Manufacturing
- Full Design and Tooling Capabilities
- 300,000 sq. ft. of building capacity
- Supplier to OEM to Tier 3 Auto, Heavy Truck, Non-Automotive



# Why partner with D&N Bending?

## **Flexibility from Prototype to Production**

- Prototype to Production customer relationship
- Value Added Capabilities: CNC, Laser cut/trim, stamping, assemblies, robotic welding

## **Industry Trusted Quality**

- Customers include OEM to Tier 3
- 5 Supplier of the year awards
- Over 60 years of industry experience

## **Vertical Integration**

- In house design, validation, tooling, & manufacturing minimizes cost & lead time

*“Manufacturing the Future Together”*

# Manufacturing Locations



## Building 1 (B1)

101 E Pond Dr  
Romeo MI 48065

- Prototype
- Robotic Welding



## Building 2 (B2)

111 E Pond Dr  
Romeo MI 48065

- Tooling
- Stamping
- Production



## Building 3 (B3)

121 E Pond Dr  
Romeo MI 48065

- Manufacturing
- Lasers
- Production



## Building 4 (B4)

150 Shafer Drive  
Romeo MI 48065

- Assembly
- Metal Finishing
- Production



## Roll Form Division

15055 32 Mile Rd  
Romeo MI 48065

- Tooling
- Roll Form
- Production



## Service & Warehouse

6892 Maple Valley Rd  
Brown City MI 48416

- 7 Buildings
- Heated & Cold storage

# Manufacturing overview



<https://youtu.be/V6uu5MkA6cs>

# Quality

IATF 16949  
ISO 9001



- PLEX - ERP system
- Zett Mess Coordinate Measuring Machine
- PC DMIS
- 5' x 9' (1.5 x 2.7 M) measuring surface
- Romer 75301S
- 40" (1016 mm) measuring circumference
- 7 axis portable scanner
- PolyWorks software

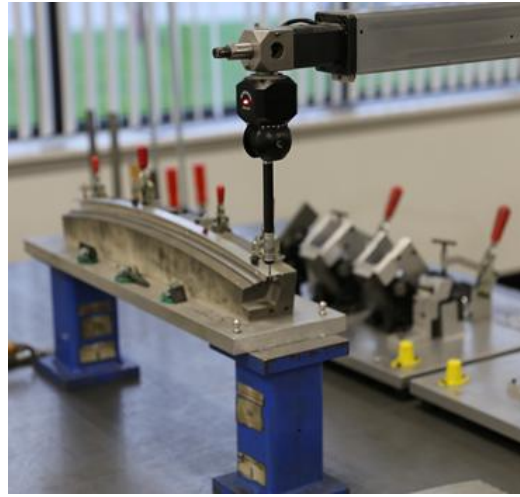

# Production Capabilities

## Low - High volumes

- 7 dedicated buildings
- Stamping, bending, roll forming & assembly
- 2 metal finishing dust-controlled areas
  - Steel
  - Aluminum
- Room for expansion



# Roll Forming

- 23 Roll Form lines
- Mill diameters
  - 1.5", 2.0", 2.5", 3.0", 3.5", 4.0"
  - (38, 51, 64, 76, 89, 102 mm)
- Largest width 60" (1524 mm)
- Max thickness 0.145" (3.7 mm)
- In House: Design, Prototype, Tooling Build, Production
- Pre-Notch, In-Line Sweep/Weld, Cutoff Die Capabilities
- Restore damaged or worn rolls



# Roll Forming

- Automated pick & place
- Pre-Notch, In-Line Sweep/Weld, Cutoff Die Capabilities
- Inline sensors

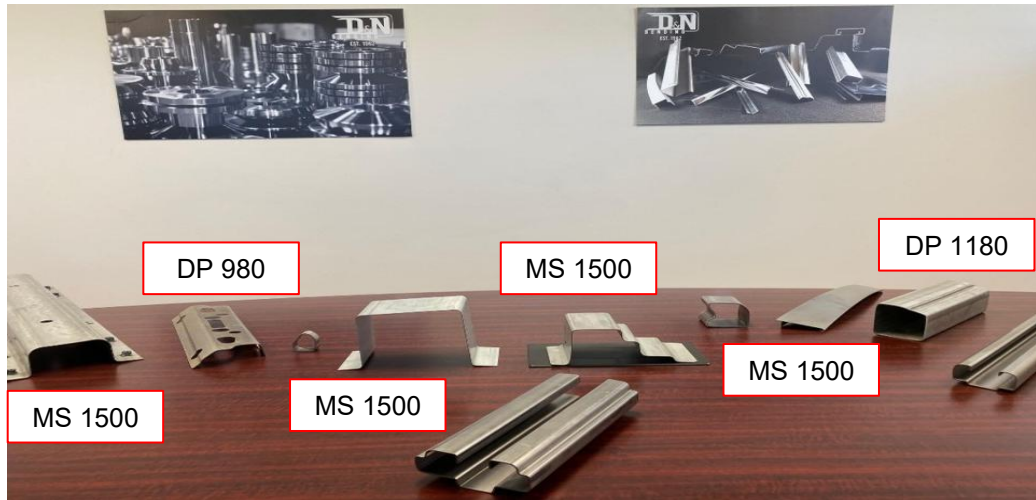

## Materials:

- High strength steels
- Dual Phase
- Stainless Steels
- Martensitic
- Pre-Coated
- Aluminum



# Class "A" manufacturing

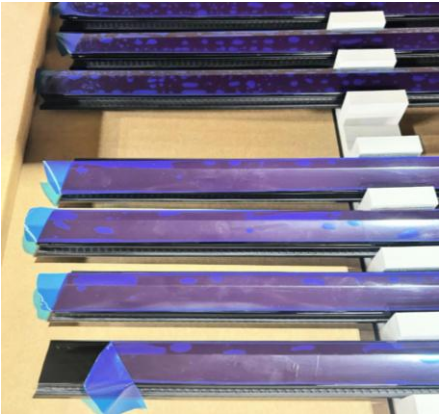

# Bending

CNC, Stretch, Form, Roller, & Pressure Benders

- Door frames
- Door upper reveals
- Door belts
- Glass channel reinforcements
- Division post
- Bumper beams
- Ditch moldings
- Tube bending

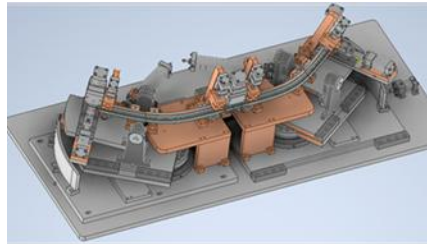
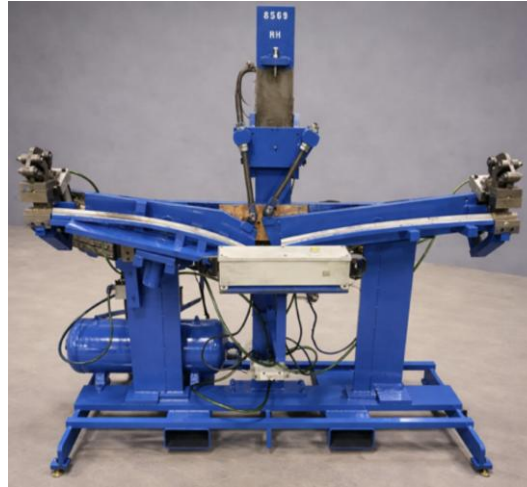

# Aluminum Extrusion Fabrication

- Forming & Bending
- CNC Drilling & Milling
- Assemblies
- Punching/Notching/Deburring
- Bumper beams
- Coatings: Anodize, Chrome, Powder Coat, E-Coat, Wet Spray

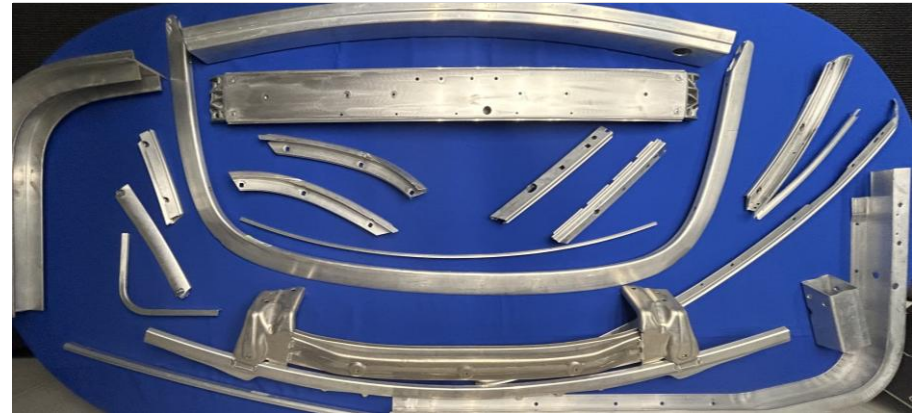

# Prototype

- Bending & Forming
- MIG, TIG, & Spot welding
- CNC Mills
- Laser trim & cut
- Stamping & Pierce
- Assemblies
- Gages

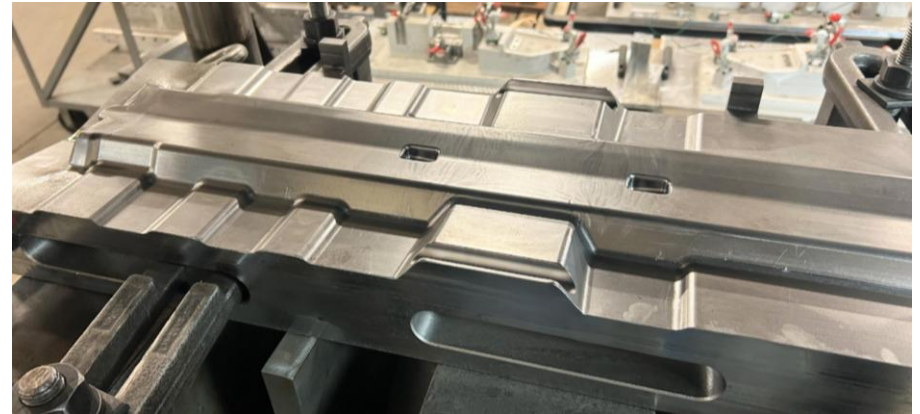

# Drawbench Process

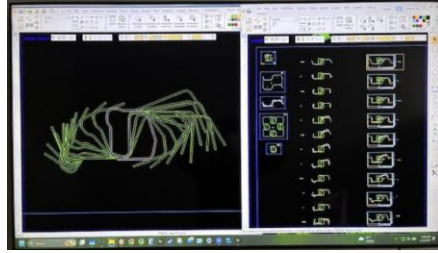

Design



Tooling

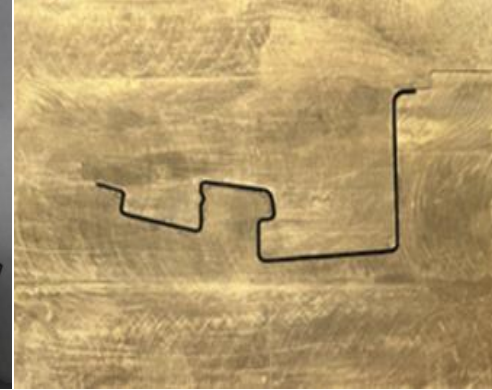

## What is Drawbench?

- Prototype Roll Form Development
- Material is pulled through Dies vs Roll Passes
- Effective with multiple materials

## Customer Value

- Validates production roll form cross section in prototype stage
- Minimizes prototype tooling cost, responsive timing, convenience to production
- Drawbench to Production Roll Forming provides a smooth transition maximizing cost efficiency, minimizing risk, and proves a trusted source in D&N Bending



# Drawbench Pull through profiles

- Closed section welding
  - Laser
  - Mig
  - Tig
  - Spot
  
- Mechanical Locking



DP 1180



MS 1500



MS 1500

DP 1180

DP 980

MS 1500

DP 980

# Stamping

- 50 total presses in-house
- Brackets, bright trim, belts, etc.
- Simulation for stamping
- Development assistance
- Hydraulic and mechanical presses
- Up to 400 tons with bed sizes up to 60" x 110" (1525 x 2795 mm)

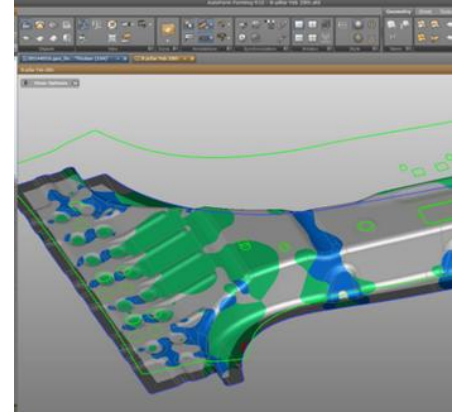

# Automation

- Robotic welders (Steel & Aluminum)
- Pick & Place
- Cell design capabilities
- Internal programming

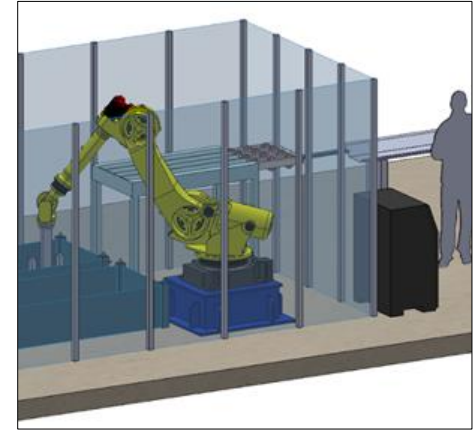

# Custom Machinery & Tooling

- Tool design/development and simulation
- Transfer Dies & Line Dies
- Trim, Form & Pierce Dies
- Stand Alone Pierce Units & Saw Machines
- Stretch Bend Tooling



# Tooling & Check Fixtures

- Inhouse

- Design
- 3D printing
- Machining Steel inserts
- Machining Aluminum
- Machining Foam Board
- Certification



- 2 dedicated tool rooms

- Roll form
- Stamping, Gages, & specialty machines
- 4 Lathe CNC's
- 10 Milling CNC's
- 3 Wire EDM's

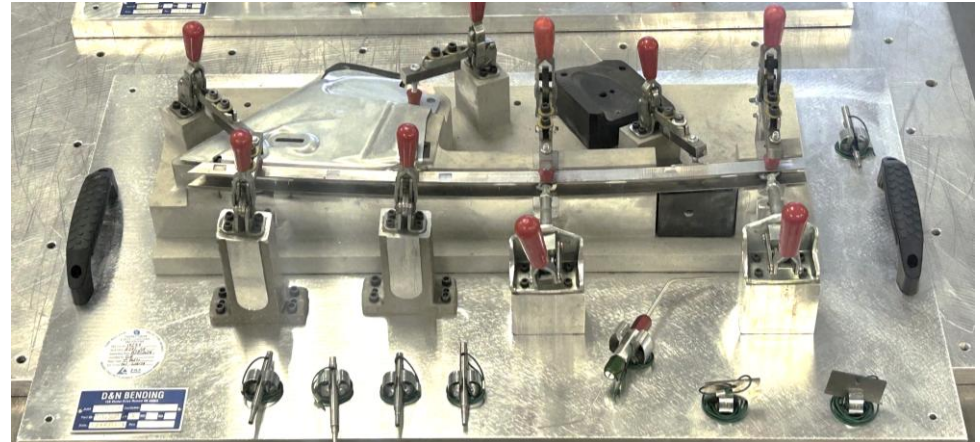

# Fleet vehicles

- 5 Box trucks
- 1 flat bed
- 1 semi (4 trailers)



# D&N Bending Products



# Exterior Products

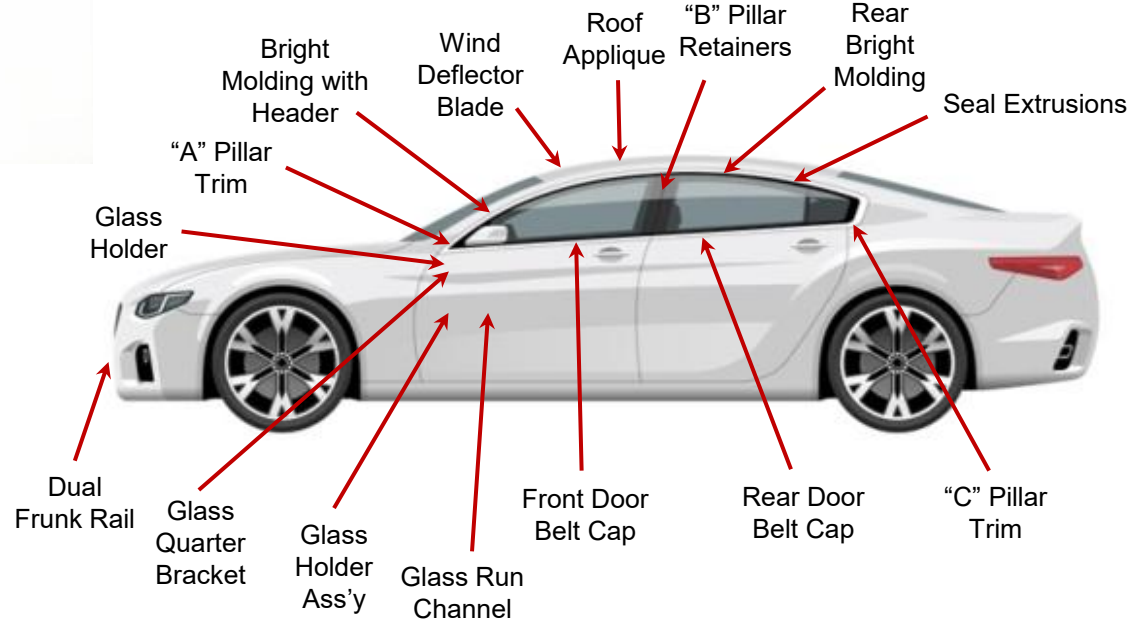
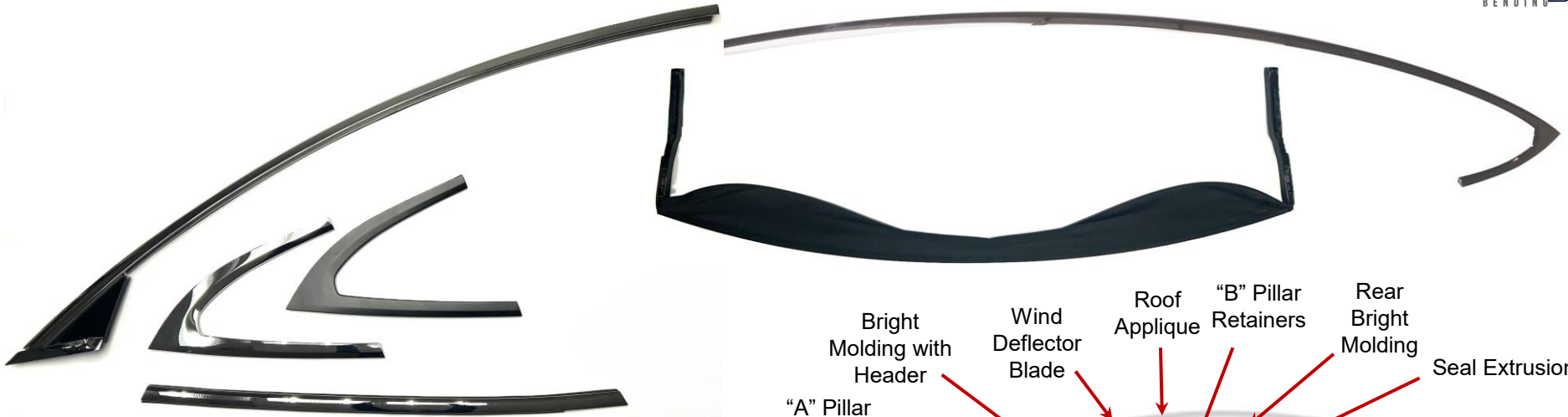

# Full Vehicle Products

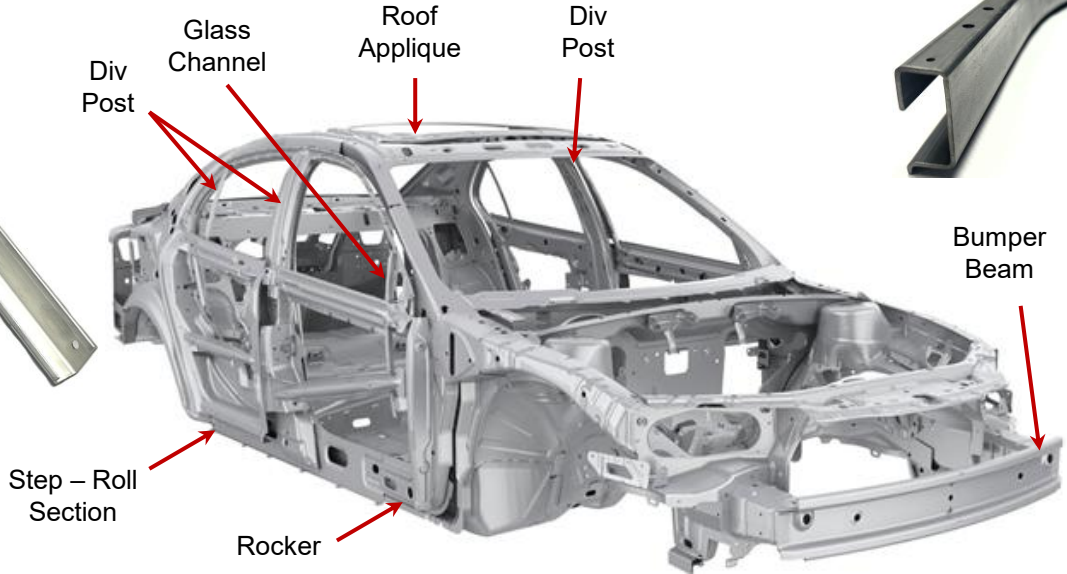

# Convertible Products

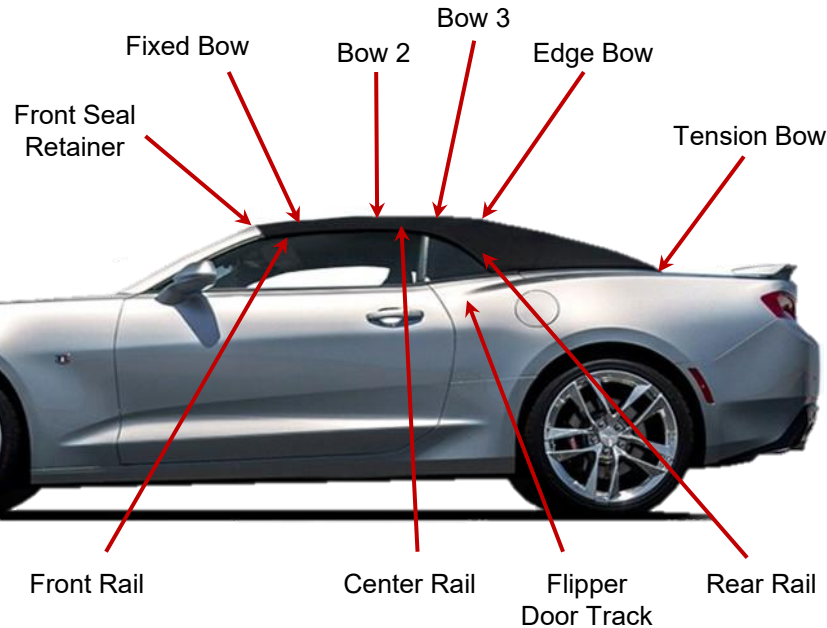

# Heavy Duty Products

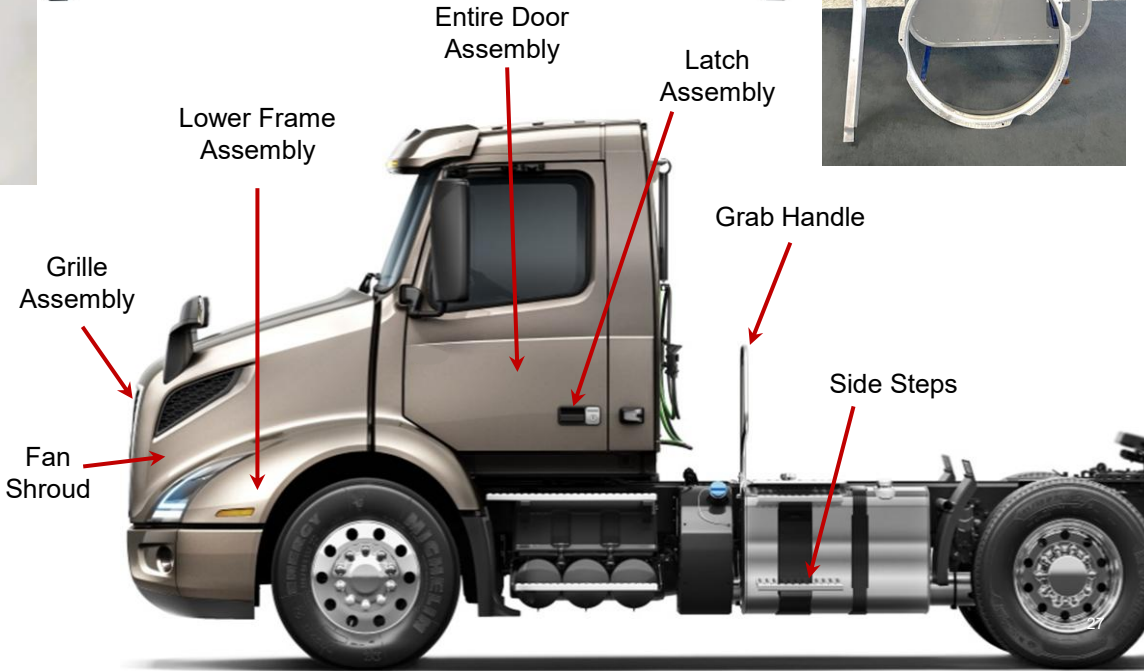

# Non-Automotive Products



Furniture Industry



Brackets  
Offroad

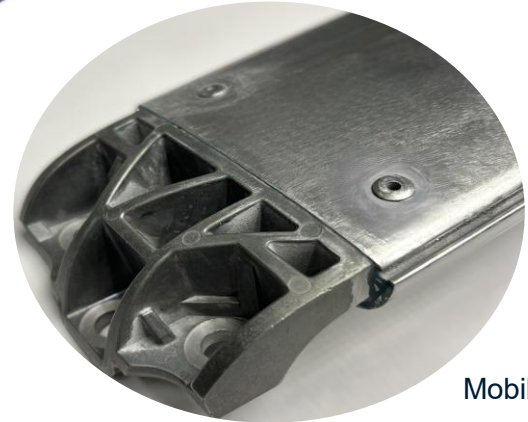

Mobility Industry



Paint Industry



Cover Plates





# D&N Bending Contacts

Mike Weaver - Director of Sales

[mweaver@dnbend.com](mailto:mweaver@dnbend.com)

Mark Filer – Director of Roll Forming

[mfiler@dnbend.com](mailto:mfiler@dnbend.com)

Gary Mispelon - Strategic Accounts

[gmispelon@dnbend.com](mailto:gmispelon@dnbend.com)

Mike Murray - VP Operations

[mmurray@dnbend.com](mailto:mmurray@dnbend.com)

Quote Team

[quote@dnbend.com](mailto:quote@dnbend.com)

Website

<https://dnbending.com/>