

Center Basket

A balanced linear fixture designed to deliver uniform ambient light with controlled distribution. The open basket design softens output while maintaining efficiency, making it suitable for offices, classrooms, and other commercial interiors where visual comfort and consistency are important. Built for reliable performance, the fixture integrates easily into a range of ceiling applications.

- Available in standard commercial sizes, including 1×4 and 2×4 configurations.
- Selectable wattage options to accommodate different ceiling heights and lighting requirements.
- Field-selectable color temperatures including 3000K, 3500K, 4000K, and 5000K.
- Operates on 120–277V input for broad commercial compatibility.
- Center basket design provides uniform, glare-controlled illumination.
- Suitable for recessed or surface ceiling installations.
- Optional occupancy sensor available for energy savings.
- Optional emergency backup for code-compliant egress lighting.
- Rated for long service life to reduce maintenance and replacement frequency.

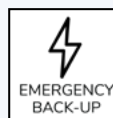
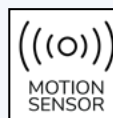

Performance Data

Product ID	Size	Wattage	Lumens	CCT	Efficacy	CRI	Angle
LFC-BSKT-22-40MW	2' x 2'	20, 25, 30, 35, 40W (selectable)	3000 - 6000	30K, 35K, 40K, 50K, 65K (selectable)	150	>80	110°
LFC-BSKT-24-60MW	2' x 4'	20, 30, 40, 50, 60 (selectable)	3000 - 9000				

Ordering Information

FIXTURE	
LFC-BSKT	Lighting FC Center Basket Fixture
SIZE	
2' x 2'	20, 25, 30, 35, 40W (selectable)
2' x 4'	20, 30, 40, 50, 60W (selectable)
WATTAGE	
40MW	20, 25, 30, 35, 40W (selectable)
60MW	20, 30, 40, 50, 60W (selectable)

OPTIONS	
-	None
MS	Motion Sensor
EM	Emergency Back-Up
WARRANTY	
5	5 Year Warranty (included)

Important safety instructions

- 1.All instructions should be read very carefully to reduce any kind of risk.
- 2.These luminaires are intended for installation by a qualified electrician in accordance with the National Electrical Code & Local regulations.
- 3.Please check the integrity of the product upon removal from packaging.
- 4.Please make sure the driver supply wiring is of adequate length and rating. Avoid any tension.

Install instruction

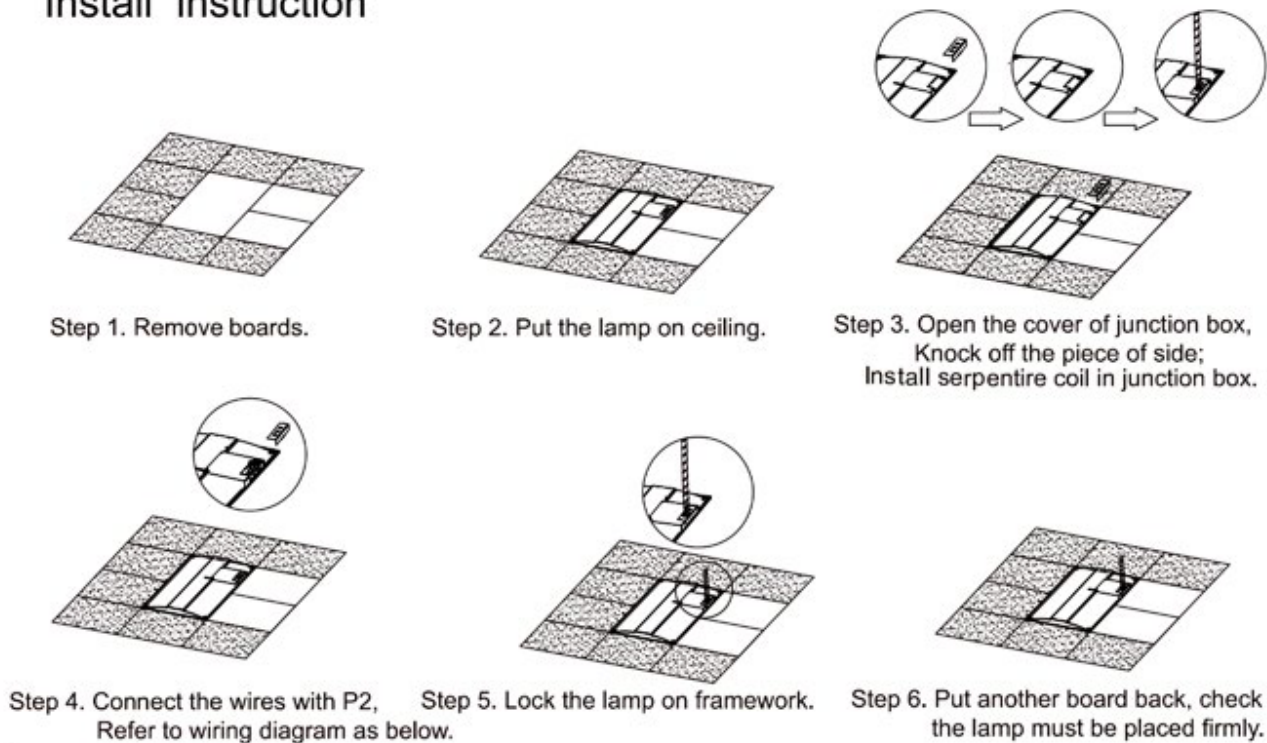

Power& Adjustable



Notes:

- 1.Before wiring the fixture with the power supply,turn off electrical power at fuse or circuit breaker(CB)box.
- 2.Check for the input and output ratings on the fixture label and make sure to use the correct supply voltage.
- 3.Observe proper polarity when connecting power to driver. Unit must be grounded as per code.L = Input Line or Hot, N= Neutral
- 4.All connections should be according to NEC or any applicable local code.

Wiring Diagram

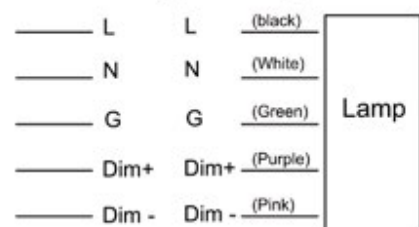

Dimension Diagram

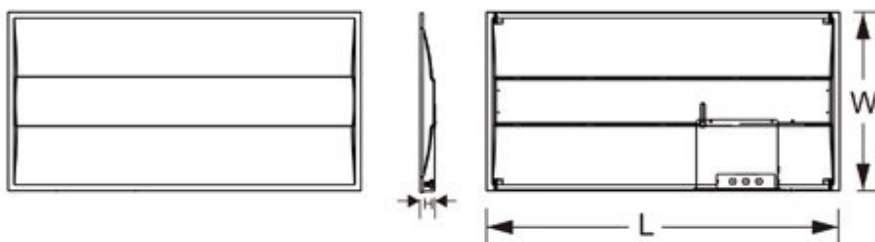

	L	W	H
2'x2	23.7	23.7	1.97
2'x4	47.7	47.7	1.97

Photometrics

2' x 2'

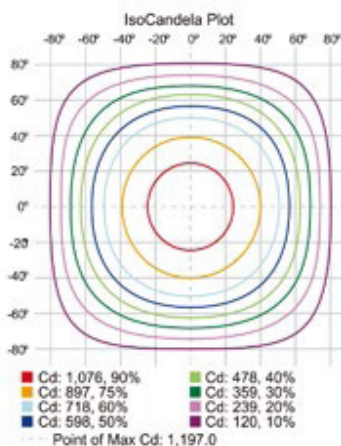
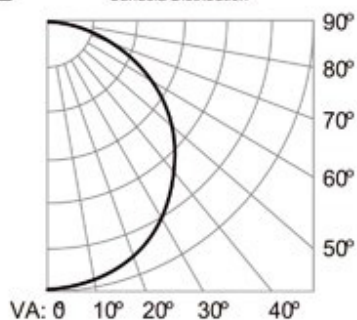
Candela Distribution
Candela Distribution

ZONAL LUMEN SUMMARY

ZONE	LUMENS	% LUMINAIRE	ZONE	LUMENS	% TOTAL	ZONE
0-30	930.9	26.9%	0-10	113.2	3.3%	90-100
0-40	1,527.9	44.1%	10-20	324.5	9.4%	100-110
0-60	2,714.0	78.4%	20-30	493.2	14.2%	110-120
60-90	738.3	21.3%	30-40	597.0	17.2%	120-130
70-100	309.9	9%	40-50	622.1	18.0%	130-140
90-120	4.2	0.1%	50-60	563.9	16.3%	140-150
0-90	3,452.3	99.7%	60-70	429.8	12.4%	150-160
90-180	9.6	0.3%	70-80	245.0	7.1%	160-170
0-180	3,461.9	100%	80-90	63.5	1.8%	170-180

ZONAL LUMEN SUMMARY

ZONE	LUMENS	% LUMINAIRE	ZONE	LUMENS	% TOTAL	ZONE	LUMENS	% TOTAL
0-30	930.9	26.9%	0-10	113.2	3.3%	90-100	1.4	0%
0-40	1,527.9	44.1%	10-20	324.5	9.4%	100-110	1.3	0%
0-60	2,714.0	78.4%	20-30	493.2	14.2%	110-120	1.5	0%
60-90	738.3	21.3%	30-40	597.0	17.2%	120-130	1.5	0%
70-100	309.9	9%	40-50	622.1	18.0%	130-140	1.4	0%
90-120	4.2	0.1%	50-60	563.9	16.3%	140-150	1.0	0%
0-90	3,452.3	99.7%	60-70	429.8	12.4%	150-160	0.7	0%
90-180	9.6	0.3%	70-80	245.0	7.1%	160-170	0.5	0%
0-180	3,461.9	100%	80-90	63.5	1.8%	170-180	0.2	0%

2' x 4'

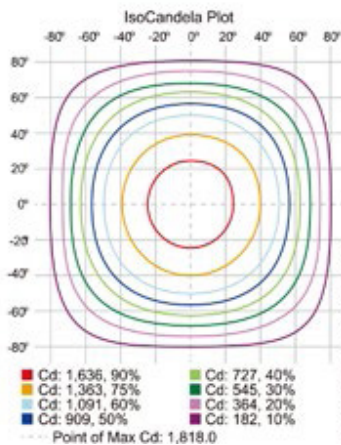
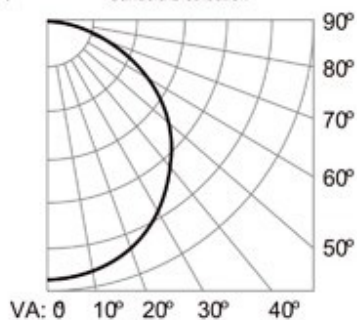
Candela Distribution
Candela Distribution

ZONAL LUMEN SUMMARY

ZONE	LUMENS	% LUMINAIRE	ZONE	LUMENS	% TOTAL	ZONE
0-30	1,417.7	26.8%	0-10	172.1	3.3%	90-100
0-40	2,328.9	44.1%	10-20	494.0	9.4%	100-110
0-60	4,141.5	78.4%	20-30	751.7	14.2%	110-120
60-90	1,131.8	21.4%	30-40	911.2	17.2%	120-130
70-100	476.4	9%	40-50	950.5	18.0%	130-140
90-120	5.1	0.1%	50-60	862.1	16.3%	140-150
0-90	5,273.4	99.8%	60-70	657.4	12.4%	150-160
90-180	9.2	0.2%	70-80	375.8	7.1%	160-170
0-180	5,282.6	100%	80-90	98.6	1.9%	170-180

ZONAL LUMEN SUMMARY

ZONE	LUMENS	% LUMINAIRE	ZONE	LUMENS	% TOTAL	ZONE	LUMENS	% TOTAL
0-30	1,417.7	26.8%	0-10	172.1	3.3%	90-100	2.0	0%
0-40	2,328.9	44.1%	10-20	494.0	9.4%	100-110	1.7	0%
0-60	4,141.5	78.4%	20-30	751.7	14.2%	110-120	1.5	0%
60-90	1,131.8	21.4%	30-40	911.2	17.2%	120-130	1.2	0%
70-100	476.4	9%	40-50	950.5	18.0%	130-140	1.0	0%
90-120	5.1	0.1%	50-60	862.1	16.3%	140-150	0.8	0%
0-90	5,273.4	99.8%	60-70	657.4	12.4%	150-160	0.6	0%
90-180	9.2	0.2%	70-80	375.8	7.1%	160-170	0.4	0%
0-180	5,282.6	100%	80-90	98.6	1.9%	170-180	0.1	0%