

CDAL444

2013 - UP RAM CHASSIS CAB CUMMINS
6.7L, RACE PIPE KIT

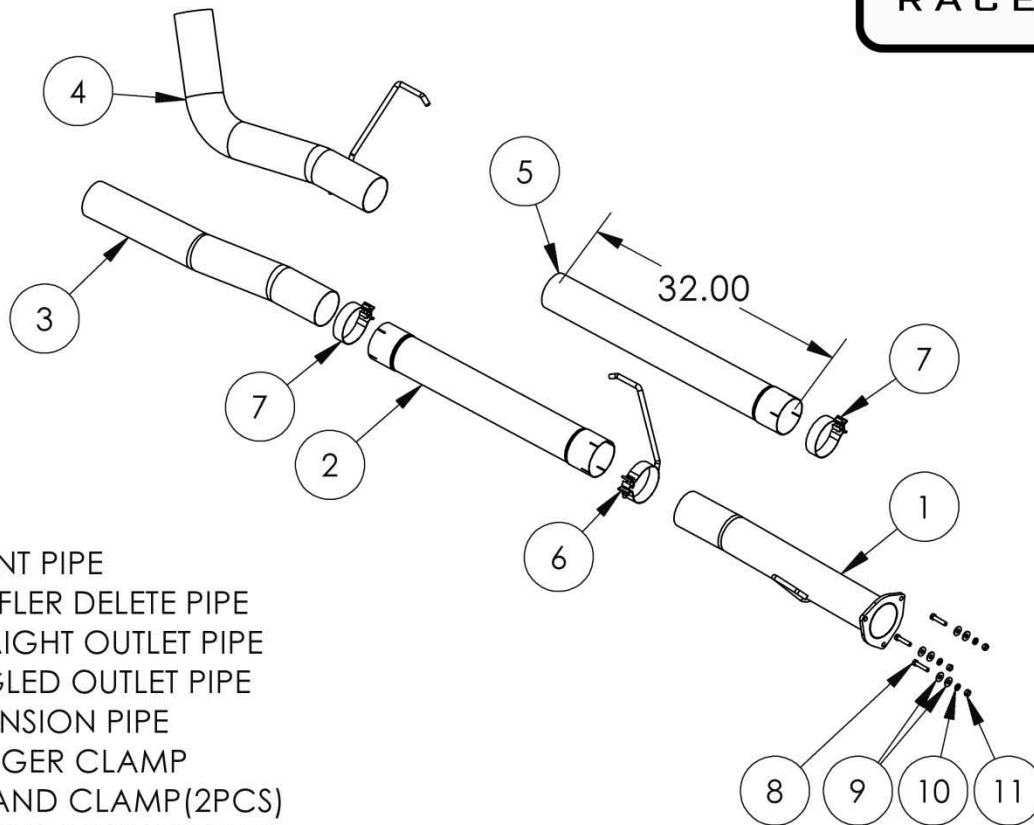
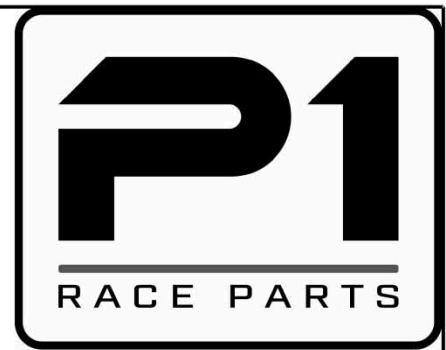

1. FRONT PIPE
2. MUFFLER DELETE PIPE
3. STRAIGHT OUTLET PIPE
4. ANGLED OUTLET PIPE
5. EXTENSION PIPE
6. HANGER CLAMP
7. 4" BAND CLAMP (2PCS)
8. 3/8X1.75" BOLT (3 PCS)
9. 3/8" FLAT WASHER (6 PCS)
10. 3/8" LOCK WASHER (3 PCS)
11. 3/8" NUT (3 PCS)

PLEASE READ BEFORE STARTING INSTALLATION

While P1 Race Parts has made every effort to ensure that all components of this system are of superior quality and properly packaged, it is the installer's responsibility to ensure the following before removal of the factory exhaust:

- that ALL components shown above are present.
- that ALL mating components fit together.
- that there are no damaged components.
- that the system you have purchased is appropriate for your vehicle year, model and configuration.
- that the system will not interfere with any modifications previously installed or planned.
- that you have read and understand these instructions.

If you have any questions or are uncertain about any aspect of the installation of this system to your vehicle please contact your dealer before commencing installation.



Removal of Stock Pipes

1. Apply penetrating lubricant liberally to all exhaust fasteners, hangers and rubber insulators.
2. Disassemble the connection behind the DPF. You may have to completely remove the rear portion of the exhaust depending on your vehicle. Remove the particulate filter by separating at the front 3-bolt flange. Be sure to disconnect sensors and lines before lowering. Removing the filter will require two people.
Refer to Figure 1.



Figure 1

Installation of P1 Race Parts

1. Using the supplied **Hardware** and a new gasket, install the **Front Pipe** onto the factory down pipe and into the factory rubber insulator.
Refer to Figure 2.
2. Vehicles with a DPF outlet that points up (60" Cab-To-Axle) skip to step 4. Vehicles with a straight outlet on the factory DPF (running horizontally), place the **Hanger Clamp** over the **Front Pipe** (hanger points to the rear) and into the factory insulator then loosely install the **Muffler Delete Pipe**.
Refer to Figure 3.



Figure 2

3. Using a **4" Clamp**, loosely install the **Straight Outlet Pipe**. Go to step 7.
Refer to Figure 4.



Figure 3

4. Crew Cab vehicles with a 60" Cab-To-Axle length require the **Extension Pipe** to be installed onto the **Front Pipe** with a **4" Clamp**. For Regular Cab vehicles, place the **Hanger Clamp** over the **Front Pipe** (hanger points to the rear) and into the factory insulator then loosely install the **Muffler Delete Pipe**.
5. For Crew Cab vehicles with a 60" Cab-To-Axle length place the **Hanger Clamp** over the **Extension Pipe** (hanger points to the rear) and into the factory insulator then loosely install the **Muffler Delete Pipe**.



Figure 4

6. Using a **4" Clamp**, loosely install the **Angled Outlet Pipe**.
7. Re-install the factory exhaust. Adjust pipe joints to get the maximum clearance around all components.
8. Tighten all hardware and clamps starting at the front and working rearward to secure the system. Check along the full length of the exhaust system to ensure there is adequate clearance for fuel tank, fuel lines, brake lines, and any wiring, etc. If there is any interference detected, relocate or adjust to provide adequate clearance.

Congratulations! You are ready to begin experiencing the improved power, sound and driving experience of your **P1 Race Parts**.

We know you will enjoy your purchase!