

Safety recommendations

- Read the instructions for use carefully (find this at: www.lopital.com) before use.
- Maximum load 135 kg.
- Make sure that the chair is on the brake during client transfers from and to the device.
- Place the foot rests at the right height and place the feet on the rests.
- Set head support to correct position (usually by tilting).
- Front closure is closed during up / down movements and arms should rest on armrest.
- Only relocate and move the chair in the lower position.

Operation panel

Up



Tilt forwards



Activate



Down



Tilt backwards



Lock button



Important!

This instruction card may not be considered a replacement for the instructions for use.

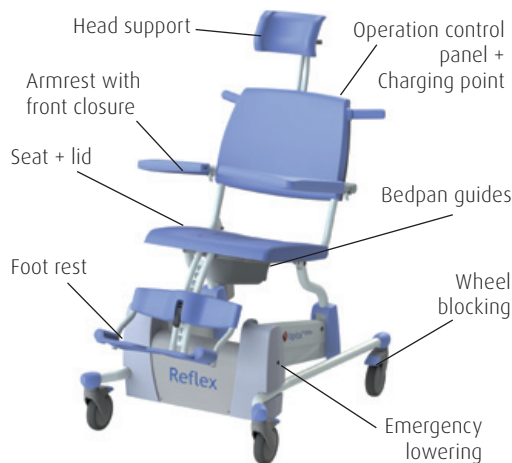

Use

1. Activate the Reflex by pressing the two 'up' buttons simultaneously for 1 second.
Note: After use, the Reflex will go into a sleep setting after 60 minutes.
2. Move the chair into the right position; adjust the head and foot rests too (or fold them up).
3. Apply the brake to the chair!
4. Open the armrests and fold these up if necessary.
5. Support the less able person when they are taking a seat.
6. Close the armrests.

Stand up by carrying out the same procedure in reverse order.

All functions on the Reflex are halted as a result of using the lock button. The Reflex must be reset. You do this by pressing both 'up' buttons for 4 seconds.

Wheel blocking

1. Wheel blocking.
2. Unlocking.

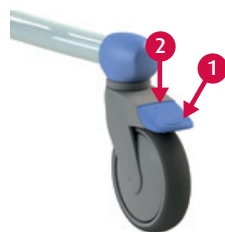

Foot rest

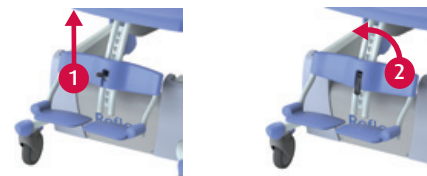

1. Unlocking.
2. Remove complete foot rest.
3. Choose desired position.
4. Hook in and lock.

Head support

1. Set height of support.
2. Set depth of support.

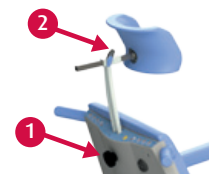

Armrest with front closure

1. Unlocking.
2. Rotating.
3. Folding up.



Charging batteries

After using the Reflex, connect it to the charger to maintain the batteries.



- | | |
|--------------|-----------------------|
| Off | Sleep setting. |
| Green | Chair ready to use. |
| Blinking red | Battery almost empty. |
| Red | Battery empty. |

The Reflex will not work during charging.

Toilet function

- Remove the lid on the seat before the person sits down in the chair.
- *In combination with toilet:* The Reflex can be moved over almost every toilet. Move the chair upwards or downwards to achieve the right position.
- *With bedpan:* The Reflex can also be used as a toilet chair. Simply slide the stainless steel / plastic bedpan under the chair using the guides.

Emergency lowering

If the Reflex breaks down, you can lower the chair using the emergency lowering handle.



Cleaning and maintenance

The Reflex must be cleaned after every use, with water and regular household cleaning agents. Do not use any abrasive or other aggressive cleaning products. Check the wheels regularly for hairs, dust and soap residues and remove when necessary.

The complete maintenance schedule can be found in the instructions for use (**find this at: www.lopital.com**).

In the event of a breakdown, contact Lopital.
Tel: +31 (0)13 - 5239300, **Fax:** +31 (0)13 - 5239301
E-mail: service@lopital.nl

Instructions for use

For the full instructions for use go to **www.lopital.com**