

# KINGS FOUNTAIN DEDINJE

## F-0-S2

Stan / Apartment

Zgrada / Building: F  
 Sprat / Floor: Prizemlje / Ground floor  
 Broj soba / Rooms: 3

1	Ulaz / Entrance	5.78 m <sup>2</sup>
2	Vešernica i ostava / Laundry & Storage	1.97 m <sup>2</sup>
3	Kuhinja / Kitchen	8.96 m <sup>2</sup>
4	Trpezarija / Dining room	20.27 m <sup>2</sup>
5	Dnevna soba / Living room	30.31 m <sup>2</sup>
6	Degažman / Antechamber	12.74 m <sup>2</sup>
7	Kupatilo / Bathroom	4.48 m <sup>2</sup>
8	Spavaća soba / Bedroom	16.79 m <sup>2</sup>
9	Kupatilo / Bathroom	5.41 m <sup>2</sup>
10	Spavaća soba / Bedroom	12.89 m <sup>2</sup>
11	Spavaća soba / Bedroom	11.42 m <sup>2</sup>
12	Garderoba / Wardrobe	4.09 m <sup>2</sup>

Površina stana / Apartment area 135.11m<sup>2</sup>

### Lokacija / Location

U KOMPLEKSU / IN COMPLEX

U ZGRADI / IN BUILDING

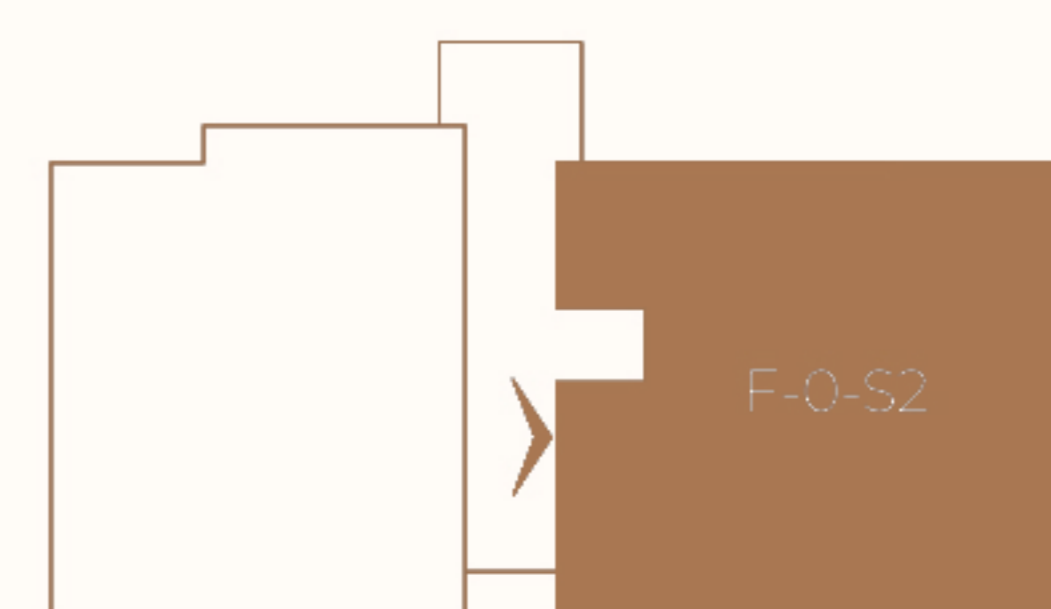
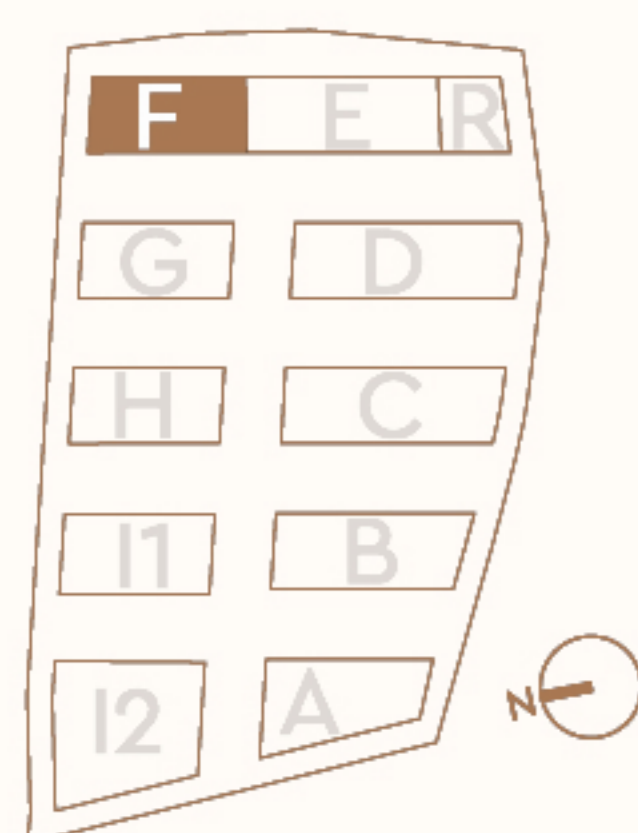

Ovaj plan je zamišljen kao orijentacioni prikaz organizacije i veličine stana. Konačne dimenzije i detalji biće potvrđeni direktno sa agentom prodaje.

This floor plan is intended as a conceptual guide to the apartment's layout and approximate size. Final dimensions and details will be confirmed directly with the sales agent.

