

KINGS FOUNTAIN DEDINJE

F-1-S3

Stan / Apartment

Zgrada / Building: F
Sprat / Floor: 1
Broj soba / Rooms: 3

| | | |
|---------------------------------|--|-----------------------|
| 1 | Ulaz / Entrance | 8.97 m ² |
| 2 | Degažman / Antechamber | 5.32 m ² |
| 3 | Kupatilo / Bathroom | 4.41 m ² |
| 4 | Toalet / Toilet | 1.89 m ² |
| 5 | Kuhinja / Kitchen | 7.74 m ² |
| 6 | Vešernica i ostava / Laundry & Storage | 5.66 m ² |
| 7 | Trpezarija / Dining room | 10.75 m ² |
| 8 | Dnevna soba / Living room | 29.76 m ² |
| 9 | Spavaća soba / Bedroom | 15.04 m ² |
| 10 | Kupatilo / Bathroom | 6.04 m ² |
| 11 | Spavaća soba / Bedroom | 9.68 m ² |
| 12 | Spavaća soba / Bedroom | 11.69 m ² |
| Zatvoreni prostor / Indoor area | | 116.95 m ² |
| 13 | Terasa / Terrace | 9.30 m ² |
| Otvoreni prostor / Outdoor area | | 9.30 m ² |
| Površina stana / Apartment area | | 126.25 m ² |

Lokacija / Location

U KOMPLEKSU / IN COMPLEX

U ZGRADI / IN BUILDING

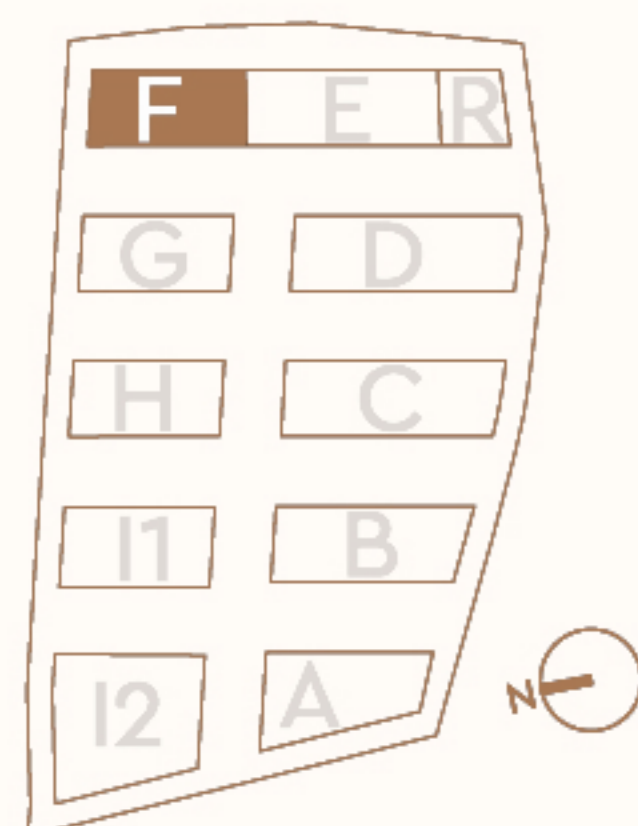

Ovaj plan je zamišljen kao orijentacioni prikaz organizacije i veličine stana. Konačne dimenzije i detalji biće potvrđeni direktno sa agentom prodaje.

This floor plan is intended as a conceptual guide to the apartment's layout and approximate size. Final dimensions and details will be confirmed directly with the sales agent.

