

# KINGS FOUNTAIN DEDINJE

## F-1-S4

Stan / Apartment

Zgrada / Building: F  
Sprat / Floor: 1  
Broj soba / Rooms: 3

1	Ulaz / Entrance	5.78 m <sup>2</sup>
2	Vešernica i ostava / Laundry & Storage	1.97 m <sup>2</sup>
3	Kuhinja / Kitchen	8.96 m <sup>2</sup>
4	Trpezarija / Dining room	14.43 m <sup>2</sup>
5	Dnevna soba / Living room	30.31 m <sup>2</sup>
6	Degažman / Antechamber	12.74 m <sup>2</sup>
7	Kupatilo / Bathroom	4.48 m <sup>2</sup>
8	Spavaća soba / Bedroom	16.79 m <sup>2</sup>
9	Kupatilo / Bathroom	5.41 m <sup>2</sup>
10	Spavaća soba / Bedroom	12.89 m <sup>2</sup>
11	Spavaća soba / Bedroom	11.42 m <sup>2</sup>
12	Garderoba / Wardrobe	4.09 m <sup>2</sup>

Zatvoreni prostor / Indoor area 129.27 m<sup>2</sup>

13 Terasa / Terrace 9.10 m<sup>2</sup>

Otvoreni prostor / Outdoor area 9.10 m<sup>2</sup>

Površina stana / Apartment area 138.37 m<sup>2</sup>

## Lokacija / Location

U KOMPLEKSU / IN COMPLEX

U ZGRADI / IN BUILDING

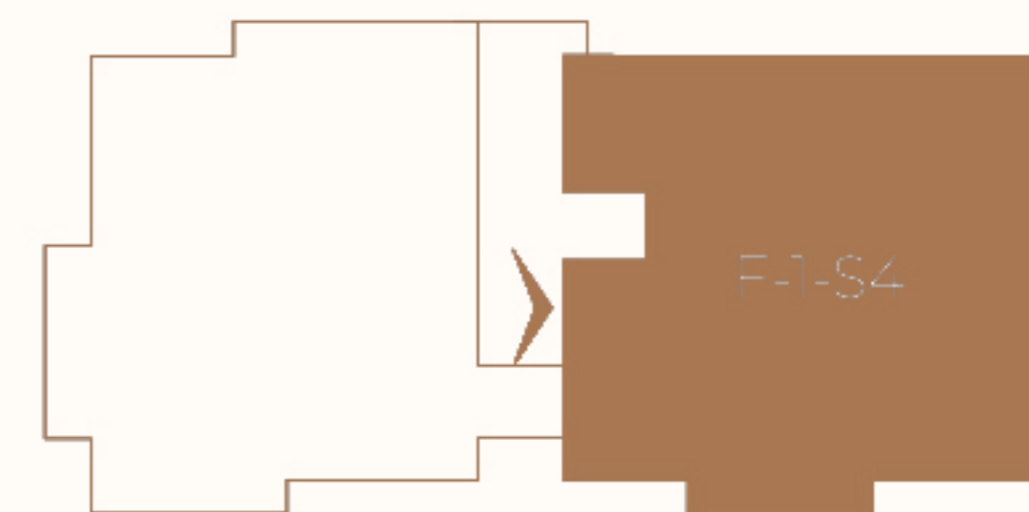
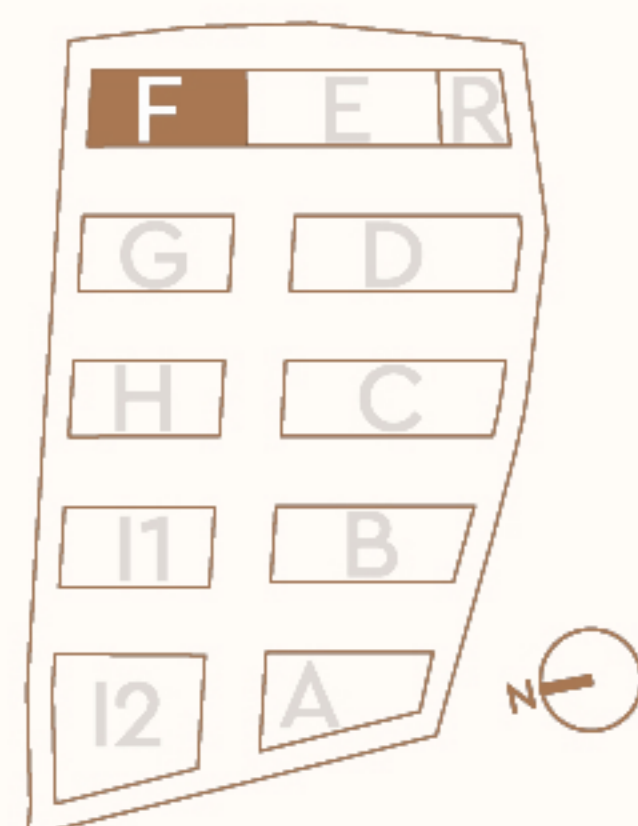

Ovaj plan je zamišljen kao orijentacioni prikaz organizacije i veličine stana. Konačne dimenzije i detalji biće potvrđeni direktno sa agentom prodaje.

This floor plan is intended as a conceptual guide to the apartment's layout and approximate size. Final dimensions and details will be confirmed directly with the sales agent.

