

# KINGS FOUNTAIN DEDINJE

## B2-0-S3

Stan / Apartment

Zgrada / Building: B  
Sprat / Floor: Prizemlje / Ground floor  
Broj soba / Rooms: 1

1	Ulaz / Entrance	4.91 m <sup>2</sup>
2	Toalet / Toilet	2.70 m <sup>2</sup>
3	Kuhinja / Kitchen	3.29 m <sup>2</sup>
4	Dnevna soba i trpezarija / Living & Dining	25.93 m <sup>2</sup>
5	Spavaća soba / Bedroom	15.43 m <sup>2</sup>
6	Kupatilo / Bathroom	5.36 m <sup>2</sup>

Površina stana / Apartment area 57.62 m<sup>2</sup>

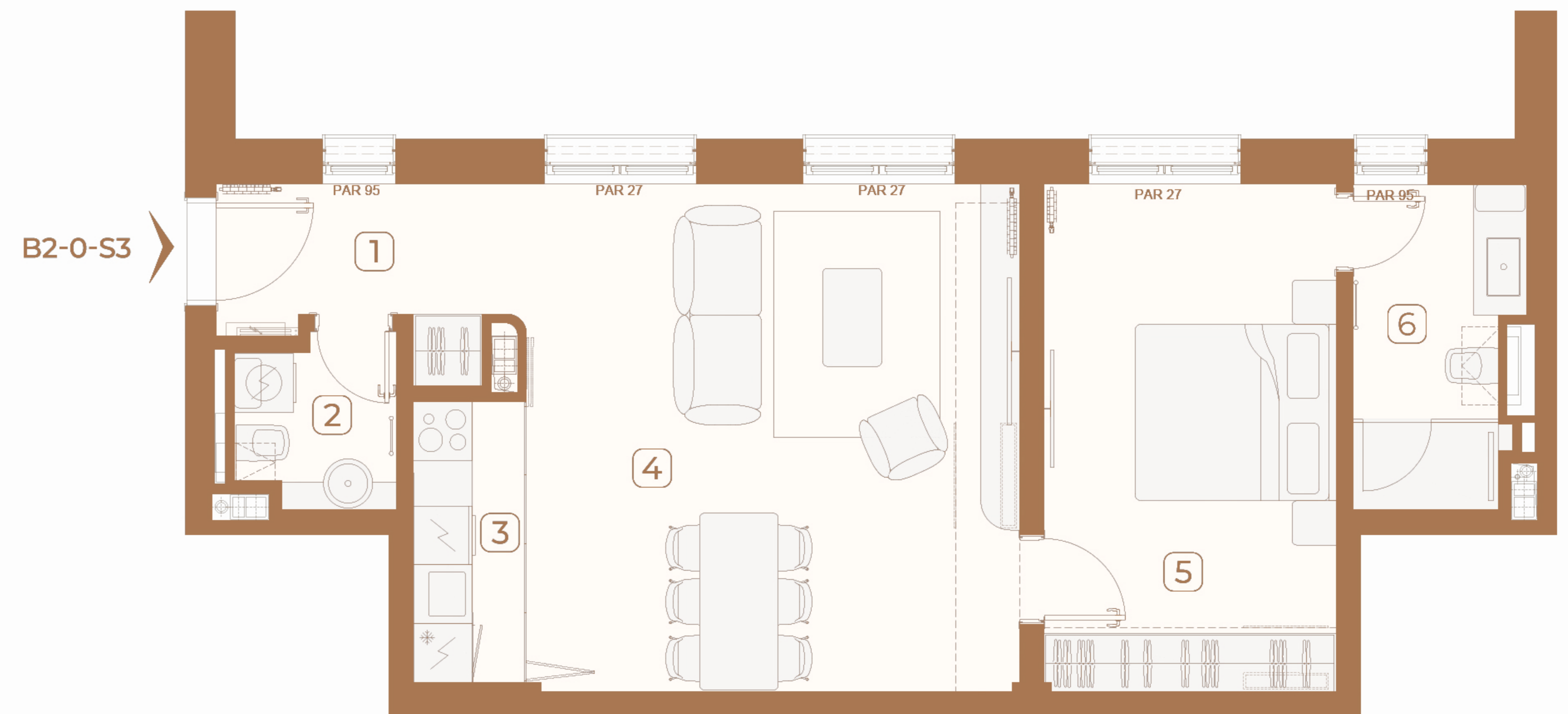

## Lokacija / Location

U KOMPLEKSU / IN COMPLEX

U ZGRADI / IN BUILDING

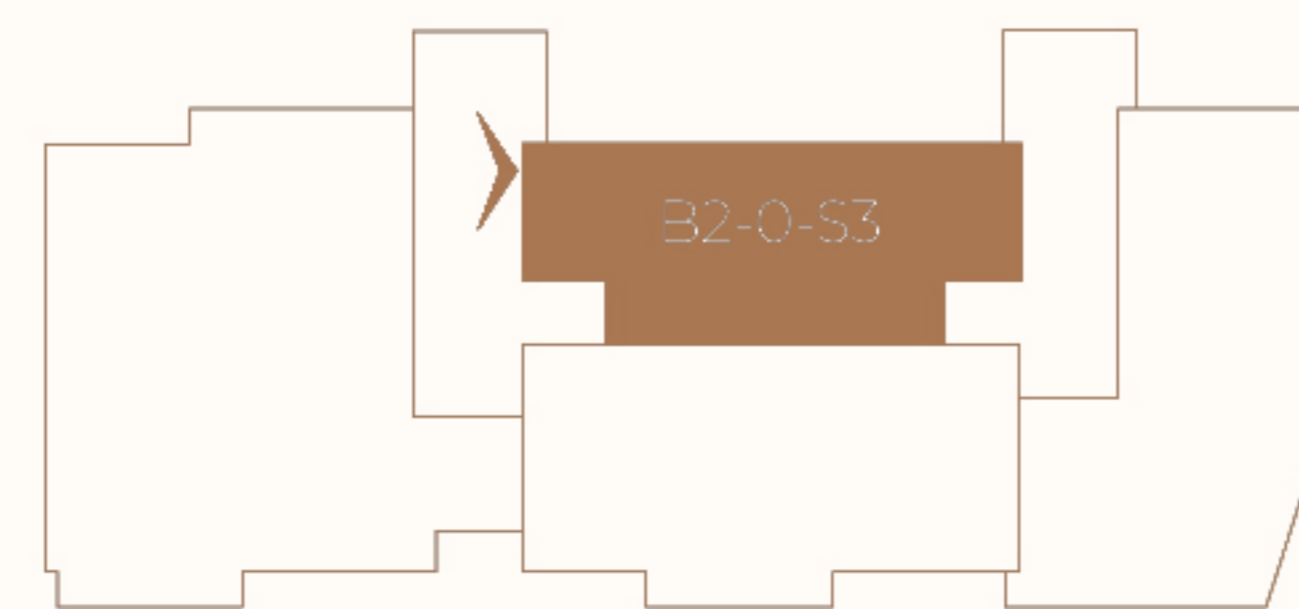
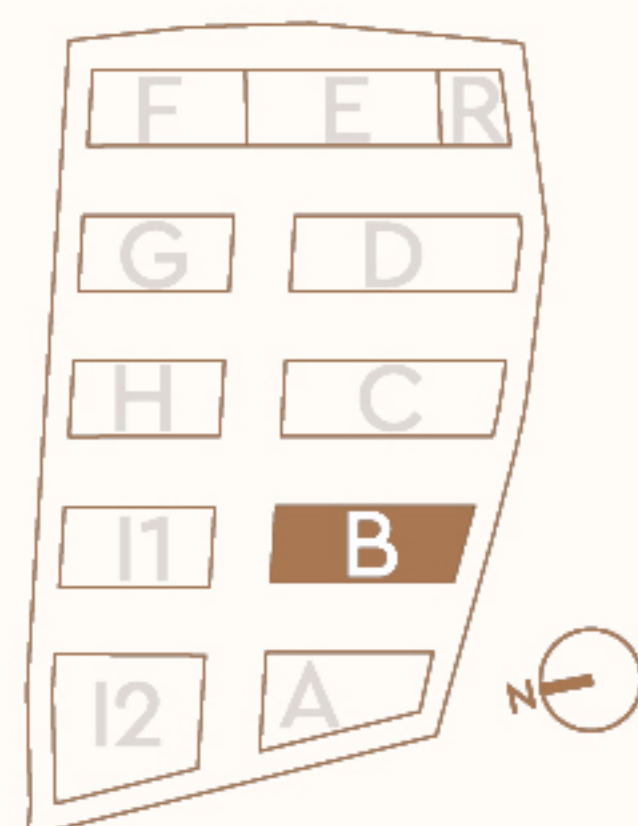

Ovaj plan je zamišljen kao orijentacioni prikaz organizacije i veličine stana. Konačne dimenzije i detalji biće potvrđeni direktno sa agentom prodaje.

This floor plan is intended as a conceptual guide to the apartment's layout and approximate size. Final dimensions and details will be confirmed directly with the sales agent.

