

KINGS FOUNTAIN DEDINJE

C2-0-S1

Stan / Apartment

Zgrada / Building: C
 Sprat / Floor: Prizemlje / Ground floor
 Broj soba / Rooms: 3

1	Ulaz / Entrance	7.48 m ²
2	Degažman / Antechamber	5.70 m ²
3	Kupatilo / Bathroom	4.07 m ²
4	Toalet / Toilet	1.96 m ²
5	Kuhinja / Kitchen	8.09 m ²
6	Vešernica i ostava / Laundry & Pantry	5.71 m ²
7	Trpezarija / Dining room	12.34 m ²
8	Dnevna soba / Living room	23.54 m ²
9	Spavaća soba / Bedroom	14.89 m ²
10	Kupatilo / Bathroom	5.97 m ²
11	Spavaća soba / Bedroom	9.90 m ²
12	Spavaća soba / Bedroom	11.41 m ²
Zatvoreni prostor / Indoor area		111.06 m ²
13	Terasa / Terrace	9.20 m ²
Otvoreni prostor / Outdoor area		9.20 m ²
Površina stana / Apartment area		120.26 m ²

Lokacija / Location

U KOMPLEKSU / IN COMPLEX

U ZGRADI / IN BUILDING

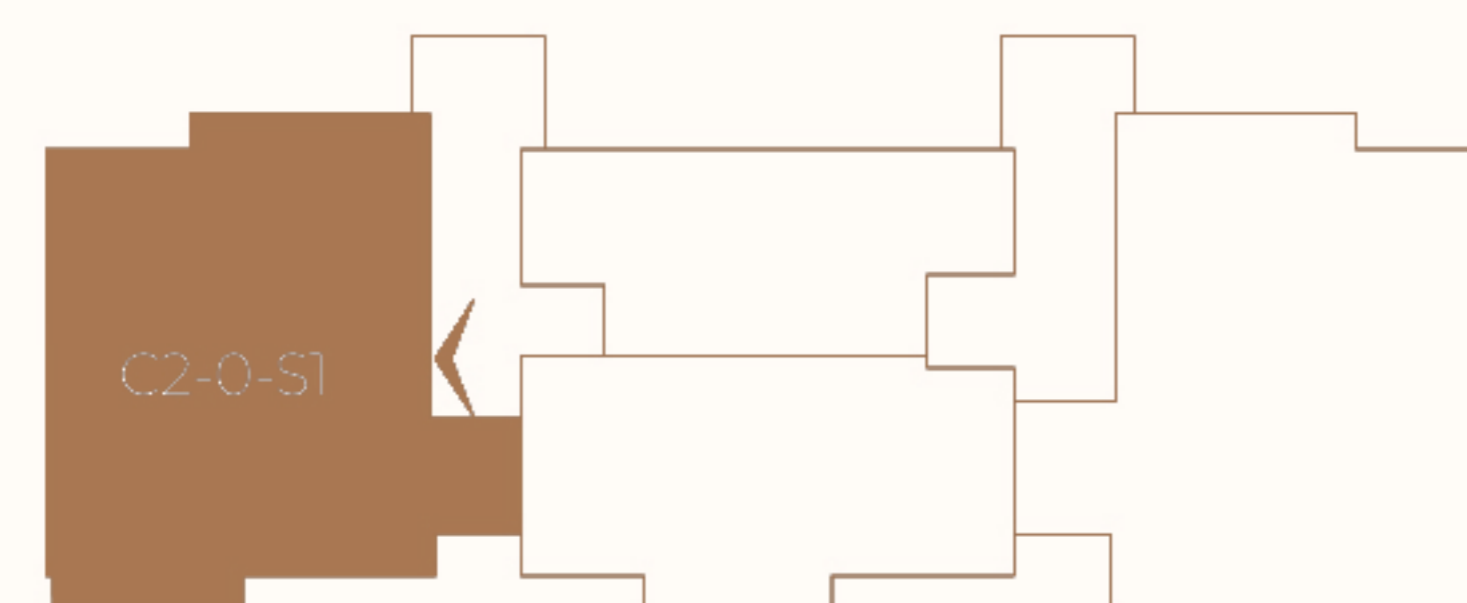
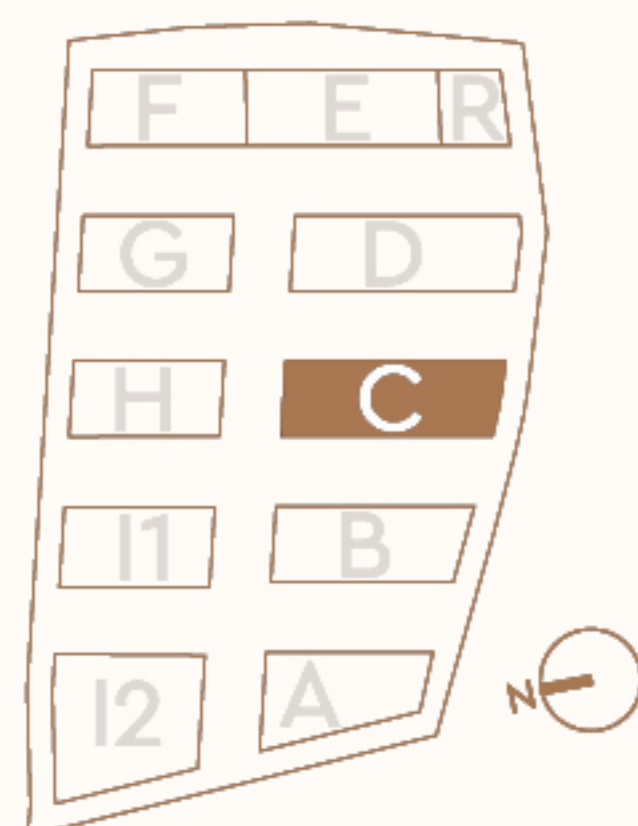

Ovaj plan je zamišljen kao orijentacioni prikaz organizacije i veličine stana. Konačne dimenzije i detalji biće potvrđeni direktno sa agentom prodaje.

This floor plan is intended as a conceptual guide to the apartment's layout and approximate size. Final dimensions and details will be confirmed directly with the sales agent.

