

KINGS FOUNTAIN DEDINJE

C2-0-S3

Stan / Apartment

Zgrada / Building: C
Sprat / Floor: Prizemlje / Ground floor
Broj soba / Rooms: 1

1	Ulaz / Entrance	4.90 m ²
2	Toalet / Toilet	2.70 m ²
3	Kuhinja / Kitchen	3.31 m ²
4	Dnevna soba i trpezarija / Living & Dining	26.03 m ²
5	Spavaća soba / Bedroom	13.87 m ²
6	Kupatilo / Bathroom	4.93 m ²

Površina stana / Apartment area 55.74 m²

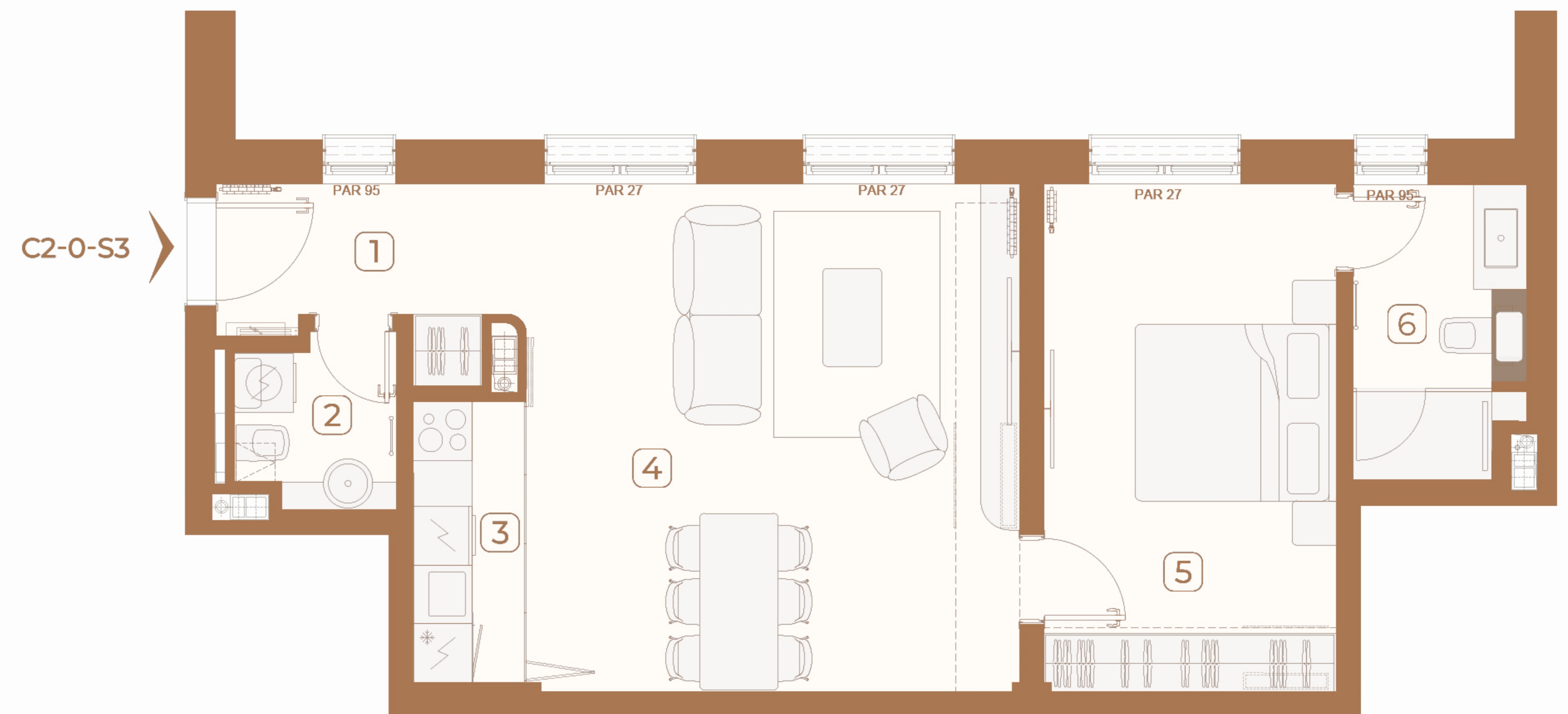

Lokacija / Location

U KOMPLEKSU / IN COMPLEX

U ZGRADI / IN BUILDING

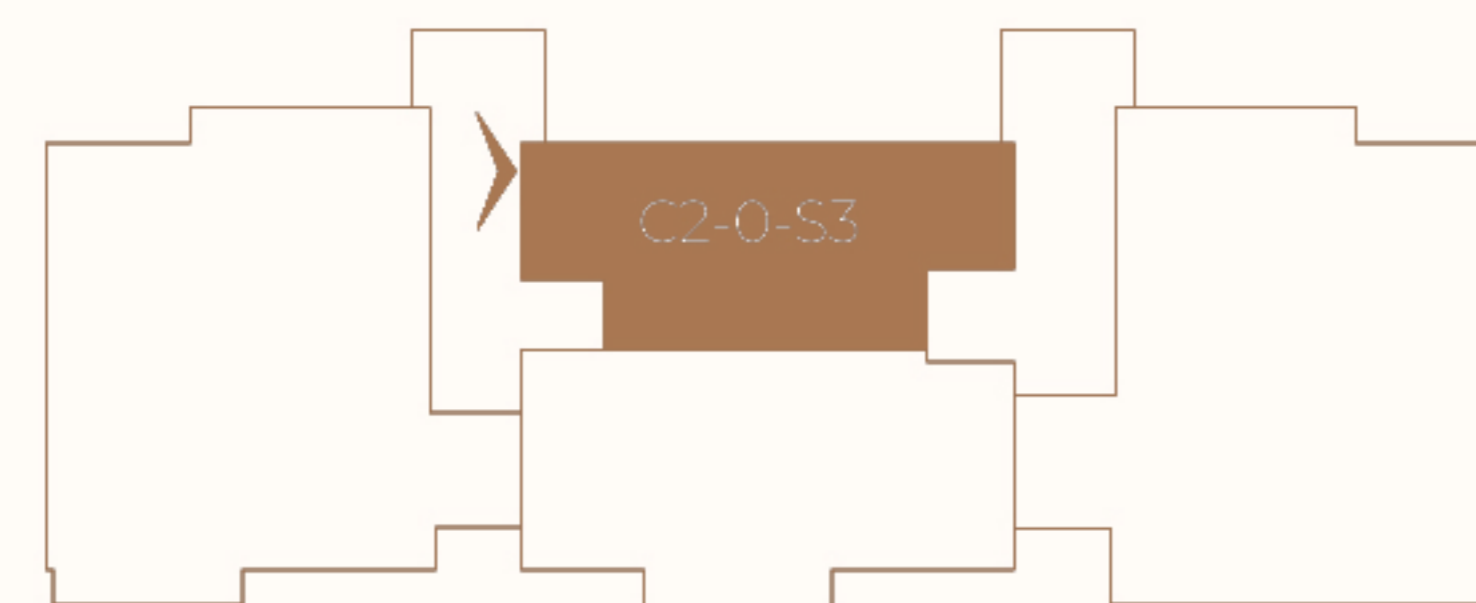
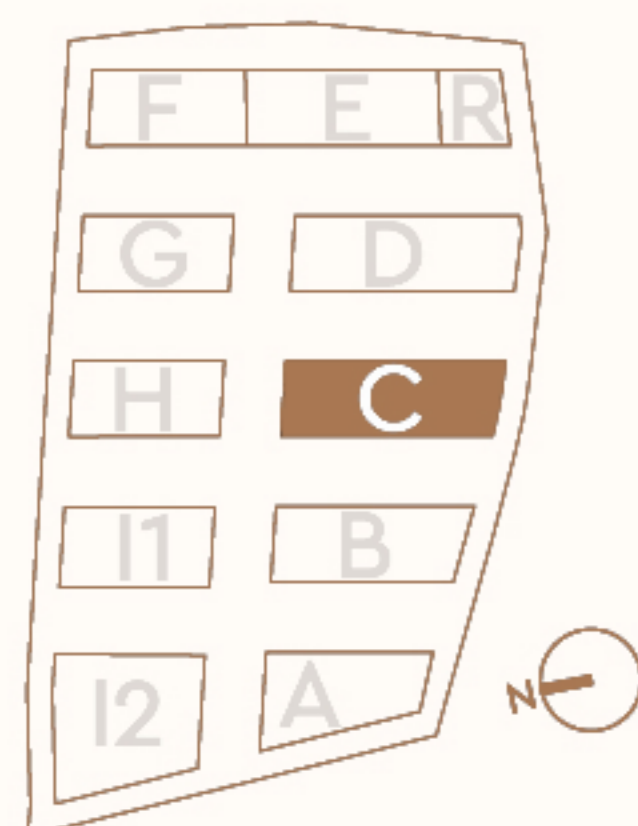

Ovaj plan je zamišljen kao orijentacioni prikaz organizacije i veličine stana. Konačne dimenzije i detalji biće potvrđeni direktno sa agentom prodaje.

This floor plan is intended as a conceptual guide to the apartment's layout and approximate size. Final dimensions and details will be confirmed directly with the sales agent.

