

# KINGS FOUNTAIN DEDINJE

## C2-1-S4

Stan / Apartment

Zgrada / Building: C  
 Sprat / Floor: 1  
 Broj soba / Rooms: 3

1	Ulaz / Entrance	7.48 m <sup>2</sup>
2	Degažman / Antechamber	5.70 m <sup>2</sup>
3	Kupatilo / Bathroom	4.07 m <sup>2</sup>
4	Toalet / Toilet	1.96 m <sup>2</sup>
5	Kuhinja / Kitchen	8.09 m <sup>2</sup>
6	Vešernica i ostava / Laundry & Storage	5.71 m <sup>2</sup>
7	Trpezarija / Dining room	12.34 m <sup>2</sup>
8	Dnevna soba / Living room	30.35 m <sup>2</sup>
9	Spavaća soba / Bedroom	14.89 m <sup>2</sup>
10	Kupatilo / Bathroom	5.97 m <sup>2</sup>
11	Spavaća soba / Bedroom	9.90 m <sup>2</sup>
12	Spavaća soba / Bedroom	11.41 m <sup>2</sup>
Zatvoreni prostor / Indoor area		117.87 m <sup>2</sup>
13	Terasa / Terrace	9.20 m <sup>2</sup>
Otvoreni prostor / Outdoor area		9.20 m <sup>2</sup>
Površina stana / Apartment area		127.07 m <sup>2</sup>

### Lokacija / Location

U KOMPLEKSU / IN COMPLEX

U ZGRADI / IN BUILDING

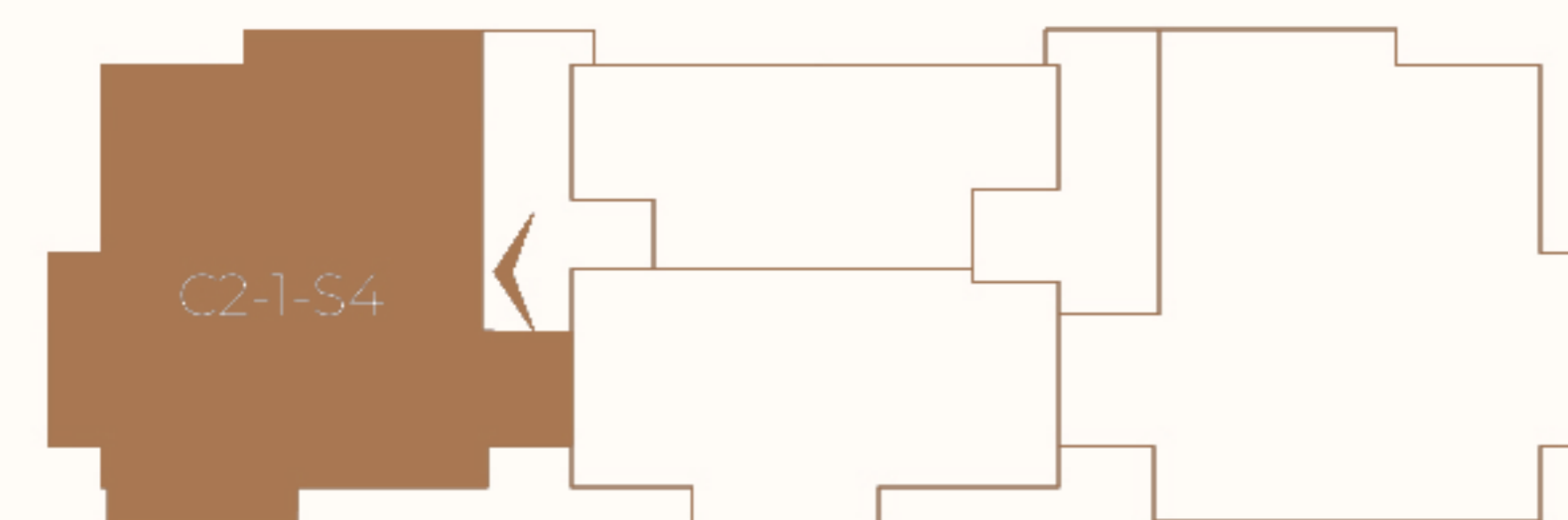
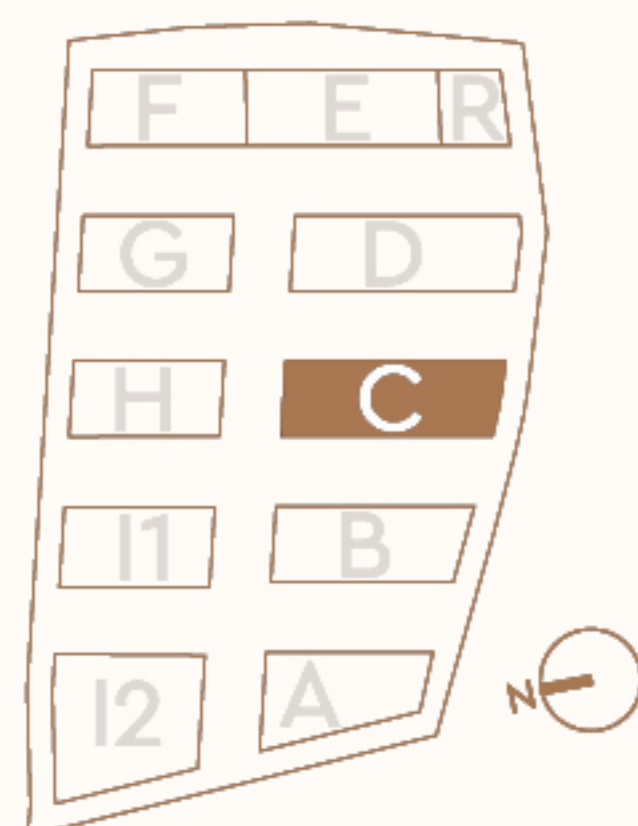

Ovaj plan je zamišljen kao orijentacioni prikaz organizacije i veličine stana. Konačne dimenzije i detalji biće potvrđeni direktno sa agentom prodaje.

This floor plan is intended as a conceptual guide to the apartment's layout and approximate size. Final dimensions and details will be confirmed directly with the sales agent.

