

# KINGS FOUNTAIN DEDINJE

## D1-0-S1

Stan / Apartment

Zgrada / Building: D  
Spat / Floor: Prizemlje / Ground floor  
Broj soba / Rooms: 3

1	Ulaz / Entrance	10.43 m <sup>2</sup>
2	Kuhinja / Kitchen	8.91 m <sup>2</sup>
3	Ostava / Pantry	1.22 m <sup>2</sup>
4	Vešernica / Laundry	2.28 m <sup>2</sup>
5	Trpezarija / Dining room	19.09 m <sup>2</sup>
6	Dnevna soba / Living room	21.90 m <sup>2</sup>
7	Degažman / Antechamber	4.65 m <sup>2</sup>
8	Kupatilo / Bathroom	4.03 m <sup>2</sup>
9	Spavaća soba / Bedroom	18.02 m <sup>2</sup>
10	Kupatilo / Bathroom	4.12 m <sup>2</sup>
11	Spavaća soba / Bedroom	10.62 m <sup>2</sup>
12	Spavaća soba / Bedroom	13.02 m <sup>2</sup>

Zatvoreni prostor / Indoor area 118.29 m<sup>2</sup>

13 Terasa / Terrace 9.37 m<sup>2</sup>

Otvoreni prostor / Outdoor area 9.37 m<sup>2</sup>

Površina stana / Apartment area 127.66 m<sup>2</sup>

### Lokacija / Location

U KOMPLEKSU / IN COMPLEX

U ZGRADI / IN BUILDING

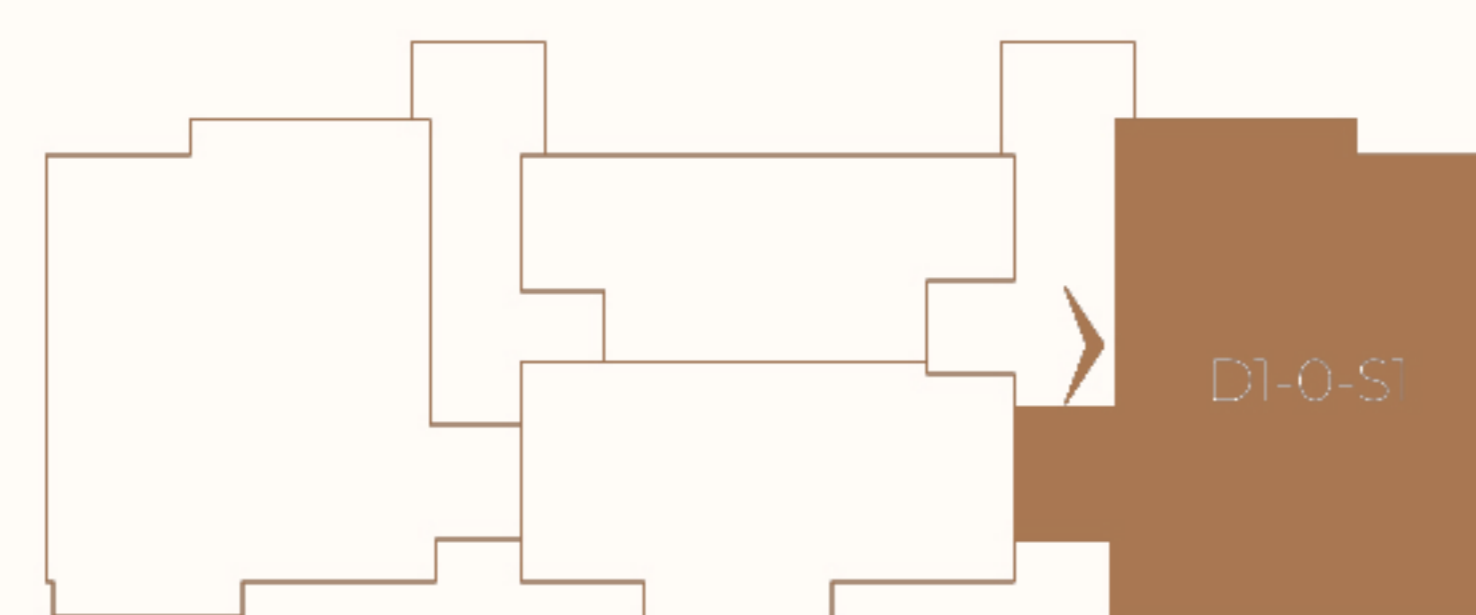
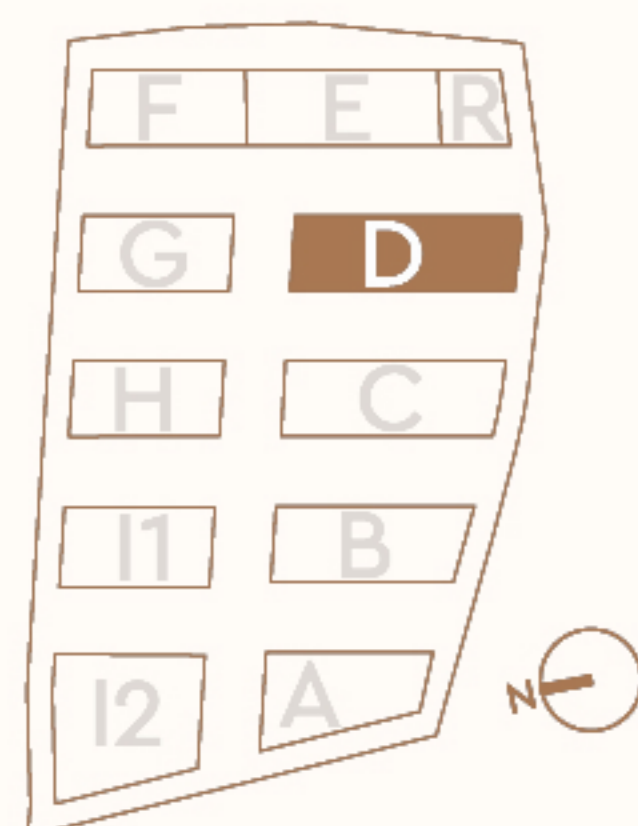

Ovaj plan je zamišljen kao orijentacioni prikaz organizacije i veličine stana. Konačne dimenzije i detalji biće potvrđeni direktno sa agentom prodaje.

This floor plan is intended as a conceptual guide to the apartment's layout and approximate size. Final dimensions and details will be confirmed directly with the sales agent.

