

# KINGS FOUNTAIN DEDINJE

## C2-3-S10

Stan / Apartment

Zgrada / Building: C  
Sprat / Floor: III  
Broj soba / Rooms: 1

1	Ulaz / Entrance	10.78 m <sup>2</sup>
2	Degažman / Antechamber	3.42 m <sup>2</sup>
3	Kupatilo / Bathroom	3.48 m <sup>2</sup>
4	Kuhinja / Kitchen	10.53 m <sup>2</sup>
5	Dnevna soba i trpezarija / Living & Dining	27.08 m <sup>2</sup>
6	Spavaća soba / Bedroom	9.54 m <sup>2</sup>
Zatvoreni prostor / Indoor area		64.83 m <sup>2</sup>
7	Terasa / Terrace	45.89 m <sup>2</sup>
8	Lođa / Loggia	3.74 m <sup>2</sup>
9	Lođa / Loggia	3.04 m <sup>2</sup>
Otvoreni prostor / Outdoor area		52.67 m <sup>2</sup>
Površina stana / Apartment area		117.50 m <sup>2</sup>

## Lokacija / Location

U KOMPLEKSU / IN COMPLEX

U ZGRADI / IN BUILDING

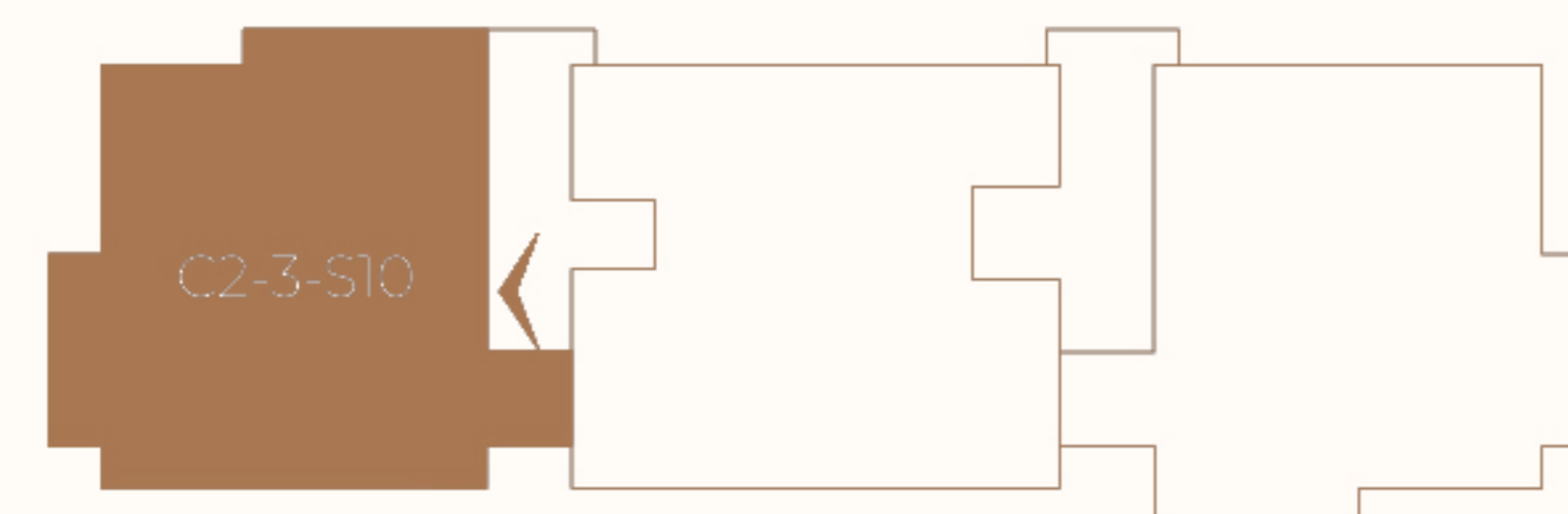
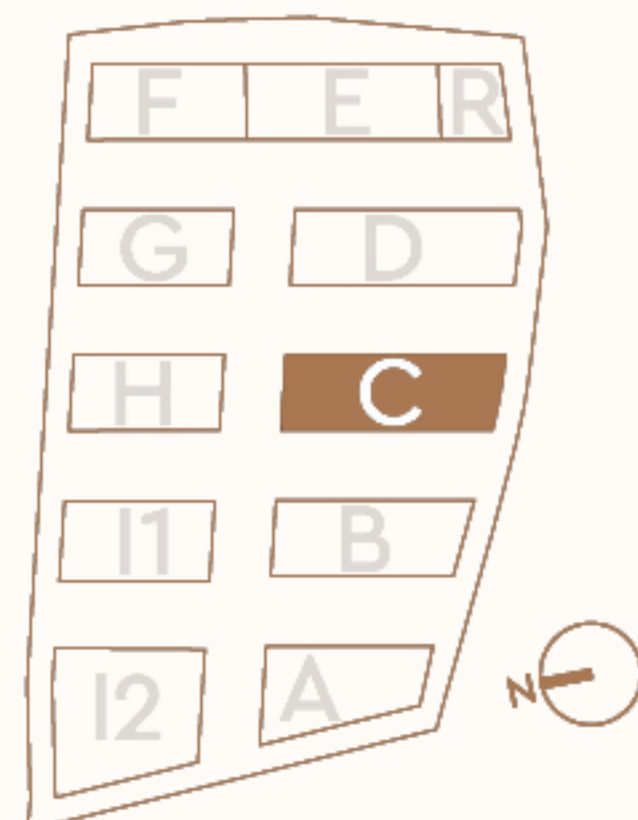

Ovaj plan je zamišljen kao orijentacioni prikaz organizacije i veličine stana. Konačne dimenzije i detalji biće potvrđeni direktno sa agentom prodaje.

This floor plan is intended as a conceptual guide to the apartment's layout and approximate size. Final dimensions and details will be confirmed directly with the sales agent.

