

KINGS FOUNTAIN DEDINJE

D1-3-S4

Stan / Apartment

Zgrada / Building: D
 Sprat / Floor: III
 Broj soba / Rooms: 2

1	Ulaz / Entrance	6.23 m ²
2	Kuhinja / Kitchen	4.62 m ²
3	Toalet / Toilet	3.06 m ²
4	Dnevna soba i trpezarija / Living & Dining	20.46 m ²
5	Degažman / Antechamber	7.61 m ²
6	Kupatilo / Bathroom	3.91 m ²
7	Spavaća soba / Bedroom	15.19 m ²
8	Spavaća soba / Bedroom	12.18 m ²

Zatvoreni prostor / Indoor area 73.26 m²

9 Lođa / Loggia 3.15 m²

10 Lođa / Loggia 3.91 m²

11 Terasa / Terrace 39.89 m²

Otvoreni prostor / Outdoor area 46.95 m²

Površina stana / Apartment area 120.21 m²

Lokacija / Location

U KOMPLEKSU / IN COMPLEX

U ZGRADI / IN BUILDING

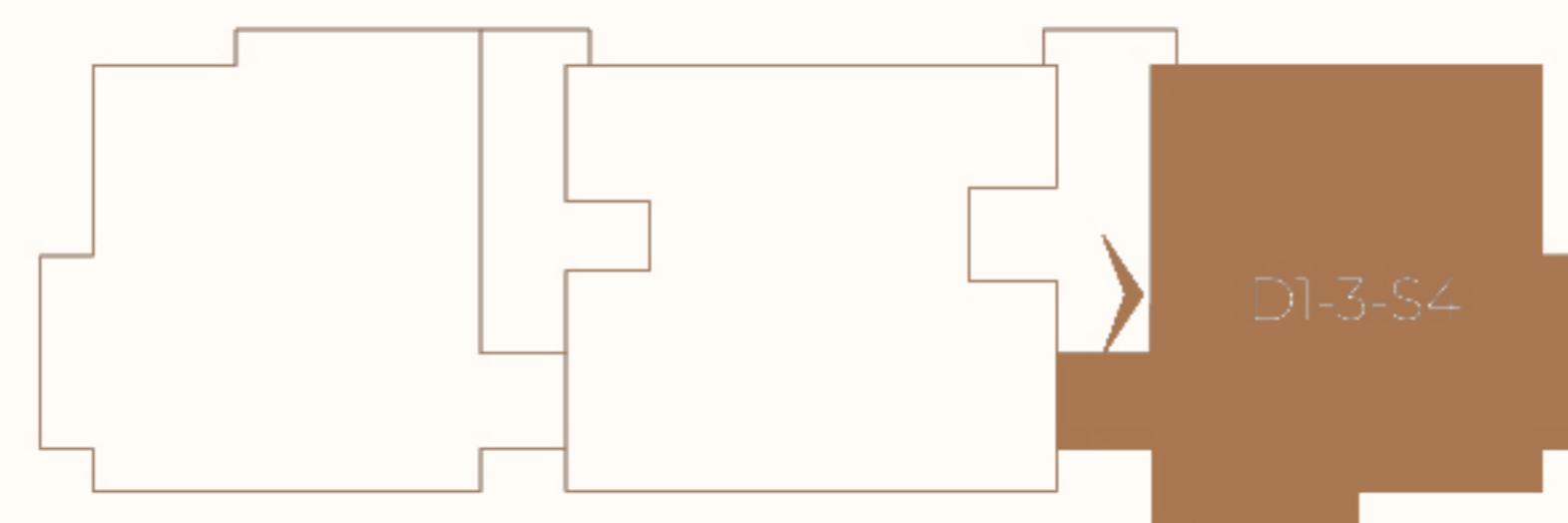
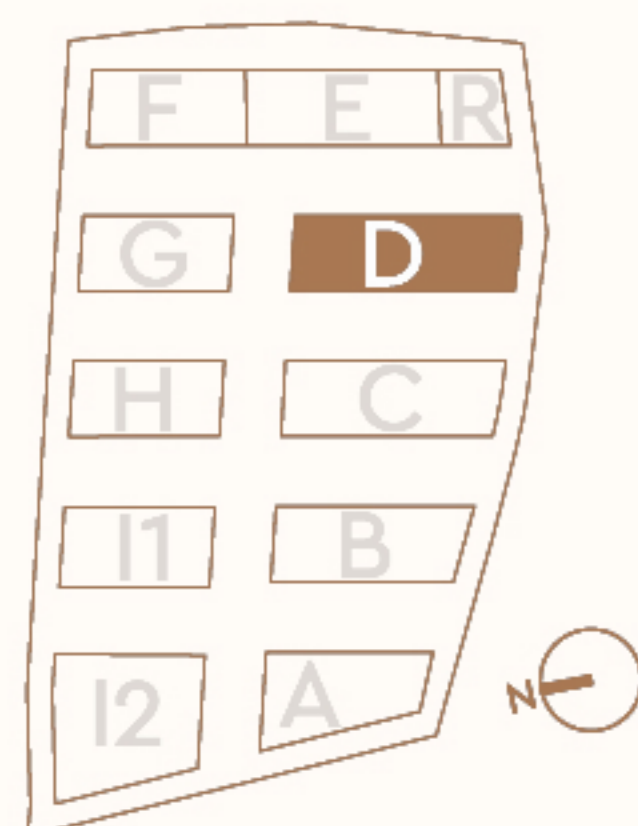

Ovaj plan je zamišljen kao orijentacioni prikaz organizacije i veličine stana. Konačne dimenzije i detalji biće potvrđeni direktno sa agentom prodaje.

This floor plan is intended as a conceptual guide to the apartment's layout and approximate size. Final dimensions and details will be confirmed directly with the sales agent.

