

# KINGS FOUNTAIN DEDINJE

## D2-1-S6

Stan / Apartment

Zgrada / Building: D  
Sprat / Floor: I  
Broj soba / Rooms: 1

1	Ulaz / Entrance	4.90 m <sup>2</sup>
2	Toalet / Toilet	2.70 m <sup>2</sup>
3	Kuhinja / Kitchen	3.31 m <sup>2</sup>
4	Dnevna soba i trpezarija / Living & Dining	26.03 m <sup>2</sup>
5	Spavaća soba / Bedroom	13.87 m <sup>2</sup>
6	Kupatilo / Bathroom	4.93 m <sup>2</sup>

Površina stana / Apartment area 55.74 m<sup>2</sup>

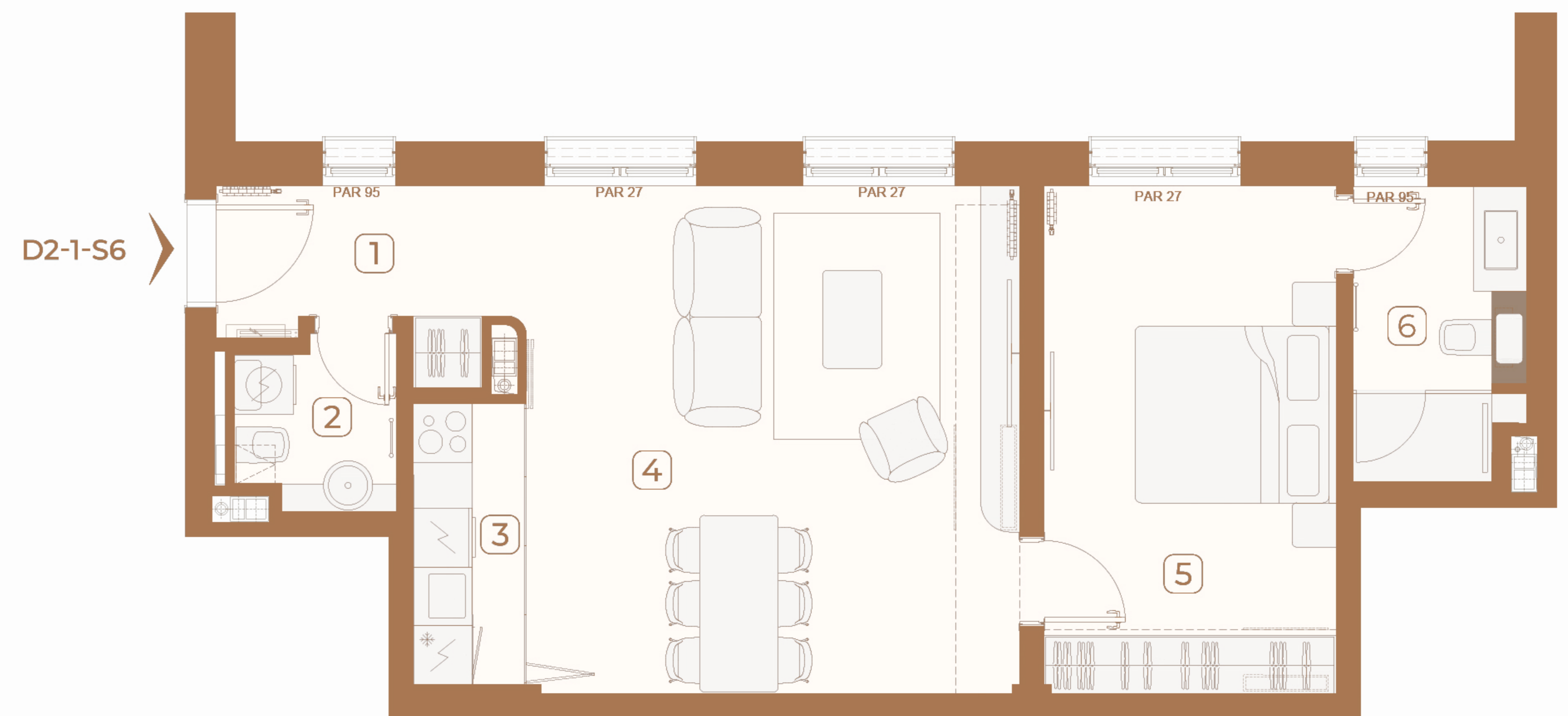

## Lokacija / Location

U KOMPLEKSU / IN COMPLEX

U ZGRADI / IN BUILDING

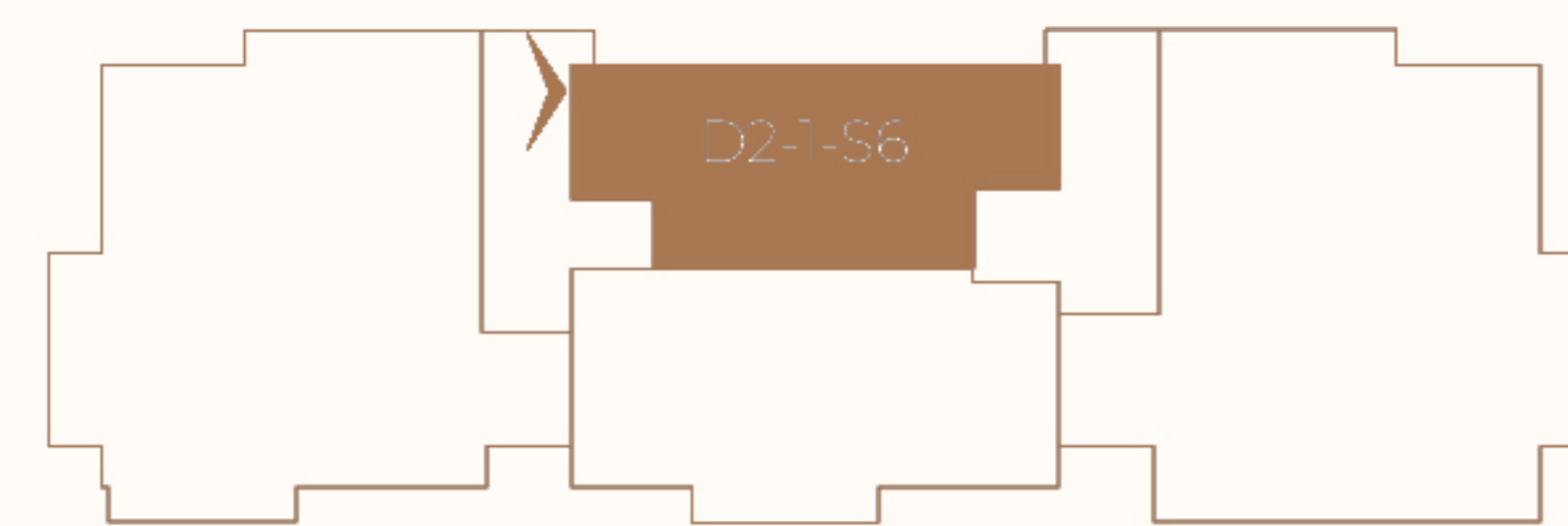
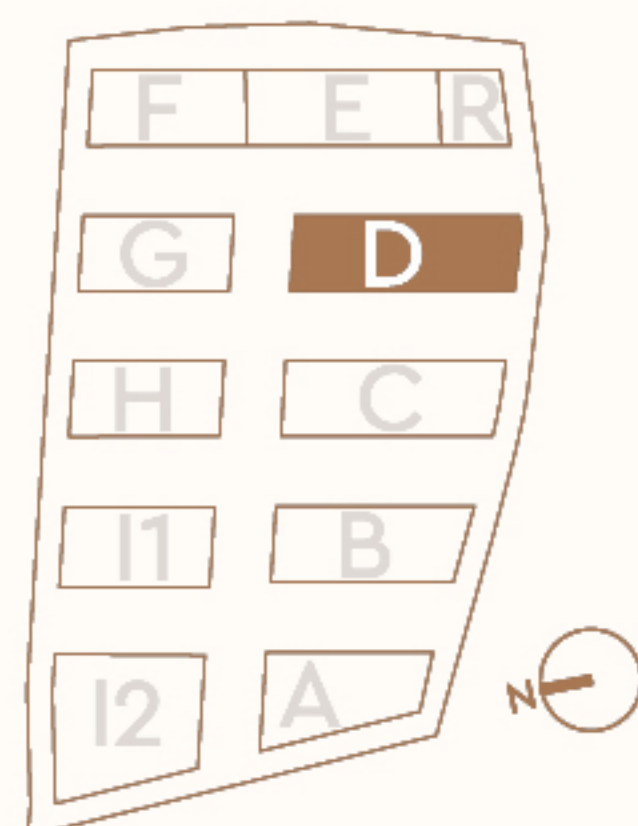

Ovaj plan je zamišljen kao orijentacioni prikaz organizacije i veličine stana. Konačne dimenzije i detalji biće potvrđeni direktno sa agentom prodaje.

This floor plan is intended as a conceptual guide to the apartment's layout and approximate size. Final dimensions and details will be confirmed directly with the sales agent.

