



[DBPR HOME](#) | [ABOUT DBPR](#) | [DBPR DIVISIONS](#) | [CONTACT DBPR](#)

[BCIS Home](#) | [Log In](#) | [User Registration](#) | [Hot Topics](#) | [Submit Surcharge](#) | [Stats & Facts](#) | [Publications](#) | [Contact Us](#) | [BCIS Site Map](#) | [Links](#) | [Search](#)



Product Approval
USER: Public User

[Product Approval Menu](#) > [Product or Application Search](#) > [Application List](#) > **Application Detail**

OFFICE OF THE SECRETARY

FL #	FL26360-R2												
Application Type	Revision												
Code Version	2023												
Application Status	Approved												
Comments													
Archived	<input type="checkbox"/>												
Product Manufacturer	Sol-A-Trol Aluminum Products												
Address/Phone/Email	4101 NW 132 St Miami, FL 33054 (350) 681-2020 Ext 209 Edith@SOLATROL.COM												
Authorized Signature	Yiping Wang mcy@mcyengineering.com												
Technical Representative	Edith Todzey												
Address/Phone/Email	4101 NW 132nd St. Miami, FL 33054 (305) 681-2020 edith@solatrol.com												
Quality Assurance Representative													
Address/Phone/Email													
Category	Windows												
Subcategory	Single Hung												
Compliance Method	Evaluation Report from a Florida Registered Architect or a Licensed Florida Professional Engineer <input type="checkbox"/> Evaluation Report - Hardcopy Received												
Florida Engineer or Architect Name who developed the Evaluation Report	Yiping Wang												
Florida License	PE-55983												
Quality Assurance Entity	National Accreditation and Management Institute												
Quality Assurance Contract Expiration Date	12/31/2024												
Validated By	Xiaojun Gu <input checked="" type="checkbox"/> Validation Checklist - Hardcopy Received												
Certificate of Independence	FL26360_R2_COI_Certificate of Independence FBC 2023.pdf												
Referenced Standard and Year (of Standard)	<table border="0"> <thead> <tr> <th>Standard</th> <th>Year</th> </tr> </thead> <tbody> <tr> <td>ASTM E330</td> <td>2014</td> </tr> <tr> <td>ASTM E331</td> <td>2016</td> </tr> <tr> <td>TAS 201</td> <td>1994</td> </tr> <tr> <td>TAS 202</td> <td>1994</td> </tr> <tr> <td>TAS 203</td> <td>1994</td> </tr> </tbody> </table>	Standard	Year	ASTM E330	2014	ASTM E331	2016	TAS 201	1994	TAS 202	1994	TAS 203	1994
Standard	Year												
ASTM E330	2014												
ASTM E331	2016												
TAS 201	1994												
TAS 202	1994												
TAS 203	1994												
Equivalence of Product Standards Certified By													

Sections from the Code

Product Approval Method Method 1 Option D

Date Submitted 11/23/2023

Date Validated 12/28/2023

Date Pending FBC Approval 01/03/2024

Date Approved 02/13/2024

Summary of Products

FL #	Model, Number or Name	Description
26360.1	SERIES 540 SINGLE/DOUBLE HUNG WINDOW WITH IMPACT LOUVER BLADES- LMI	SERIES 540 SINGLE/DOUBLE HUNG WINDOW WITH IMPACT LOUVER BLADES- LMI
Limits of Use Approved for use in HVHZ: Yes Approved for use outside HVHZ: Yes Impact Resistant: Yes Design Pressure: +75/-75 Other: For Design Pressure Vs. Window Size refer to Installation Instructions.		Installation Instructions FL26360_R2_II_540 SHW-DHW IMP. LOUVER- LMI FL26360 AD18-06 REV 11.23.2023 ss.pdf Verified By: Yiping Wang FL#55983 Created by Independent Third Party: Yes Evaluation Reports FL26360_R2_AE Evaluation Report FBC 2023.pdf Created by Independent Third Party: Yes

[Back](#) [Next](#)

[Contact Us :: 2601 Blair Stone Road, Tallahassee FL 32399 Phone: 850-487-1824](#)

The State of Florida is an AA/EEO employer. [Copyright 2007-2013 State of Florida.](#) :: [Privacy Statement](#) :: [Accessibility Statement](#) :: [Refund Statement](#)

Under Florida law, email addresses are public records. If you do not want your e-mail address released in response to a public-records request, do not send electronic mail to this entity. Instead, contact the office by phone or by traditional mail. If you have any questions, please contact 850.487.1395. *Pursuant to Section 455.275(1), Florida Statutes, effective October 1, 2012, licensees licensed under Chapter 455, F.S. must provide the Department with an email address if they have one. The emails provided may be used for official communication with the licensee. However email addresses are public record. If you do not wish to supply a personal address, please provide the Department with an email address which can be made available to the public. To determine if you are a licensee under Chapter 455, F.S., please click [here](#).



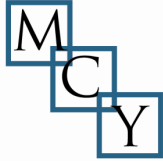

PRODUCT APPROVAL EVALUATION REPORT

<p><u>Product Manufacturer:</u> Sol-A-Trol Aluminum Products, INC. 4101 NW 132nd Street Miami FL, 33054</p>	<p><u>Product Name/Model & Description:</u> Series 540 Single/Double Hung Window with Impact Louver Blades - LMI Single Hung - Large Missile Impact System</p>
---	---

Scope: This product has been evaluated by the below-signed Florida Professional Engineer for compliance with the Code noted herein and is, for the purpose intended, at least equivalent to that required by the Code, in accordance with section 553.842 F.S. & chapter 61G20-3.005 F.A.C. Re-evaluation of this product shall be required following applicable Code modifications or revisions.

Code: 8th Edition Florida Building Code (2023), inclusive of all Supplements effective as of this report date.

Compliance Method: 61G20-3.005 (1)(d) – Evaluation Report from a licensed Professional Engineer

Product Description: Product Approval Drawing #AD18-06, prepared by MCY Engineering, signed and sealed by Yiping Wang, P.E., is an integral part of this Evaluation Report.

Limitations & Conditions of Use:

- This product has been evaluated for use **inside and outside of the HVHZ** (High-Velocity Hurricane Zone)
- Impact Resistance: **Large Missile Impact**
- Refer to Product Approval Drawing noted above for:
 - Maximum allowable wind loads at the related maximum allowable size(s).
 - Other load limitations applicable to the product, if any.
 - Overall dimensions and material/grade of main product components, accessories, etc.
 - Illustrated diagrams of the attachment of the product to the structure.
 - Anchor type(s), size(s), substrate(s), embedment, edge distance and spacing/locations.

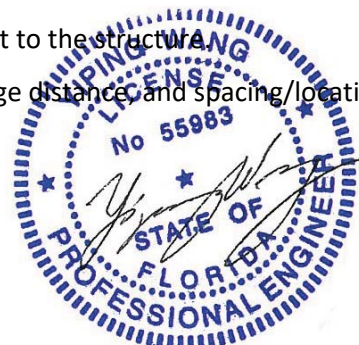

November 23rd, 2023

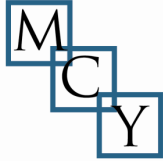

Test Reports:

Mandatory Tests (Tested in accordance with Florida Building Code Tests Protocols)

Test Lab	Report Number	Test Report Date	Test Standard & Description
Hurricane Engineering & Testing INC. 6120 NW 97 Ave. Miami, FL 33178	<i>HETI-04-1386A</i> <i>HETI-04-1386B</i> <i>HETI-04-1386C</i> <i>signed and sealed</i> <i>by Hurricane, PE, FL</i>	06/01/2004	TAS 201 (large missile impact) TAS 202 (uniform static test) TAS 203 (cyclic wind pressure loading) ASTM E547/E331 (water infiltration test) ASTM E330 (static load test)
Fenestration Testing laboratory, INC. 1677 W 31 st Place Hialeah FL, 33012	<i>01-164, signed and sealed by Fenestration, PE, FL #3059</i>	09/07/2001	TAS 201 (large missile impact) TAS 202 (uniform static test) TAS 203 (cyclic wind pressure loading) ASTM E547/E331 (water infiltration test) ASTM E330 (static load test)

Engineering Analysis: The following engineering analyses and/or calculations have been performed:

- No comparative analysis has been performed for conditions other than those tested.
- No rational analysis has been performed.
- Anchor calculations are based on manufacturer’s published anchor capacity, anchor Notice of Acceptance by Miami Dade County.



November 23rd, 2023

SOL-A-TROL ALUMINUM PRODUCTS

SERIES '540' SINGLE/DOUBLE HUNG WINDOW WITH IMPACT LOUVER BLADES

LARGE MISSILE IMPACT - IMPACT LEVEL 'D'

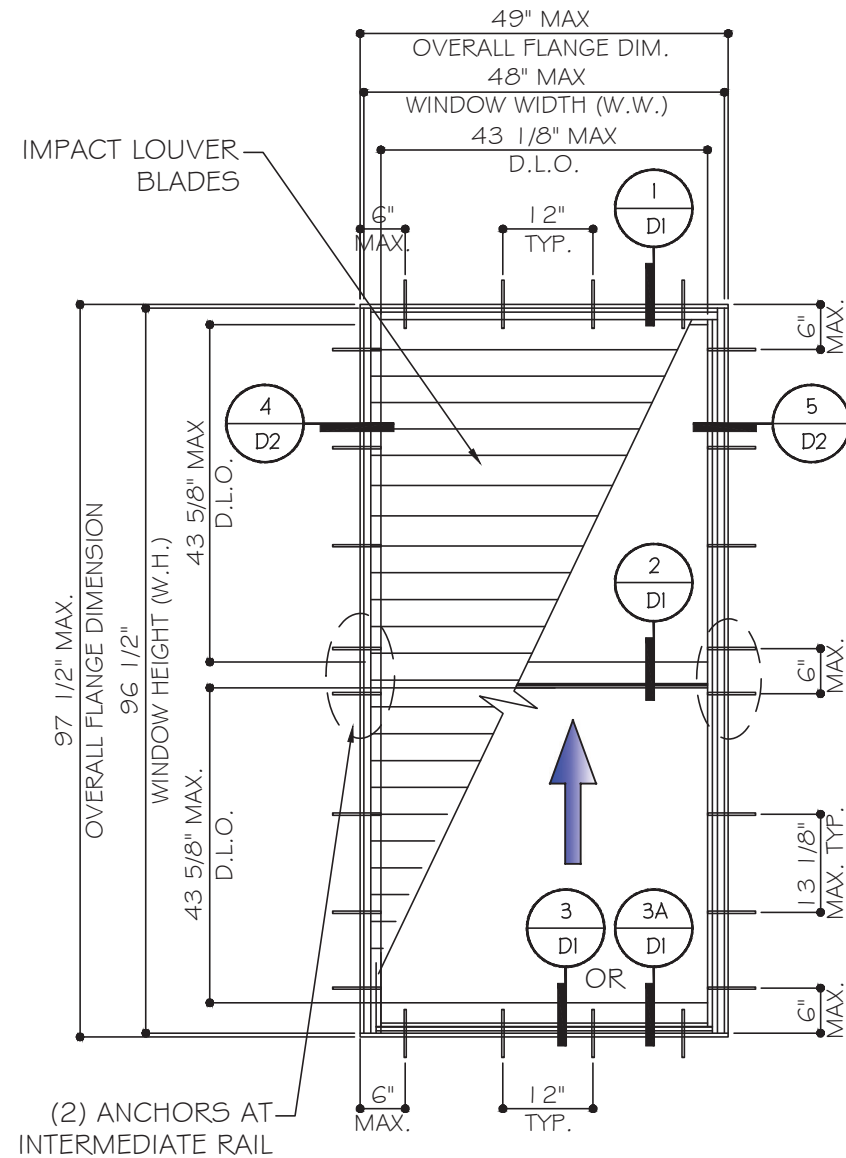

TYPICAL EXTERIOR ELEVATION

DESIGN LOADS (FOR SIZE SHOWN ABOVE OR SMALLER AS PERMITTED BY FBC)
+75 PSF -75 PSF

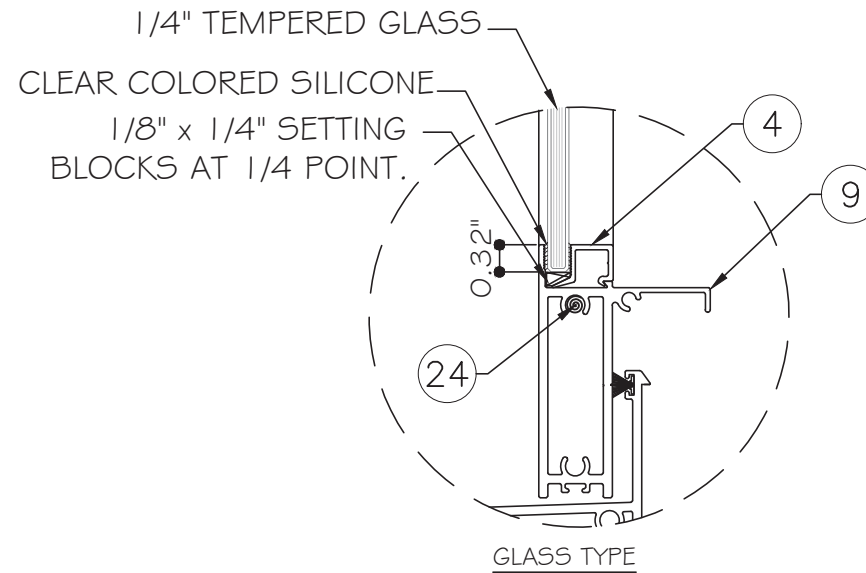

NOTE:
GLASS COMPLIES WITH ASTM E1300-16 (3 SEC. GUSTS).

GENERAL NOTES:

- THIS PRODUCT HAS BEEN DESIGNED AND TESTED TO COMPLY WITH THE REQUIREMENTS OF THE 8TH EDITION FLORIDA BUILDING CODE (2023) INCLUDING HIGH VELOCITY HURRICANE ZONE (HVHZ).
- WINDOWS RATED FOR LARGE MISSILE IMPACT. IMPACT SHUTTERS ARE NOT REQUIRED.
- THESE WINDOWS ARE APPROVED FOR AIR AND WATER INFILTRATION.
- ANCHORS SHALL BE AS LISTED, SPACED AS SHOWN ON DETAILS. ANCHORS EMBEDMENT TO BASE MATERIAL SHALL BE BEYOND WALL DRESSING OR STUCCO.
- ANCHORING OR LOADING CONDITIONS NOT SHOWN IN THESE DETAILS ARE NOT PART OF THIS APPROVAL.
- MATERIALS INCLUDING BUT NOT LIMITED TO STEEL/METAL SCREWS THAT COME INTO CONTACT WITH OTHER DISSIMILAR MATERIALS SHALL MEET THE REQUIREMENTS OF THE 8TH EDITION FLORIDA BUILDING CODE (2023) SECTION AS APPLICABLE.
- METAL STRUCTURES NOT BY SOL-A-TROL ALUMINUM PRODUCTS, INC. TO BE DESIGNED TO SUPPORT THE LOADS IMPOSED BY THIS GLAZING SYSTEM AND TO TRANSFER SUCH LOADS TO THE BUILDING MAIN STRUCTURE.
- ULTIMATE LOAD OBTAINED FROM ASCE 7-22, MULTIPLY BY 0.6 SHALL BE LESS THAN OR EQUAL TO MAX. DESIGN LOAD IN THIS DOCUMENT. THE DESIGN LOADS SHOWN IN THIS DOCUMENT ARE ALLOWABLE DESIGN LOADS.
- MANUFACTURER'S LABEL SHALL BE LOCATED ON A READILY VISIBLE LOCATION IN ACCORDANCE WITH SECTION 1709.9.3 OF FLORIDA BUILDING CODE LABELING TO COMPLY WITH SECTION 1709.9.2.

ABBREVIATIONS AND SYMBOLS

- D.L.O. - DAYLITE OPENING
- W.H.- WINDOW HEIGHT
- W.W.- WINDOW WIDTH
- W/ - WITH
- W/O - WITHOUT
- O.C. - ON CENTER

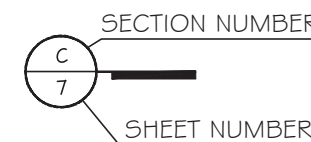

LIMITATIONS OF USE

A- THIS PRODUCT EVALUATION DOCUMENT (P.E.D.) PREPARED BY THIS ENGINEER IS GENERIC AND DOES NOT PROVIDE INFORMATION FOR A SITE SPECIFIC PROJECT. I.e. WHERE THE SITE CONDITIONS DEVIATE FROM THE P.E.D.

B- CONTRACTOR TO BE RESPONSIBLE FOR THE SELECTION, PURCHASE AND INSTALLATION OF THIS PRODUCT BASED ON THIS PRODUCT EVALUATION PROVIDED HE/SHE DOES NOT DEVIATE FROM THE CONDITIONS DETAILED ON THIS DOCUMENT.

C- THIS PRODUCT EVALUATION DOCUMENT WILL BE CONSIDERED INVALID IF ALTERED BY ANY MEANS.

D- SITE SPECIFIC PROJECTS SHALL BE PREPARED BY A FLORIDA REGISTERED ENGINEER OR ARCHITECT WHICH WILL BECOME THE ENGINEER OF RECORD (E.O.R.) FOR THE PROJECT AND WHO WILL BE RESPONSIBLE FOR THE PROPER USE OF THE P.E.D. ENGINEER OF RECORD, ACTING AS A DELEGATED ENGINEER TO THE P.E.D. ENGINEER SHALL SUBMIT TO THIS LATTER THE SITE SPECIFIC DRAWINGS FOR REVIEW.

E- THIS P.E.D. SHALL BEAR THE DATE AND ORIGINAL SEAL AND SIGNATURE OF THE PROFESSIONAL ENGINEER OF RECORD THAT PREPARED IT.

FLORIDA APPROVAL:
FL #26360

YIPING WANG, P.E.
FLORIDA REGISTERED PROFESSIONAL ENGINEER
No 55983
L.C.N. 28677

November 23rd, 2023

MCY ENGINEERING, INC.
GLAZING CONSULTANTS

12781 MIRAMAR PKWY. STE. 301
MIRAMAR, FL 33027 P. 305.271.0117

www.MCYEngineering.com mcy@mcyengineering.com

SOL-A-TROL

ALUMINUM PRODUCTS, INC.

4101 N.W. 132ND STREET MIAMI, FL 33054

TEL. (305)-681-2020

540 SINGLE/DOUBLE HUNG WINDOW IMP. LOUVER BLADES

DATE: 11.23.2023
DRAWN BY: James
DATE: 11.23.2023
REV. NO.: 2

SCALE: as shown

DRAWING NO. AD18-06

SHEET NO. 1 OF 7

97 1/2" MAX. OVER ALL FLANGE DIMENSION
96 1/2" MAX. WINDOW HEIGHT (W.H.)

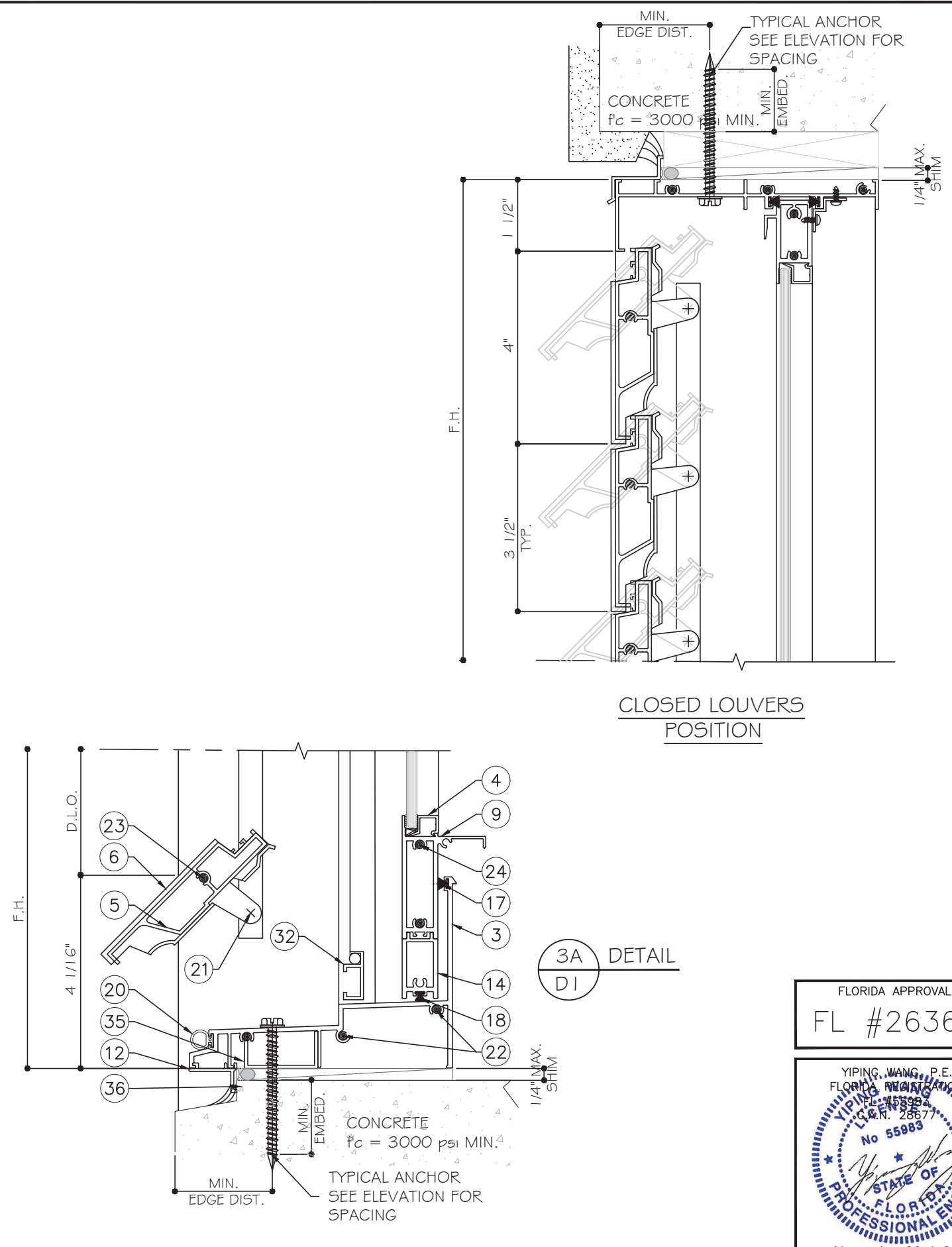
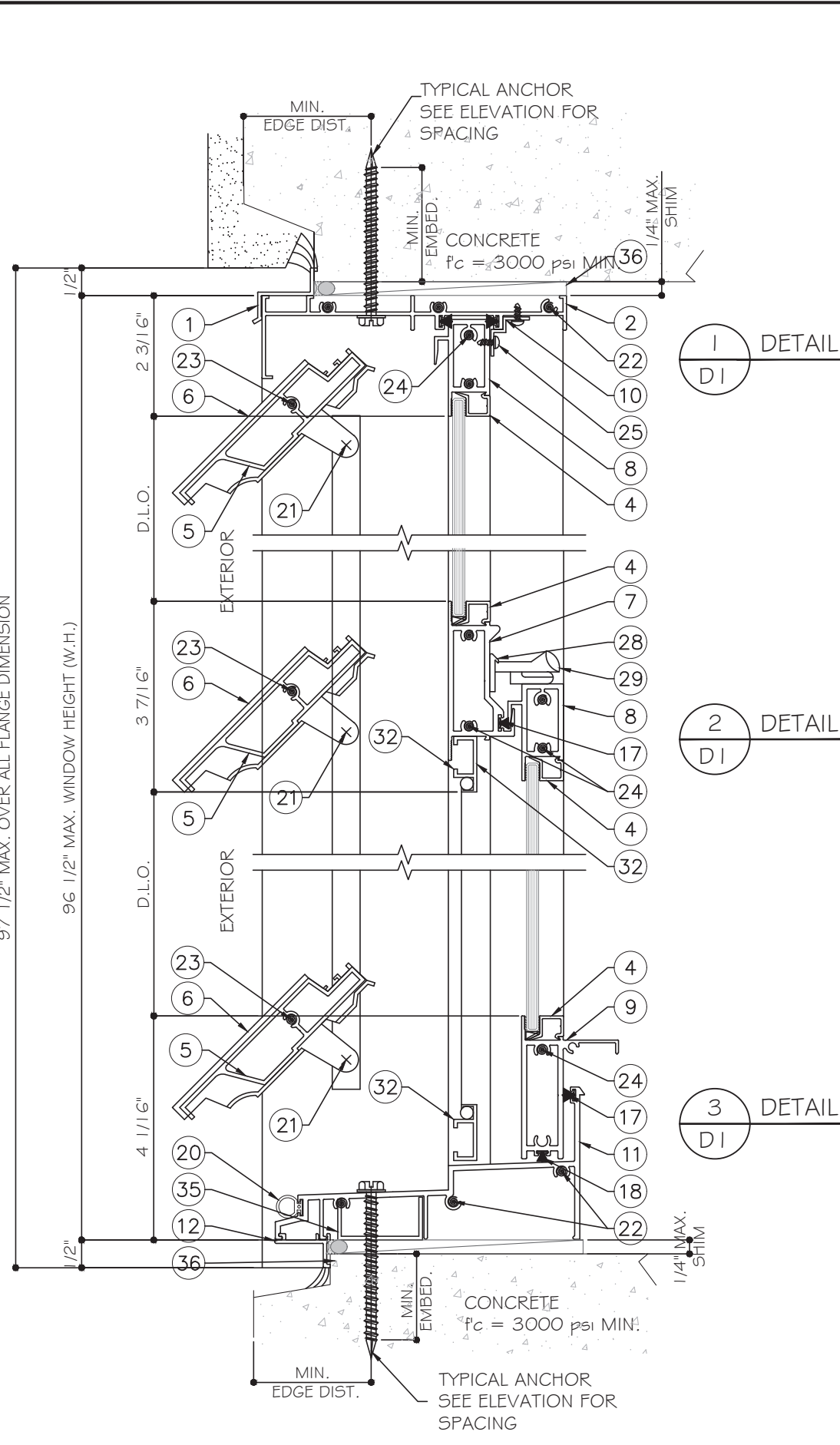

FLORIDA APPROVAL:
FL #26360

YIPING WANG, P.E.
FLORIDA REGISTRATION
No 55983
November 23rd, 2023

MCY ENGINEERING, INC.
GLAZING CONSULTANTS
12781 MIRAMAR PKWY. STE. 301
MIRAMAR, FL 33027
P: 305.271.0117
www.MCYEngineering.com mcy@mcyengineering.com

SOL-A-TROL
ALUMINUM PRODUCTS, INC.
4101 N.W. 132ND STREET MIAMI, FL 33054
TEL. (303)-681-2020

Rev. No.	Date	Drawn By	Description
Rev.2	11.23.2023	James	UPDATE TO FBC 2023

Drawn Date: 11.23.2023
Scale: as shown

DRAWING NO.
AD18-06

Sheet No.
2 OF 7

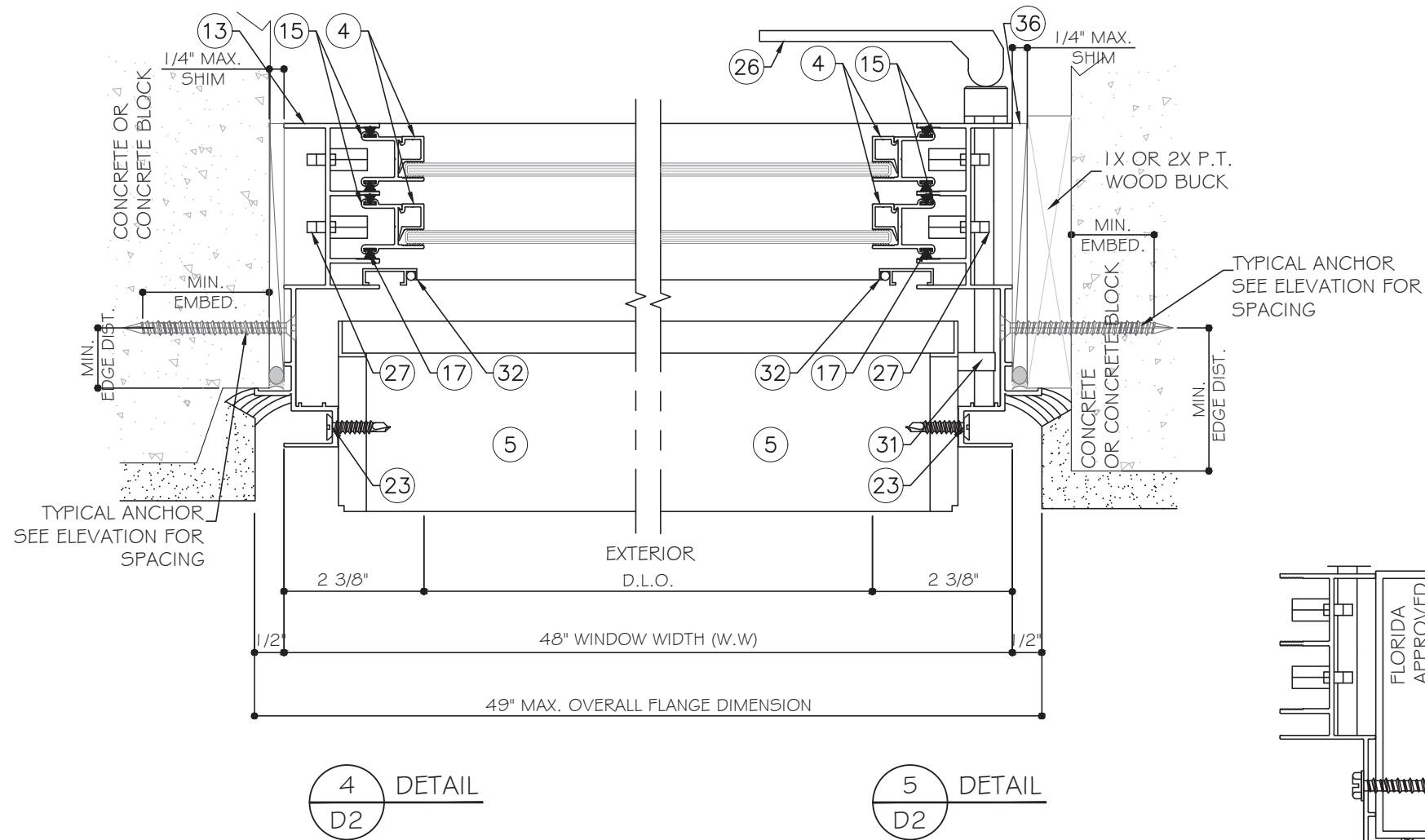

4
D2
DETAIL

5
D2
DETAIL

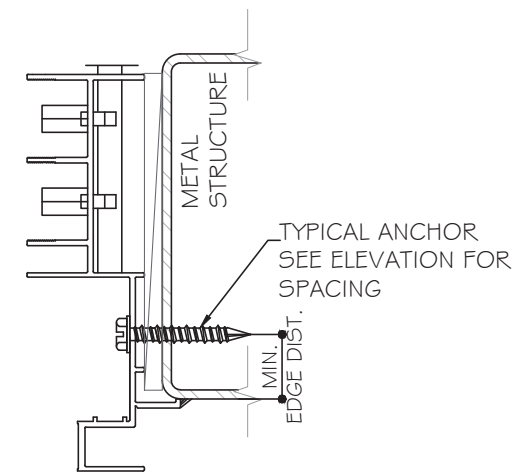
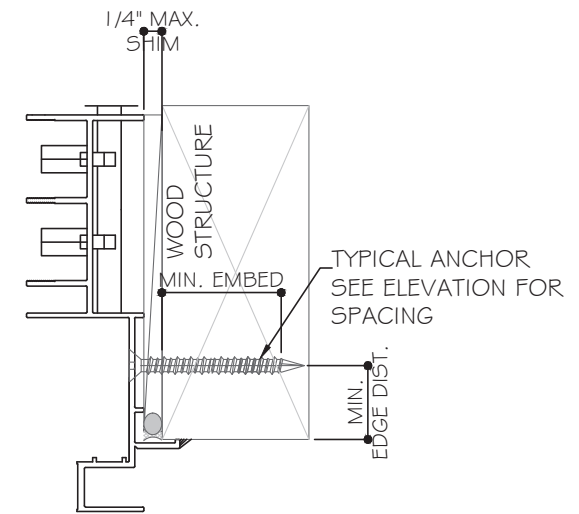
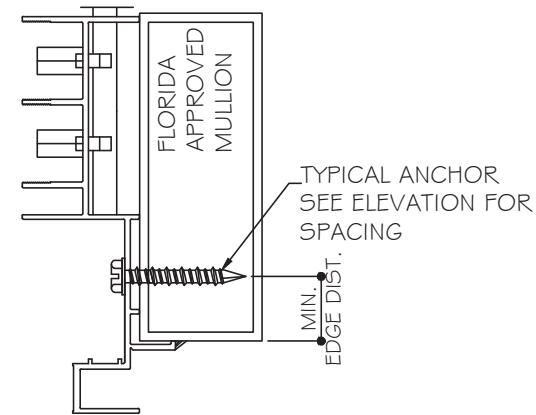

HARDWARE SCHEDULE:

- A. Four (4) spring and pulley balances, with I.D. BSI -- locate two (2) at each frame jamb.
- B. Two (2) surface mounted metallic cam locks, with I.D. BC 49 -- locate at bottom vent top rail, 9 1/2" from each end.
- C. Two (2) surface mounted keepers, with I.D. BC 39 locate at top vent bottom rail, 9 1/2" from each end.
- D. Four (4) plastic vent guides, with no I.D. marks -- locate one (1) at each end of each vent top rail.
- E. Four (4) steel balance clips, with I.D. marks -- locate two (2) at each frame jamb, 90 1/2" and 92" from bottom.
- F. Two (2) surface mounted lever type cam locks, operating louvers, with I.D. Solatrol -- locate at left frame jamb, 16" and 58" from bottom.
- G. Fifty-four (54) aluminum pivot hinges, with no I.D. marks -- locate one (1) at each end of each louver.
- H. Four (4) aluminum slide bar assemblies, 3/4" x 47" long, with no I.D. marks -- locate one (1) at each frame jamb.

FLORIDA APPROVAL:
FL #26360

YIPING WANG, P.E.
FLORIDA REGISTRATION
No. 55983
November 23rd, 2023

MCY ENGINEERING, INC.
GLAZING CONSULTANTS
12781 MIRAMAR PKWY. STE. 301
MIRAMAR, FL 33027 P: 305.271.0117
www.MCYEngineering.com mcy@mcyengineering.com

SOL-A-TROL
ALUMINUM PRODUCTS, INC.
4101 N.W. 132ND STREET MIAMI, FL 33054
TEL. (303)-681-2020

Rev. No.	Date	Drawn By	Description
Rev.2	11.23.2023	James	UPDATE TO FBC 2023

Drawn Date: 11.23.2023 Scale: as shown

DRAWING NO. AD18-06

Sheet No. 3 of 7

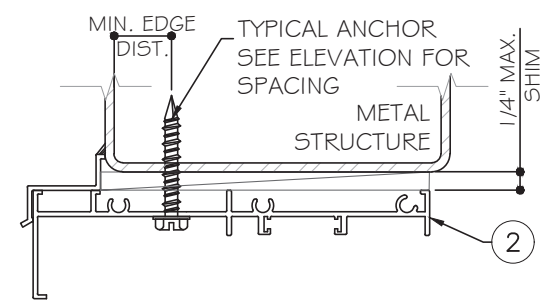
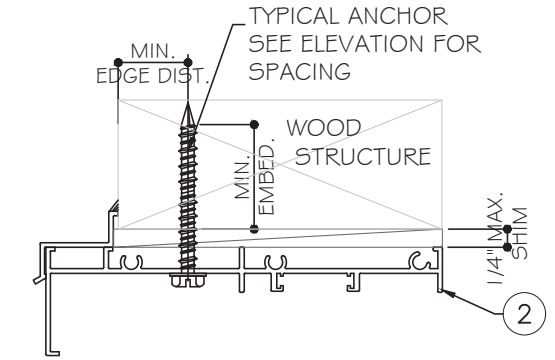
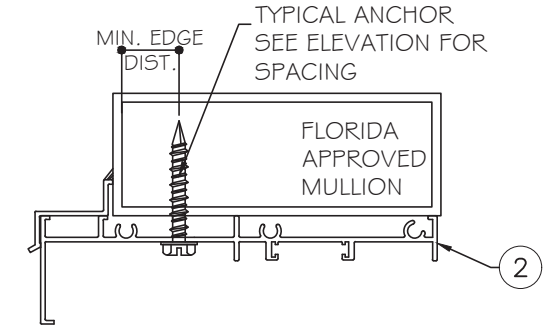
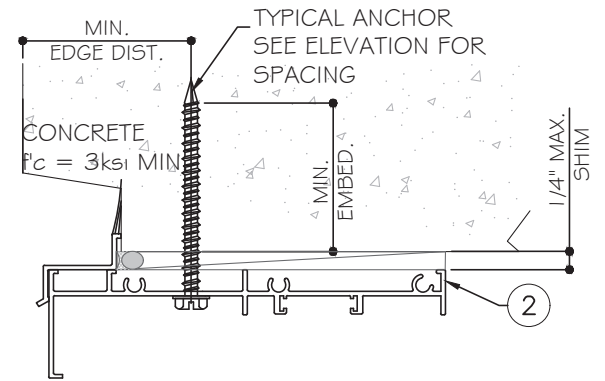
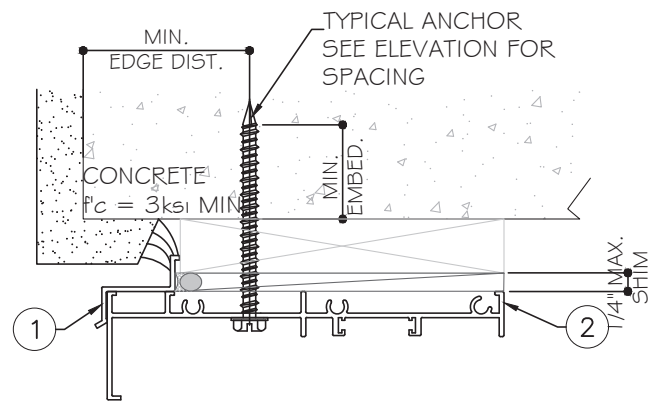

TYPICAL ANCHORS:
SEE ELEVATIONS FOR SPACING

1/4" DIA. TAPCON (Fu= 120 ksi, Fy= 92 ksi)
 INTO 2BY WOOD BUCKS OR WOOD STRUCTURE
 WITH 1 1/2" MIN. PENETRATION INTO WOOD
 OR THRU 1 BY WOOD BUCKS
 1-3/4" MIN. EMBED INTO CONCRETE
 1-1/4" MIN. EMBED INTO HOLLOW BLOCK (JAMB ONLY)

1/4 DIA TAPCON (Fu= 120 ksi, Fy=92 ksi)
 WITH 1 3/4" EMBED INTO CONCRETE
 OR 1-1/4" MIN. EMBED INTO MASONRY (JAMB ONLY)

1/4" ULTRACON+ BY 'DEWALT' (Fu= 164 ksi, Fy= 148 ksi)
 INTO 2BY WOOD BUCKS OR WOOD STRUCTURE
 WITH 1 1/2" MIN. PENETRATION INTO WOOD
 OR THRU 1 BY WOOD BUCKS
 1-3/4" MIN. EMBED INTO CONCRETE
 1-3/4" MIN. EMBED INTO GROUT FILLED BLOCK (JAMB ONLY)
 1-1/4" EMBED INTO HOLLOW BLOCK (JAMB ONLY)

1/4" ULTRACON+ BY 'DEWALT' (FU= 164 KSI, FY= 148 KSI)
 WITH 1 3/4" EMBED INTO CONCRETE
 1-3/4" MIN. EMBED INTO CONCRETE
 1-3/4" MIN. EMBED INTO GROUT FILLED BLOCK
 1-1/4" EMBED INTO HOLLOW BLOCK (JAMB ONLY)

#14 SMS (GRADE 2) INTO:
 1/8" THK METAL STRUCTURE
 ALUM. 18" THK. (6063-T5 MIN.)
 STEEL: 12 GA MIN. THK.

#14 TEKS (GRADE 5, SELF DRILLING SCREW) INTO:
 1/8" THK METAL STRUCTURE
 ALUM. 18" THK. (6063-T5 MIN.)
 STEEL: 12 GA MIN. THK.

WEATHERSTRIPPING REQUIREMENTS:

- A. SINGLE ROW VINYL BULB LOCATED AT THE FRAME SILL ON THE EXTERIOR.
- B. SINGLE ROW, WOOL PILE WITH INTEGRAL PLASTIC LOCATED AT THE TOP VENT RAIL AND ON THE INTERIOR AND EXTERIOR OF FRAME HEAD, AND AT EACH VENT JAMB RAIL.
- C. ONE (1) STRIP OF PILE WEATHERSTRIP, 1 3/8" LONG LOCATED AT EACH END OF THE TOP VENT BOTTOM RAIL AND AT THE BOTTOM VENT TOP RAIL
- D. ONE (1) VINYL FLAP LOCATED AT THE BOTTOM VENT BOTTOM RAIL, AT THE INTERIOR SILL FLANGE AND AT THE TOP OF EACH LOUVER.
- E. ONE (1) ADHESIVE BACKED CLOSED CELL FOAM PAD, 1" X 1 1/2" X 1/2" HIGH LOCATED AT EACH LOWER FRAME CORNER.
- F. ONE (1) ADHESIVE BACKED CLOSED CELL FOAM PAD, 5/8" X 44" 7/8" X 1/4" HIGH LOCATED AT THE INTERIOR OF THE BOTTOM VENT BOTTOM RAIL.
- G. ONE (1) ADHESIVE BACKED CLOSED CELL FOAM PAD, 5/8" X 1" X 1/4" HIGH LOCATED AT THE LEFT END OF THE BOTTOM VENT BOTTOM RAIL.

FLORIDA APPROVAL:
 FL #26360

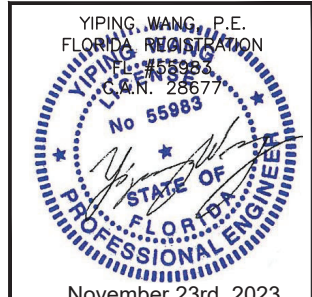

MCY ENGINEERING, INC.
 GLAZING CONSULTANTS
 12781 MIRAMAR PKWY. STE. 301
 MIRAMAR, FL 33027 P: 305.271.0117
 www.MCYEngineering.com mcy@mcyengineering.com

540 SINGLE/DOUBLE HUNG WINDOW IMP. LOUVER BLADES

SOL-A-TROL
ALUMINUM PRODUCTS, INC.
 4101 N.W. 132ND STREET MIAMI, FL 33054
 TEL. (303)-681-2020

Rev. No.	Date	Drawn By	Description
Rev.2	11.23.2023	James	UPDATE TO FBC 2023

Drawn Date: 11.23.2023 Scale: as shown

DRAWING NO.
AD18-06

Sheet No.
 A1
 4 OF 7

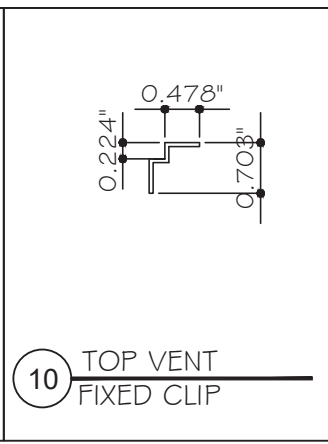
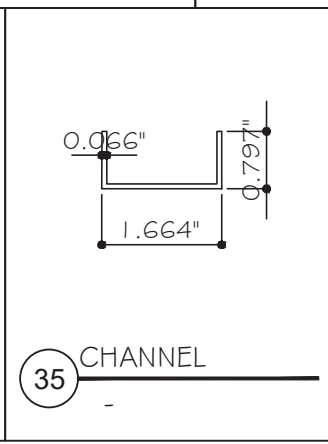
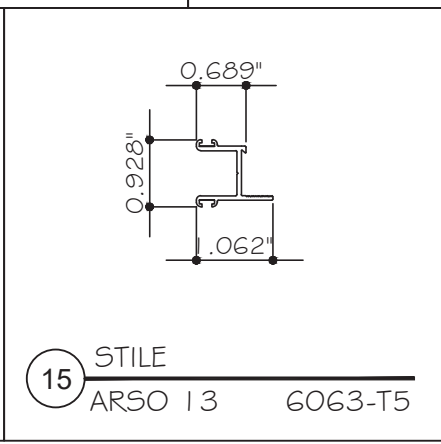
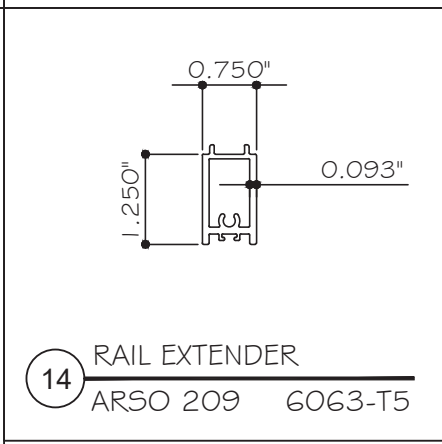
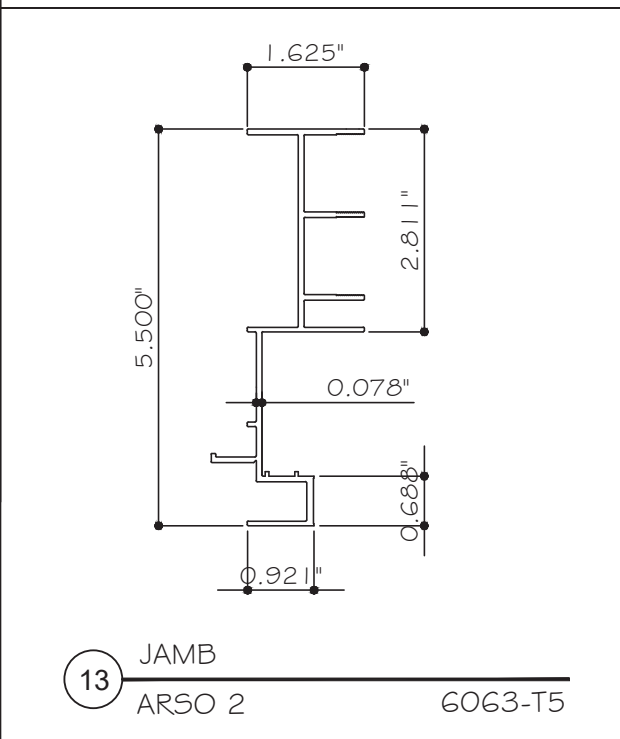
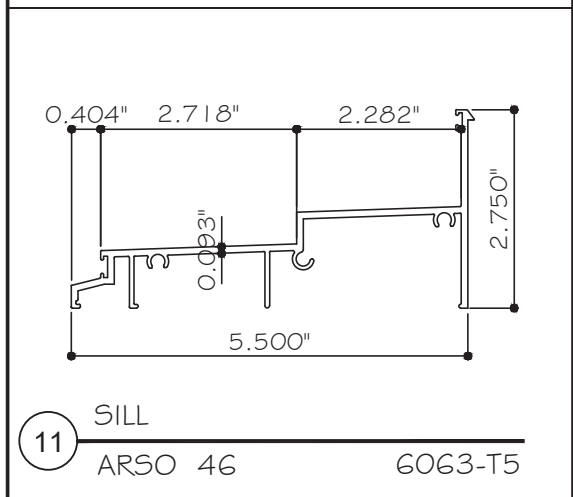
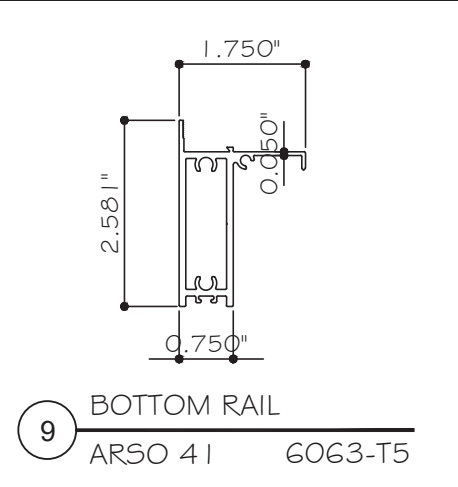
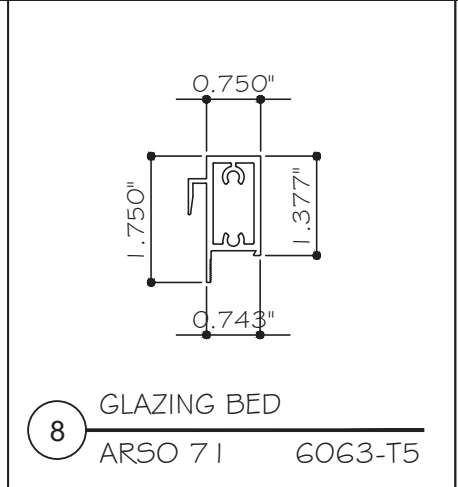
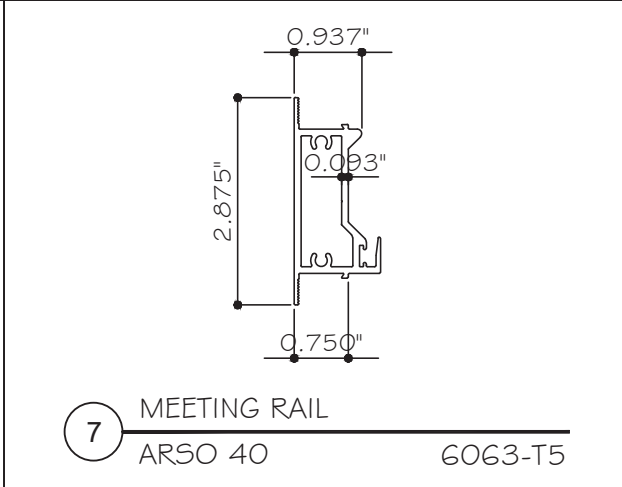
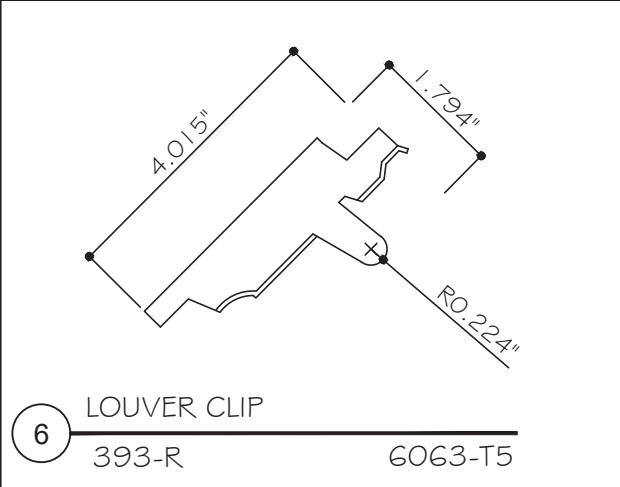
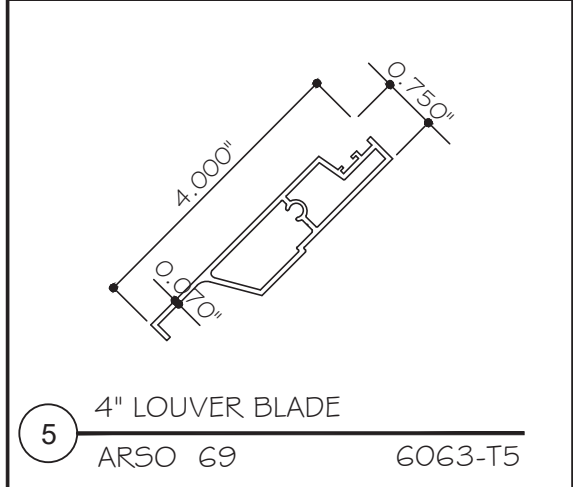
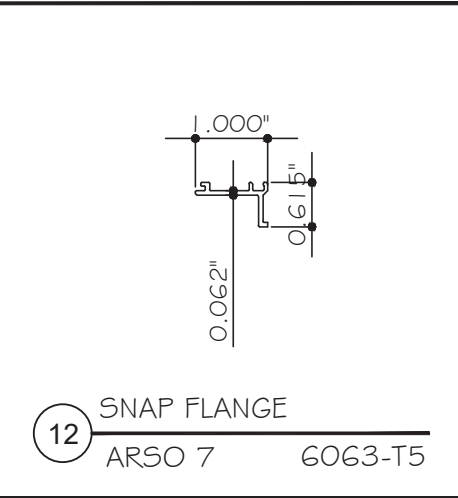
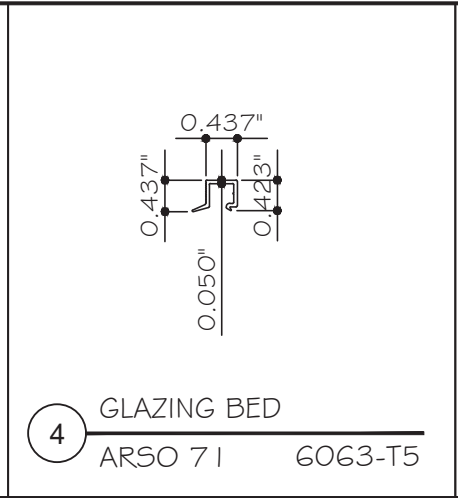
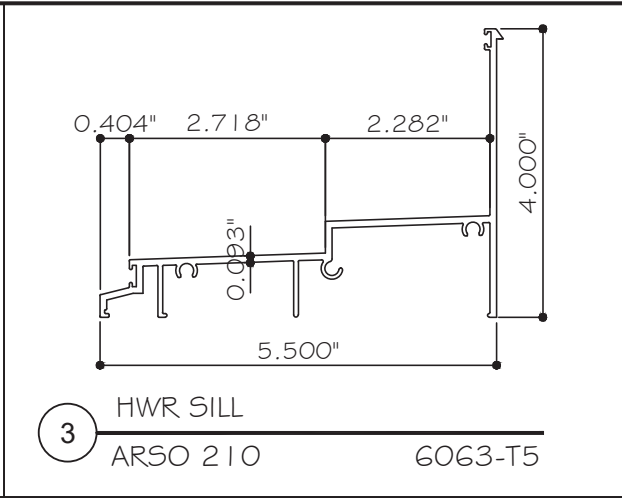
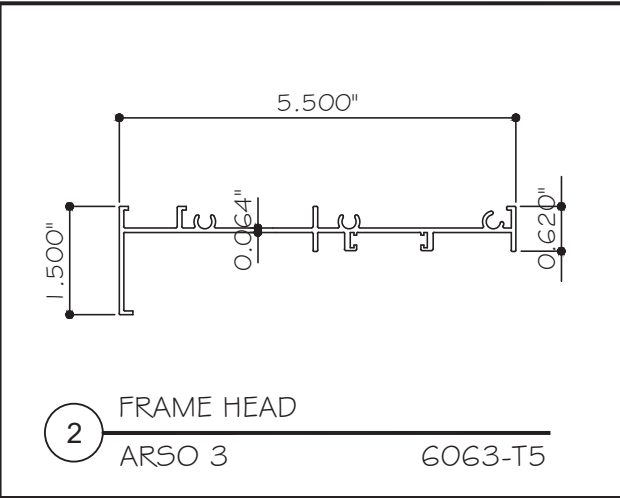
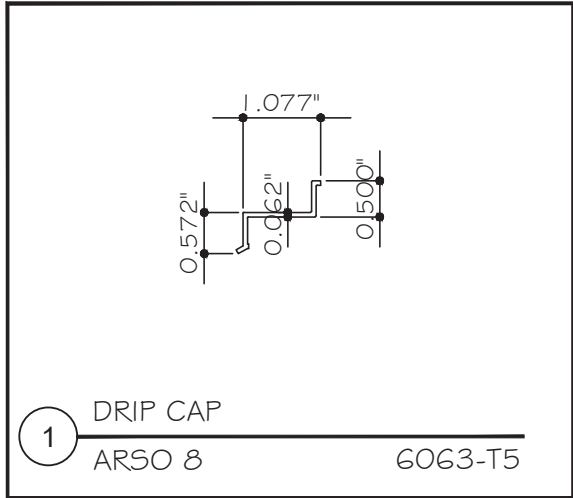

FLORIDA APPROVAL:
FL #26360

YIPING WANG, P.E.
FLORIDA REGISTRATION
No. 55983
November 23rd, 2023

MCY ENGINEERING, INC.
GLAZING CONSULTANTS
12781 MIRAMAR PKWY. STE. 301
MIRAMAR, FL 33027 P: 305.271.0117
www.MCYEngineering.com mcy@mcyengineering.com

SOL-A-TROL
ALUMINUM PRODUCTS, INC.
4101 N.W. 132ND STREET MIAMI, FL 33054
TEL. (305)-681-2020

540 SINGLE/DOUBLE HUNG WINDOW IMP. LOUVER BLADES

Rev. No.	Date	Drawn By	Description
Rev.2	11.23.2023	James	UPDATE TO FBC 2023

Drawn Date: 11.23.2023 Scale: as shown

DRAWING NO. AD18-06

Sheet No. P1 5 OF 7

BILL OF MATERIALS

ITEM	PART	DESCRIPTION	MATERIAL
1	ARSO 8	DRIP CAP	6063-T5
2	ARSO 3	HEAD	6063-T5
3	ARSO 210	HDW SILL	6063-T5
4	ARSO 71	GLAZING BED	6063-T5
5	ARSO 69	4" LOUVER BLADE	6063-T5
6	393-R	LOUVER CLIP	3003 ALUM
7	ARSO 40	MEETING RAIL	6063-T5
8	ARSO 47	TOP/LOWER MEETING RAIL	6063-T5
9	ARSO 41	BOTTOM RAIL	6063-T5
10	-	TOP VENT FIXED CLIP (2 PER WINDOW)	6063-T5
11	ARSO 46	SILL	6063-T5
12	ARSO 7	SNAP FLANGE	6063-T5
13	ARSO 2	JAMB	6063-T5
14	ARSO 209	RAIL EXTENDER	6063-T5
15	ARSO 13	STILE	6063-T5
16	-	SMALL JOINT SEALER	-
17	187	SINGLE FIN WEATHERSTRIPPING (3/16" BASE, 201 PILE HEIGHT) #210187	SCHLEGEL MFG.
18	187- R	VINYL WEATHERSTRIPPING #150	PVC
19	-	1/4" DIA. TAPCON (LENGTH VARIES) ANCHOR PAGE FOR MIN. EMBEDMENT	-
20	FP-86-5	VINYL BULB (3/16" BASE, 9/32" DIA. BULB)	PVC
21	182	TUBULAR RIVET(.182X.281 OHSI AP)	ALUM
22	10-A	#10 X 1" STAINLESS STEEL PAN HEAD SCREW	18-8 S.S.
23	10-B	#10 X 1 1/2" STAINLESS STEEL HEX HEAD TEK SCREW	18-8 S.S.
24	10-C	#10 X 1" CADMIUM PLATED STEEL PAN HEAD SCREW	18-8 CAD P. S.
25	10-C	#10 X 1/2" STAINLESS STEEL PAN HEAD SCREW	-
26	148-003	LOUVER HANDLE	-
27	37-40	BLOCK & TACKLE SASH BALANCE	-
28	204-002	KEEPER	-
29	290-001	SWEEP LOCK	-
30	313	5/16 HEX ROD	2024-T4
31	1580	SPOOL ARM	-
32	ARSO 30	SCREEN FRAME	-
33	-	1/4" TEMPERED GLAZING	-
34	-	INSECT SCREEN	-
35	-	CANTELIVER SPAN REDUCTION CHANNEL	6063-T5
36	-	1/4" SHIM (THK. X 1 7/8" X 3 5/8" WITH SLOT)	ABC
37	-	SETTING BLOCKS AT 1/4 POINT	NEOPRENE 70 SHORE A

MCY ENGINEERING, INC.
GLAZING CONSULTANTS

12781 MIRAMAR PKWY. STE. 301
MIRAMAR, FL 33027 P: 305.271.0117

www.MCYEngineering.com mcy@mcyengineering.com

540 SINGLE/DOUBLE HUNG WINDOW IMP. LOUVER BLADES

SOL-A-TROL
ALUMINUM PRODUCTS, INC.
4101 N.W. 132ND STREET MIAMI, FL 33054
TEL. (303)-681-2020

FLORIDA APPROVAL:
FL #26360

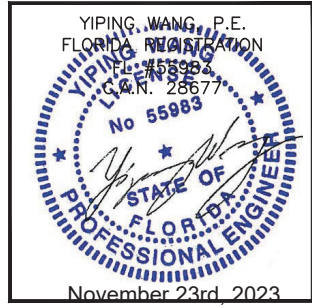

Rev. No.	11.23.2023	James	Drawn By	UPDATE TO FBC 2023	Description				
Drawn Date	11.23.2023								
Scale	as shown								
DRAWING NO.									
AD18-06									
BOM									
Sheet No.									
6 OF 7									

VENT TOP RAIL TO STILE CONNECTION

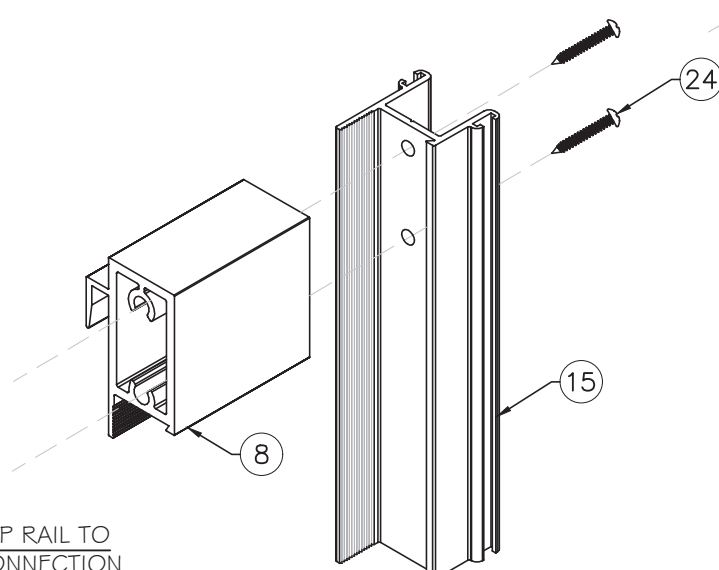

VENT BOTTOM RAIL TO STILE CONNECTION

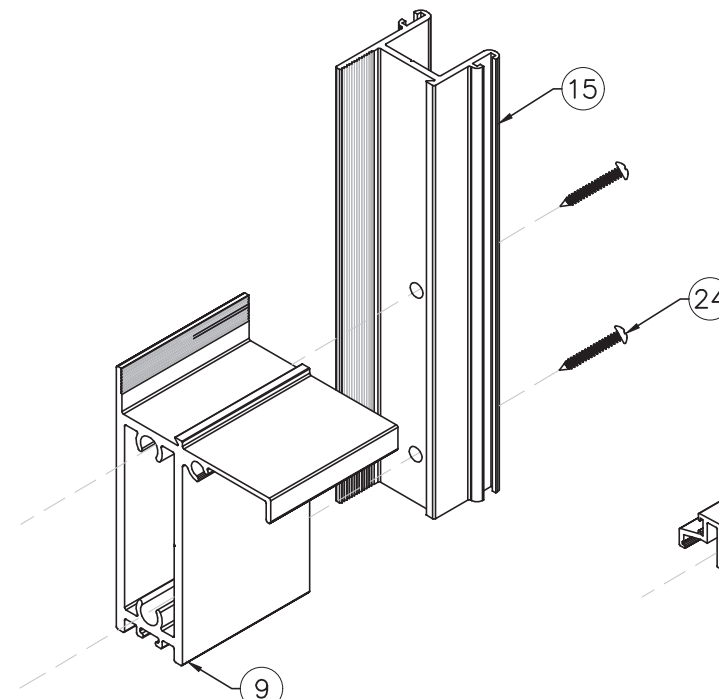

FRAME HEAD TO JAMB CONNECTION

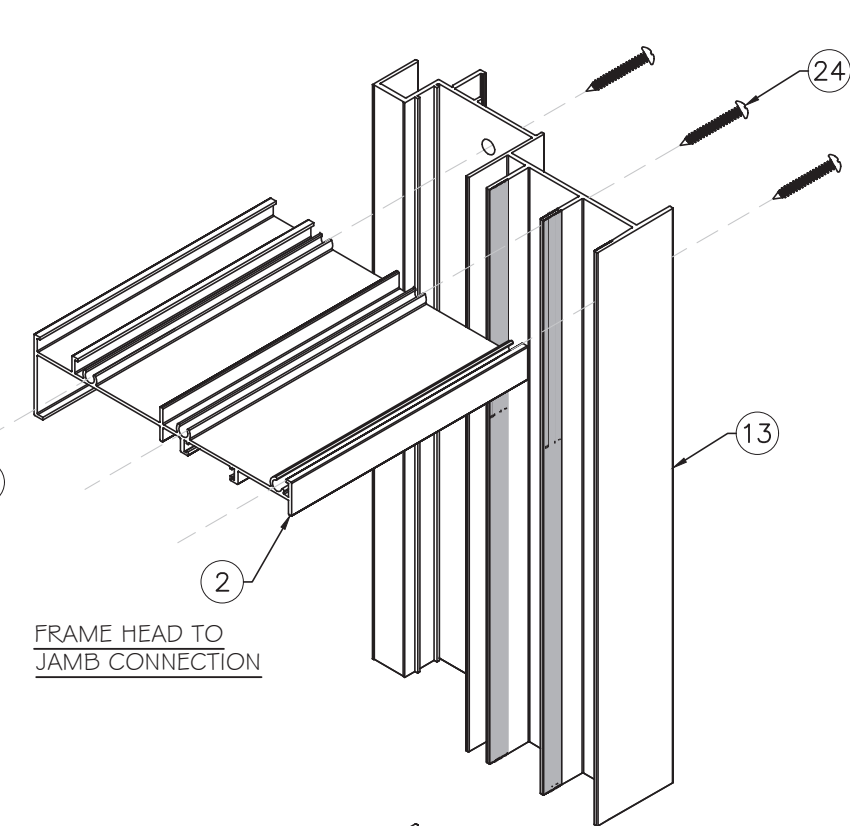

FRAME SILL TO JAMB CONNECTION

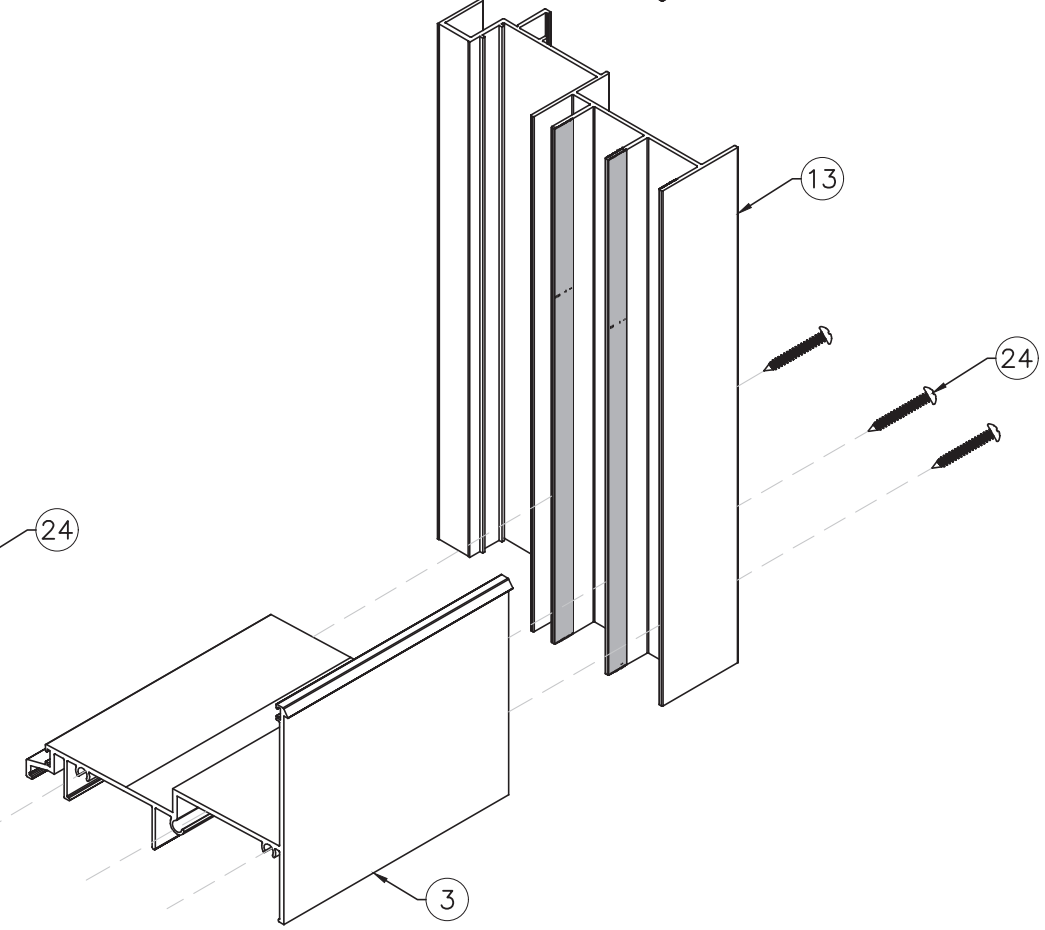

10 VENT FIXED CLIP (2 PER WINDOW)

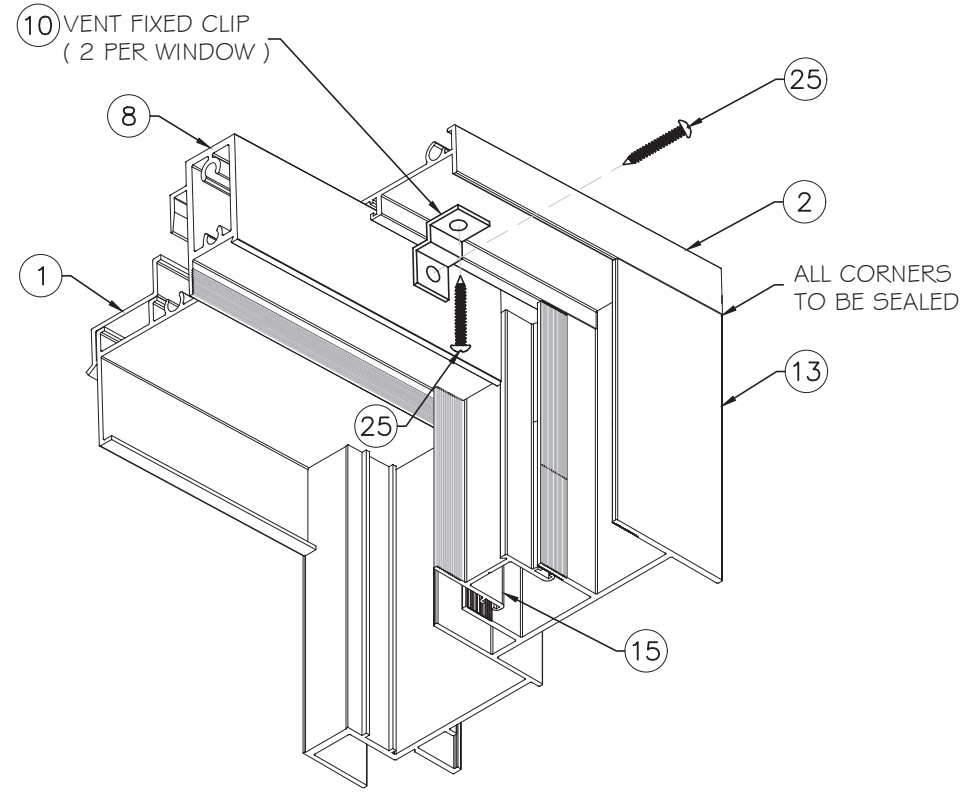

NOTE: MEETING RAIL IS NOT FIXED TO FRAME IN EITHER SINGLE OR DOUBLE HUNG CONFIGURATION

NOTE: MEETING RAIL IS NOT FIXED TO FRAME IN EITHER SINGLE OR DOUBLE HUNG CONFIGURATION

ALL CORNERS TO BE SEALED

FLORIDA APPROVAL:
FL #26360

YIPING WANG, P.E.
FLORIDA REGISTRATION
No 55983
November 23rd, 2023

MCY ENGINEERING, INC.
GLAZING CONSULTANTS
12781 MIRAMAR PKWY. STE. 301
MIRAMAR, FL 33027 P: 305.271.0117
www.MCYEngineering.com mcy@mcyengineering.com

540 SINGLE/DOUBLE HUNG WINDOW IMP. LOUVER BLADES
SOL-A-TROL
ALUMINUM PRODUCTS, INC.
4101 N.W. 132ND STREET MIAMI, FL 33054
TEL. (303)-681-2020

Rev. No.	Date	Drawn By	Description
Rev.2	11.23.2023	James	UPDATE TO FBC 2023

Drawn Date: 11.23.2023 Scale: as shown

DRAWING NO. AD18-06

ISO

Sheet No. 7 OF 7