

# 4006 SL

## 380 KV

### MOTOR SPECIFICATIONS

Kv (Motor Velocity Constant)	380 RPM/V
Kt (Motor Torque Constant)	0.033 Nm/A @ 4826 RPM
Maximum Continuous Current*	9A (180s)
Maximum Continuous Power*	233W (180s)
Power Density	2.9 W/g [Rated], 4.73 W/g [Maximum]
Voltage Range	22V - 25V [ 6S LiPo]
I <sub>o</sub> (24@V)	0.6A [24@V]
Inductance per phase (Winding Inductance)	0.119 [ ≈0.03] mH
R <sub>ph</sub> (Wind Resistance per phase)	0.23 [ ≈0.03] Ω
Stator Poles	18S
Magnetic Poles	24P
Bearings	Dual 619/4-2RS Sealed
Stick Out Shaft Diameter	∅ 4 mm
Motor Diameter	∅ 44.6 mm
Motor Length	20 mm
Motor Weight	67 g ± 2 g
Motor Mount Pattern @ 90 deg	4 X M3 @ PCD ∅ 25 mm ↓ 2.5 mm
Compatible Propeller Size	13 " inch to 16 " inch
Propeller Mount Pattern	4 X M3 @ PCD ∅ 12 mm ↓ 3 mm

### 2D CAD

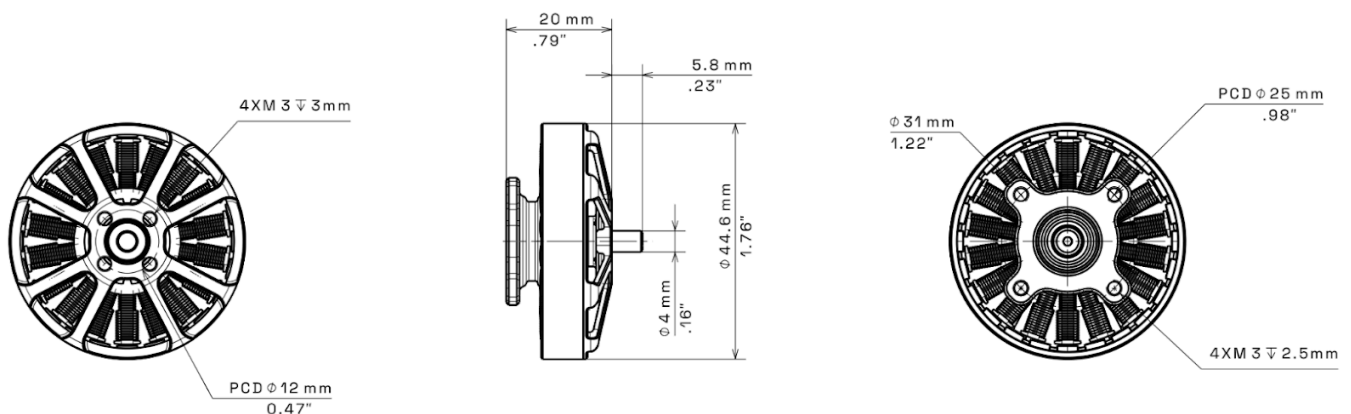

Note: Specifications and drawings may be revised without notice. Vector Technics assumes no liability for reliance on unverified data.  
All Dimensions in millimeters [mm]

# 4006 SL 380 KV - TEST DATA

Note: The test data provided below is subject to environmental and testing conditions, including but not limited to temperature, humidity, altitude, and the equipment used. Results may vary depending on specific testing parameters and conditions.

<b>Propeller</b>	TM 14 x 4.8 CF_FX			<b>Power Supply / Battery</b>	TB - 22000mAh 6S		
<b>ESC</b>	HW 40A 6S			<b>Environmental Temp:</b>	29 ° C		
<b>Test Date:</b>	10-08-2024	<b>Humidity:</b>	60 %	<b>Cross-winds:</b>	Mild		

PWM - Throttle%	Voltage	Current (A)	RPM	Thrust (g)	Torque (N*m)	Electrical Power (W)	Efficiency	Temp (Celcius)
1300 - 30	25.1	0.5	2286	194	0.03	12.6	15.5	45 ° C [@70% 10 min Constant]
1400 - 40	25	1	3075	327	0.05	25.0	13.1	
1500 - 50	25	2.1	3979	570	0.09	52.5	10.9	
1600 - 60	25	3.5	4755	797	0.13	87.5	9.1	
1700 - 70	24.9	5.2	5337	1067	0.18	129.5	8.2	
1800 - 80	24.8	7.1	5964	1285	0.21	176.1	7.3	50 ° C [Maximum]
1900 - 90	24.7	9.6	6550	1575	0.26	237.1	6.6	
1950 - 95	24.7	10.3	6617	1657	0.27	254.4	6.5	
2000 - 100	24.7	10.4	6602	1663	0.28	256.9	6.5	

<b>Propeller</b>	SS 15 x 5.5 CF_FX			<b>Power Supply / Battery</b>	TB - 22000mAh 6S		
<b>ESC</b>	HW 40A 6S			<b>Environmental Temp:</b>	33 ° C		
<b>Test Date:</b>	04-04-2025	<b>Humidity:</b>	57 %	<b>Cross-winds:</b>	Mild		

PWM - Throttle%	Voltage	Current (A)	RPM	Thrust (g)	Torque (N*m)	Electrical Power (W)	Efficiency	Temp (Celcius)
1300 - 30	25.1	0.5	2127	192	0.04	12.6	15.3	58 ° C [@70% 10 min Constant]
1400 - 40	25	1.3	2860	367	0.07	32.5	11.3	
1500 - 50	25	2.7	3659	625	0.12	67.5	9.3	
1600 - 60	24.9	4.5	4294	890	0.17	112.1	7.9	
1700 - 70	24.8	6.7	4861	1154	0.22	166.2	6.9	
1800 - 80	24.7	9.2	5354	1409	0.27	227.2	6.2	61 ° C [Maximum]
1900 - 90	24.5	12.4	5788	1697	0.33	303.8	5.6	
1950 - 95	24.5	13	5833	1756	0.34	318.5	5.5	
2000 - 100	24.5	13	5837	1751	0.34	318.5	5.5	

<b>Propeller</b>	TM 16.2 x 5.3 CF_FX			<b>Power Supply / Battery</b>	TB - 22000mAh 6S		
<b>ESC</b>	HW 40A 6S			<b>Environmental Temp:</b>	29 ° C		
<b>Test Date:</b>	10-08-2024	<b>Humidity:</b>	60 %	<b>Cross-winds:</b>	Mild		

PWM - Throttle%	Voltage	Current (A)	RPM	Thrust (g)	Torque (N*m)	Electrical Power (W)	Efficiency	Temp (Celcius)
1300 - 30	25.1	0.6	2100	223	0.05	15.1	14.8	53 ° C [@70% 10 min Constant]
1400 - 40	25.1	1.4	2801	424	0.08	35.1	12.1	
1500 - 50	25	2.8	3582	722	0.13	70.0	10.3	
1600 - 60	25	4.7	4265	1010	0.18	117.5	8.6	
1700 - 70	24.9	6.9	4826	1293	0.23	171.8	7.5	
1800 - 80	24.8	9.4	5337	1511	0.27	233.1	6.5	60 ° C [Maximum]
1900 - 90	24.7	12.5	5770	1862	0.33	308.8	6.0	
1950 - 95	24.6	13.2	5834	1935	0.34	324.7	6.0	
2000 - 100	24.7	13.1	5853	1889	0.34	323.6	5.8	

Note: Specifications and drawings may be revised without notice. Vector Technics assumes no liability for reliance on unverified data.