

Revolution® 150 Series

High-Volume, Low-Speed (HVLS) Fan

Climate control with direct drive technology.

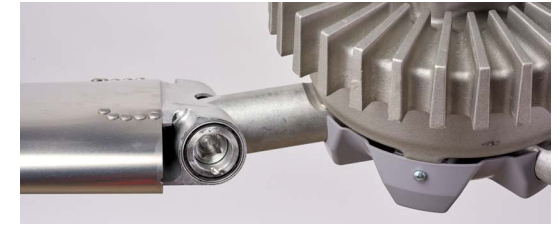

Performance

- » Improve productivity by providing evaporative cooling
- » Exclusive Propell-Aire™ aluminum blades with standard mill finish. Incorporates tilt, taper, and twist to produce consistent airflow across the entire length of the blade, eliminating pockets of stagnant air under the center of the fan
- » Covers 31,000 sq. ft., moving air up to 100 ft. in all directions from the center of the fan

Construction

- » Vibration-dampening material is incorporated to reduce stress to the hub by 50 to 75%
- » The blade and hub are balanced for smooth, efficient performance
- » Maximum weight is 250 lbs. Actual weight varies according to the fan size and mounting style
- » Backed by Rite-Hite's 50 year track record as an industrial manufacturer

NOTE: Fan assembly is pre-wired with a NEMA twist-lock plug and 5' cord.

Safety

- » All fans feature a hub to motor connection with redundant safety cable, stabilizing cables, and mounting bracket
- » A unique safety system is provided for back-up security for the motor to hub connection

Warranties

- » 3 year parts & 3 year labor warranty
- » 10 year structural integrity warranty
- » Lifetime warranty on workmanship of blades and interlocking fan arms
- » 12 month limited money-back guarantee
- » Listed to UL507 Standard

Direct Drive Motor

- » Motor is nearly silent operating between 38 to 42 dBA, depending on fan speed. Ideal for environments with sound concerns
- » Direct drive design does not require oil
- » Simplified design reduces installation time and costs

Wireless Controls

- » Customizable 7-day scheduling. Manage up to 24 fans from the wireless touch screen control station
- » Standard Ethernet connectivity allows remote access to fan controls from a PC or mobile device



Fan-Commander®

NOTE: Control box ships standard with connection locations to receive a low voltage stop signal from a fire panel to comply with NFPA 13

Specifications/Survey

Fan Dimensions and Mounting Guidelines

REVOLUTION
150 SERIES

Date _____
 Company Name _____
 Address _____
 City _____
 State _____ Zip Code _____
 Representative _____
 Salesperson _____
 Quantity _____ Signature _____

Fan Diameter:

- 20' (6100 mm)
 24' (7320 mm)

Mounting Option:

- I-Beam Bracket

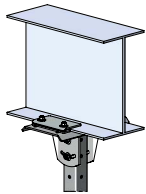

- Truss Kit

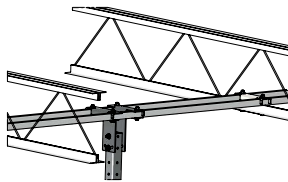

- Purlin Kit

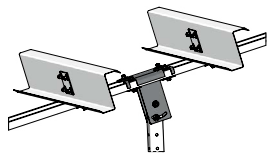

- Laminated Beam Kit

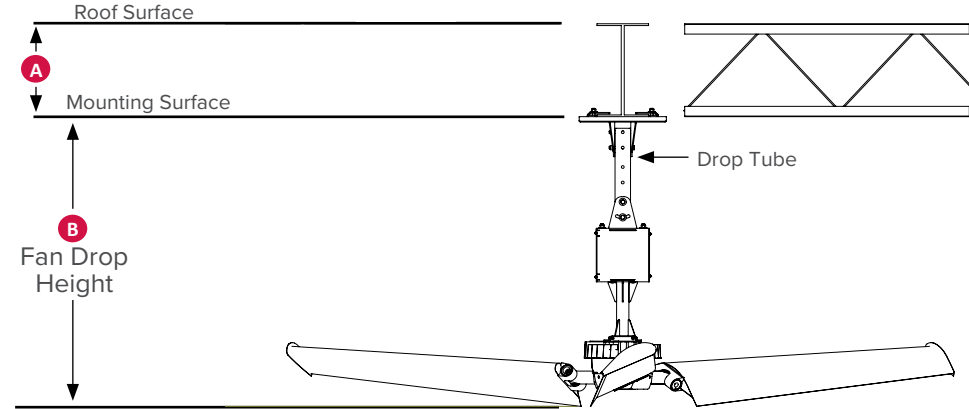
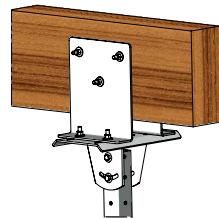

B Fan Drop Height (See Chart):

- 43" (1100 mm) (No Drop Tube)
 56" (1430 mm)
 68" (1730 mm)
 86" (2190 mm)

Voltage/Phase:

- 200-240V / 1 phase
 200-240V / 3 phase
 277V / 1 phase
 400-480V / 3 phase

600 Volt Transformer:

- No
 Yes (requires 480V / 3 phase)

EMC Compliance:

- No
 Yes

Shipment Destination:

- North America
 International

Custom Color: Blades and Hub

- No. Standard Mill Finish
 Yes.
 RAL K5# _____ (20% gloss)

Drop tubes may be cut on site to decrease Fan Drop Height. See the Owner's Manual for cut lengths and fan clearances.

A Roof Surface to Mounting Surface	B Fan Drop Height <i>Minimum height required for air intake</i>	
	20' Fan Diameter	24' Fan Diameter
0" - 6" (0 mm - 152 mm)	68"	86"
7" - 12" (178 mm - 305 mm)	68"	86"
13" - 18" (330 mm - 457 mm)	56"	68"
19" - 24" (483 mm - 610 mm)	56"	68"
25" - 36" (635 mm - 920 mm)	43"	56"
37" - 48" (940 mm - 1220 mm)	43"	56"

Minimum Fan Drop Height assumes a flat roof surface.
 Fan Drop Height may need to be increased for roofs with a steeper pitch.

Note: Controls are not included. Please order Fan-Commander® separately.

RITEHITE
ALWAYS LOOKING AHEAD

Milwaukee, Wisconsin, USA

www.ritehite.com

P 414-355-2600 (800-456-0600)

F 414-355-9248

Rite-Hite®, Fan-Commander®, Propell-Aire™ and Revolution® are trademarks of Rite-Hite Holding Corporation. Rite-Hite products may be covered by one or more U.S. Patents with other U.S. and foreign patents pending. Patent coverage: www.ritehite.com/patents. The information herein is provided as a general reference only regarding the use of the applicable products. The specifications stated here are subject to change. Manufactured by Rite-Hite Engineered Solutions Group, Inc.