

RACKEEPER™

INSTALLATION AND OWNER'S MANUAL

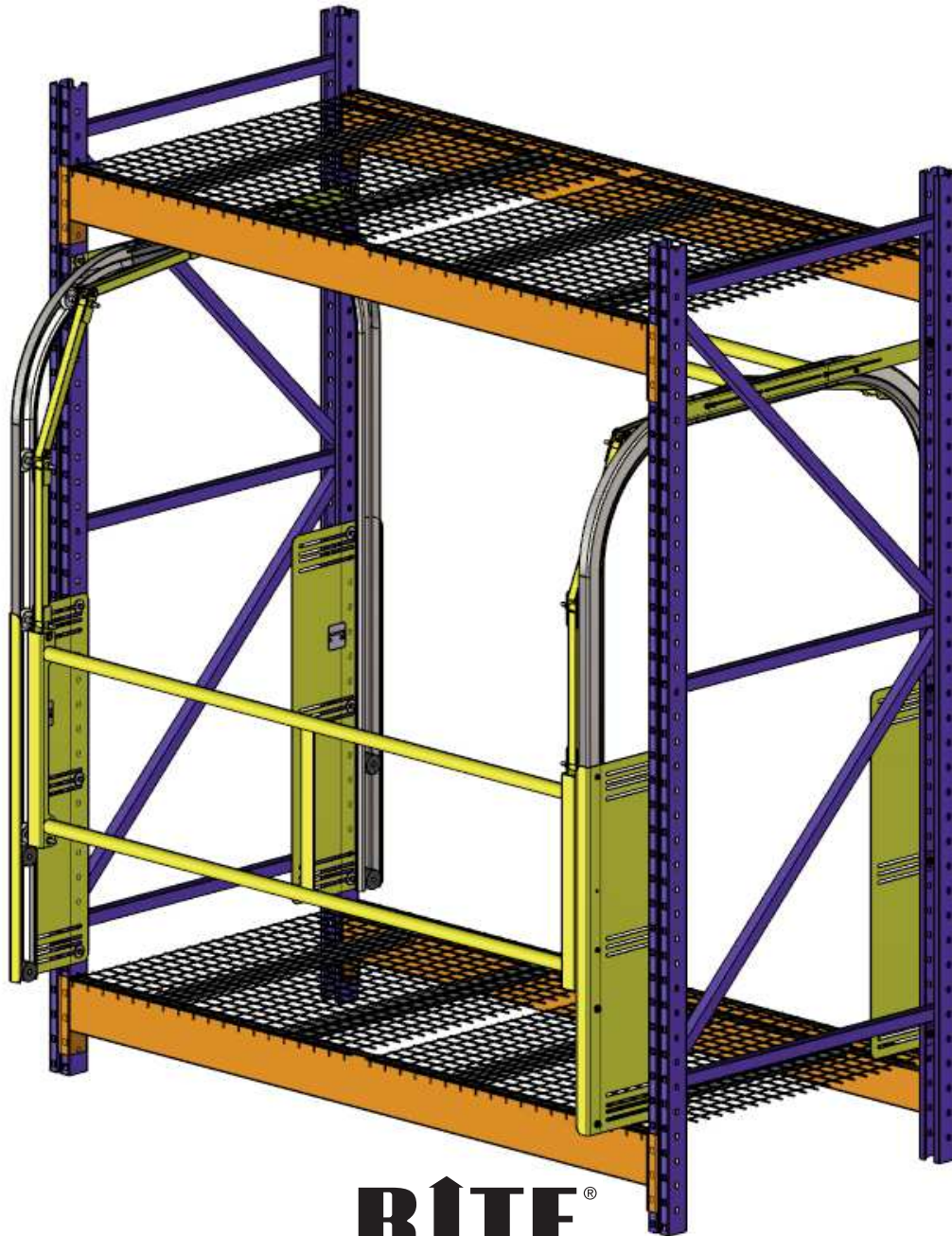

THIS MANUAL COVERS ALL UNITS SHIPPED JANUARY 2013 TO DATE

TABLE OF CONTENTS

TOOLS AND COMPONENTS	2
SAFETY WARNINGS	3
DIMENSIONS	4
INSTALLATION	5
ANNUAL PLANNED MAINTENANCE	10
PARTS LIST	11
WARRANTY	16

PRODUCT INTRODUCTION

Thank you for purchasing the RACKEEPER™ from RITE-HITE®.

IMPORTANT

Read and understand contents of this manual prior to installation or operation of this equipment. For best results, have this product serviced by your authorized RITE-HITE®.

NOTICE TO USER

Your local RITE-HITE® Representative provides the Planned Maintenance Program (P.M.P.) which can be fitted to your specific operation. Call your local representative or RITE-HITE® at 1-414-355-2600 or toll free at 1-800-456-0600.

The RITE-HITE® products in this manual may be covered by one or more of the following U.S. patents: 4,560,315 (RE: 32,968); 4,634,334; 4,692,755; 4,744,121; 4,819,770; 4,843,373; 4,865,507; 4,920,598; 4,995,130; 5,040,258; 5,111,546; 5,212,846; 5,271,183; 5,299,386; 5,311,628; 5,323,503; 5,375,965; 5,440,772; 5,442,825; 5,453,735; 5,531,557; 5,546,623; 5,553,987; 5,582,498; 5,664,930; 5,702,223; 5,762,459 (RE: 37,570); 5,882,167; 5,964,572; 6,010,297; 6,052,268; 6,065,172; 6,070,283; 6,074,157; 6,085,375; 6,092,970; 6,106,212; 6,116,839; 6,190,109; 6,220,809; 6,627,016; 6,238,163; 6,322,310; 6,311,352; 6,360,394; 6,368,043; 6,431,819; 6,488,464; 6,497,067; 6,499,169; 6,505,713; 6,524,053; 6,634,049; 6,654,976; 6,676,360; and pending U.S. and foreign patent applications. RITE-HITE®, LEVEL-RITE®, THINMAN™, SAFE-T-LIP®, HYDRACHEK®, WHEEL-LOK™, DOK-LOK®, DUAL-DOK®, SAFE-T-STRUT™, DOK-COMMANDER®, JUMBO™ and SAFE-T-GATE® are trademarks of RITE-HITE®.

TOOLS REQUIRED:

- (1) 9/16" Open End Wrench
- (1) 9/16" Socket Ratchet Wrench
- (1) 1/8" Allen Wrench
- (1) Tape Measure
- (1) Level

SAFETY WARNINGS

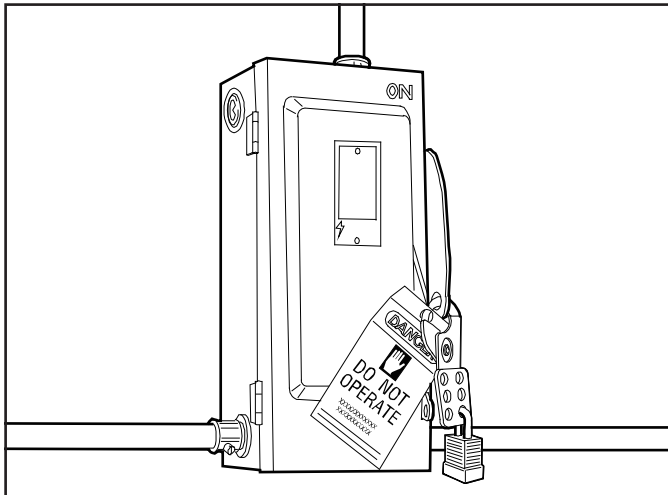



Figure 1

 WARNING	
	<p>When working with electrical or electronic controls, make sure that the power source has been locked out and tagged according to OSHA regulations or your country's local standards and approved local electrical codes.</p>

LOCKOUT / TAGOUT PROCEDURES

The Occupational Safety and Health Administration (OSHA) requires that, in addition to posting safety warnings and barricading the work area, the power supply has been locked in the OFF position or disconnected. It is mandatory that an approved lockout device is utilized. An example of a lockout device is illustrated in Figure 1. The proper lockout procedure requires that the person responsible for the repairs is the only person who has the ability to remove the lockout device.

In addition to the lockout device, it is also a requirement to tag the power control in a manner that will clearly note that repairs are under way and state who is responsible for the lockout condition. Tagout devices have to be constructed and printed so that exposure to weather conditions or wet and damp locations will not cause the tag to deteriorate or become unreadable.

RITE-HITE® Corporation does not recommend any particular lockout device, but recommends the utilization of a device that meets OSHA standards (refer to OSHA regulation 1910.147). RITE-HITE® Corporation also recommends the review and implementation of an entire safety program for the Control of Hazardous Energy (Lockout/Tagout). These regulations are available through OSHA publication 3120.

 DANGER
<p>Indicates a hazardous situation which, if not avoided, <i>will</i> result in death or serious injury.</p>

 CAUTION
<p>Indicates a hazardous situation which, if not avoided, <i>could</i> result in minor or moderate injury.</p>

 WARNING
<p>Indicates a hazardous situation which, if not avoided, <i>could</i> result in death or serious injury.</p>

NOTICE
<p><i>Indicates a situation which can cause damage to the equipment, personal property and/or the environment, or cause the equipment to operate improperly.</i></p>

DIMENSIONS

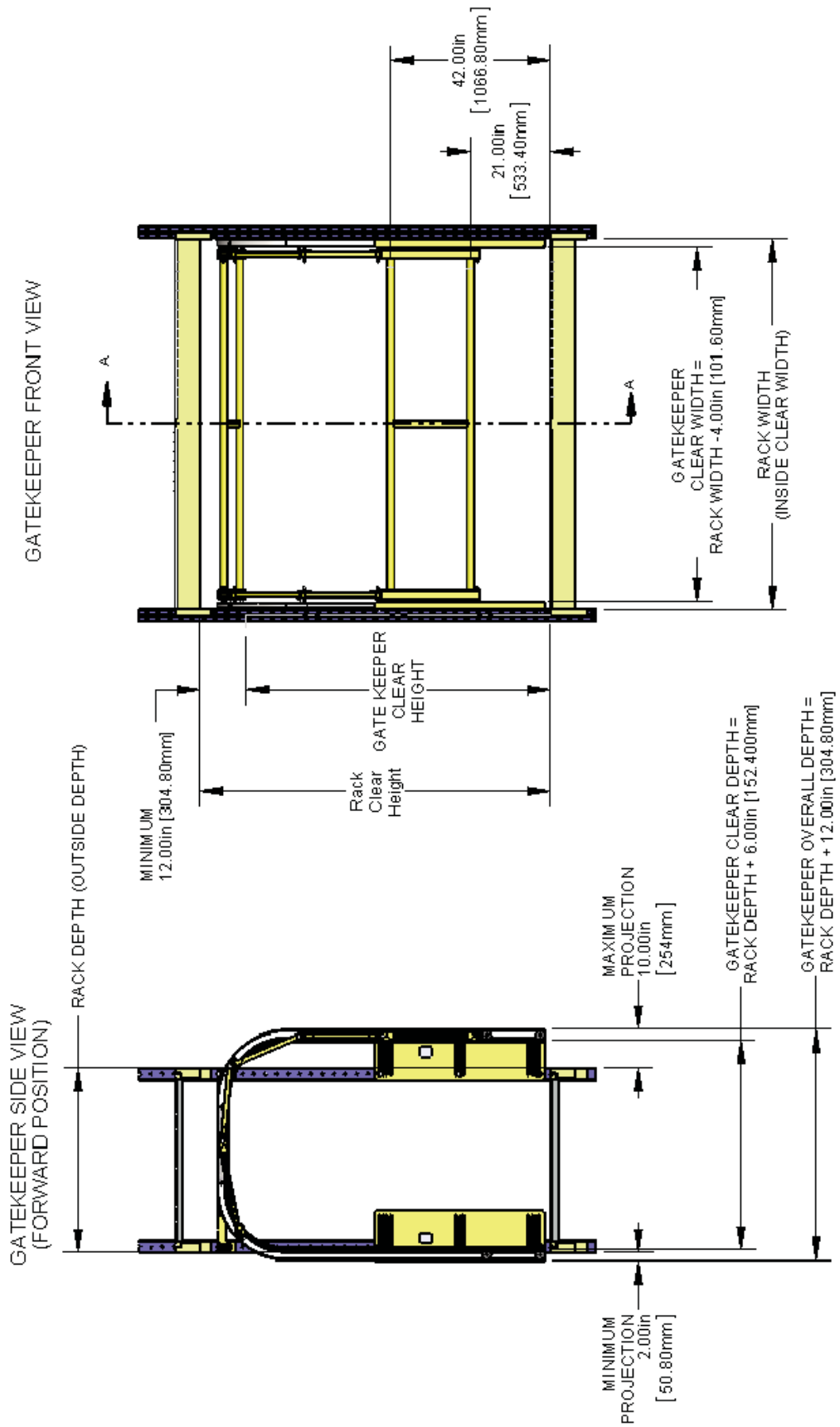

INSTALLATION

SIDE HEADER

The RackKeeper is assembled so the frames are offset toward the working platform. The Side Header is slotted so the 3" track can be slid toward the center of the rack.



Figure 2

The Side Header may need to be inverted to allow for mounting hardware clearance. The Frames with Curved track are also slotted to offset the unit.

1. Bolt each of the (4) Frames to the rack using (3) 3/8-1/4" bolts with 1-7/16" OD washers under the hex head.
2. Secure the bolt with a 1" OD washer and nylon locking nut inside the rack upright. Use existing mounting holes when possible.

NOTICE

Do NOT tighten any hardware until all of the track is properly aligned.

3. Bolt the Side Header to the racking using the same 3/8-1/4" bolts with 1-7/16" OD washers under the hex head.
4. Secure the bolt with a 1" OD washer and nylon locking nut inside the rack upright
5. Slide the front Frames with track to the desired position and tighten the mounting hardware. Make sure the projection is the same on the right and left sides.

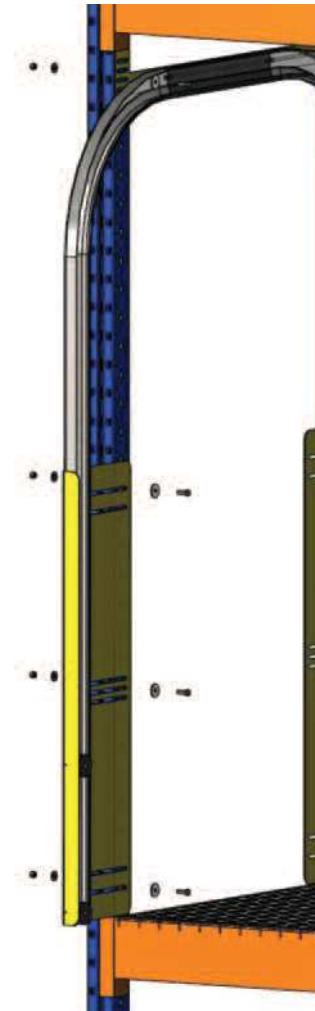

Figure 3



Figure 4

INSTALLATION CONTINUED

SECURE TRACK

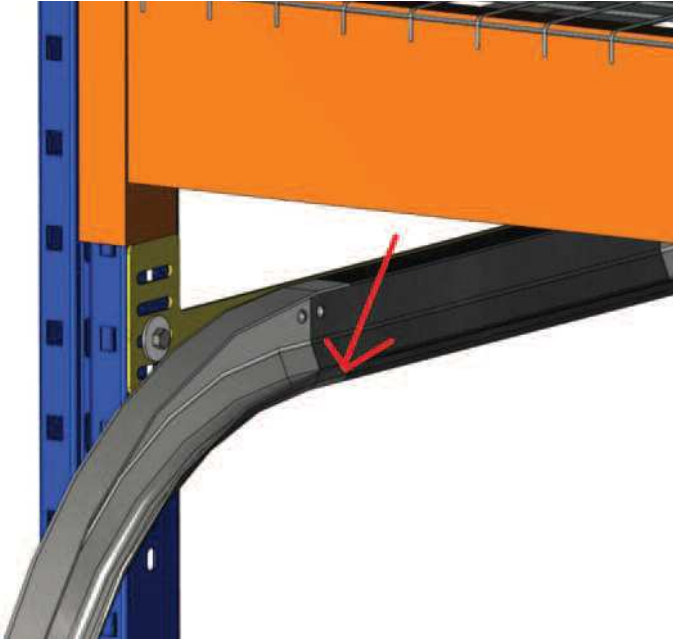

Figure 5

1. Loosen the nuts / track bolts to create a smooth transition between the curved and straight tracks.

The critical surface is on the inside bottom of the 3" Track where the wheels travel (see Figure 5).

2. Start in one corner of the unit, and align all of the track transitions.
3. Secure the curved track to the side header in four places using 1/4" Track bolt and serrated hex flange washers.
4. Tighten all of the mounting hardware.

FRONT RAIL

1. Install (2) wheels in the Front Rail using (2) set screws per side.
2. Remove the (4) bumpers from the front two 3" Tracks.

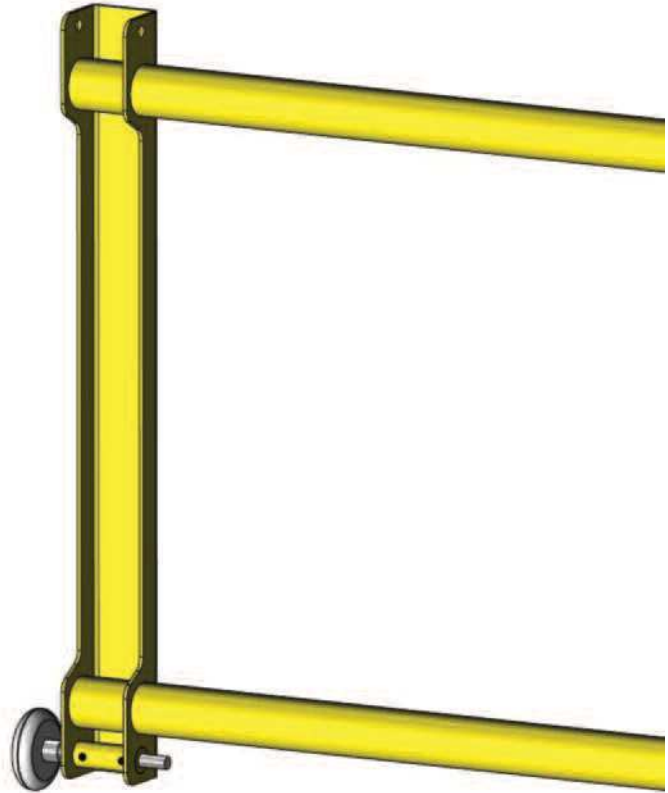

Figure 6

NOTICE

Do NOT tighten the set screws until the front rails are properly centered.

INSTALLATION CONTINUED

CROSS SECTION OF THE FRONT RAILS WITH LINKS INSTALLED

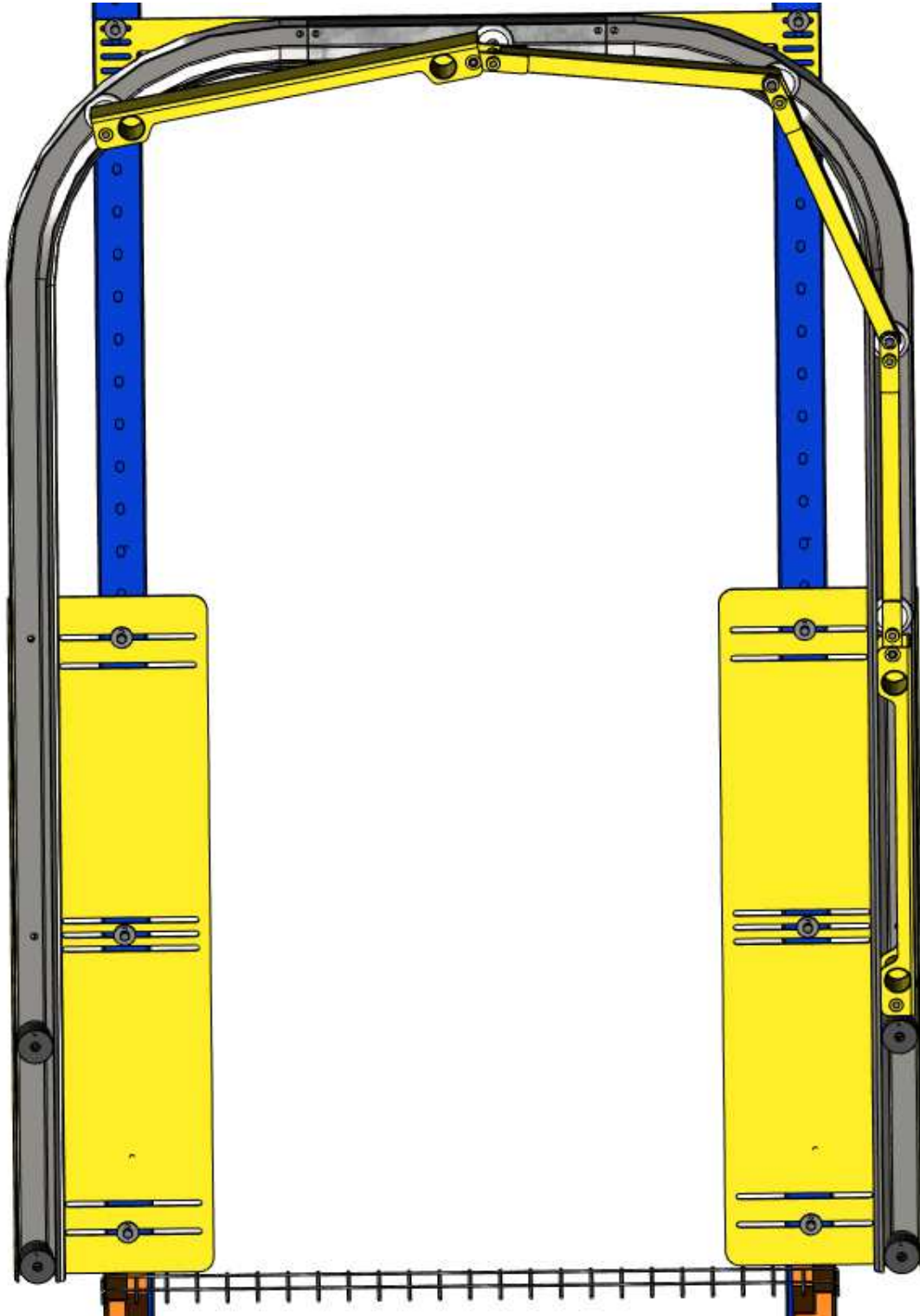

Figure 7

INSTALLATION CONTINUED

FRONT RAILS

1. Slide the Front Rail Wheels into the 3" track
2. Move the Front Rails toward the back of the unit and rest the wheels on the rubber bumpers as shown in Figure 8.
3. Locate (1) 3/8" x 3-1/4" Hex Head Bolt and (1) Double Link with (2) wheels.
4. Remove and discard (1) of the 3/8" x 2-3/4" hex head bolts installed in the Double Link.
5. Install the Double Link Wheels in the 3" Track.
6. Attach the Double Link to the Front Rail using (1) 3/8" x 3-1/4" Hex Head Bolt, (2) washers, and (1) nylock nut.



Figure 8

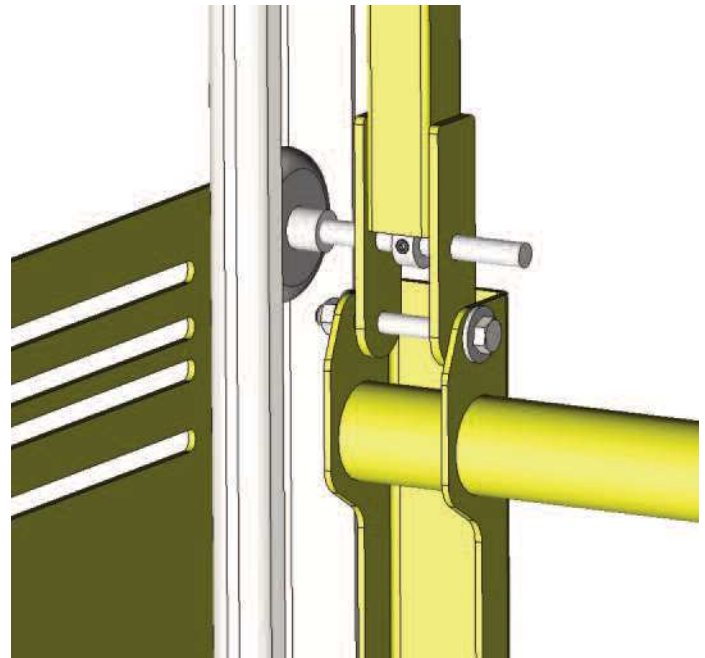

Figure 9

INSTALLATION CONTINUED

1. Attach (2) Single Links using factory installed 3/8" x 2-3/4" bolts, washers, and nylock nuts.
2. Repeat the procedure to install (1) Double Link and (2) Single Links for the Right Side.
3. Install the second Front Rail wheels in the 3" Track.
4. Slide the second Front Rail up and attach to the rear assembly using 3/8" x 3-1/4" Hex Head Bolts, washers, and nylock nuts.
5. Center the Front Rails between the Side Frames.
6. With the Front Rail centered, slide the wheels so they are centered in the 3" Track.
7. Use a 1/8" Allen wrench to tighten both set screws against the centered wheel stems.
8. Cycle the unit several times and adjust tracks and wheel spacing as required.

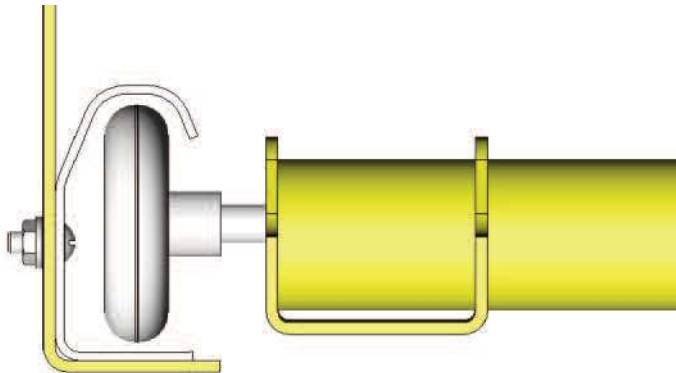

Figure 10



Figure 11

ANNUAL PLANNED MAINTENANCE

Inspect the entire unit for damage caused by impacts from fork lifts, pallets, or other objects.
Replace components as required.

Frame

Inspect anchoring method and secure as required.

Make sure frame is plumb and square.

Confirm the track mounting hardware is tight.

Confirm the front and side header mounting hardware is tight.

Rubber Bumpers

Confirm mounting hardware is tight.

Inspect rubber bumpers and replace as required.

Wheels

Check all of the set screws securing the wheel stems and tighten as required.

Allow approximately 1/2" between wheel stem shoulder and link collar.

Inspect all of the wheels. Confirm that the white nylon is properly seated on bearings. Confirm the wheel bearings are properly pressed on the wheel stem

Linkage

Inspect all connecting hardware. Bolt threads should engage nylon in lock nut. Bolts should not bend link tabs when tightened.

Rails

Components should be centered on the unit width so the wheels travel in the center of the track.

PARTS LIST

FRAMES AND TRACK

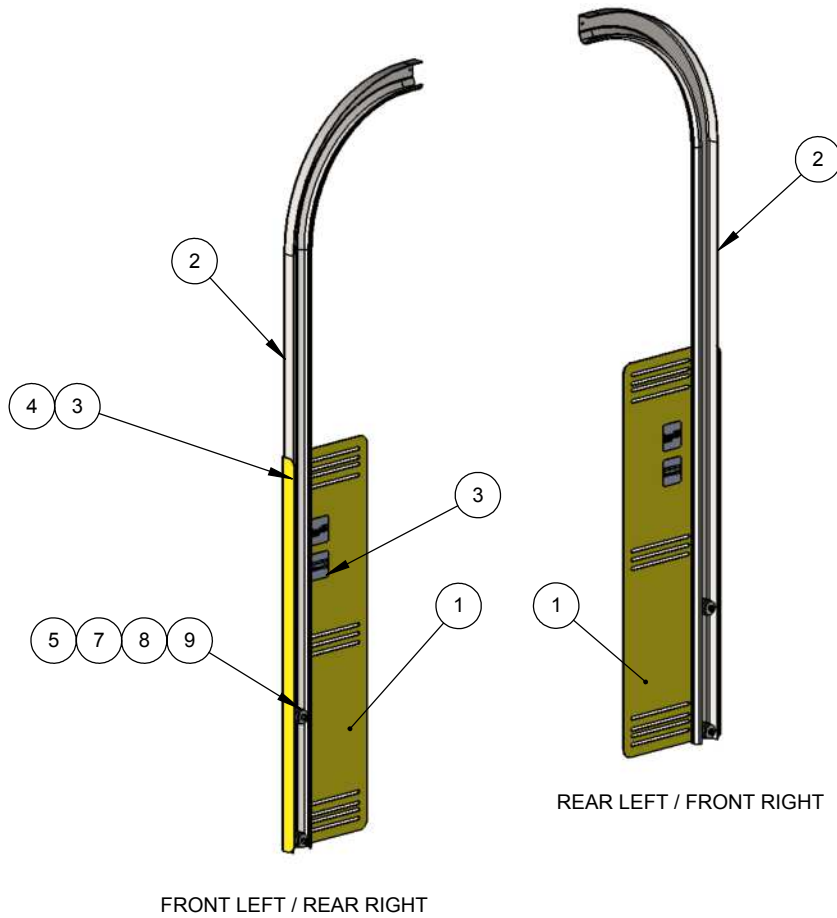

1035.XX TRK,SIDE,BRKT,ASSY,RKPR (INCLUDES THE FOLLOWING)			
ITEM	QTY	PART NUMBER	DESCRIPTION
1	1	46000093	FRAME,SIDE,RKPR
2	1	1036.XX	TRK,CUT,3IN,90DEG,RKPR
3	3	67860022	BLT,TRK,RIBBED,1/4X5/8,ZNC
4	3	55610013	NUT,HEX,FLANGE,SERRATED,1/4-20
5	2	67880135	SCR,HHMS,3/8-16X2-1/2,GR5,ZNC
6	2	74130001	WSHR,FLAT,3/8X1X.063,ZNC
7	2	55630005	NUT,HEX,NYL LOCK,3/8-16,ZNC
8	2	74130025	WSHR,FLAT,3/8X1-1/2X1/8,ZNC
9	2	15250142	BMPR,RUBR,1.68ODX3/8IDX1-5/8
10	1	53850681	LABEL,BARRIER,RHC,RACKEEPER
11	1	53850680	LABEL,BARRIER,RACKEEPER

PARTS

FRONT AND REAR RAIL

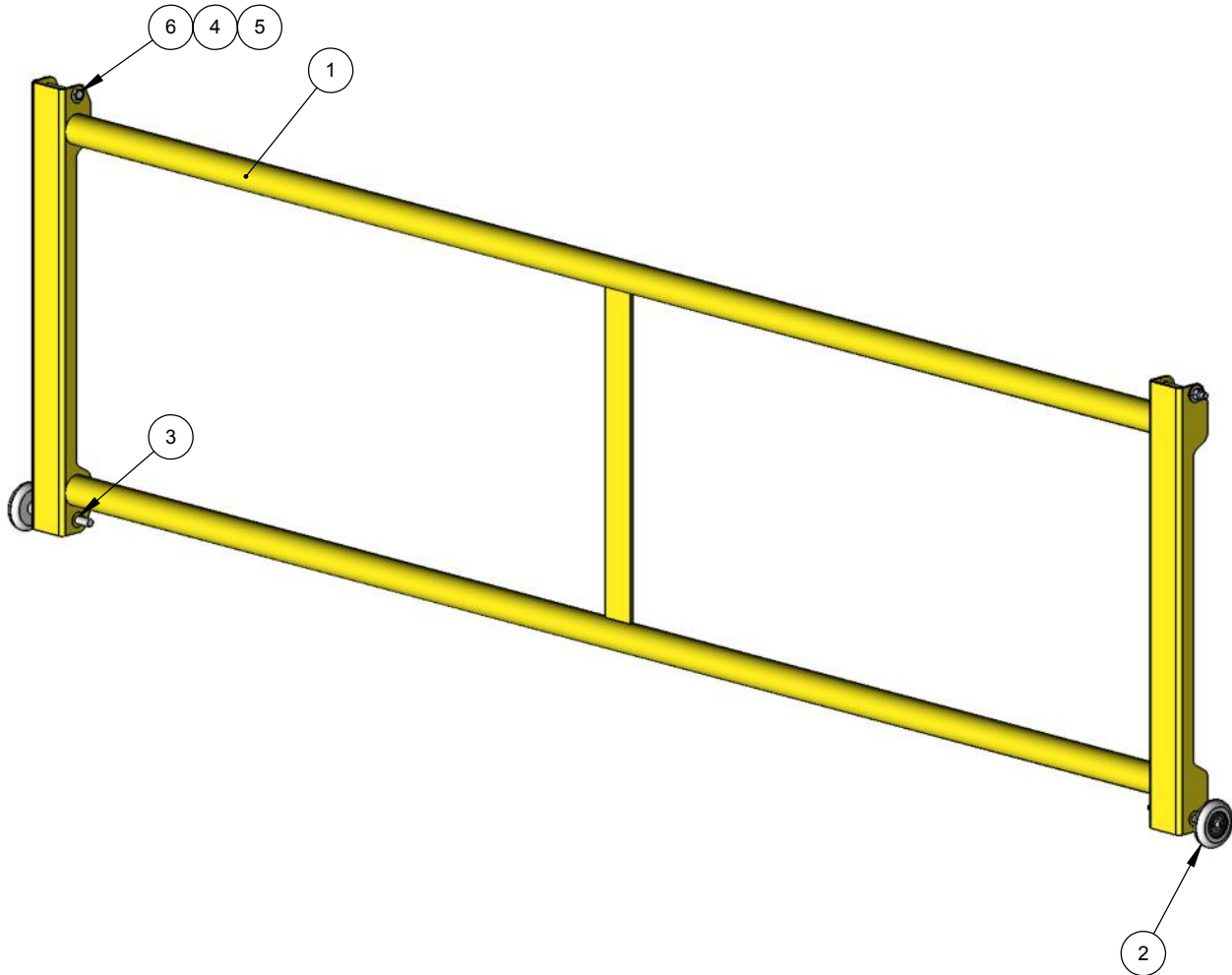

ITEM	QTY	PART NUMBER	DESCRIPTION
1	1	1032.XX	RAIL,FRONT,STL,RKPR,XX",COW
2	1	75550015	WHEEL,DOOR,3IN,NYL,4-1/2 STEM
3	2	67860038	SCR,SET,SCKT,KN CUP,1/4-20X1/4
4	2	74130001	WSHR,FLAT,3/8X1X.063,ZNC
5	1	55630005	NUT,HEX,NYL LOCK,3/8-16,ZNC
6	1	67880134	SCR,HHMS,3/8-16X3-1/4,ZNC

SIDE HEADER

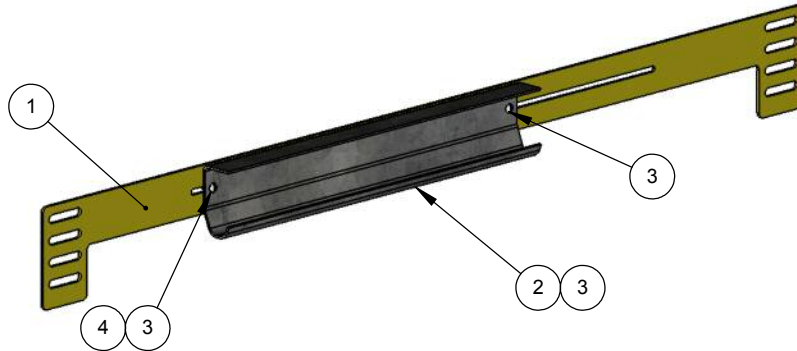

1030.XX SIDE HEADER ASSEMBLY				
ITEM	QTY	PART NUMBER	DESCRIPTION	(includes the following:)
1	1	1031.XX	HEADER,SIDE,GTKPR,RS,XX"COD	
2	1	73450253	TRACK,DOOR,3IN,STRGHT,GTKPR	
3	2	67860022	BLT,TRK,RIBBED,1/4X5/8,ZNC	
4	2	55610013	NUT,HEX,FLANGE,SERRATED,1/4-20	

OPTIONAL FACE MOUNT KIT

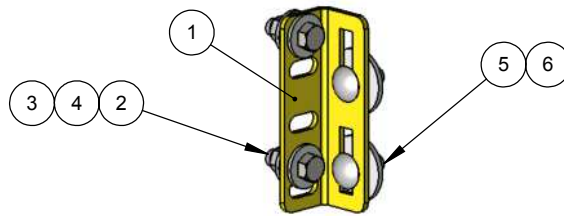

53760028 KIT,FACE MOUNT,RKPR (includes the following:)				
ITEM	QTY	PART NUMBER	DESCRIPTION	
1	1	14502088	BRKT,MNT,FACE,RKPR	
2	2	67880004	SCR,HHMS,3/8-16X1-1/4,GR5,ZNC	
3	4	74130001	WSHR,FLAT,3/8X1X.063,ZNC	
4	4	55630005	NUT,HEX,NYL LOCK,3/8-16,ZNC	
5	2	67880092	BLT,CARG,3/8-16X1,ZNC,GRD5	
6	2	74130025	WSHR,FLAT,3/8X1-1/2X1/8,ZNC	

PARTS

PARTS BOX

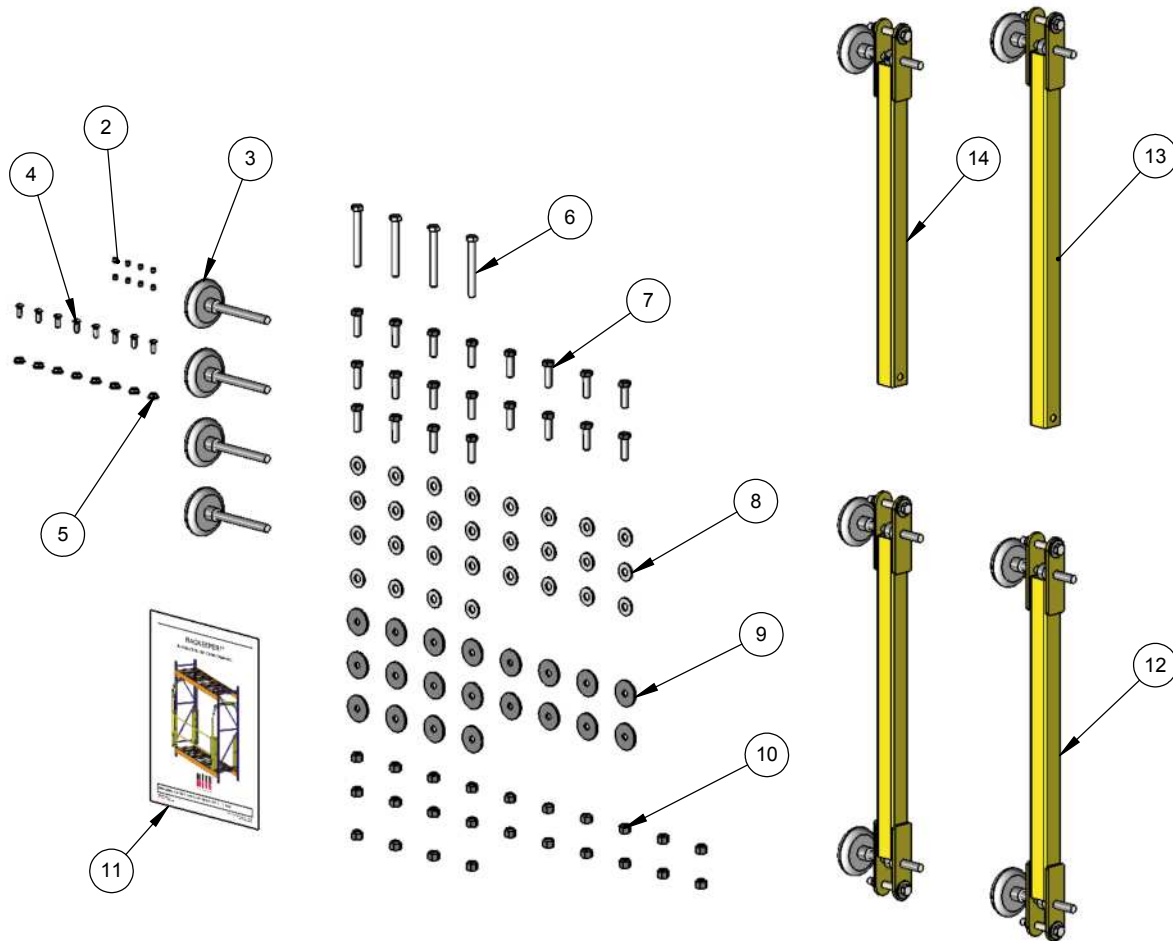

BOM Table				
ITEM	QTY.	PART NUMBER	DRAWING	DESCRIPTION
1	1	53760010	1213M111	KIT,PARTS BOX RKPR
2	8	67860038	(9900M158)	SCR,SET,SCKT,KN CUP,1/4-20X1/4
3	4	75550015	1201M063	WHEEL,DOOR,3IN,NYL,4-1/2 STEM
4	8	67860022	(9900M172)	BLT,TRK,RIBBED,1/4X5/8,ZNC
5	8	55610013	(9902M081)	NUT,HEX,FLANGE,SERRATED,1/4-20
6	4	67880134	(9900M172)	SCR,HHMS,3/8-16X3-1/4,ZNC
7	20	67880004	(9900M003)	SCR,HHMS,3/8-16X1-1/4,GR5,ZNC
8	28	74130001	(9902M006)	WSHR,FLAT,3/8X1X.063,ZNC
9	20	74130025	(9902M206)	WSHR,FLAT,3/8X1-1/2X1/8,ZNC
10	24	55630005	(9902M007)	NUT,HEX,NYL LOCK,3/8-16,ZNC
11	1	54450047	(1213M020)	LIT,MANUAL,OWNERS,RKPR
12	2	54400037	1201M104	LINK,ASSY,DBL,STEEL,GTKPR
13	1	54400042	1201M098	LINK,ASSY,LONG,STEEL,GTKPR
14	1	54400039	1201M109	LINK,ASSY,SHORT,STEEL,GTKPR

NOTES

WARRANTY

RITE-HITE® WARRANTY

RITE-HITE® warrants that its **RACKEEPER™**, will be free from defects in design, materials and workmanship for a period of three (3) years parts and one (1) year labor from the date of shipment. All claims for breach of this warranty must be made within thirty (30) days after the defect is or can, with reasonable care, be discovered to be entitled to the benefits of this warranty, the products must have been properly installed, maintained, operated within their rated capacities, and not otherwise abused. Periodic lubrication and adjustment is the sole responsibility of the owner. This warranty is RITE-HITE® exclusive warranty. RITE-HITE® EXPRESSLY DISCLAIMS ALL IMPLIED WARRANTIES INCLUDING THE IMPLIED WARRANTIES OF MERCHANTABILITY AND FITNESS. Non-standard RITE-HITE® warranties, if any, must be specified by RITE-HITE in writing.

In the event of any defects covered by this warranty, RITE-HITE® will remedy such defects by repairing or replacing any defective equipment or parts, bearing all of the costs for parts, labor, and transportation. This shall be the exclusive remedy for all claims whether based on contract negligence or strict liability. Neither RITE-HITE®, ANY OTHER MANUFACTURER WHOSE PRODUCTS ARE THE SUBJECT OF THIS TRANSACTION, NOR ANY RITE-HITE® REPRESENTATIVE, SHALL IN ANY EVENT BE LIABLE FOR ANY LOSS OR USE OF ANY EQUIPMENT OR INCIDENTAL OR CONSEQUENTIAL DAMAGES OF ANY KIND WHETHER FOR BREACH OF WARRANTY, NEGLIGENCE, OR STRICT LIABILITY. The application of a manufacturer's specifications to a particular job is the responsibility of the purchaser. RITE-HITE® SHALL NOT IN ANY EVENT BE LIABLE FOR ANY LOSS OF THE USE OF ANY EQUIPMENT OR INCIDENTAL OR CONSEQUENTIAL DAMAGES OF ANY KIND.



AFTERMARKET CORPORATION

8900 N. Arbon Drive
P.O. Box 23043
Milwaukee, Wisconsin 53223
Sales: 414-362-6377
Toll Free: 888-423-0789

Representatives in All Major Cities
To find the name and number of
your local RITE-HITE® representative
please visit www.ritehite.com