

1	Stone Cladding 40mm
2	Eterpan Base, 9mm
3	Building Wrap, RAB or other E2/AS1 compliant system
4	Mapelastic Smart Waterproofing Membrane
5	Pipe penetration sloping outside
6	Screw Detail For use with building wrap Screw SS, 10g, 35mm Coastal- 316 Non Coastal- 304 For use with Rigid Air Barrier (7mm Ecoply or similar) Screw SS, 10g, 35mm Coastal- 316 Non Coastal- 304
7	Cavity Batten, 40-45x40-45mmn Nogs/Dwangs to be inclined 5°
8	Marshall Pipe Gasket or similar
9	Sealant
10	Structural 40mm Batten Fixing by Engineer

INTELLECTUAL PROPERTY NOTICE

- PEDRACLAD®** and related materials are owned by Stone Cladding Systems Limited and are protected by international copyright, trademark, design and other intellectual property and proprietary rights.
- Unauthorized use or alteration is prohibited without express permission from Stone Cladding Systems Limited or Island Stone NZ Ltd as its designated agent.
- The information contained in these drawings is intended exclusively for use with ISNZ/NSC supplied products or authorised agents as part of a total system.
- STONE CLADDING SYSTEMS LIMITED** provides no certification, guarantee, indemnity or warranty in respect of the information contained herein if used with any non ISNZ/NSC supplied product without **PEDRACLAD®** permission.
- Any use of this information beyond the purpose for which it was intended is strictly prohibited including the use in unauthorised projects or in conjunction with non ISNZ/NSC products and may result in legal action.

Max. wet weight of stone 80kg
Studs @ max. 600mm crs
Nogs @ max. 800mm crs
Screws to all framing @ max. 150mm crs
Max. wet weight of stone 100kg
Studs @ max. 400mm crs
Nogs @ max. 800mm crs
Screws to all framing @ max. 150mm crs

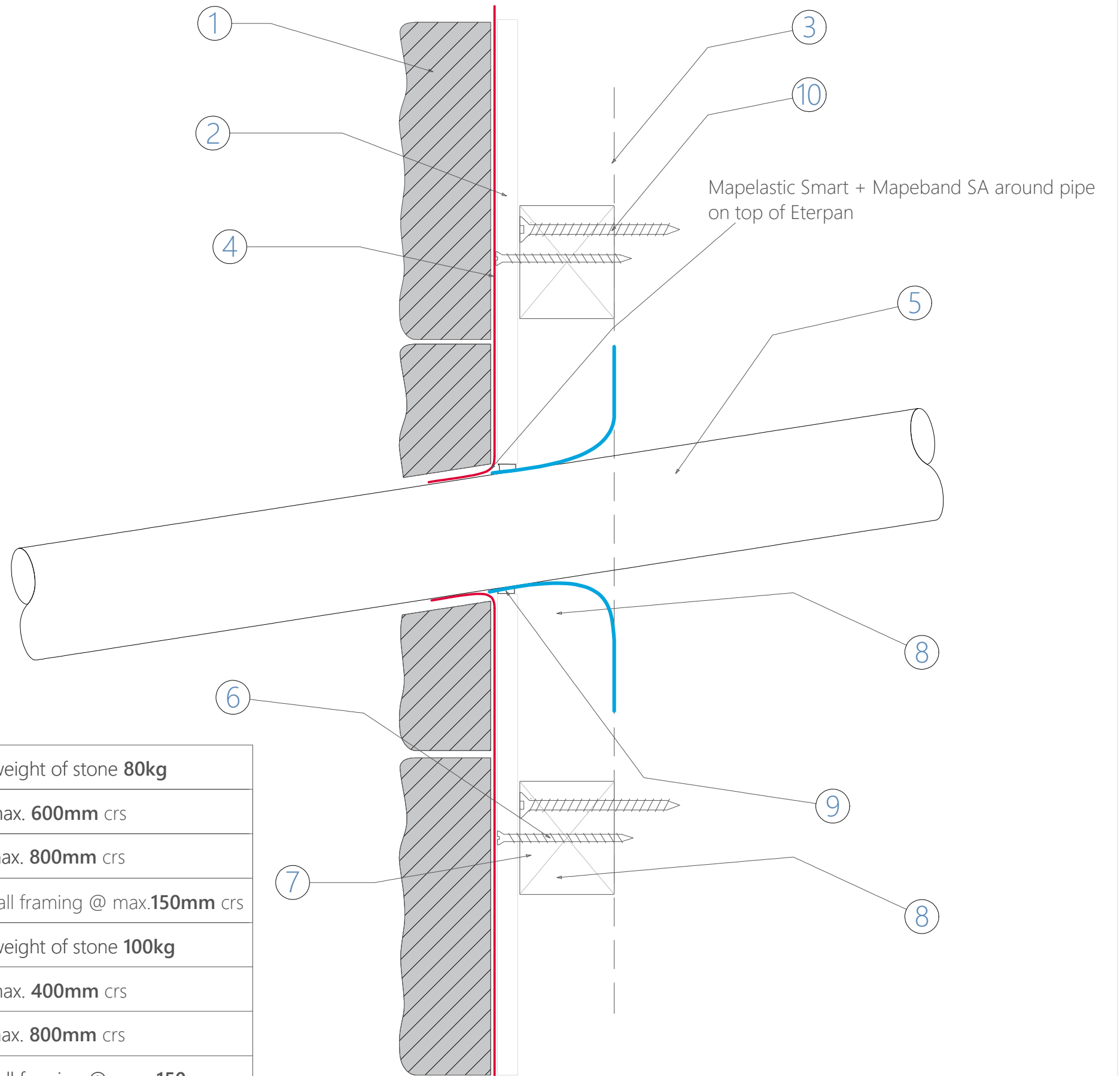

Drawing:	40-45mm: Pipe Penetrations	PEDRACLAD® STONE CLADDING INSTALLATION SYSTEMS	Scale:	NTS @ A3
Drawing Number:	31	Licensed to Island Stone NZ Ltd and The Natural Stone Co.	Sheet Details:	S-01
			Date:	11-May-26