



# StratusEEG Client Installation Guide

---

Software Version 6.0

Revision: 01.00

Date of Issue: 27 Aug 2025

## System Requirements

The table below outlines the minimum and recommended system specifications for installing the StratusEEG Client software, which includes the Centrum, Review, and Team Monitor applications.

	Minimum	Recommended
<b>Operating System</b>	Windows 11 (64-bit)	Windows 11 (64-bit)
<b>Processor</b>	Dual Core 3.0 GHZ	Quad Core – 4 GHZ
<b>Memory</b>	8 GB	32 GB
<b>Screen Resolution</b>	1920 x 1080	1920 x 1080
<b>Graphic Card</b>	-	Graphics processing units (GPU)
<b>Hard Drive (Available space)</b>	150 GB	500 GB

Note: Operating at the minimum system requirements may reduce performance, particularly when reviewing exams that include video.

## Network Requirements

The table below represents the network requirements for optimal communication with a StratusEEG Server from a client system:

	Minimum	Recommended
<b>Bandwidth - Upload</b>	20 Mbps	40 Mbps
<b>Bandwidth - Download</b>	50 Mbps	100 Mbps
<b>Packet loss</b>	<1%	<0.1%
<b>Accessible Firewall Ports</b>	HTTPS/443, HTTPS/8443	

Note: Operating at the minimum network requirements may reduce performance, particularly when reviewing exams that include video.

## Windows Applications Requirement

The software installs the Windows .NET application *Kvikna.Streaming.Server.exe*, which must be running to support background operations for the software, such as exam uploads.

## Installing the Client Software

The Client software is installed using the provided Windows installer in a compatible environment. The installer file is named: *Stratus.EEG.Client\_ Major.Minor.build.rev.msi*.

By default, the software is installed in: *%programfiles%\Kvikna ehf\Stratus EEG Client*.

The following steps describe how to install the StratusEEG Client software:

1. Verify that the computer meets the system and network requirements.
2. Log in to the computer with an account that has administrative privileges.
3. Ensure all applicable Windows updates are installed.
4. Download the StratusEEG Client / Physician Client from <https://stratus EEG.com/eeg-resources/>.
5. Double-click the downloaded Windows installer file.
6. When prompted, select **Yes** to continue with the installation.

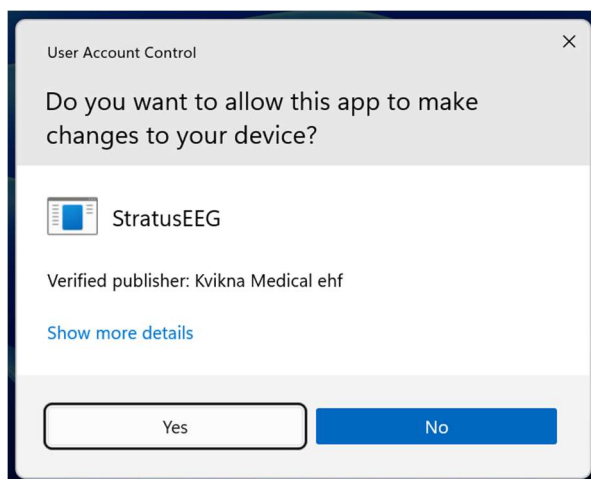

7. Optional: When prompted, select **Yes** to install the Word Report add-in, which enables the use of Microsoft Word reports in the software.

## Configure Connection to a Server

The StratusEEG Client must be connected to a designated StratusEEG Server. While the Client can be set up to recognize multiple Servers, only one active connection is available at a time.

The following steps describe how to configure the Client to connect to a Server:

1. Open the Centrum application



2. On the Login page, click Manage Connections



3. Click Add at the bottom of the Connection List on the left side of the screen



4. Under Connection Properties on the right, enter the information as follows:

<b>Name</b>	myconnection
<b>Host</b>	https myconnection.stratuseeg.com
<b>Port</b>	443

**Name:** Server name (chosen by user)

**Host:** *https* followed by the IP Address/DNS name of the StratusEEG Server

**Port:** 443

5. At the bottom of the Connection Properties page, click Save

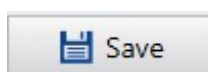

6. Go back to the Login page and click on the newly added Server to confirm successful configuration



7. Log in to the Server using the provided User Name and Password, then click OK.

User Name	username
Password	.....

## Client Update Functionality

Depending on the server configuration, automatic Client updates may be available. If the server has a newer version of StratusEEG installed, the connecting Client will display the following notification:



Select **Yes** to upgrade the Client to the newest version. The update will download, and the application will automatically restart once the installation is complete.

Select **No** to dismiss the notification without updating.