



Accessory Dwelling Unit

Document Contents:

P00	Cover
P01	Rendered Perspective
P02	Rendered Perspective
P03	Floor Plan



XFrame reusable, prefabricated timber frame system made from structural plywood.

Polycarbonate Panels, 100% recyclable with aluminium frames.

Bi-folding doors with black aluminium frame. Possibility to extend living area outside onto a deck.

Abodo Vertical Weatherboards in thermally modified New Zealand Pinus Radiata.

Marmoleum Modular Tiles, a natural, sustainable linoleum floor covering made from natural, raw materials. Durable, easy to clean and maintain sustainable flooring.



saveBOARD Paperfaced internal linings made from 100% recycled Tetra Pak and plastic waste. Painted with Natural Paint Co. bio-based, non-toxic paint.

Built in furniture, made from FSC certified pine or birch plywood and finished with natural oils.

Compressed Bamboo Flooring made from sustainable, compressed bamboo fibres. Click-locking system facilitating quick installation.

Betta Stone benchtop made from 100% Australian recycled glass.

HDPE Plastic Sheet made from 100% recycled plastic in 'Black Marble'. Durable and moisture resistant bathroom lining.

Exterior Services enclosed by timber cladding system. Easily assessable for maintenance and upgrades.

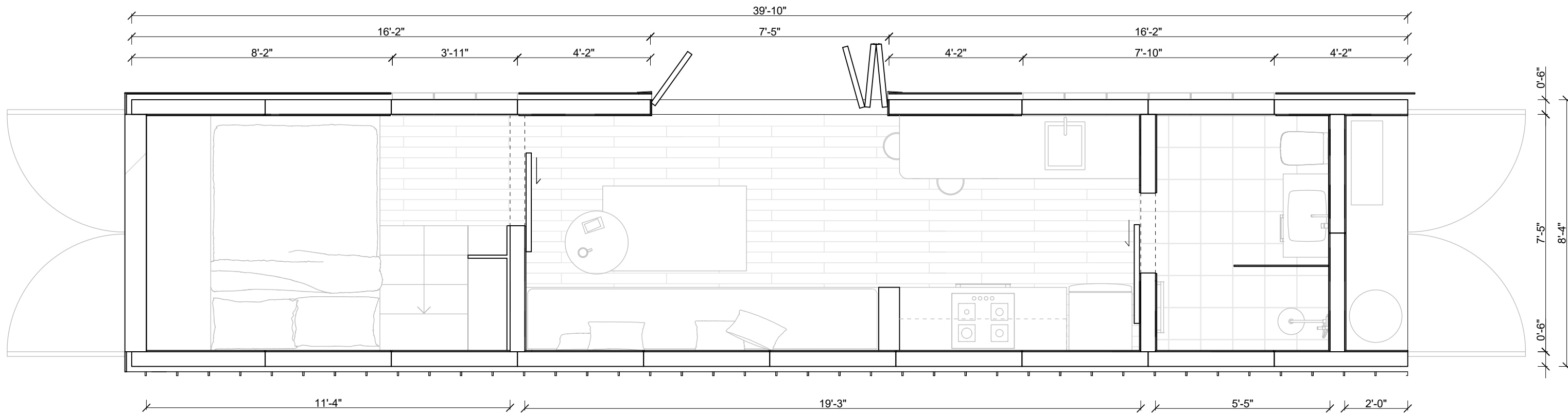

Dimensions subject to final design.



[w. xframe.com.au](http://w.xframe.com.au) | [e. projects@xframegroup.com](mailto:e.projects@xframegroup.com)

Copyright XFrame Party Limited 2026. XFrame and the XFrame Logo are a registered trademark of XFrame Pty Ltd, Australia.