

HOW TO USE YOUR CARD FOR LOGIN

LINK ACCESS FIDO2 TO USER ACCOUNT:

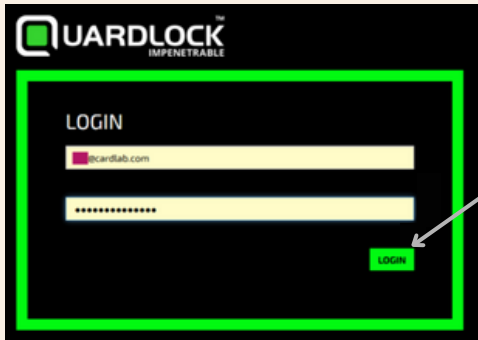

- Go to Quardlock.com.
- Enter username.
- Press "Login".

You should have received an username and a onetime password, in the introduction mail - "Setup Cardlab Access card".

You will need to change the password, on first login.



- Go to dashboard.
- Press "Register FIDO/Passkey Token".

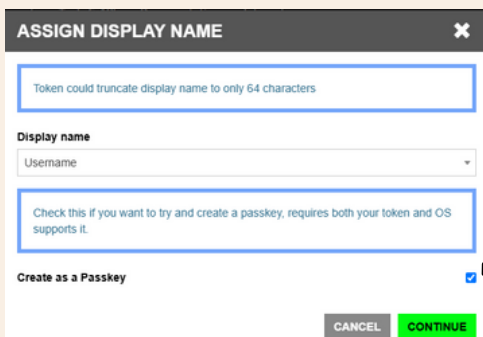

- Tick of "Create as a Passkey".
- Press Continue.

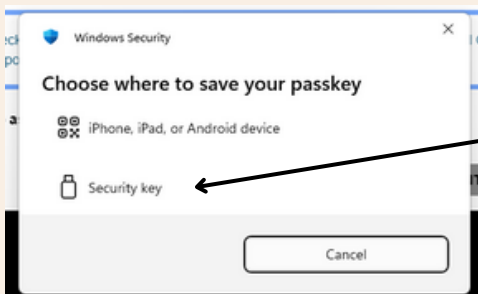

- Press the security key.

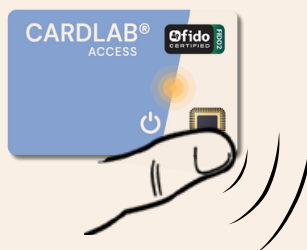

- Turn on the card. 
- Place your finger on the fingerprint sensor when you see the yellow blinking light.

HOW TO USE YOUR CARD FOR LOGIN

LOGIN WITH YOUR ACCESS CARD

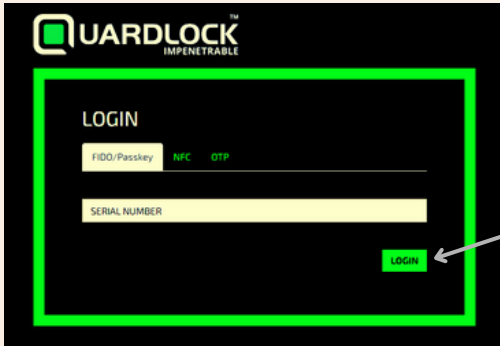

- Go to the homepage mentioned in your introduction mail – “Setup Cardlab Access card”.
- Press login

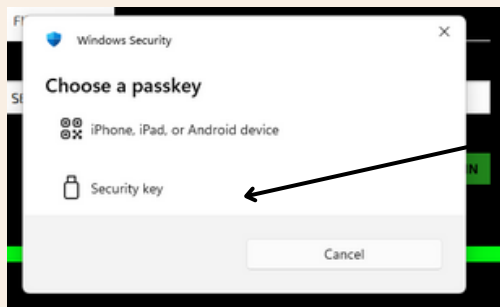

- Press the security key



- Turn on the card 
- Place your finger on the fingerprint sensor when you see the red blinking light.

You have now logged in using the CardLab Access Card

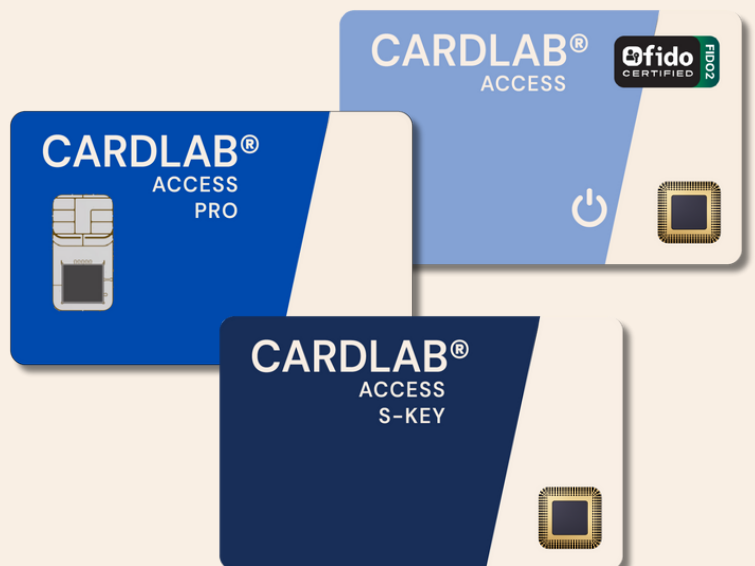

CARDLAB INNOVATION APS

HOERKAER 20, 2
DK-2730 HERLEV
DENMARK

EMAIL: INFO@CARDLAB.COM
PHONE: +45 31 55 49 94