



HERA 750

CNC GEAR HOBGING MACHINE

Combining advanced technology, precision components, and economic pricing to enable profitable production of high-quality spur gears, helical gears, worm gears, and other hobbled profiles.

- **High-speed direct-drive hob head with CNC shifting.**
 - Automatic retraction of X-axis during power failure, preventing hob damage.
- **Direct-drive torque motor for the work spindle**
- **Flexible standard dialogue program offering:**
 - One or two gears on a single workpiece.
 - Radial, axial, climb, and/or conventional hobbing on single- or two-cut cycle.
 - Crowning (lead modification) and deburring using two equal hobs.
 - Automatic shifting over broken hob section.
- **CNC by FANUC® oi-MF with 6 axes (optional 7).**
 - Tangential position of hob head (shifting) by CNC.
- **Quality components and construction:**
 - Precision, repeatability, and control with linear scales on the X-axis.
 - Cast iron machine base for optimum stability and dampening.



1.6 DP

Max Pitch Rating

30.7 in

Max Part Diameter

7

CNC Axes



WORKPIECE		Hera 750 metric/imperial	
Maximum pitch rating, hobbing	16.00 m _n	1.6 DP	
Maximum workpiece diameter	780 mm	30.71 in	
Total axial travel	480 mm	18.90 in	
Minimum axial position	230 mm	9.06 in	
Maximum axial position	710 mm	27.95 in	
Total radial travel of hob head	550 mm	21.65 in	
Minimum radial position of hob head	80 mm	3.15 in	
Maximum radial position of hob head	630 mm	24.80 in	
Total tailstock travel	600 mm	23.62 in	
Minimum tailstock position	400 mm	15.75 in	
Maximum tailstock position	1000 mm	39.37 in	
Maximum work spindle speed	50 rpm		
Maximum table load	5,500 kg	12,125 lb	
HOB HEAD			
Maximum spindle speed	450 rpm		
Maximum hob diameter	300 mm	11.81 in	
Maximum cutter width	300 mm	11.81 in	
Maximum cutter shift	280 mm	11.02 in	
Swivel range	+35°/-45°		
DIMENSIONS			
Width	4,500 mm	177.17 in	
Depth	3,000 mm	118.11 in	
Height	3,200 mm	125.98 in	
Weight	20,000 kg	44,093 lbs	
POWER			
Total connected load	95 kVA		
Main spindle motor	12 kW		
Electrical connection	220V, 3 phase, 60 Hz		

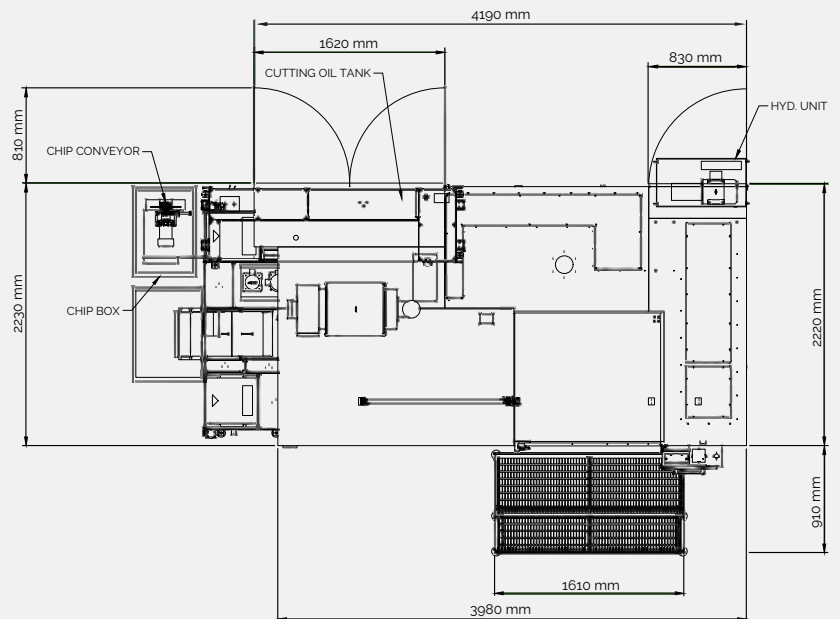

CONTACT
 (847) 931-4121
 635 Schneider Drive
 South Elgin, Illinois 60177

HELIOSGEARPRODUCTS.COM
 sales@heliosgearproducts.com

