

Complete Thermal Break and Ventilation Cavity System

The ATI X12 Cavity System provides a practical, compliant and cost-effective way to meet the new NCC 2025 requirements for drained and ventilated cavity wall systems.

Improve Efficiency. Control Moisture.

Modern homes are more airtight and heavily insulated, improving energy performance but increasing the need for drainage and ventilation behind cladding. Without a drained and ventilated cavity, trapped moisture can lead to condensation, mould, rot, poor indoor air quality and increased builder liability.

One System to Drain, Ventilate and Insulate.

Designed for timber and steel frames, ATI X12 creates a consistent cavity for drainage and airflow behind cladding, while providing a thermal break to support energy efficiency and compliance.

Simple to Specify. Easy to Use.

Whether replacing timber battens or adding a cavity system for the first time, ATI X12 fits easily into everyday building practice, helping simplify compliance, reduce moisture risk and control cost.

Australian-owned. Practical by Design.

Australian Thermal Industries is an Australian-owned company committed to practical, efficient and more sustainable building methods that support builders, specifiers and homeowners.

NCC 2025 COMPLIANT

EXCEEDS NATIONAL CONSTRUCTION CODE 2025 REQUIREMENTS



Industry Focused Features



Score and snap using hand tools with **no hazardous dust**



Effortless management with lightweight, easy to transport pack sizes



Straighter walls with high compressive strength XPS construction



Resistant to mould, rot, mildew and termites



Fire retardant additives to ensure a low flame spread risk



30% faster installation with easy to handle 1200mm lengths



Superior adhesion with reinforced self-adhesive backing



Improved energy efficiency and code compliance

One System. Two Products.

Complete Cavity Management.

Cavi-Break® X12

Installs vertically to create a consistent 12mm cavity between your frame and cladding, with thermal break performance built in.

Ideal for use as a superior thermal break for steel framing and also an efficient cavity batten for timber framing. Cavi-Break® X12 exceeds the NCC R-value requirement by 60%.

Cavi-Vent® X12

Installs horizontally with an engineered castellated profile that creates drainage and ventilation pathways behind your cladding preventing trapped moisture.

One System for Timber and Steel

Cavi-Break® X12 and Cavi-Vent® X12, form a complete 12mm cavity system that drains, ventilates, and insulates — all in your timber or steel wall assembly.

Cavi-Break® X12 and Cavi-Vent® X12 exceed new cavity provisions and reduce thermal bridging between cladding and framing.

Works with the Cladding You Use.

Compatible with all lightweight cladding: Weathertex, James Hardie, Colorbond, vinyl, aluminium, and more.

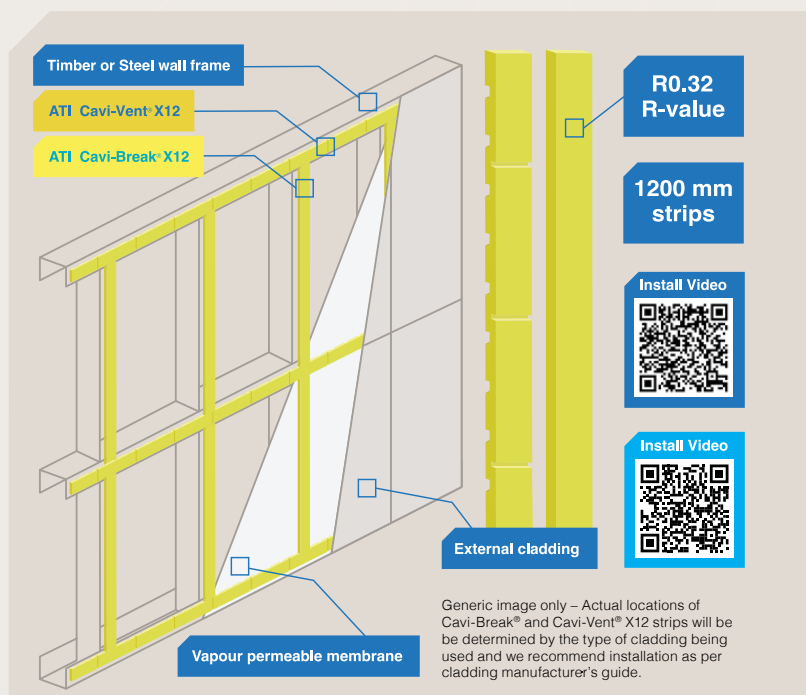

Specifications

| | Cavi-Break® X12 | Cavi-Vent® X12 |
|------------------------------------|-----------------|----------------|
| Cavity Spacing | ■ | ■ |
| Thermal Break | ■ | ■ |
| Drainage + Ventilation | | ■ |
| Installation Orientation | Vertical | Horizontal |
| Stud Fixing | ■ | ■ |
| Thermal Performance | R0.32 | R0.32 |
| High-performance XPS | ■ | ■ |
| Self-adhesive Peel & Stick Backing | ■ | ■ |
| Waterproof, Mould-proof, Rot-proof | ■ | ■ |
| Timber Frame Compatibility | ■ | ■ |
| Steel Frame Compatibility | ■ | ■ |
| 45mm W x 12mm D x 1200mm L | ■ | ■ |
| Pack Quantity | 125 | 125 |
| Lineal Metres/Pack | 150 | 150 |
| 10 Year Product Warranty | ■ | ■ |

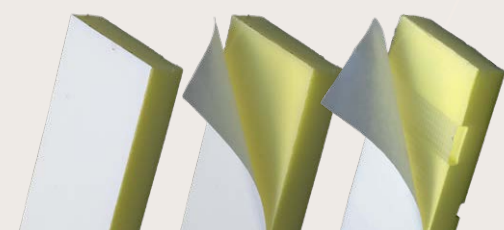

Ready to see it for yourself? Contact us today.

Request a sample box - feel the quality, test the adhesive, see how fast it goes on.

Use the Usage Estimator - calculate exactly what you need for your next project.

Download the Specifier Pack - technical data sheets, DWG and Revit files, specification references.

Talk to ATI - have a question about your wall assembly or climate zone? We'll help you work it out.

sales@australianthermal.com.au
P 1300 430 949

PO Box 188
Wynnum, QLD, 4178

australianthermal.com.au



ABN 44 664 489 678

ATI donates 1% of its sales revenue to the HIA Charitable Foundation (HIACF), which works to improve health and welfare outcomes in the housing industry, including mental health issues.

